



WARNING/SAFETY PRECAUTIONS

To avoid any risk of personal injury, material damage or incorrect use of the appliance, be sure to observe the following safety precautions. (After reading these owner's instructions, please keep them in a safe place for reference).

Remember to hand them over to any subsequent owner.

 WARNING	Indicates that a danger of death or serious injury exists
 CAUTION	Indicates that risk of personal injury or material damage exists

WARNING

Do not plug several appliances into the same sockets.

- This could cause overheating and the risk of fire.

Keep the power plug away from the rear of the fridge.

- A damaged power plug may cause fire due to overheating.

Do not directly spray water inside or outside the fridge .

- There is a risk of fire or electric shock.

Do not bend the power cord excessively or place heavy articles on it.

- This constitutes a fire hazard. If the power cord is damaged, have it replaced immediately by the manufacturer, its service agent or a similarly qualified person.

Do not insert the power plug with wet hands.

- You may receive an electric shock.

Do not put a container filled with water on top of the appliance.

- If the water spills on to any electrical parts, it may lead to fire or electric shock.

Do not store volatile and flammable substances in the refrigerator.

- The storage of benzene, thinner, alcohol, ether, LP gas or other such substances may cause an explosion.

Do not disassemble, repair or alter the appliance.

- It may cause fire or abnormal operations, which may lead to injury.
Pull the power plug out of the socket before replacing the interior light in the refrigerator.
- Otherwise, there is a risk of electric shock.
- Only the customer service may change the power cord and carry out any other repairs. Improper Installations and repairs may put the user at considerable risk.

Be sure to earth the appliance.

- Otherwise, it may cause material damage and electric shock.

If you wish to dispose of the fridge , throw it away after removing the door or its seals.

Keep ventilation openings in the appliance enclosure or in the built-in structure, clear of obstruction.

Do not use mechanical devices or other means to accelerate the defrosting process, other than those recommended by the manufacturer.

CAUTION

Do not store too much food in the appliance.

- When you open the door, an item may fall out and cause personal injury or material damage.

If the wall socket is loose, do not insert the power plug.

- It may cause electric shock or fire.

Do not disconnect the power cord by pulling on it.

- You may disconnect a wire and cause a short circuit.

Do not store pharmaceutical products, scientific material or other temperature-sensitive products in the refrigerator.

- Products that require strict temperature controls must not be stored in the refrigerator.

Do not let a child hang from the door.

- It may cause frostbite.

Remove any foreign matter from the power plug pins.

- Otherwise, there is a risk of fire.

Do not put your hand into the bottom area of appliance.

- Any sharp edges may cause personal injury.

After unplugging the appliance, wait for at least five minutes before plugging it again to the wall socket.

- It may cause abnormal operation.

If the appliance is not be used for a long period of time, pull out the power plug.

- Any deterioration in the insulation may cause fire.

CAUTION

- R-600a or R-134a is used as a refrigerant. Check the compressor label or the rating label to see which refrigerant is used for your refrigerator.

When this product contains flammable gas(R-600a), please be aware of followings;

- Keep ventilation openings, in the appliance enclosure or in the built-in structure, clear of obstruction.
- Do not damage the refrigerant circuit.

And contact your local authorities in regard to the safe disposal of this product.

Ensure that none of the pipes on the back of the appliance are damaged prior to disposal.

- Do not allow children to play with this appliance.

- C-Pentane is used as an insulation blowing gas.

The flammable insulation blowing gases require special disposal procedure. Please contact your local authorities in regard to the environmentally safe disposal of this product.

- This appliance is not intended for use by persons (including children) with reduced physical, sensory or mental capabilities, or lack of experience and knowledge, unless they have been given supervision or instruction concerning use of the appliance by a person responsible for their safety.

NAMES OF THE PARTS

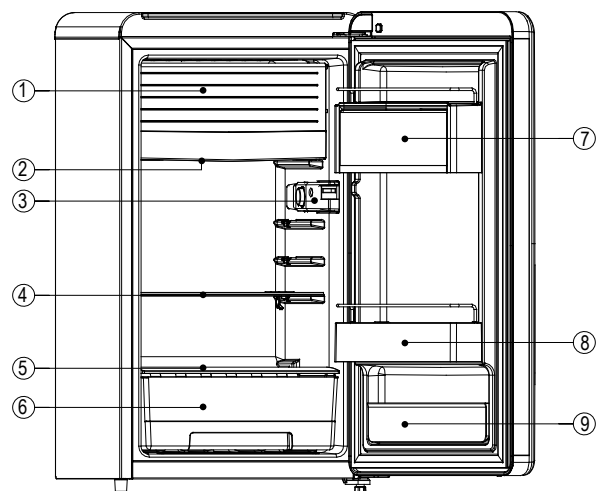

1. EVAPORATOR

The heart of the refrigerator.

It evaporates the refrigerant fluid and thereby absorbs heat from the surrounding. Made of pure aluminum.

2. DRAIN PAN (Use of Defrost Only)

Discards the water that drips of the evaporator when defrosting.

3. CONTROL BOX :

Regulates the operation of the motor and controls the inside temperature of the refrigerator.

4. SHELF

Has full width and can slide out.

5. COVER CASE VEGETABLE has full width and can slide out.

6. CASE VEGETABLE

for vegetables and fruits.

7. MULTI POCKET for cans or jars.

8. BOTTLE RACK for bottles, cans or jars.

9. POCKET TILT for cheezes.

HOW TO OPERATE

Starting your new Refrigerator

1. Clean the refrigerator thoroughly. Wipe the outside with a soft dry cloth, the inside with a damp cloth.
2. Keep the door open and insert the power supply cord into the socket.
3. Turn the thermostat dial to "7". Close the door and let the refrigerator operate for 15-20 minutes.

The freezer should then show some traces of frost.

Temperature control

You can control the inside temperature by turning the thermostat dial. Higher numbers mean greater cooling power, smaller numbers mean less cooling power. To make ice cubes in the freezer compartment, set the dial to "7". The dial does not have to be set exactly on the numbers, but can be any place in between.

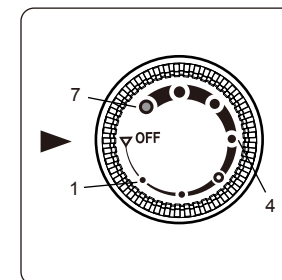

NOTE : Wait 3 to 5 minutes before restarting if you unplug the machine. Unit may fail to operate properly if restarted too quickly.

How to defrost

Defrost the refrigerator when the frost accumulated on the evaporator is about 5 mm (1/5 inch) thick.

Set the thermostat dial to "OFF". Remove foods. Keep drip tray in place. Defrosting usually takes a few hours. To defrost quickly remove all foods from the refrigerator and leave door open. Never use a knife or other metal instrument to remove ice/frost from the evaporator.

After defrosting empty water from drip tray, return the thermostat dial to the desired position to start refrigerating again.

HOW TO CLEAN

Cleaners: The cleaners noted below are available.

Never use harsh, abrasive cleaners, heavy-duty cleaners, or solvents on any surface.

Exterior: Wipe with damp, sudsy cloth, rinse and dry.

For stubborn stains and for periodic waxing, use silicon wax.

Evaporator: When refrigerator needs defrosting turn thermostat dial to "OFF".

Do not use sharp instruments.

Refrigeration Section: Wash shelves and other removable parts in warm sudsy water, rinse and dry.
Wash interior with baking soda solution (3 table spoons to one quart of water) or warm sudsy water, rinse and dry.

Magnetic Door Seals: Wash with warm sudsy water.

The Finishing Touch: Replace all parts and return thermostat dial to desired setting.

HOW TO INSTALL

- Install refrigerator in a convenient location away from extreme heat and cold. Allow sufficient clearance between the refrigerator and side wall so the door will open for a fully usable interior. Refrigerator is not designed for recessed installation.
- Select a place with strong level floor.
- Allow 5 inches of space between the refrigerator's side and the wall.

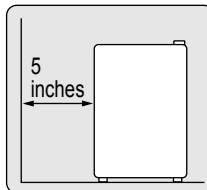

HOW TO LEVEL

If the front of the appliance is slightly higher than the rear, the door can be opened and closed more easily.

1. The appliance tilts up to the left.

Turn the left adjusting leg in the direction of the arrow until the appliance is level.

2. The appliance tilts down to the right.

Turn the right adjusting leg in the direction of the arrow until the appliance is level.

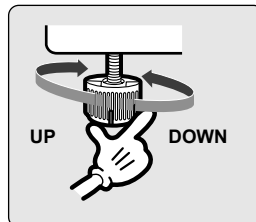

WHAT TO DO...

1. When out of operating for a long time:

- Remove the power supply cord.
- Dry your refrigerator opening the door for 2-3 days.

2. When you get ready to move:

- Securely fasten removable interior parts (or move and package them separately)
- Do not lay your refrigerator horizontally, or compressor may be damaged.

When you need service: Before you call for service make sure you need it, check a few things noted below for yourself first.

If refrigerator is not operating:

- Is the power supply cord unplugged?
- Is home fuse blown or circuit breaker off?

If refrigerator is warmer than usual:

- Has the door been open frequently or for a long period?
- Is refrigerator overcrowded-preventing good air circulation?
- Is the hot thing stored without cooling?
- Is the clearance between refrigerator's side and the wall allowed sufficiently?

If there are unusual sounds:

- Is refrigerator placed on the level?
- Are foreign objects behind the refrigerator?
- Are dishes on refrigerator shelves vibrating?
If so, rearrange the dishes.

If the supply cord is damaged, it must be replaced by the manufacturer or its service agent or a simmilary qualified person in order to avoid a hazard.

DIMENSIONS

Model	FR-S123N**
Gross / Storage	124L
Weight	Product: 28Kg / Packing: 30Kg
Size (W X D X H)	489.2 X 579.5 X 917.5mm
Voltage / Frequency	220V / 60Hz

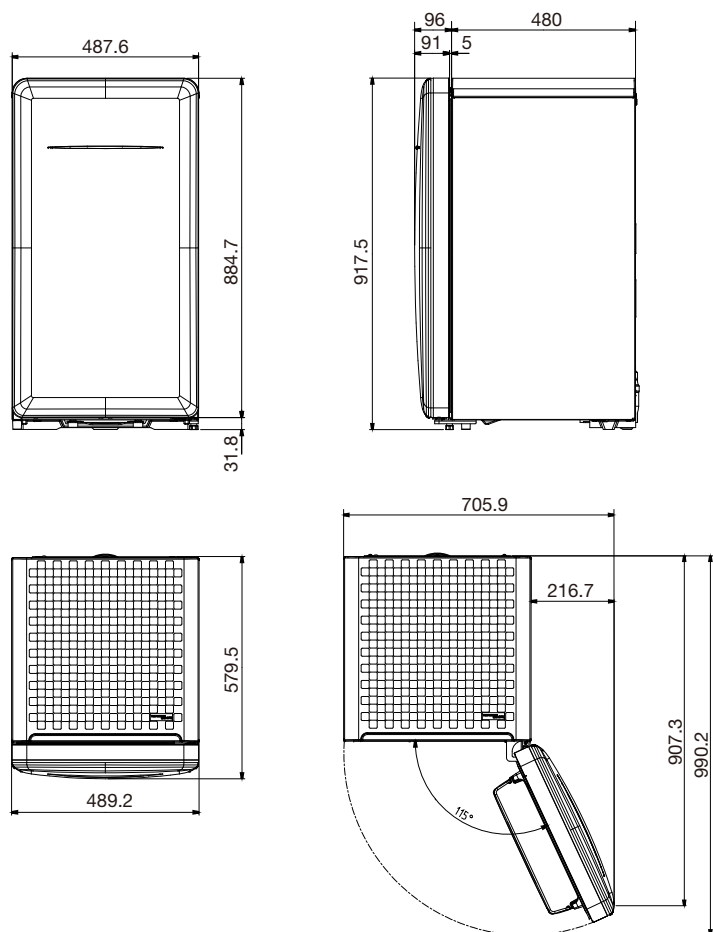

Ambient Room Temperature Limits

This appliance is designed to operate in ambient temperature specified by its temperature class marked on the rating plate.

Temperature Class	Symbol	Range of Ambient Temperature °C
Extended Temperate	SN	+10 to +32
Temperate	N	+16 to +32
Subtropical	ST	+16 to +38
Tropical	T	+16 to +43

NOTE : The internal temperature may be affected by such factors as the location of the appliance, ambient temperature and the frequency with which you open the doors. Adjust the temperature as required to compensate for these factors.

Put the newly introduced food inside.

Most power failures that are corrected in an hour and two will not affect your refrigerator temperatures. However, you should minimize the number of door openings while the power is off. But should the power failure last more than 24hours, remove all frozen food.

When you plan not to operate(during average length vacations), remove all food, disconnect the power cord, clean the interior thoroughly, and leave each door OPEN to prevent door formation.

Option: The keys are kept out of the reach of children and not in the vicinity of the refrigerating appliance, in order to prevent children from being locked inside

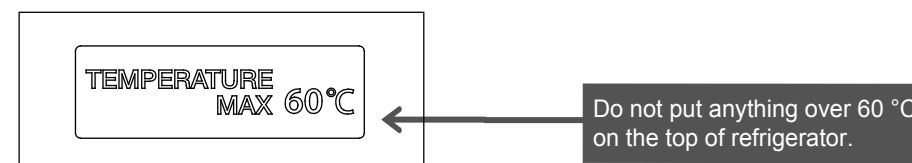



SAFETY WARNING (R-600a Models Only)

This appliance contains a certain amount of isobutane refrigerant (R600a) a natural gas with high environmental compatibility that is, however, also combustible.

when transporting and installing the appliance, care should be taken to ensure that no parts of the refrigerating circuit are damaged.

Refrigerant squirting out of the pipes could ignite or cause an eye injury. If a leak is detected, avoid any naked flames or potential sources of ignition and air the room in which appliance is standing for several minutes.

- In order to avoid the creation of a flammable gas-air mixture if a leak in the refrigerating circuit occurs, the size of the room in which the appliance may be sited depends on the amount of refrigerant used.

The room must be 1m³ in size for every 8g of R600a refrigrant inside the appliance. The amount of refrigerant is shown on the identification plate inside the appliance.

- Never start up an appliance showing any signs of damage. If in doubt, consult your dealer.

Disposal of Used Electrical & Electronic Equipment



The meaning of the symbol on the product, its accessory or packaging indicates that this product shall not be treated as household waste.

Please, dispose of this equipment at your applicable collection point for the Contains fluorinated greenhouse gases covered By the Kyoto Protocol and is hermetically sealed.

By ensuring the correct disposal of this product, you will help prevent potentially hazardous to the environment and to human health, which could otherwise be caused by unsuitable waste handling of this product.

The recycling of materials will help conserve natural resources.

Please do not therefore dispose of your old electrical and electronic equipment with your household waste. For more detailed information about recycling of this product, please contact your local city office, your household waste disposal service or the shop where you purchased the product.



RoHS (Directive 2011/65/EU) Compliant

This product is environmentally sound and sustainable free from Pb, Cd, Cr+6, Hg, PBBs and PBDEs restricted in accordance with the Directive.

Refrigerant Information

Refrigerant	R600a
Charge	0.032kg
Global Warming Potential	1300
Contains fluorinated greenhouse gases covered by the Kyoto Protocol and is hermetically sealed.	
Foam blown with fluorinated greenhouse gases.	

DAEWOO
ELECTRONICS



REFRIGERATOR INSTRUCTION MANUAL

Model No.

FN-153

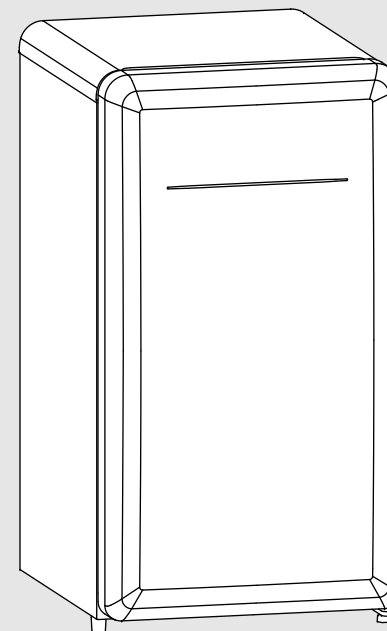

■ Before use, please read this manual carefully.