

# **SNAIGÉ**



**CD350**  
**CD290**  
**CD130**

---

---

---

**Vertical display cooler**

**Instructions for Use**

## SAFETY INSTRUCTIONS

Carefully read the Instruction manual! If instructions are not followed, there is a risk of injury, damage of the appliance and loss of the right to free warranty service. We recommend to keep the Instruction manual the whole time you have the appliance. When you sell the appliance pass the Instruction manual to the new owner of the appliance.

### ⚠ WARNING!

- Do not cover the ventilation holes at the top and on the sides of the appliance.
- Do not use any mechanical means or electrical devices to hasten the thawing process when cleaning the freezer compartment.
- Do not use electrical appliances inside the food storage compartments of the appliance, unless they are of the type recommended by the manufacturer.
- If the supply cord is damaged it must be replaced by the manufacturer, manufacturer service agent or a similarly qualified person, in order to avoid a hazard.
- Disposal of the appliance should be according to national rules.
- Do not damage the appliance refrigeration system. It contains the refrigerant gas R600a. If the refrigeration system is damaged:



- ✓ Do not use any open flame.
  - ✓ Avoid sparks — do not turn on any electrical devices or lighting fixtures.
  - ✓ Immediately ventilate the room.
- The appliance should be used only for storing foodstuffs.
  - This appliance is not designed for the storage of explosive substances such as aerosol cans with a flammable propellant.
  - It is prohibited to store petrol and other flammable liquids near the appliance.

### ⚠ CONNECTION TO THE MAINS

- The appliance should only be connected to an earthed socket installed in accordance with the regulations. Make sure that the supply voltage corresponds with the voltage marked on the rating label. This product complies with all binding CE labelling directives.. The earthed electrical socket by which the appliance is connected to the mains should be in an accessible place.

- IF THE APPLIANCE IS PRODUCED WITH THE SPECIAL SUPPLY CORD IT CAN BE EXCHANGED ONLY BY THE SAME SPECIAL SUPPLY CORD PROVIDED BY THE MANUFACTURER.
  - TO AVOID HAZARDS, DAMAGED POWER SUPPLY CORDS SHOULD ONLY BE REPLACED BY THE MANUFACTURER, A MAINTENANCE TECHNICIAN OR A PERSON WITH AN EQUIVALENT QUALIFICATION.
  - DO NOT USE extension cords or connectors (adapters), or hubs.
  - The frequency and power of the electricity supply must conform to the general data parameters of the appliance as it is shown in the product label.
  - When positioning the appliance be careful that the electrical cord isn't squeezed in order to avoid its damage. Do not store heavy objects such as cooling devices, furniture or other devices next the appliance in such a way that they could squeeze and damage the electrical cord. This can cause a short circuit and a fire.
  - Make sure that the plug of the electrical cord is not squeezed by the back wall of the appliance or otherwise damaged. A damaged plug can be the cause of a fire!
  - **WARNING!** DO NOT OPEN THE COVER OF THE LED ILLUMINATION. In case that LED illumination is used the service representative must be contacted when the LED light is defected.
- If the appliance is unplugged (for cleaning, moving to another place, etc.), it may be repeatedly **SWITCHED ON AFTER 15 MIN.**
  - The appliance can't be disposed of by burning.
  - Do not place any switched on electrical devices (such as microwave ovens, hair dryers, irons, electric kettles or other electrical devices) on top of the appliance because this may cause ignition of plastic parts.
  - Do not place any dishes with liquids on top of the appliance and do not keep flowers in vases or other liquid-filled vessels on the appliance.
  - Do not climb on or sit on the appliance, do not lean on or hang on the appliance doors.
-  IF THE APPLIANCE IS OUT OF ORDER AND IT IS NOT POSSIBLE TO REPAIR IT BY MEANS OF GIVEN RECOMMENDATIONS, UNPLUG IT, OPEN THE DOORS AND CALL THE SERVICE EXPERT. ONLY A SERVICE REPRESENTATIVE CAN REMEDY ALL TECHNICAL OR CONSTRUCTION FAULTS.

## GENERAL INFORMATION

The appliance is a vertical display cooler with glass doors and with a fan and is designed for storage of foodstuffs and for chilling of drinks and for a short-term storage of them.

**This appliance is intended for commercial use!**

THE APPLIANCE IS ECOLOGICALLY CLEAN, CONTAINING NO MATERIALS HARMFUL TO THE OZONE LAYER: the refrigerant used is R600a, the foaming agent used for the appliance insulation is cyclopentane C<sub>5</sub>H<sub>10</sub>.

THE MANUFACTURER GUARANTEES RELIABLE OPERATION OF THE REFRIGERATOR WHEN THE AMBIENT TEMPERATURE IS +16 TO +32 DEGREES CELSIUS AND THE RELATIVE AIR HUMIDITY NOT GREATER THAN 60 PER CENT.

The appliance climate class is **3**. Inside temperature class – **S** (from –2 °C to +14 °C)

### Product data sheet

Model		CD140	CD290-1004, CD290-1008		CD350-1003 CD350-100D	CD350-1004 CD350-100E
Refrigerator total gross volume, L		130	290		350	
Refrigerator net volume, L		127	275		320	
Dimensions (H / W / D), cm		85 / 60 / 60	145 / 60 / 60		173 / 60 / 60	
Shelf area, dm²		43	115		115	
Average air temperature inside the refrigerator, °C		from +7 to +14	from 0 to +10			
Rated current, A		1,0	1,5		1,7	
Weight, kg		32	58		67	
Voltage used		220 - 230V/50HZ				
Rated input, W		100	200		230	
Data according to requirements of standard EN ISO 23953-2:2005						
Product temperature ranges, °C		+8 to +14	from -2 to +14			
Door opening area, m²		0,288	0,66		0,80	
General product exposure area, m²		0,273	0,51		0,62 / 0,58	
Loading of the refrigerator quantity of bottles, pcs.	0,33 l	153 (cans)	270		329	
	0,5 l	62	162		197	
Maximum loading of one shelf, kg		20	50		50	
Energy consumption at ambient temperature +25 °C:		-	At switched on lighting	At switched off lighting	At switched on lighting	At switched off lighting
kWh/24 h		0,652	2,05	2,02	2,14	2,07
kWh/year		238	748	737	781	756
Nominal input of luminaire, W		-	3			

NOTE. The manufacturer reserves the right to make future changes to technical parameters and specifications.

The appliance is a refrigerator **CD350-1313** with glass doors and is designed for storage and chilling of wine. The appliance may be used in cafes, bars and etc.

THE APPLIANCE IS ECOLOGICALLY CLEAN, CONTAINING NO MATERIALS HARMFUL TO THE OZONE LAYER: the refrigerant used is R600a, the foaming agent used for the appliance insulation is cyclopentane C<sub>5</sub>H<sub>10</sub>.

THE MANUFACTURER GUARANTEES RELIABLE OPERATION OF THE REFRIGERATOR WHEN THE AMBIENT TEMPERATURE IS +16 TO +32 DEGREES CELSIUS AND THE RELATIVE AIR HUMIDITY NOT GREATER THAN 70 PER CENT.

The appliance climate class is **N**.

Model	CD350-1313	
Refrigerator total gross volume, L	350	
Refrigerator net volume, L	330	
Dimensions (H x W x D), cm	173 x 60 x 60	
Shelf area, dm <sup>2</sup>	120	
Average air temperature inside the refrigerator, °C	from +4 to +14	
Rated current, A	1,0	
Weight, kg	67	
Voltage used	220 - 230V/50HZ	
Rated input, W	150	
Door opening area, m <sup>2</sup>	0,80	
General product exposure area, m <sup>2</sup>	0,62	
Loading of the refrigerator (quantity of bottles) 0,75 l	105 pcs.	
Maximum loading of one shelf, kg	50	
Energy consumption at ambient temperature +25 °C:  kWh/24 h kWh/year	At switched off lighting	At switched off lighting
	0,930 340	0,880 321
Nominal input of luminaire, W	3	

NOTE. The manufacturer reserves the right to make future changes to technical parameters and specifications.

Temperature in the storage compartment depends on the ambient temperature, on the position of the thermostat knob. Thermostat knob position is set according to the table.

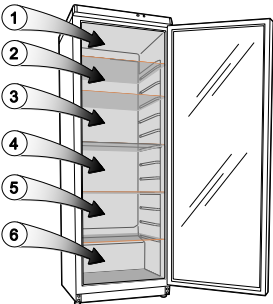

Wine temperature, °C					
Zone designation	Position of the thermostat (ambient temperature +25 °C)				
	1	2	3	4	5
1 zone	12 – 14	12 – 14	12 - 14	10 – 12	8 – 10
2 zone	10 – 12	10 – 12	9 – 11	8 – 10	6 – 8
3 zone	8 – 10	8 – 10	8 – 10	6 – 8	4 – 6
4 zone	8 – 10	8 – 10	6 – 8	4 – 6	4 – 6
5 zone	8 – 10	8 – 10	4 – 6	2 – 4	2 – 4
6 zone	6 – 8	6 – 8	4 – 6	2 – 4	1 – 3

## DESCRIPTION OF THE APPLIANCE, BASIC PARTS (see fig. 1)

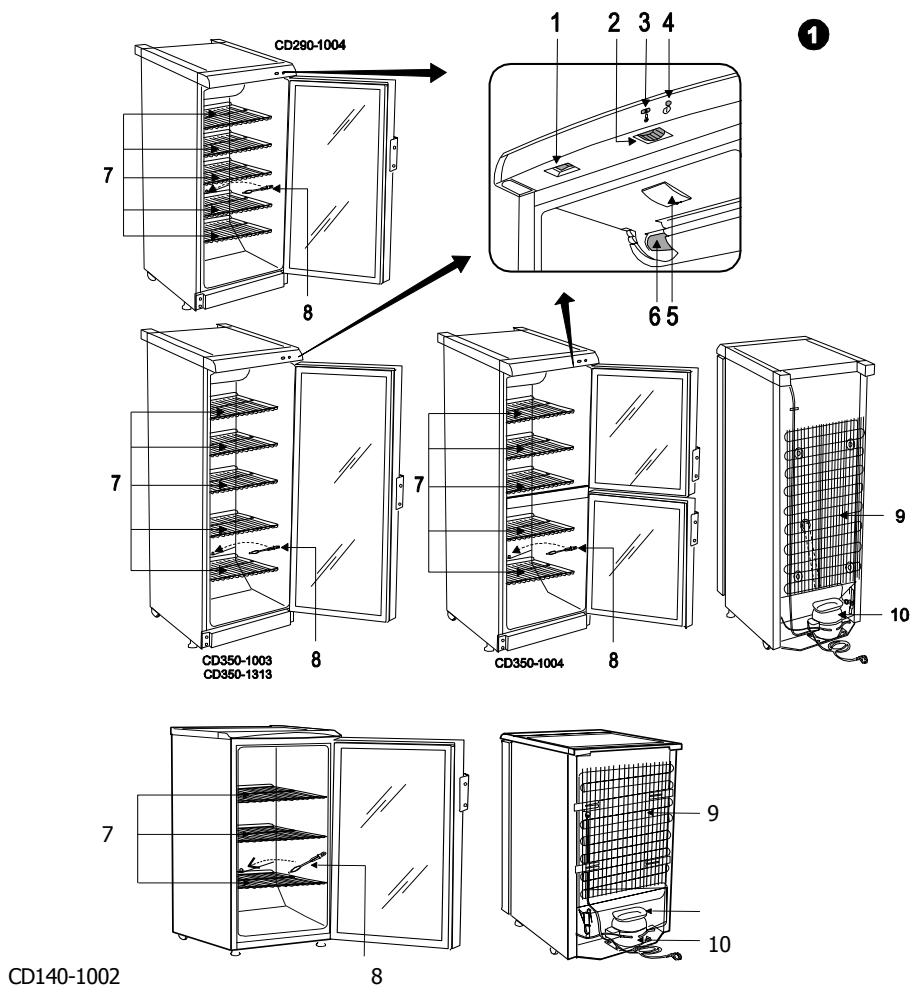

<b>1</b>	Switch -(ON/OFF) (in CD140-no)	<b>6</b>	Fan (in CD140-no)
<b>2</b>	Thermostat knob (in CD140-no)	<b>7</b>	Shelf
<b>3</b>	Thermostat indicator (in CD140-no)	<b>8</b>	Cleaner
<b>4</b>	Electricity supply indicator (in CD140-no)	<b>9</b>	Condenser
<b>5</b>	Interior light block (in CD140-no)	<b>10</b>	Compressor

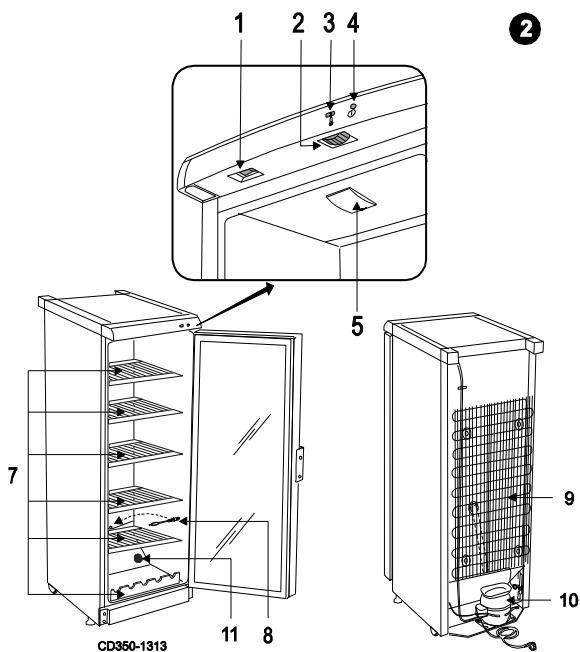

- 1** Switch - (ON/OFF)
- 2** Thermostat knob
- 3** Thermostat indicator
- 4** Electricity supply indicator
- 5** Interior light block
- 6** Fan (in CD350-1313 – no)
- 7** Shelf
- 8** Cleaner
- 9** Condenser
- 10** Compressor
- 11** Carbon filtre (in CD350-1313)

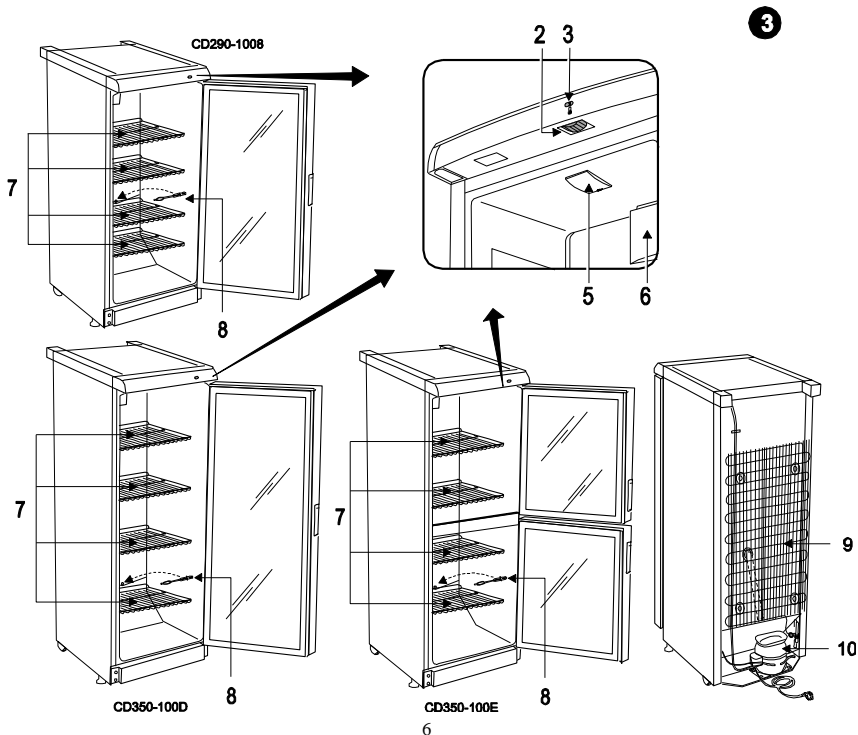

**3**

## REVIEW OF MECHANICAL CONTROL (see fig. 1)

### 1 – On / off switch for interior light.

On / off switch for interior light **I** -(ON) **O** -(OFF)

### 2 – Thermostat knob.

The thermostat is off when there is a zero (**0**) in the thermostat indicator space. Turning the thermostat knob clockwise the temperature in the compartment lowers.

### 3 – Thermostat indicator.

Marked with the symbol  When the door is closed, the temperature setting can be seen on the thermostat indicator display

### 4 – Electricity supply indicator,

marked with the symbol  When the appliance is connected to the electricity supply, the green indicator light is illuminated.

**WARNING!** The fan switches on and continuously operates.

## PREPARING THE APPLIANCE FOR OPERATION

It is recommended to prepare the appliance for operation with a helper.

- Remove package. Lift the appliance away from foamed polystyrene base.
- Therefore take out adhesive tapes from sides and simply lift the appliance up and take out the board. Strip adhesive tapes off and open the door. Remove the spacer above the door.

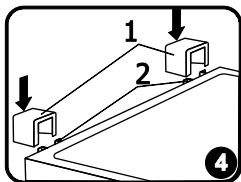

- When positioning the appliance in chosen location, it will move more easily into position if you lift the front a little and incline it backward allowing it to roll on its casters.
- Take two supports from the bag (see fig. 4) and insert them into the guides at the top back part of the appliance.
- If the appliance is brought in from the cold (temperature is not higher than +12 °C), **you should wait for two hours before connecting it to the mains.**



The appliance **should not be connected** to the mains until all packing and transport materials aren't removed. Suitably dispose the packaging material

## POSITIONING

- Place the appliance in a dry, well ventilated room.



**WARNING!** The appliance should not be operated in an unheated room or porch. Place the appliance away from heat sources such as kitchen stove/oven, radiators, or direct sunlight.



**WARNING!** The appliance must not touch any pipes for heating, gas or water supply or any other electrical devices.

- Do not cover the ventilation holes at the top of the appliances – it must be a good air circulation around the appliance. There should be a gap of at least 10 cm between the top of the appliance body and any furniture that may be above it. If this requirement is not followed, the appliance consumes more electrical energy and its compressor may overheat.



- If the appliance is placed in a corner, a gap of at least 1 cm must be left between the appliance body and the wall (see fig.).
- The appliance must stand on a level surface and must not touch the wall. If necessary, regulate the height of the appliance by adjusting the levelling feet: by turning them clockwise – the front of the appliance rises, by turning them counter clockwise – it comes down. If the appliance is tilted slightly backward – the doors will close by themselves.

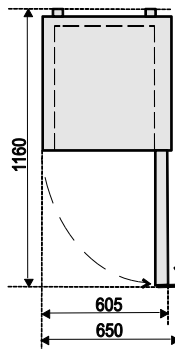

## TEMPERATURE REGULATION

The temperature in the refrigerator compartment is controlled using the thermostat knob **2** (see fig. 1) by turning it to one side or the other. The temperature indication in digits is shown beside the thermostat knob. When the door is closed, the temperature setting can be seen on the thermostat indicator display **3** (fig. 1).

The temperature is regulated on the scale of five digits.

**0** = Compressor is switched off. **WARNING! Electric current is not switched off.**

**1** = highest temperature (lowest cooling)

**5** = lowest temperature (highest cooling)

If foodstuffs in the refrigerator compartment are too cold, set the thermostat knob to **1**, **2** or **3**. If foodstuffs in the refrigerator compartment are not being chilled sufficiently, set the thermostat knob to **4** or **5**. Please set the desired temperature in the appliance according to your own requirements!



THE TEMPERATURE IN THE REFRIGERATOR COMPARTMENT MAY VARY DEPENDING ON AMBIENT TEMPERATURE, THE AMOUNT OF FOODSTUFFS, THE TEMPERATURE OF THE FOODSTUFFS, AND HOW OFTEN THE APPLIANCE DOORS ARE OPENED AND CLOSED.



IF THE ROOM IS COOL, THE APPLIANCE COOLS LESS. THE TEMPERATURE IN THE APPLIANCE MAY THEREFORE RISE. Use the thermostat wheel to set a lower temperature.

## DEFROSTING

The refrigerator compartment defrosts automatically. Drops of ice that form on the back wall of the refrigerator compartment thaw during the time the compressor is not working and the thaw water runs down the thaw water runoff channel to the tray on top of the compressor, where it evaporates.

# CLEANING AND CARE

REGULARLY CLEAN THE APPLIANCE.

**!** Remember that before cleaning you must disconnect the appliance from the electrical energy supply socket by pulling the plug out of the electricity outlet.

- Protect the appliance inner surfaces and plastic parts from fats, acids and sauces. In case of accidental spills – immediately clean with warm soapy water or dishwashing detergent. Wipe dry.
- Clean the appliance inner surfaces with warm soapy water. Dishwashing detergent may also be used.

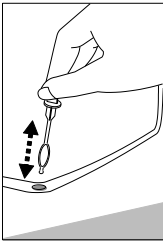

- Regularly clean the hermetic gaskets of the doors. Wipe dry.
  - REGULARLY CLEAN THE THAW WATER CHANNEL SPACE WITH A SPECIAL CLEANER **8** FOR THAT PURPOSE (Fig. 1).
  - At least once a year clean dust away from the back part of the appliance body and the compressor. A soft brush, electrostatic cloth or vacuum cleaner may be used for cleaning.
  - DO NOT use detergents containing abrasive particles, acid, alcohol or benzene for cleaning the appliance inner and outer surfaces.
  - DO NOT use for cleaning cloths or sponges that have coarse surfaces intended for scrubbing.
- IF THE APPLIANCE IS TO BE LEFT SWITCHED OFF FOR AN EXTENDED PERIOD, LEAVE ITS DOORS OPEN.
- Outer of the doors – glass – clean with agents intended for glass cleaning.



**Remarks on the appliance operating noise.** As the appliance operates and goes through the freezing cycle, various noises will be emitted. This is normal and is not a sign of any malfunction.

- As the refrigerant circulates around the refrigeration system, it causes sounds like murmuring, bubbling, or rustling.
- Louder sounds like popping or clicking may be heard for a short time as the refrigerator compressor switches on.

## Operation problems and their solutions (troubleshooting)

What if ...

- **The appliance is plugged in to the mains but it does not work and the electricity supply voltage indicator is not illuminated.** Check that your house electricity supply installations are in order. Check that the plug is correctly inserted into the electricity supply socket.
- **The noise has become louder.** Check that the appliance is standing stable, on a level place. To make it level, regulate the front feet. Check if the appliance is not touching any furniture, and that no part of the refrigeration system at the back part of the appliance body is touching the wall. Pull the appliance away from any furniture or walls. Check that the cause of increased noise isn't due to bottles, cans or dishes in the appliance that might be touching each other.

- **Water has appeared at the bottom of the refrigerator compartment.** Check whether a thaw water channel space isn't blocked. Clean the thaw water channel space with a cleaner intended for that purpose.
- **Water has appeared under the appliance.** The thaw water collection tray has slipped off the compressor. Place the tray on top of the compressor.
- **When the appliance door is opened, the rubber sealing gasket pulls out.** The gasket is smeared with sticky foodstuffs (fat, syrup). Clean the sealing gasket and the groove for it with warm water containing soap or dishwashing detergent and wipe dry. Put the rubber sealing gasket back into the place.
- **High temperature in appliance, the compressor operation pauses are short.** Ascertain whether the appliance door/doors are shutting tightly, whether the door wasn't kept open longer than necessary when taking out or putting in foodstuffs or whether a large amount of warm food was placed in the appliance.
- **The top of the appliance has condensation on it.** The ambient relative air humidity is above 60 %. Ventilate the room where the appliance stands and if possible remove the cause of the humidity.

## TRANSPORT



THE MANUFACTURER WILL NOT BE RESPONSIBLE FOR ANY DAMAGE OF THE APPLIANCE THAT RESULTS FROM NON-COMPLIANCE WITH THE INSTRUCTIONS FOR TRANSPORTATION.

- The appliance should be transported only in the vertical position.
- When being transported, the appliance should be protected from atmospheric conditions (rain, snow, dampness).
- The appliance should be firmly secured in place while being transported, to avoid slippage or any shocks in the transport vehicle.
- **If the appliance was transported not vertically, it may be connected to the mains after 4 hours at least. If this is not done, the appliance compressor may fail.**

## ENVIRONMENTAL PROTECTION INFORMATION



This symbol indicates that once the appliance is no longer needed, it cannot be disposed together with other miscellaneous municipal waste. It should be collected and eliminated separately, i.e. in containers specially marked with this symbol in large-dimension rubbish collection areas. Full information on where to submit the old appliance safely can be obtained from local government authorities, the shop where you bought the appliance or the manufacturer's representatives.

If you decided to scrap the appliance, make it impossible to use in order to prevent possible misadventure. Pull out the electric plug from the electricity supply socket and then cut off the cord. Tear off the gasket. Break the door lock if any.

**WARNING! Do not dismantle the appliance yourself. Pass it on to recycling companies.**

## **WARRANTY SERVICE**

IF YOUR APPLIANCE IS NOT WORKING PROPERLY, ASCERTAIN WHETHER YOU CAN REMEDY THE CAUSE OF THE FAULTY FUNCTIONING OF THE APPLIANCE YOURSELF. If you cannot solve the problem yourself, contact the nearest refrigerator service representative by telephone or in writing. When making contact necessarily indicate the refrigerator model and number. You will find this data on the product label, which is glued to the wall.