

SNAIGĒ

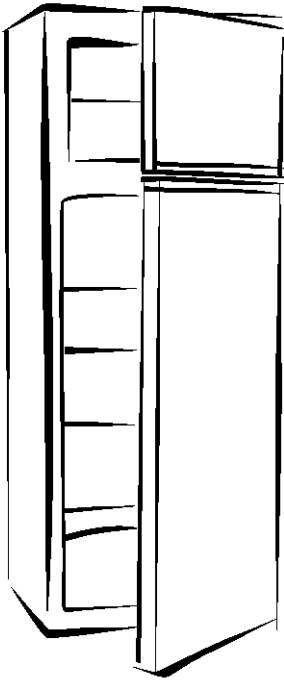

FR240

FR275

Refrigerator-freezer with freezer top

Instructions for Use

SAFETY INSTRUCTIONS

CAREFULLY READ THE INSTRUCTION MANUAL. If instructions are not followed, there is a risk of injury, damage of the appliance and loss of the right to free warranty service. We recommend to keep the Instruction manual the whole time you have the appliance. When you sell the appliance pass the Instruction manual to the new owner of the appliance.

! WARNING!

- Do not cover the ventilation holes at the top and on the sides of the appliance.
- Do not use any mechanical means or electrical devices to hasten the thawing process when cleaning the freezer compartment.
- Do not use electrical appliances inside the food storage compartments of the appliance, unless they are of the type recommended by the manufacturer.
- If the supply cord is damaged it must be replaced by the manufacturer, manufacturer service agent or a similarly qualified person, in order to avoid a hazard.
- Disposal of the appliance should be according to national rules.
- Do not damage the appliance refrigeration system. It contains the refrigerant gas R600a. If the refrigeration system is damaged:



- Do not use any open flame.
- Avoid sparks—do not turn on any electrical appliances or lighting fixtures.
- Immediately ventilate the room.
- Do not allow children to play with the appliance or to plug it in or unplug from the electricity supply socket. Do not allow children to play with the packaging material from the appliance.
- This appliance can be used by children aged from 8 years and above and persons with reduced physical, sensory or mental capabilities or lack of experience and knowledge if they have been given supervision or instruction concerning use of the appliance in a safe way and understand the hazards involved.
- Cleaning and user maintenance shall not be made by children without supervision.
- The appliance should be used only for freezing and storing foodstuffs.
- This appliance is not designed for the storage of explosive substances such as aerosol cans with a flammable propellant.
- It is prohibited to store petrol and other flammable liquids near the appliance.

❗ CONNECTION TO THE MAINS

- The appliance should only be connected to an earthed socket installed in accordance with the regulations. Make sure that the supply voltage corresponds with the voltage marked on the rating label. This product complies with all binding CE labelling directives.. The earthed electrical socket by which the appliance is connected to the mains should be in an accessible place.
- IF THE APPLIANCE IS PRODUCED WITH THE SPECIAL SUPPLY CORD IT CAN BE EXCHANGED ONLY BY THE SAME SPECIAL SUPPLY CORD PROVIDED BY THE MANUFACTURER.
- TO AVOID HAZARDS, DAMAGED POWER SUPPLY CORDS SHOULD ONLY BE REPLACED BY THE MANUFACTURER, A MAINTENANCE TECHNICIAN OR A PERSON WITH AN EQUIVALENT QUALIFICATION.
- DO NOT USE extension cords or connectors (adapters), or hubs.
- When positioning the appliance, be careful that the electrical cord isn't squeezed in order to avoid its damage. Do not store heavy objects such as cooling devices, furniture or other domestic devices next the appliance in such a way that they could squeeze and damage the electrical cord. This can cause a short circuit and a fire.
- Make sure that the plug of the electrical cord is not squeezed by the back wall of the appliance or otherwise damaged. A damaged plug can be the cause of a fire!
- If the appliance is unplugged (for cleaning, moving to another place, etc.), it may be repeatedly switched ON AFTER 15 MIN.
- It is forbidden to use a technically damaged appliance.
- The appliance can't be disposed of by burning.
- Do not place any switched on electrical devices (such as microwave ovens, hair dryers, irons, electric kettles or other electrical devices) on top of the appliance because this may cause ignition of plastic parts.
- Do not place any dishes with liquids on top of the appliance and do not keep flowers in vases or other liquid-filled vessels on the appliance.
- Do not climb on or sit on the appliance, do not lean on or hang on the appliance doors and do not allow children to do this.



IF THE APPLIANCE IS OUT OF ORDER AND IT IS NOT POSSIBLE TO REPAIR IT BY MEANS OF GIVEN RECOMMENDATIONS, UNPLUG IT, OPEN THE DOORS AND CALL THE SERVICE EXPERT. ONLY A SERVICE REPRESENTATIVE CAN REMEDY ALL TECHNICAL OR CONSTRUCTION FAULTS.

ENVIRONMENTAL PROTECTION INFORMATION



This symbol indicates that once the appliance is no longer needed, it cannot be disposed together with other miscellaneous municipal waste. It should be collected and eliminated separately, i.e. in containers specially marked with this symbol in large-dimension rubbish collection areas. Full information on where to submit the old appliance safety can be obtained from local government authorities, the shop where you bought the appliance or the manufacturer's representatives.

If you decided to scrap the appliance, make it impossible to use in order to prevent possible misadventure. Pull out the electric plug from the electricity supply socket and then cut off the cord. Tear off the gasket. Break the door lock if any.

WARNING! Do not dismantle the appliance yourself. Pass it on to recycling companies.

GENERAL INFORMATION

The appliance is a two-compartment refrigerator-freezer combination. The refrigerator compartment is intended for short-term storage of fresh foodstuffs; the freezer compartment is intended for freezing and long-term storage of foodstuffs.

THE APPLIANCE IS ECOLOGICALLY CLEAN, CONTAINING NO MATERIALS HARMFUL TO THE OZONE LAYER: the refrigerant used is R600a, the foaming agent used for the appliance insulation is cyclopentane C_5H_{10} .



THE MANUFACTURER GUARANTEES RELIABLE OPERATION OF THE REFRIGERATOR WHEN THE RELATIVE AIR HUMIDITY NOT GREATER THAN 70 PER CENT AND THE AMBIENT TEMPERATURE IS:

- +16 TO +32 DEGREES CELSIUS - the appliance climate class is **N**;
- +16 TO +38 DEGREES CELSIUS - the appliance climate class is **ST**;
- +16 TO +43 DEGREES CELSIUS - the appliance climate class is **T**.

Product data sheet

Model	FR275		FR240	
Category ¹⁾	7 - Refrigerator-freezer			
Energy efficiency class ²⁾	A++	A+	A++	A+
Annual energy consumption ³⁾ , kWh/in year	197	230	173	211
Actual consumption will depend on how the appliance is used and where it is located				
Fridge net volume , L	201		166	
**** Freezer net volume , L	57		46	
Frost-free : refrigeration unit	yes			
Frost-free : freezer unit	no			
Freezing capacity, kg/24h	3		2	
Power cut safe, h	17			
Climate class ⁵⁾	N - T	N	N - ST	N
Dimensions (H/W/D), cm	169 / 56 / 63	169 / 56 / 60	144 / 56 / 63	144 / 56/ 60
Noise level, dB(A) re 1pw	39			
Construction	Freestanding			
Electrical Data	see in the product label			

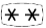
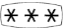
NOTE. The manufacturer reserves the right to make future changes to technical parameters and specifications.

- ¹⁾ 1 = Refrigerator with one or more fresh-food storage compartments,
2 = Refrigerator-cellar, Cellar and Wine storage appliances,
3 = Refrigerator-chiller and Refrigerator with a 0-star compartment,
4 = Refrigerator with a one-star compartment, 5 = Refrigerator with a two-star compartment,
6 = Refrigerator with a three-star compartment, 7 = Refrigerator-freezer,
8 = Upright freezer, 9 = Chest freezer, 10 = Multi-use and other refrigerating appliances
- ²⁾ A+++ (most efficient) to D (least efficient)
- ³⁾ Annual energy consumption (AE C) in kWh per year, based on standard test results for 24 hours.
Actual energy consumption will depend on how the appliance is used and where it is located.
- 4) 1  One-star compartment with nominal temperature of -6°C
2  Two-star compartment with nominal temperature of -12°C
3  Three-star compartment with nominal temperature of -18°C
4  Food freezer compartment (four-star compartment) with nominal temperature of -18°C
- ⁵⁾ Climate class: This appliance is intended to be used at an ambient temperature between lowest and highest temperature: SN = 10°C-32°C, N = 16°C-32°C, ST = 16°C-38°C, T = 16°C-43°C

DESCRIPTION OF THE APPLIANCE, BASIC PARTS (Fig. 1)

 THE APPLIANCE ACCESSORIES LISTED BELOW MAY DIFFER FROM THE ACCESSORIES OF THE APPLIANCE YOU HAVE BOUGHT IN QUANTITY AND IN DESIGN. This description is adapted for entire group of refrigerator-freezer combinations.*

A – refrigerator compartment

B – freezer compartment

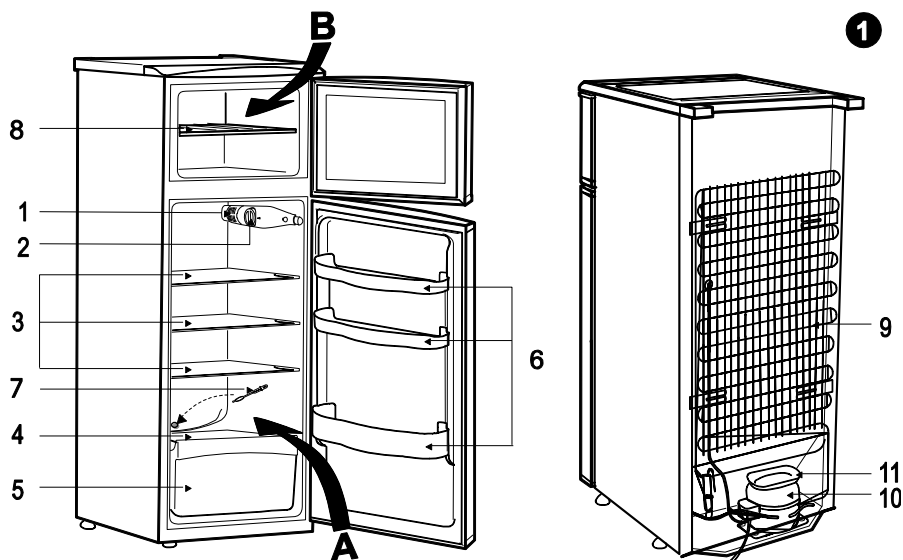

1 Interior light block

2 Thermostat knob

3 Adjustable height shelves*

4 Glass shelf

5 Drawer for vegetables and fruits

6 Door trays

7 Thaw water channel cleaner

8 Wire shelf

9 Condenser

10 Compressor

11 Thaw water drip tray

PREPARING THE APPLIANCE FOR OPERATION

It is recommended to prepare the appliance for operation with a helper.

- Remove package. Lift the appliance away from foamed polystyrene base. Tear off adhesive tapes.
- Remove all red-coloured parts from the shelves (fig. 2). Tear away the red-coloured adhesive tapes from the door trays – they are intended only for the transport of the appliance.
- Take two supports from the bag (fig. 3) and insert them into the guides at the top back part of the appliance.
- If the appliance is brought in from the cold (temperature is not higher than +12 °C), **you should wait for two hours before connecting it to the mains.**



The appliance **should not be connected** to the mains until all packing and transport materials aren't removed. Suitably dispose the packaging material.

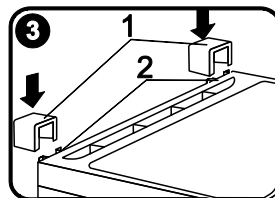
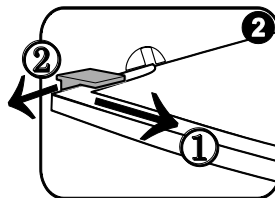

POSITIONING

- Place the appliance in a dry, well ventilated room.



WARNING! The appliance should not be operated in an unheated room or porch. Place the appliance away from heat sources such as kitchen stove/oven, radiators, or direct sunlight.



WARNING! The appliance must not touch any pipes for heating, gas or water supply, or any other electrical devices.

- Do not cover the ventilation holes at the top of the appliances—it must be a good air circulation around the appliance. There should be a gap of at least 10 cm between the top of the appliance body and any furniture that may be above it (fig. 4). If this requirement is not followed, the appliance consumes more electrical energy and its compressor may overheat.

- If the appliance is placed in a corner, a gap of at least 1 cm must be left between the appliance body and the wall so that the door can be opened enough to pull out the drawer for vegetables and fruits (fig. 5).

- The appliance must stand on a level surface and must not touch the wall. If necessary, regulate the height of the appliance by adjusting the levelling feet: by turning them clockwise – the front of the appliance rises, by turning them counter clockwise – it comes down. If the appliance is tilted slightly backward – the doors will close by themselves.

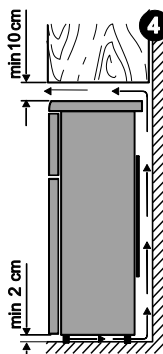
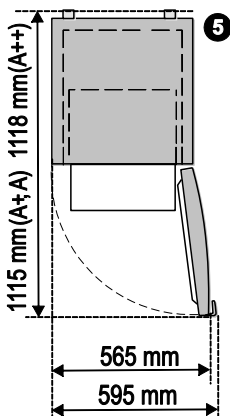

TEMPERATURE REGULATION

The temperature in the refrigerator compartment is controlled using the thermostat knob **2** (fig. 1) by turning it to one side or the other. The temperature indication in digits is shown beside the thermostat knob **2**.

The temperature is regulated on a scale of seven digits.

0 = Compressor is switched off. WARNING! Electric current is not switched off.

1 = highest temperature (lowest cooling)

7 = lowest temperature (highest cooling)

If foodstuffs in the refrigerator compartment are too cold, set the thermostat knob to **1**, **2** or **3**. If foodstuffs in the refrigerator compartment are not being chilled sufficiently, set the thermostat knob to **4**, **5** or **6**. Please set the desired temperature in the appliance according to your own requirements.



THE TEMPERATURE IN THE REFRIGERATOR COMPARTMENT MAY VARY DEPENDING ON AMBIENT TEMPERATURE, THE AMOUNT OF FOODSTUFFS, THE TEMPERATURE OF THE FOODSTUFFS, AND HOW OFTEN THE APPLIANCE DOORS ARE OPENED AND CLOSED. Therefore we recommend:

- locate the appliance away from heat sources,
- **do not put hot foodstuffs in the refrigerator compartment – they must be cooled down to room temperature,**
- appliance door must not to be left open,
- the appliance door should not be open longer than it is necessary to take out or put in foodstuffs..



IF THE ROOM IS COOL, THE APPLIANCE COOLS LESS. THE TEMPERATURE IN THE APPLIANCE MAY THEREFORE RISE. Use the thermostat wheel to set a lower temperature.

FREEZING OF FOODSTUFFS IN THE FREEZER COMPARTMENT ***

The thermostat knob should be set to **7**. Fresh foodstuffs prepared for freezing and cooled to room temperature should be placed in one layer at the bottom of the freezer. After 24 hours, move the frozen foodstuffs onto the wire shelf **8** (see illustration 1). When the products are frozen, the thermostat wheel should be **set at its earlier position**.

- DO NOT EXCEED THE MAXIMUM AMOUNT OF FROZEN FOOD INDICATED IN THE PRODUCTS DATA SHEET.
- Leave a gap of not less than 3 cm between the foodstuffs being frozen and the upper partition.
- Do not place unwrapped foodstuffs in the freezer sections.
- Fresh food for freezing should not touch already frozen foodstuffs.
- Do not freeze foodstuffs that are warmer than the room temperature.
- **Do not freeze liquid foodstuffs in glass vessels or bottles. Do not freeze carbonated beverages.**
- Strictly observe the frozen foodstuffs validity dates indicated by the manufacturer on the their packaging.

- WE RECOMMEND THAT FROZEN FISH AND SAUSAGE SHOULD BE STORED IN THE FREEZER COMPARTMENT NOT LONGER THAN 6 MONTHS; CHEESE, POULTRY, PORK, LAMB – NOT MORE THAN 8 MONTHS; BEEF, FRUIT AND VEGETABLES – NOT LONGER THAN 12 MONTHS.

DEFROSTING

THE REFRIGERATOR COMPARTMENT defrosts automatically. Drops of ice that form on the back wall of the refrigerator compartment thaw during the time the compressor is not working and the thaw water runs down the thaw water runoff channel to the tray on top of the compressor (Fig. 1), where it evaporates.

FREEZER COMPARTMENT should be thawed not less than twice a year or when a layer of ice thicker than 5 mm forms in it. Do the actions below in the order they are listed:

WARNING! Turn the appliance off and pull the plug out of the electrical socket.

- Remove foodstuffs from freezer compartment. The frozen foodstuffs will not warm up too much while you are thawing the freezer compartment if you cover them with a thick cloth and keep them in a cool place.
- Leave door of appliance open. When the ice melts, clean and wipe dry the surfaces and fixtures of the refrigerator and freezer compartments.
- Close the appliance door. Plug in and turn on the appliance.

CLEANING AND CARE

REGULARLY CLEAN THE APPLIANCE.



Remember that before defrosting the appliance and cleaning the back part of the appliance body you must disconnect the appliance from the electrical energy supply socket by pulling the plug out of the electricity outlet.

- Protect the appliance inner surfaces and plastic parts from fats, acids and sauces. In case of accidental spills – immediately clean with warm soapy water or dishwashing detergent. Wipe dry.
- Clean the appliance inner surfaces with warm soapy water. Dishwashing detergent may also be used.
- Wipe dry inner and outer surfaces.
- Regularly clean the hermetic gaskets of the doors. Wipe dry.

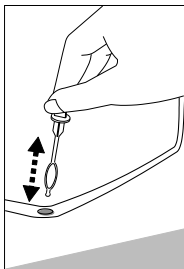

- ◀REGULARLY CLEAN THE THAW WATER CHANNEL SPACE IN THE REFRIGERATOR WITH A SPECIAL CLEANER FOR THAT PURPOSE (see fig.).
- At least once a year clean dust away from the back part of the appliance body and the compressor. A soft brush, electrostatic cloth or vacuum cleaner may be used for cleaning (see fig.).
- DO NOT use detergents containing abrasive particles, acid, alcohol or benzene for cleaning the appliance inner and outer surfaces.
- DO NOT use for cleaning cloths or sponges that have coarse surfaces intended for scrubbing.

PRACTICAL TIPS AND OBSERVATIONS

- Strictly observe the foodstuff validity time indicated by the manufacturer on the product packaging.
- Do not keep bananas in the refrigerator – these fruits are sensitive to cold.
- Do not keep prepared food and ready-to-cook ("heat and eat") food in the same container.
- Store in an airtight container in the appliance any foodstuffs that have a strong odour (e.g. fresh fish, pâté de foie gras goose liver pâté, and cheese).
- Frozen foodstuffs should be thawed in the refrigerator compartment. Food that thaws slowly retains better flavour properties and spread cold will help to maintain the set temperature in the refrigerator compartment.
- Do not consume ice made in the freezer compartment straight away.
- Products will freeze more quickly if they are divided up and packed in small portions.
- IF THE APPLIANCE IS TO BE LEFT SWITCHED OFF FOR AN EXTENDED PERIOD, LEAVE ITS DOORS OPEN.



Remarks on the appliance operating noise. As the appliance operates and goes through the freezing cycle, various noises will be emitted. This is normal and is not a sign of any malfunction.

- As the refrigerant circulates around the refrigeration system, it causes sounds like murmuring, bubbling, or rustling. Louder sounds like popping or clicking may be heard for a short time as the refrigerator's compressor switches on.

CHANGING THE INTERIOR LIGHT BULB

When changing the interior light bulb (fig. 6), do the actions below in the order they are listed:

1. **Unplug the appliance from the mains by pulling the plug out of the electricity supply socket.**
2. Push the interior light bulb lid **4** retainer **5** with a flat screwdriver and with your other hand pull it toward yourself.
3. If the bulb does not light up, replace it with another 15 W bulb of the same type with an E14 lamp holder.
4. When you have changed the light bulb, replace the lid **4** and push — the lid will snap into position.
5. Plug the appliance into the electricity supply socket.

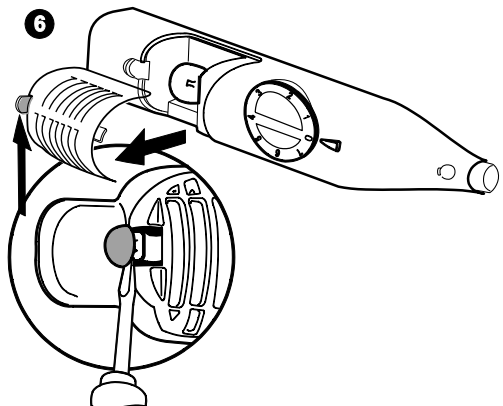

CHANGING THE OPENING DIRECTION OF THE DOORS

It is recommended that changing the opening direction of the doors should be done with a helper. You will need two spanners No. 8 and No. 10 and a Philips head screwdriver.

 When changing the opening direction of the doors YOU CAN NOT lay the refrigerator horizontally!

Do the actions below in the order they are listed :

WARNING! Turn off the appliance and pull the plug out of the electricity supply socket.

1. Unscrew fixing screws **2** and **3** and remove the top table.

2. Unscrew and remove the upper door bracket **5**, unscrew the axle together with the nut and washers and screw all this set on the reverse bracket side.

3. Remove the upper door **6**. Unscrew fixing screws **7** of the middle bracket.

4. Remove the middle bracket together with washers on the axle and the spacer.

5. Remove the bottom door **8**. Unscrew and remove the bottom bracket **9**, unscrew the axle, upturn the bracket and the axle and screw them on the reverse side. Screw and fix the bottom bracket.

6. Remove the plug **10** from the upper door and the plug **10** from the bottom door and place them on the reverse side.

7. Remove the plugs **11** from the crossbar and place them on the reverse side.

8. Hang the bottom door **13** on the axle **15** of the bottom bracket **14**.

9. Before screwing the middle bracket **7** together with the set of washers and spacers on the reverse side, insert the bracket axle into the bottom door.

10. Hang the upper door **8** on the axle of the middle bracket **9**.

11. Before screwing the upper bracket **5** together with the set of washers and spacers, insert the axle of the bracket into the upper door **7**. Put the top table and fix it with screws **2** and **3**.

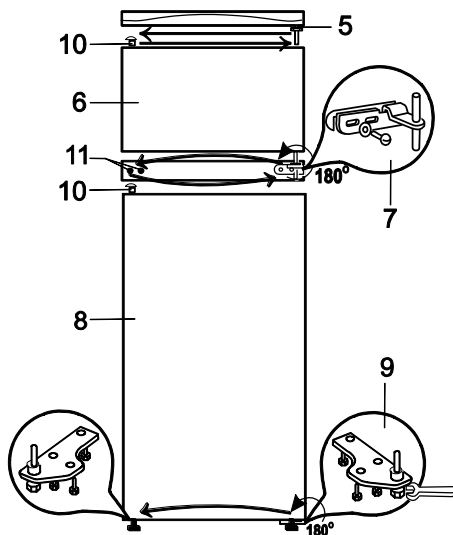
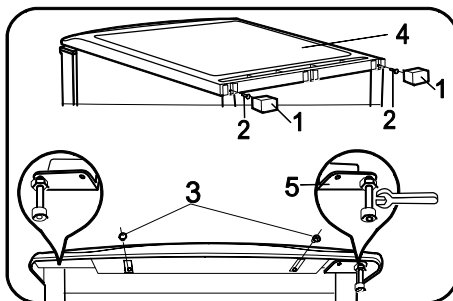

OPERATION PROBLEMS AND THEIR SOLUTIONS (TROUBLESHOOTING)

What if...

- **The appliance is plugged in to the mains but it does not work and.** Check that your house electricity supply installations are in order. Check that the plug is correctly inserted into the electricity supply socket.
- **The noise has become louder.** Check that the appliance is standing stable on a level place. To make it level, regulate the front feet. Check if the appliance is not touching any furniture and that no part of the refrigeration system at the back part of the appliance body is touching the wall. Pull the appliance away from any furniture or walls. Check that the cause of increased noise isn't due to bottles, cans or dishes in the appliance that might be touching each other.
- **Water has appeared at the bottom of the refrigerator compartment.** Check whether a thaw water channel space isn't blocked. Clean the thaw water channel space with a cleaner intended for that purpose.
- **Water has appeared on the tempered glass shelves.** Food items or dishes in the refrigerator compartment are touching the back wall of the compartment. Do not let food items or dishes touch the back wall.
- **Moisture dripping from under the glass shelves.** If you placed many containers with liquids on the shelf, moisture can condense and drip onto the shelf below. Move some containers with liquids onto other shelves.
- **Water has appeared under the appliance.** The thaw water collection tray has slipped off the compressor. Place the tray on top of the compressor.
- **When the appliance door is opened, the rubber sealing gasket pulls out.** The gasket is smeared with sticky foodstuffs (fat, syrup). Clean the sealing gasket and the groove for it with warm water containing soap or dishwashing detergent and wipe dry. Put the rubber sealing gasket back into the place.
- **High temperature in appliance, the compressor operation pauses are short.** Ascertain whether the appliance doors are shutting tightly, whether the door wasn't kept open longer than necessary when taking out or putting in foodstuffs or whether a large amount of warm food was placed in the appliance.
- **The top of the appliance has condensation on it.** The ambient relative air humidity is above 70 %. Ventilate the room where the appliance stands and if possible remove the cause of the humidity.

TRANSPORT



THE MANUFACTURER WILL NOT BE RESPONSIBLE FOR ANY DAMAGE OF THE APPLIANCE THAT RESULTS FROM NON-COMPLIANCE WITH THE INSTRUCTIONS FOR TRANSPORTATION.

- The appliance should be transported in the vertical position.
- When being transported, the appliance should be protected from atmospheric conditions (rain, snow, dampness).
- The appliance should be firmly secured in place while being transported, to avoid slippage or any shocks in the transport vehicle.
- **If the appliance was transported not vertically, it may be connected to the mains after 4 hours at least. If this is not done, the appliance compressor may fail.**

WARRANTY SERVICE

IF YOUR APPLIANCE IS NOT WORKING PROPERLY, ASCERTAIN WHETHER YOU CAN REMEDY THE CAUSE OF THE FAULTY FUNCTIONING OF THE APPLIANCE YOURSELF. If you cannot solve the problem yourself, contact the nearest refrigerator service representative by telephone or in writing. When making contact, necessarily indicate the refrigerator model and number. You will find this data on the product label, which is glued to the left wall of the refrigerator compartment near the fruit and vegetable trays.