

SNAIGĒ
ICE LOGIC

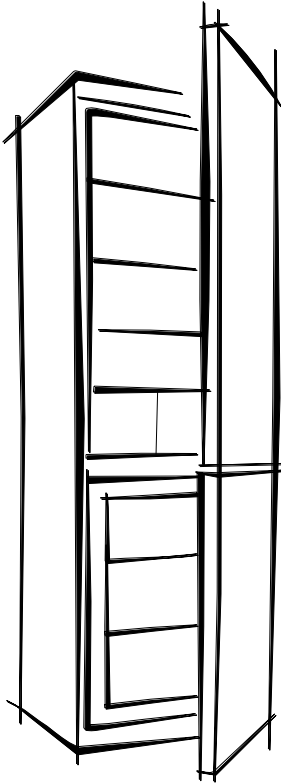

RF27SM

RF31SM

RF32SM

RF34SM

RF35SM

RF36SM

RF39SM

Refrigerator - freezer combination

Instructions for Use

SAFETY INSTRUCTIONS

CAREFULLY READ THE INSTRUCTION MANUAL. If instructions are not followed, there is a risk of injury, damage of the appliance and loss of the right to free warranty service. We recommend to keep the Instruction manual the whole time you have the appliance. When you sell the appliance pass the Instruction manual to the new owner of the appliance.

! WARNING!

- Do not cover the ventilation holes at the top and on the sides of the appliance.
- Do not use any mechanical means or electrical devices to hasten the thawing process when cleaning the freezer compartment.
- Do not use electrical appliances inside the food storage compartments of the appliance, unless they are of the type recommended by the manufacturer.
- If the supply cord is damaged it must be replaced by the manufacturer, manufacturer service agent or a similarly qualified person, in order to avoid a hazard.
- Disposal of the appliance should be according to national rules.
- Do not damage the appliance refrigeration system. It contains the refrigerant gas R600a. If the refrigeration system is damaged:



- Do not use any open flame.
- Avoid sparks—do not turn on any electrical appliances or lighting fixtures.
- Immediately ventilate the room.
- Do not allow children to play with the appliance or to plug it in or unplug from the electricity supply socket. Do not allow children to play with the packaging material from the appliance.
- This appliance can be used by children aged from 8 years and above and persons with reduced physical, sensory or mental capabilities or lack of experience and knowledge if they have been given supervision or instruction concerning use of the appliance in a safe way and understand the hazards involved.
- Cleaning and user maintenance shall not be made by children without supervision.
- The appliance should be used only for freezing and storing foodstuffs.
- This appliance is not designed for the storage of explosive substances such as aerosol cans with a flammable propellant.
- It is prohibited to store petrol and other flammable liquids near the appliance.

❗ CONNECTION TO THE MAINS

- The appliance should only be connected to an earthed socket installed in accordance with the regulations. Make sure that the supply voltage corresponds with the voltage marked on the rating label. This product complies with all binding CE labelling directives.. The earthed electrical socket by which the appliance is connected to the mains should be in an accessible place.
- IF THE APPLIANCE IS PRODUCED WITH THE SPECIAL SUPPLY CORD IT CAN BE EXCHANGED ONLY BY THE SAME SPECIAL SUPPLY CORD PROVIDED BY THE MANUFACTURER.
- TO AVOID HAZARDS, DAMAGED POWER SUPPLY CORDS SHOULD ONLY BE REPLACED BY THE MANUFACTURER, A MAINTENANCE TECHNICIAN OR A PERSON WITH AN EQUIVALENT QUALIFICATION.
- DO NOT USE extension cords or connectors (adapters), or hubs.
- When positioning the appliance, be careful that the electrical cord isn't squeezed in order to avoid its damage. Do not store heavy objects such as cooling devices, furniture or other domestic devices next the appliance in such a way that they could squeeze and damage the electrical cord. This can cause a short circuit and a fire.
- Make sure that the plug of the electrical cord is not squeezed by the back wall of the appliance or otherwise damaged. A damaged plug can be the cause of a fire!
- **ATTENTION!** DO NOT REMOVE THE COVER OF THE LIGHT EMITTING DIODE (LED) LUMINAIRE! If the cooling appliance is equipped with light emitting diode (LED) luminaire and the lighting is not functioning, please contact a maintenance technician to have it replaced. THE LUMINAIRE CAN BE REPLACED ONLY BY A MAINTENANCE TECHNICIAN!
- If the appliance is unplugged (for cleaning, moving to another place, etc.), it may be repeatedly switched ON AFTER 15 MIN.
- It is forbidden to use a technically damaged appliance.
- The appliance can't be disposed of by burning.
- Do not place any switched on electrical devices (such as microwave ovens, hair dryers, irons, electric kettles or other electrical devices) on top of the appliance because this may cause ignition of plastic parts.
- Do not place any dishes with liquids on top of the appliance and do not keep flowers in vases or other liquid-filled vessels on the appliance.

- Do not climb on or sit on the appliance, do not lean on or hang on the appliance doors and do not allow children to do this.



IF THE APPLIANCE IS OUT OF ORDER AND IT IS NOT POSSIBLE TO REPAIR IT BY MEANS OF GIVEN RECOMMENDATIONS, UNPLUG IT, OPEN THE DOORS AND CALL THE SERVICE EXPERT. ONLY A SERVICE REPRESENTATIVE CAN REMEDY ALL TECHNICAL OR CONSTRUCTION FAULTS.

ENVIRONMENTAL PROTECTION INFORMATION



This symbol indicates that once the appliance is no longer needed, it cannot be disposed together with other miscellaneous municipal waste. It should be collected and eliminated separately, i.e. in containers specially marked with this symbol in large-dimension rubbish collection areas. Full information on where to submit the old appliance safely can be obtained from local government authorities, the shop where you bought the appliance or the manufacturer's representatives.

If you decided to scrap the appliance, make it impossible to use in order to prevent possible misadventure. Pull out the electric plug from the electricity supply socket and then cut off the cord. Tear off the gasket. Break the door lock if any.

WARNING! Do not dismantle the appliance yourself. Pass it on to recycling companies.

GENERAL INFORMATION

The appliance is a two-compartment refrigerator-freezer combination.

The refrigerator compartment is designed for the brief storage of fresh food.

The freezer compartment is designed for the freezing and long-term storage of food products.

THE APPLIANCE IS ECOLOGICALLY CLEAN, CONTAINING NO MATERIALS HARMFUL TO THE OZONE LAYER: the refrigerant used is R600a, the foaming agent used for the appliance insulation is cyclopentane C_5H_{10} .

THE MANUFACTURER GUARANTEES RELIABLE OPERATION OF THE REFRIGERATOR WHEN THE RELATIVE AIR HUMIDITY NOT GREATER THAN 70 PER CENT AND THE AMBIENT TEMPERATURE IS:

+16 TO +32 DEGREES CELSIUS (Climate class **N**);



+16 TO +38 DEGREES CELSIUS (Climate class **ST**).

+16 TO +43 DEGREES CELSIUS (Climate class **T**).

Product data sheet

Model	RF27SM		RF31SM		RF32SM		RF34SM-Z1xx233
Category ¹⁾	7						
Fridge net volume, L	173		191		233		214
*** Freezer net volume, L	54		88		54		88
Actual consumption will depend on how the appliance is used and where it is located							
Energy efficiency class ²⁾	A++	A+	A++	A+	A++	A+	A+++
Annual energy consumption ³⁾ , kWh/annum	179	219	204	248	196	238	147
Climate class	N-ST	N	N-ST	N	N-ST	N	N-T
Frost-free: refrigeration unit	yes						
Frost-free: freezer unit	no						
Freezing capacity, kg / 24 h	6	7,5	8	12	6	7,5	4
Temperature rise time, h	18		20	20	18		25
Dimensions: (H / W), cm	150 / 60		176 / 60		176 / 60		185/60
(D), cm	65	62	65	62	65	62	65
Noise level, dB(A) re1pW	40						41
Construction	Freestanding						
Electrical Data: see in the product label							

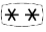
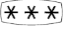

NOTE. The manufacturer reserves the right to make future changes to technical parameters and specifications.

- ¹⁾ 1 = Refrigerator with one or more fresh-food storage compartments,
2 = Refrigerator-cellar, Cellar and Wine storage appliances,
3 = Refrigerator-chiller and Refrigerator with a 0-star compartment,
4 = Refrigerator with a one-star compartment, 5 = Refrigerator with a two-star compartment,
6 = Refrigerator with a three-star compartment, 7 = Refrigerator-freezer,
8 = Upright freezer, 9 = Chest freezer, 10 = Multi-use and other refrigerating appliances
- ²⁾ A+++ (most efficient) to D (least efficient)
- ³⁾ Annual energy consumption (AE C) in kWh per year, based on standard test results for 24 hours.
Actual energy consumption will depend on how the appliance is used and where it is located.
- 4) 1  One-star compartment with nominal temperature of -6°C
2  Two-star compartment with nominal temperature of -12°C
3  Three-star compartment with nominal temperature of -18°C
4  Food freezer compartment (four-star compartment) with nominal temperature of -18°C
- ⁵⁾ Climate class: This appliance is intended to be used at an ambient temperature between lowest and highest temperature: SN = 10°C-32°C, N = 16°C-32°C, ST = 16°C-38°C, T = 16°C-43°C

Product data sheet

Model	RF34SM		RF35SM		RF36SM		RF39SM	
Category ¹⁾	7							
Fridge net volume, L	214		191		233		245	
 Freezer net volume, L	88		119		88		88	
Actual consumption will depend on how the appliance is used and where it is located								
Energy efficiency class ²⁾	A++	A+	A++	A+	A++	A+	A++	A+
Annual energy consumption ³⁾ , kWh/annum	212	256	223	270	217	262	222	266
Climate class	N-ST	N	N-ST	N	N-ST	N	N-ST	N
Frost-free: refrigeration unit	yes							
Frost-free: freezer unit	no							
Freezing capacity, kg / 24 h	8	12	8	12	8	12	8	12
Temperature rise time, h	20		20		20		20	
Dimensions: (H / W), cm	185 / 60		194,5 / 60		194,5 / 60		200 / 60	
(D), cm	65	62	65	62	65	62	65	62
Noise level, dB(A) re1pW	41							
Construction	Freestanding							
Electrical Data: see in the product label								

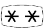
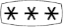
NOTE. The manufacturer reserves the right to make future changes to technical parameters and specifications.

- ¹⁾ 1 = Refrigerator with one or more fresh-food storage compartments,
 2 = Refrigerator-cellar, Cellar and Wine storage appliances,
 3 = Refrigerator-chiller and Refrigerator with a 0-star compartment,
 4 = Refrigerator with a one-star compartment, 5 = Refrigerator with a two-star compartment,
 6 = Refrigerator with a three-star compartment, 7 = Refrigerator-freezer,
 8 = Upright freezer, 9 = Chest freezer, 10 = Multi-use and other refrigerating appliances
- ²⁾ A+++ (most efficient) to D (least efficient)
- ³⁾ Annual energy consumption (AE C) in kWh per year, based on standard test results for 24 hours.
 Actual energy consumption will depend on how the appliance is used and where it is located.
- 4) 1  One-star compartment with nominal temperature of -6°C
 2  Two-star compartment with nominal temperature of -12°C
 3  Three-star compartment with nominal temperature of -18°C
 4  Food freezer compartment (four-star compartment) with nominal temperature of -18°C
- ⁵⁾ Climate class: This appliance is intended to be used at an ambient temperature between lowest and highest temperature: SN = 10°C-32°C, N = 16°C-32°C, ST = 16°C-38°C, T = 16°C-43°C

DESCRIPTION OF THE APPLIANCE, BASIC PARTS



THE APPLIANCE ACCESSORIES LISTED BELOW MAY DIFFER FROM THE ACCESSORIES OF THE APPLIANCE YOU HAVE BOUGHT IN QUANTITY AND IN DESIGN. This description is adapted for entire group of two-compartment refrigerator-freezer combinations.*

A – Refrigerator compartment

B – freezer compartment

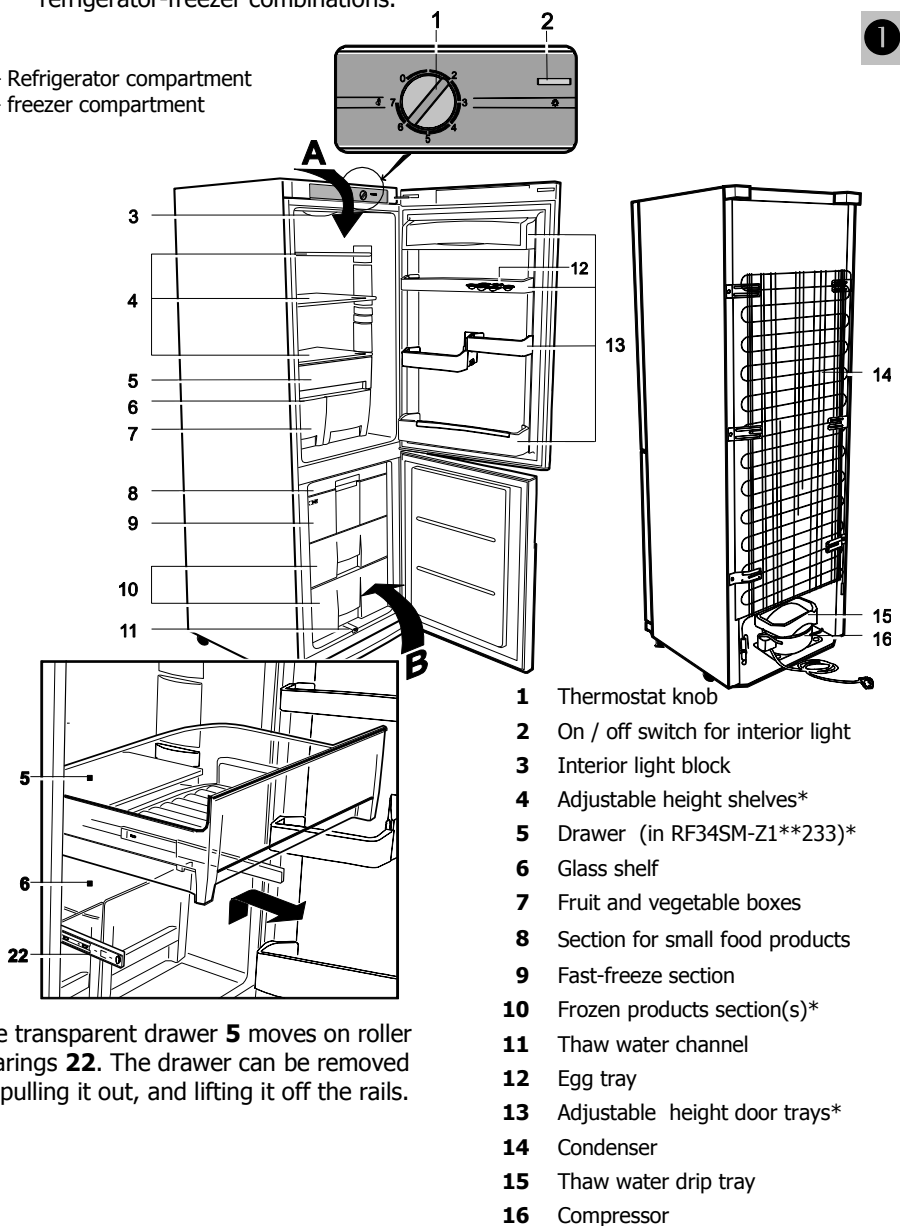

The transparent drawer **5** moves on roller bearings **22**. The drawer can be removed by pulling it out, and lifting it off the rails.

PREPARING THE APPLIANCE FOR OPERATION

It is recommended to prepare the appliance for operation with a helper.

- Remove package. Lift the appliance away from foamed polystyrene base. Tear off adhesive tapes.
- When positioning the appliance in chosen location, it will move more easily into position if you lift the front a little and incline it backward, allowing it to roll on its casters. **Never lift or push the appliance holding their handles as they may break.**
- Remove all red-coloured parts from the shelves (fig. 2.). Tear away the red-coloured adhesive tapes from the door trays – they are intended only for the transport of the appliance.

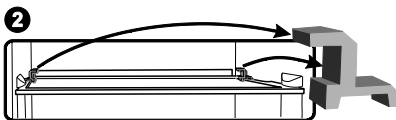

NOTE. When you open the freezer compartment door a little red packing detail will fall out – IT IS FOR TRANSPORTATION PURPOSES ONLY.

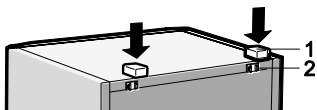

- ◀ Take two supports **1** from the bag and insert them into the guides **2** at the top back part of the appliance (see picture).
- If the appliance is brought in from the cold (temperature is not higher than +12 °C), **you**

should wait for two hours before connecting it to the mains.

 The appliance **should not be connected** to the mains until all packing and transport materials aren't removed. Suitably dispose the packaging material.

POSITIONING

- Place the appliance in a dry, well ventilated room.

 **WARNING!** The appliance should not be operated in an unheated room or porch. Place the appliance away from heat sources such as kitchen stove/oven, radiators, or direct sunlight.

 **WARNING!** The appliance must not touch any pipes for heating, gas or water supply, or any other electrical devices.

- Do not cover the ventilation holes at the top of the appliances – it must be a good air circulation around the appliance. There should be a gap of at least 10 cm between the top of the appliance body and any furniture that may be above it (see fig.). If this requirement is not followed, the appliance consumes more electrical energy and its compressor may overheat. ▶
- The appliance must stand on a level surface and must not touch the wall. If necessary, regulate the height of the appliance by adjusting the levelling feet: by turning them clockwise – the front of the appliance rises, by turning them counter clockwise – it comes down. If the appliance is tilted slightly backward – the doors will close by themselves.

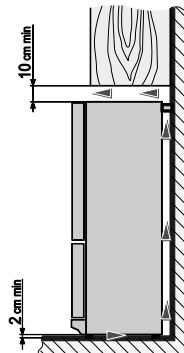

- If the appliance is placed in a corner, a gap must be left between the appliance body and the wall so that the freezer compartment door can be opened enough to pull out the frozen product drawer (see picture).

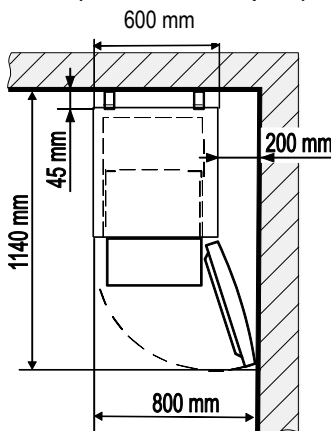

RF39SM-S1**21, RF36SM-S1**21, RF35SM-S1**21
 RF34SM-S1**21, RF31SM-S1**21, RF32SM-S1**21
 RF27SM-S1**21

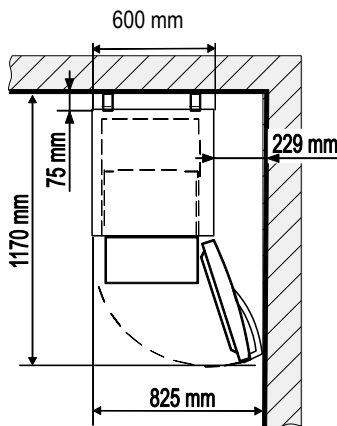

RF39SM-P1**22, RF36SM-P1**22, RF35SM-P1**22
 RF34SM-P1**22, RF34SM-Z1**23, RF31SM-P1**22
 RF27SM-P1**22

TEMPERATURE REGULATION

The temperature in the refrigerator compartment is controlled using the thermostat knob **1** (fig. 1) by turning it to one side or the other. The temperature indication in digits is shown beside the thermostat knob.

The temperature is regulated on the scale of seven digits:

- 0** = Compressor is switched off. **WARNING!** Electric current is not switched off.
- 1** = highest temperature (lowest cooling)
- 7** = lowest temperature (highest cooling)

If foodstuffs in the refrigerator compartment are too cold, set the thermostat knob to **1**, **2** or **3**. If foodstuffs in the refrigerator compartment are not being chilled sufficiently, set the thermostat knob to **4**, **5** or **6**. Please set the desired temperature in the appliance according to your own requirements.

 THE TEMPERATURE IN THE REFRIGERATOR COMPARTMENT MAY VARY DEPENDING ON AMBIENT TEMPERATURE, THE AMOUNT OF FOODSTUFFS, THE TEMPERATURE OF THE FOODSTUFFS, AND HOW OFTEN THE APPLIANCE DOORS ARE OPENED AND CLOSED.

Therefore we recommend:

- locate the appliance away from heat sources,
- **do not put hot foodstuffs in the refrigerator compartment – they must be cooled down to room temperature,**
- appliance door must not to be left open,
- the appliance door should not be open longer than it is necessary to take out or put in foodstuffs.



IF THE ROOM IS COOL, THE APPLIANCE COOLS LESS. THE TEMPERATURE IN THE APPLIANCE MAY THEREFORE RISE. Use the thermostat wheel to set a lower temperature.

FREEZING OF FOODSTUFFS

When freezing large quantities of fresh food, the thermostat knob should be set to **7**. Place fresh food prepared for freezing in one or two lines in the rapid freezing compartment marked with the symbol **❄️*****

After 24 hours the frozen food products should be replaced from the quick-freeze section to the storage section drawer(s) (Fig. 1). When the products are frozen, the thermostat wheel should be **set at its earlier position**.

- DO NOT EXCEED THE MAXIMUM AMOUNT OF FROZEN FOOD INDICATED IN THE PRODUCTS DATA SHEET.
- Leave not less than 3 cm gap between a top of frozen products and a bottom of drawer, which is over them.
- Do not place unwrapped foodstuffs in the freezer sections.
- Fresh food for freezing should not touch already frozen foodstuffs.
- Do not freeze foodstuffs that are warmer than the room temperature.
- **WARNING!** Do not freeze liquid foodstuffs in glass vessels or bottles.
- Strictly observe the frozen foodstuffs validity dates indicated by the manufacturer on the product packaging.
- WE RECOMMEND THAT FROZEN FISH AND SAUSAGE SHOULD BE STORED IN THE FREEZER COMPARTMENT NOT LONGER THAN 6 MONTHS; CHEESE, POULTRY, PORK, LAMB – NOT MORE THAN 8 MONTHS; BEEF, FRUIT AND VEGETABLES – NOT LONGER THAN 12 MONTHS.

DEFROSTING

THE REFRIGERATOR COMPARTMENT defrosts automatically. Drops of ice that form on the back wall of the refrigerator compartment thaw during the time the compressor is not working and the thaw water runs down the thaw water runoff channel to the tray on top of the compressor (Fig. 1), where it evaporates.

FREEZER COMPARTMENT should be thawed not less than twice a year or when a layer of ice thicker than 5 mm forms in it. Do the actions below in the order they are listed:

IMPORTANT! Turn off the appliance – unplug the power supply cord plug from the electrical socket.

- Remove foodstuffs from freezer compartment. The frozen foodstuffs will not warm up too much while you are thawing the freezer compartment if you cover them with a thick cloth and keep them in a cool place.
- Remove the thaw water chamfer, turn it 180 ° and place in front of the freezer compartment (Fig. 4). Place a bowl under the thaw water chamfer.
- Place a dish under the thaw water channel. Leave door of freezer compartment open.
- When the ice melts, clean and wipe dry the surfaces and fixtures of the freezer compartment.
- Remove the melt water channel, turn it by 180° again

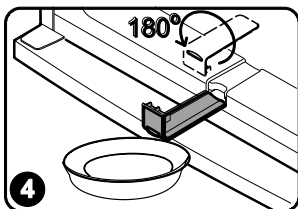

- and put it back in its original place.
- Close the appliance door. Plug in and turn on the appliance.

CLEANING AND CARE

REGULARLY CLEAN THE APPLIANCE!



Remember that before defrosting the freezer compartment and cleaning the back part of the appliance body you must disconnect the appliance from the electrical energy supply socket by pulling the plug out of the electricity outlet.

- Protect the appliance inner surfaces and plastic parts from fats, acids and sauces. In case of accidental spills – immediately clean with warm soapy water or dishwashing detergent. Wipe dry.

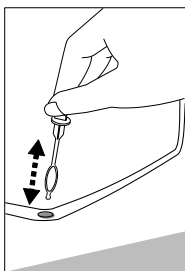

- Clean the appliance inner surfaces with warm soapy water. Dishwashing detergent may also be used.
- Wipe dry inner and outer surfaces.
- Regularly clean the hermetic gaskets of the doors. Wipe dry.
- Regularly wash the trays and other accessories.
- ◀ **REGULARLY CLEAN THE THAW WATER CHANNEL SPACE WITH A SPECIAL CLEANER FOR THAT PURPOSE** (see picture).
- At least once a year clean dust away from the back part of the appliance body and the compressor. A soft brush, electrostatic cloth or vacuum cleaner may be used for cleaning.
- DO NOT use detergents containing abrasive particles, acid, alcohol or benzene for cleaning the appliance inner and outer surfaces.
- DO NOT use for cleaning cloths or sponges that have coarse surfaces intended for scrubbing.

PRACTICAL TIPS AND OBSERVATIONS

- Strictly observe the foodstuff validity time indicated by the manufacturer on the product packaging.
- Do not keep bananas in the refrigerator – these fruits are sensitive to cold.
- Do not keep prepared food and ready-to-cook (“heat and eat”) food in the same container.
- Store in an airtight container in the appliance any foodstuffs that have a strong odour (e.g. fresh fish, pâté de foie gras goose liver pâté, and cheese).
- Frozen foodstuffs should be thawed in the refrigerator compartment. Food that thaws slowly retains better flavour properties and spread cold will help to maintain the set temperature in the refrigerator compartment.
- Do not consume ice made in the freezer compartment straight away.
- Products will freeze more quickly if they are divided up and packed in small portions.
- IF THE APPLIANCE IS TO BE LEFT SWITCHED OFF FOR AN EXTENDED PERIOD, LEAVE ITS DOORS OPEN.



Remarks on the appliance operating noise. As the appliance operates and goes through the freezing cycle, various noises will be emitted. This is normal and is not a sign of any malfunction.

- As the refrigerant circulates around the refrigeration system, it causes sounds like murmuring, bubbling, or rustling.
- Louder sounds like popping or clicking may be heard for a short time as the refrigerator's compressor switches on.

CHANGING THE OPENING DIRECTION OF THE DOORS

It is recommended that changing the opening direction of the doors should be done with a helper. You will need two spanners No. 8 and No. 10 and a head screwdriver.



When changing the opening direction of the doors, **YOU CAN NOT** lay the refrigerator horizontally!

Do the actions below in the order they are listed:

WARNING! Turn off the appliance and pull the plug out of the electricity supply socket.

1. Remove the covers **c** from the body of the refrigerator and of the inner side of the door. Also remove the upper bracket **6** together with the nut and washers and the spacer under the bracket.
2. Remove the door of the refrigerator compartment **1**. Remove the stopper **5** from the bottom of it. On the other side of the door attach the stopper intended for doors that open on the left (you will find it in the packet).
3. Remove the middle bracket **4** together with the washers on the axle and the plastic spacer.
4. Remove the freezer compartment door **3**.
5. Remove the bottom cover **11** together with the small cover **10**.
6. Remove the bottom bracket **2** together with the washers on the axle and the plastic spacer. Unscrew the axle with the washers and screw it into the aperture provided on the other side.
7. Unscrew the bracket **7** and counterchange brackets **2** and **7**.
8. Remove plugs **8** from the partition wall, separating freezer and refrigerator compartments, and place them into holes on the opposite side.
9. Remove covers **a** of handle fixing screws and unscrew these screws. Transfer handles to the other side. Impress plugs **b** (you'll find them in package) into empty holes in doors.
10. Remove plug **9** of the freezer compartment door and impress it in the opposite side.
11. Hang the freezer compartment door **3** on the axle of bracket **2** on the opposite side of refrigerator.
12. Turn the bracket **4** together with plastic spacer at 180° and counterchange washers, located on axle, on top and bottom of the bracket. Having the bracket axle placed in door of freezer, screw it on the opposite side of refrigerator.
13. Hang the refrigerator compartment door on the axle of bracket **4**.
14. Turn the bracket **6** around 180° together with the washers on the axle and the plastic spacer. Remove the axle and the washers and reattach them on the other side of the bracket. Having the axle of bracket **6** placed into the door of refrigerator compartment door, screw the bracket into lower holes on the opposite side of refrigerator. Cover the bracket and remaining empty hole with covers **c**.

15. Place the cover **10** to the guides of the bottom cover **11** on the opposite side and place the bottom cover **11** in its former place.

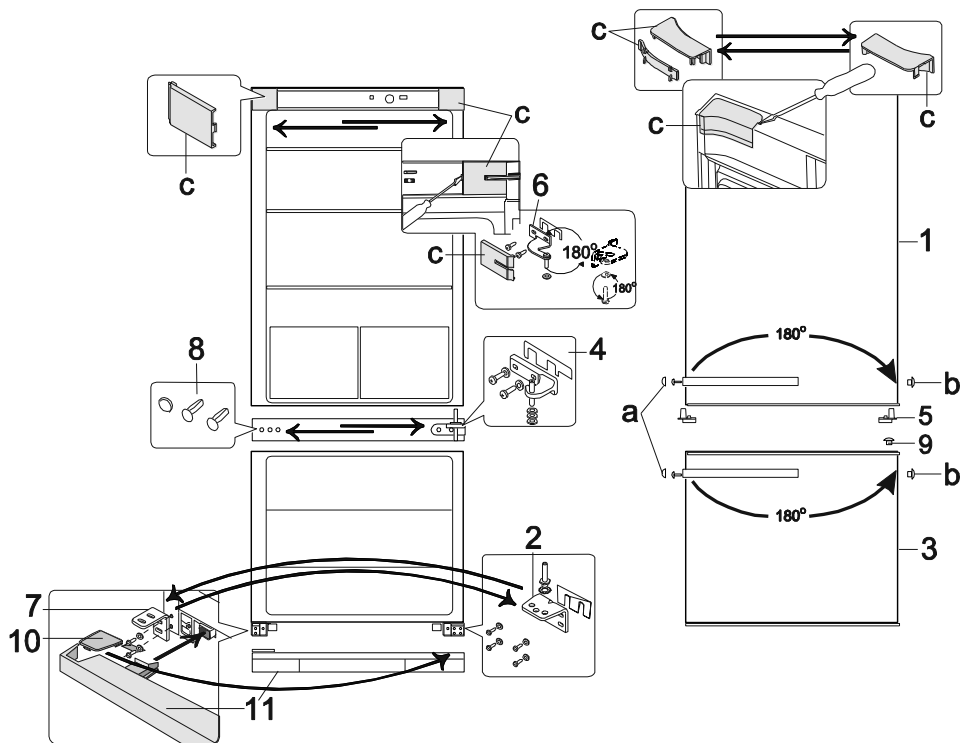

OPERATION PROBLEMS AND THEIR SOLUTIONS (TROUBLESHOOTING)

What if ...

- **The appliance is plugged in to the mains but it does not work.** Check that your house electricity supply installations are in order. Check that the plug is correctly inserted into the electricity supply socket.
- **The noise has become louder.** Check that the appliance is standing stable, on a level place. To make it level, regulate the front feet. Check if the appliance is not touching any furniture, and that no part of the refrigeration system at the back part of the appliance body is touching the wall. Pull the appliance away from any furniture or walls. Check that the cause of increased noise isn't due to bottles, cans or dishes in the appliance that might be touching each other.
- **Water has appeared at the bottom of the refrigerator compartment.** Check whether a thaw water channel space isn't blocked. Clean the thaw water channel space with a cleaner intended for that purpose.

- **Water has appeared on the tempered glass shelves.** Food items or dishes in the refrigeration compartment are touching the back wall of the compartment. Do not let food items or dishes touch the back wall.
- **Moisture dripping from under the glass shelves.** If you placed many containers with liquids on the shelf, moisture can condense and drip onto the shelf below. Move some containers with liquids onto other shelves.
- **Water has appeared under the appliance.** The thaw water collection tray has slipped off the compressor. Place the tray on top of the compressor.
- **When the appliance door is opened, the rubber sealing gasket pulls out.** The gasket is smeared with sticky foodstuffs (fat, syrup). Clean the sealing gasket and the groove for it with warm water containing soap or dishwashing detergent and wipe dry. Put the rubber sealing gasket back into the place.
- **High temperature in appliance, the compressor operation pauses are short.** Ascertain whether the appliance doors are shutting tightly, whether the door wasn't kept open longer than necessary when taking out or putting in foodstuffs or whether a large amount of warm food was placed in the appliance.
- **The top of the appliance has condensation on it.** The ambient relative air humidity is above 70 %. Ventilate the room where the appliance stands and if possible remove the cause of the humidity.

TRANSPORT



THE MANUFACTURER WILL NOT BE RESPONSIBLE FOR ANY DAMAGE OF THE APPLIANCE THAT RESULTS FROM NON-COMPLIANCE WITH THE INSTRUCTIONS FOR TRANSPORTATION.

- The appliance should be transported in the vertical position.
- When being transported, the appliance should be protected from atmospheric conditions (rain, snow, dampness).
- The appliance should be firmly secured in place while being transported, to avoid slippage or any shocks in the transport vehicle.
- **If the appliance was transported not vertically, it may be connected to the mains after 4 hours at least. If this is not done, the appliance compressor may fail.**

WARRANTY SERVICE

IF YOUR APPLIANCE IS NOT WORKING PROPERLY, ASCERTAIN WHETHER YOU CAN REMEDY THE CAUSE OF THE FAULTY FUNCTIONING OF THE APPLIANCE YOURSELF. If you cannot solve the problem yourself, contact the nearest refrigerator service representative by telephone or in writing. When making contact, necessarily indicate the refrigerator model and number. You will find this data on the product label, which is glued to the left wall of the refrigerator compartment near the fruit and vegetable trays.