

**SNAIGÉ**  
ICE LOGIC

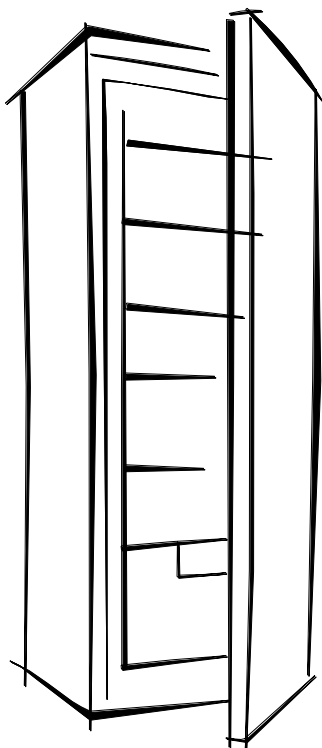

**C 29SM**

**C 31SM**

---

---

---

Instructions for Use

Refrigerator

## **SAFETY INSTRUCTIONS**

CAREFULLY READ THE INSTRUCTION MANUAL. If instructions are not followed, there is a risk of injury, damage of the appliance and loss of the right to free warranty service. We recommend to keep the Instruction manual the whole time you have the appliance. When you sell the appliance pass the Instruction manual to the new owner of the appliance.

### **! WARNING!**

- Do not cover the ventilation holes at the top and on the sides of the appliance.
- Do not use any mechanical means or electrical devices to hasten the thawing process when cleaning the freezer compartment.
- Do not use electrical appliances inside the food storage compartments of the appliance, unless they are of the type recommended by the manufacturer.
- If the supply cord is damaged it must be replaced by the manufacturer, manufacturer service agent or a similarly qualified person, in order to avoid a hazard.
- Disposal of the appliance should be according to national rules.
- Do not damage the appliance refrigeration system. It contains the refrigerant gas R600a. If the refrigeration system is damaged:



- Do not use any open flame.
- Avoid sparks—do not turn on any electrical appliances or lighting fixtures.
- Immediately ventilate the room.
- Do not allow children to play with the appliance or to plug it in or unplug from the electricity supply socket. Do not allow children to play with the packaging material from the appliance.
- This appliance can be used by children aged from 8 years and above and persons with reduced physical, sensory or mental capabilities or lack of experience and knowledge if they have been given supervision or instruction concerning use of the appliance in a safe way and understand the hazards involved.
- Cleaning and user maintenance shall not be made by children without supervision.
- The appliance should be used only storing foodstuffs.
- This appliance is not designed for the storage of explosive substances such as aerosol cans with a flammable propellant.
- It is prohibited to store petrol and other flammable liquids near the appliance.

## ❗ CONNECTION TO THE MAINS

- The appliance should only be connected to an earthed socket installed in accordance with the regulations. Make sure that the supply voltage corresponds with the voltage marked on the rating label. This product complies with all binding CE labelling directives.. The earthed electrical socket by which the appliance is connected to the mains should be in an accessible place.
- IF THE APPLIANCE IS PRODUCED WITH THE SPECIAL SUPPLY CORD IT CAN BE EXCHANGED ONLY BY THE SAME SPECIAL SUPPLY CORD PROVIDED BY THE MANUFACTURER.
- TO AVOID HAZARDS, DAMAGED POWER SUPPLY CORDS SHOULD ONLY BE REPLACED BY THE MANUFACTURER, A MAINTENANCE TECHNICIAN OR A PERSON WITH AN EQUIVALENT QUALIFICATION.
- DO NOT USE extension cords or connectors (adapters), or hubs.
- When positioning the appliance, be careful that the electrical cord isn't squeezed in order to avoid its damage. Do not store heavy objects such as cooling devices, furniture or other domestic devices next the appliance in such a way that they could squeeze and damage the electrical cord. This can cause a short circuit and a fire.
- Make sure that the plug of the electrical cord is not squeezed by the back wall of the appliance or otherwise damaged. A damaged plug can be the cause of a fire!
- **ATTENTION!** DO NOT REMOVE THE COVER OF THE LIGHT EMITTING DIODE (LED) LUMINAIRE! If the cooling appliance is equipped with light emitting diode (LED) luminaire and the lighting is not functioning, please contact a maintenance technician to have it replaced. THE LUMINAIRE CAN BE REPLACED ONLY BY A MAINTENANCE TECHNICIAN!
- If the appliance is unplugged (for cleaning, moving to another place, etc.), it may be repeatedly switched ON AFTER 15 MIN.
- It is forbidden to use a technically damaged appliance.
- The appliance can't be disposed of by burning.
- Do not place any switched on electrical devices (such as microwave ovens, hair dryers, irons, electric kettles or other electrical devices) on top of the appliance because this may cause ignition of plastic parts.
- Do not place any dishes with liquids on top of the appliance and do not keep flowers in vases or other liquid-filled vessels on the appliance.

- Do not climb on or sit on the appliance, do not lean on or hang on the appliance doors and do not allow children to do this.



IF THE APPLIANCE IS OUT OF ORDER AND IT IS NOT POSSIBLE TO REPAIR IT BY MEANS OF GIVEN RECOMMENDATIONS, UNPLUG IT, OPEN THE DOORS AND CALL THE SERVICE EXPERT. ONLY A SERVICE REPRESENTATIVE CAN REMEDY ALL TECHNICAL OR CONSTRUCTION FAULTS.

## ENVIRONMENTAL PROTECTION INFORMATION



This symbol indicates that once the appliance is no longer needed, it cannot be disposed together with other miscellaneous municipal waste. It should be collected and eliminated separately, i.e. in containers specially marked with this symbol in large-dimension rubbish collection areas. Full information on where to submit the old appliance safely can be obtained from local government authorities, the shop where you bought the appliance or the manufacturer's representatives.

If you decided to scrap the appliance, make it impossible to use in order to prevent possible misadventure. Pull out the electric plug from the electricity supply socket and then cut off the cord. Tear off the gasket. Break the door lock if any.

**WARNING! Do not dismantle the appliance yourself. Pass it on to recycling companies.**

## GENERAL INFORMATION

The appliance is a refrigerators made as a cabinet and designed for a short-term storage of chilled products.

THE APPLIANCE IS ECOLOGICALLY CLEAN, CONTAINING NO MATERIALS HARMFUL TO THE OZONE LAYER: the refrigerant used is R600a, the foaming agent used for the appliance insulation is cyclopentane  $C_5H_{10}$ .





THE MANUFACTURER GUARANTEES RELIABLE OPERATION OF THE REFRIGERATOR WHEN THE RELATIVE AIR HUMIDITY NOT GREATER THAN 70 PER CENT AND THE AMBIENT TEMPERATURE IS:

- +16 TO +32 DEGREES CELSIUS (Climate class **N**);
- +16 TO +38 DEGREES CELSIUS (Climate class **ST**);
- +16 TO +43 DEGREES CELSIUS (Climate class **T**).

## Product data sheet

Model	C 29SM		C 31SM
Category <sup>1)</sup>	1		
Gross volume, L	270		310
Refrigerator net volume, L	267		308
Actual consumption will depend on how the appliance is used and where it is located			
Energy efficiency class <sup>2)</sup>	A+	A++	A++
Annual energy consumption <sup>3)</sup> , kWh/annum	133	104	108
Climate class	N-T		
Frost-free: refrigeration unit	yes		
Noise level, dB(A) re1pW	41		
Dimensions (H/W/D), cm	145 / 60 / 62	145 / 60 / 65	163 / 60 / 65
Construction	Freestanding		
Electrical Data: see in the product label			

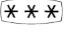
NOTE. The manufacturer reserves the right to make future changes to technical parameters and specifications.

- <sup>1)</sup> 1 = Refrigerator with one or more fresh-food storage compartments,  
 2 = Refrigerator-cellar, Cellar and Wine storage appliances,  
 3 = Refrigerator-chiller and Refrigerator with a 0-star compartment,  
 4 = Refrigerator with a one-star compartment, 5 = Refrigerator with a two-star compartment,  
 6 = Refrigerator with a three-star compartment, 7 = Refrigerator-freezer,  
 8 = Upright freezer, 9 = Chest freezer, 10 = Multi-use and other refrigerating appliances
- <sup>2)</sup> A+++ (most efficient) to D (least efficient)
- <sup>3)</sup> Annual energy consumption (AE C ) in kWh per year, based on standard test results for 24 hours.  
 Actual energy consumption will depend on how the appliance is used and where it is located.
- 4) 1  One-star compartment with nominal temperature of -6°C  
 2  Two-star compartment with nominal temperature of -12°C  
 3  Three-star compartment with nominal temperature of -18°C  
 4  Food freezer compartment (four-star compartment) with nominal temperature of -18°C
- <sup>5)</sup> Climate class: This appliance is intended to be used at an ambient temperature between lowest and highest temperature: SN = 10°C-32°C, N = 16°C-32°C, ST = 16°C-38°C, T = 16°C-43°C

# DESCRIPTION OF THE APPLIANCE, BASIC PARTS

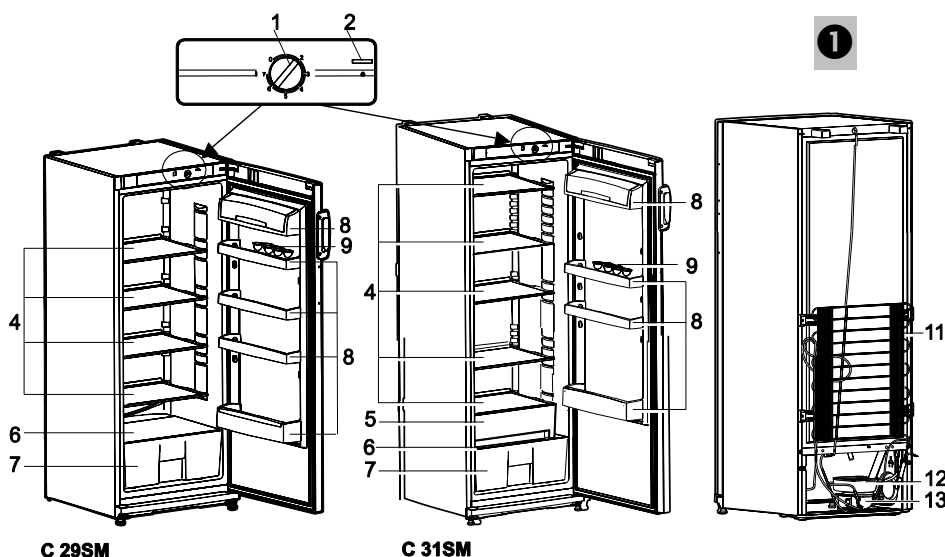

**C 29SM**

**C 31SM**

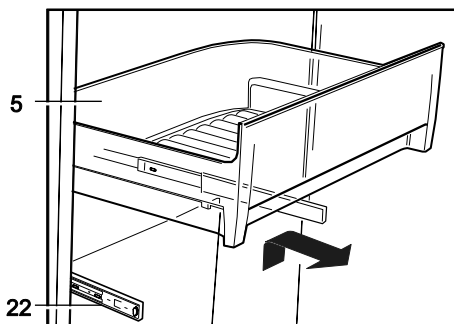

The drawer **5** moves on roller bearings **22**. The drawer can be removed by pulling it out, and lifting it off the rails.

**1** Thermostat - temperature regulator

**2** On / off switch for interior light

**4** Adjustable height shelves

**5** Pull-out drawer (in C 31SM)

**6** Shelf (glass)

**7** Fruit and vegetable box

**8** Doors tray

**9** Egg tray

**11** Condenser

**12** Thaw water drip tray

**13** Compressor

## PREPARING THE APPLIANCE FOR OPERATION

It is recommended to prepare the appliance for operation with a helper.

- Remove package. Lift the appliance away from foamed polystyrene base. Tear off adhesive tapes.
- When positioning the appliance in chosen location, it will move more easily into position if you lift the front a little and incline it backward, allowing it to roll on its casters. **Never lift or push the appliance holding their handles as they may break.**
- Remove all red-coloured parts from the shelves (fig. 2.). Tear away the red-coloured adhesive tapes from the door trays – they are intended only for the transport of the appliance.

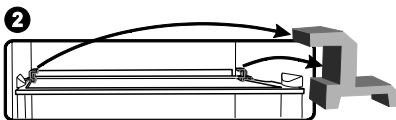

NOTE. When you open the freezer compartment door a little red packing detail will fall out – IT IS FOR TRANSPORTATION PURPOSES ONLY.

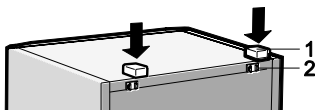

- ◀ Take two supports **1** from the bag and insert them into the guides **2** at the top back part of the appliance (see picture).
- If the appliance is brought in from the cold (temperature is not higher than +12 °C), **you**

**should wait for two hours before connecting it to the mains.**

 The appliance **should not be connected** to the mains until all packing and transport materials aren't removed. Suitably dispose the packaging material.

## POSITIONING

- Place the appliance in a dry, well ventilated room.

 **WARNING!** The appliance should not be operated in an unheated room or porch. Place the appliance away from heat sources such as kitchen stove/oven, radiators, or direct sunlight.

 **WARNING!** The appliance must not touch any pipes for heating, gas or water supply, or any other electrical devices.

- Do not cover the ventilation holes at the top of the appliances – it must be a good air circulation around the appliance. There should be a gap of at least 10 cm between the top of the appliance body and any furniture that may be above it. If this requirement is not followed, the appliance consumes more electrical energy and its compressor may overheat (see fig.) ▶
- The appliance must stand on a level surface and must not touch the wall. If necessary, regulate the height of the appliance by adjusting the levelling feet: by turning them clockwise – the front of the appliance rises, by turning them counter clockwise – it comes down. If the appliance is tilted slightly backward – the doors will close by themselves.

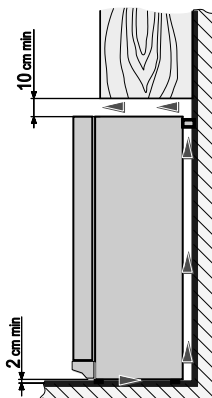

- If the appliance is placed in a corner, a gap of at least 60 mm must be left between the appliance body and the wall (see fig.) ►

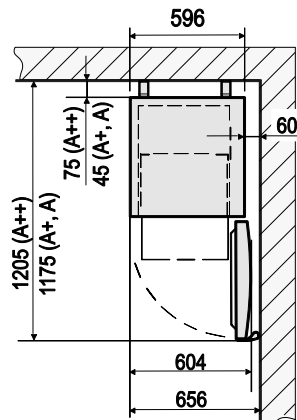

## TEMPERATURE REGULATION

The temperature in the refrigerator compartment is controlled using the thermostat knob **1** (fig. 1) by turning it to one side or the other. The temperature indication in digits is shown beside the thermostat knob.

The temperature is regulated on the scale of seven digits:

- 0** = Compressor is switched off. **WARNING!** Electric current is not switched off.
- 1** = highest temperature (lowest cooling)
- 7** = lowest temperature (highest cooling)

If foodstuffs in the refrigerator compartment are too cold, set the thermostat knob to **1**, **2** or **3**. If foodstuffs in the refrigerator compartment are not being chilled sufficiently, set the thermostat knob to **4**, **5** or **6**. Please set the desired temperature in the appliance according to your own requirements.



THE TEMPERATURE IN THE REFRIGERATOR COMPARTMENT MAY VARY DEPENDING ON AMBIENT TEMPERATURE, THE AMOUNT OF FOODSTUFFS, THE TEMPERATURE OF THE FOODSTUFFS, AND HOW OFTEN THE APPLIANCE DOORS ARE OPENED AND CLOSED.

Therefore we recommend:

- locate the appliance away from heat sources,
- **do not put hot foodstuffs in the refrigerator compartment – they must be cooled down to room temperature,**
- appliance door must not to be left open,
- the appliance door should not be open longer than it is necessary to take out or put in foodstuffs.



IF THE ROOM IS COOL, THE APPLIANCE COOLS LESS. THE TEMPERATURE IN THE APPLIANCE MAY THEREFORE RISE. Use the thermostat wheel to set a lower temperature.



## DEFROSTING

THE REFRIGERATOR COMPARTMENT defrosts automatically. Drops of ice that form on the back wall of the refrigerator compartment thaw during the time the compressor is not working and the thaw water runs down the thaw water runoff channel to the tray on top of the compressor (Fig. 1), where it evaporates.

## CLEANING AND CARE

REGULARLY CLEAN THE APPLIANCE.



**Remember that before cleaning the appliance body you must disconnect the appliance from the electrical energy supply socket by pulling the plug out of the electricity outlet.**

- Clean the appliance inner surfaces with warm soapy water. Dishwashing detergent may also be used. Wipe dry inner and outer surfaces.
- Regularly clean the hermetic gaskets of the doors. Wipe dry.

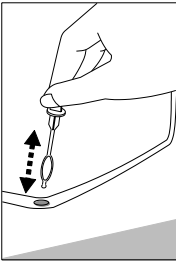

- Regularly wash the trays and other accessories.
- ◀REGULARLY CLEAN THE THAW WATER CHANNEL SPACE WITH A SPECIAL CLEANER FOR THAT PURPOSE (see Fig.).
- At least once a year clean dust away from the back part of the appliance body and the compressor. A soft brush, electrostatic cloth or vacuum cleaner may be used for cleaning.
- DO NOT use detergents containing abrasive particles, acid, alcohol or benzene for cleaning the appliance inner and outer surfaces.
- DO NOT use for cleaning cloths or sponges that have coarse surfaces intended for scrubbing.

## PRACTICAL TIPS AND OBSERVATIONS

- Strictly observe the foodstuff validity time indicated by the manufacturer on the product packaging.
- Do not keep bananas in the refrigerator – these fruits are sensitive to cold.
- Do not keep prepared food and ready-to-cook ("heat and eat") food in the same container.
- Store in an airtight container in the appliance any foodstuffs that have a strong odour (e.g. fresh fish, pâté de foie gras goose liver pâté, and cheese).
- IF THE APPLIANCE IS TO BE LEFT SWITCHED OFF FOR AN EXTENDED PERIOD, LEAVE ITS DOORS OPEN.



**Remarks on the appliance operating noise.** As the appliance operates and goes through the freezing cycle, various noises will be emitted. This is normal and is not a sign of any malfunction.

- As the refrigerant circulates around the refrigeration system, it causes sounds like murmuring, bubbling, or rustling.
- Louder sounds like popping or clicking may be heard for a short time as the refrigerator's compressor switches on.

## CHANGING THE OPENING DIRECTION OF THE DOORS

It is recommended that changing the opening direction of the doors should be done with a helper. You will need two spanners No. 8 and No. 10 and a head screwdriver. When changing the opening direction of the doors, YOU CAN NOT lay the refrigerator horizontally.

Do the actions below in the order they are listed.

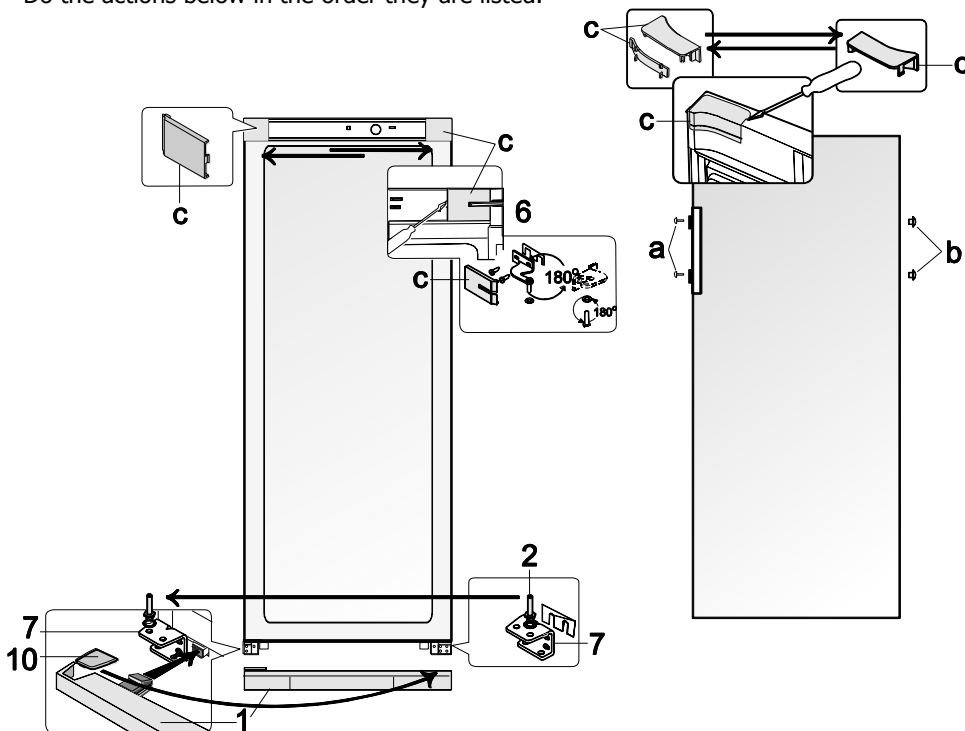

**WARNING! Turn off the appliance and pull the plug out of the electricity supply socket.**

1. Remove the covers **c** from the body of the refrigerator and of the inner side of the door. Also remove the upper bracket **6** together with the nut and washers and the spacer under the bracket.
2. Remove the door of the refrigerator compartment.
3. Remove the bottom cover **1**.
4. Unscrew the axle **2** from the bottom bracket **7** and put it together with all washers on the other cabinet side by screwing to the bracket **7** on the opposite side symmetrically to former position.
5. Hang the door on the axle **2** of bracket **7**.
6. Turn bracket **4** around 180° together with the washers on the axle and the plastic spacer, transferring the washers to the axle on the other side of the bracket.

Once the bracket is attached to the freezer compartment door, fix it in place on the other side of the refrigerator.

7. Turn the bracket **6** around 180° together with the washers on the axle and the plastic spacer. Remove the axle and the washers and reattach them on the other side of the bracket. Once the bracket **6** is attached to the refrigerator compartment door, fix it in place on the other side of the refrigerator in the uppermost apertures. Use the covers **c** to cover the bracket and the remaining space.
8. Remove the bolt covers **a** and the stoppers **b**. Remove the screws that hold the handle in place. Move the handle to the other side and screw them in place. Place the stoppers into the remaining apertures in the door, and put the screw caps in place.
9. Remove the cover **10** from the bottom cover **1** and insert it to the guides on the other side of the bottom cover (symmetrically to former position). Insert left and right legs of the bottom cover **1** (see pic.) and push it until cover fixing.

## **OPERATION PROBLEMS AND THEIR SOLUTIONS (TROUBLESHOOTING)**

### **What if ...**

- **The appliance is plugged in to the mains but it does not work.** Check that your house electricity supply installations are in order. Check that the plug is correctly inserted into the electricity supply socket.
- **The noise has become louder.** Check that the appliance is standing stable, on a level place. To make it level, regulate the front feet. Check if the appliance is not touching any furniture, and that no part of the refrigeration system at the back part of the appliance body is touching the wall. Pull the appliance away from any furniture or walls. Check that the cause of increased noise isn't due to bottles, cans or dishes in the appliance that might be touching each other.
- **Water has appeared at the bottom of the refrigerator compartment.** Check whether a thaw water channel space isn't blocked. Clean the thaw water channel space with a cleaner intended for that purpose.
- **Water has appeared on the tempered glass shelves.** Food items or dishes in the refrigeration compartment are touching the back wall of the compartment. Do not let food items or dishes touch the back wall.
- **Moisture dripping from under the glass shelves.** If you placed many containers with liquids on the shelf, moisture can condense and drip onto the shelf below. Move some containers with liquids onto other shelves.
- **Water has appeared under the appliance.** The thaw water collection tray has slipped off the compressor. Place the tray on top of the compressor.
- **When the appliance door is opened, the rubber sealing gasket pulls out.** The gasket is smeared with sticky foodstuffs (fat, syrup). Clean the sealing gasket and the groove for it with warm water containing soap or dishwashing detergent and wipe dry. Put the rubber sealing gasket back into the place.
- **High temperature in appliance, the compressor operation pauses are short.** Ascertain whether the appliance doors are shutting tightly, whether the door wasn't kept open longer than necessary when taking out or putting in foodstuffs or whether a large amount of warm food was placed in the appliance.

- **The top of the appliance has condensation on it.** The ambient relative air humidity is above 70 %. Ventilate the room where the appliance stands and if possible remove the cause of the humidity.

## TRANSPORT



THE MANUFACTURER WILL NOT BE RESPONSIBLE FOR ANY DAMAGE OF THE APPLIANCE THAT RESULTS FROM NON-COMPLIANCE WITH THE INSTRUCTIONS FOR TRANSPORTATION.

- The appliance should be transported in the vertical position.
- When being transported, the appliance should be protected from atmospheric conditions (rain, snow, dampness).
- The appliance should be firmly secured in place while being transported, to avoid slippage or any shocks in the transport vehicle.
- **If the appliance was transported not vertically, it may be connected to the mains after 4 hours at least. If this is not done, the appliance compressor may fail.**

## WARRANTY SERVICE

IF YOUR APPLIANCE IS NOT WORKING PROPERLY, ASCERTAIN WHETHER YOU CAN REMEDY THE CAUSE OF THE FAULTY FUNCTIONING OF THE APPLIANCE YOURSELF. If you cannot solve the problem yourself, contact the nearest refrigerator service representative by telephone or in writing. When making contact, necessarily indicate the refrigerator model and number. You will find this data on the product label, which is glued to the left wall of the refrigerator compartment near the fruit and vegetable trays.