

Overview

• Front View

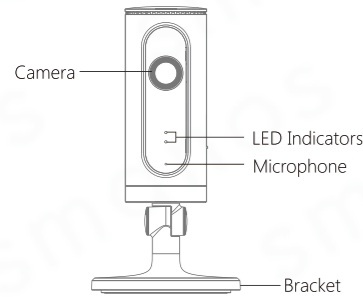

Red indicator	Blinking	Enter WiFi pairing state
Blue indicator	Blinking	Searching network
	On	Network connected

• Side View

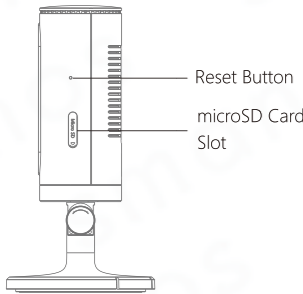

• Back View

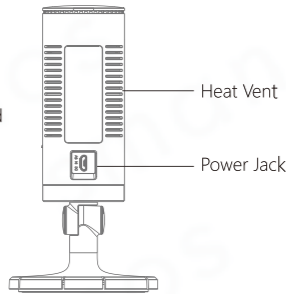

microSD Card (Not included)

Support 32GB microSD card maximum; please do not insert the card after the camera is powered on.

This camera automatically records and saves video once every 20 minutes; the video recorded at the earliest will be replaced with the latest ones if the microSD card is full.

Note: Please format your microSD card before inserting into this slot if any file had been written in.

Check What You Have

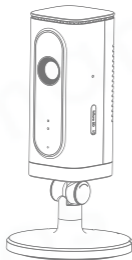

WiFi Camera×1

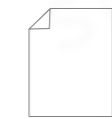

Quick Guidex1



AC Adapter×1



Reset Pin×1

Download the App

Download the App by searching “IP6 camera” from Apple Store or Google Play.



WiFi Pairing

1. Preparation

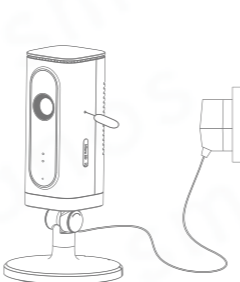

- Hold the reset button by using the supplied reset pin until the camera beeps once, and then the red indicator starts to blink
- Find and choose the WiFi named “smanos IP6” from your phone’s WiFi list

2. Pairing Camera with WiFi through App

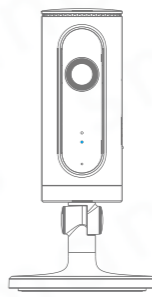
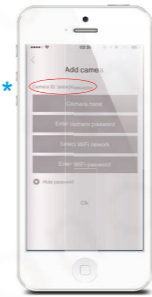

- Launch the App, and then tap [+] to add a new camera
- Name your camera, enter the password (default: 888888) and input your home WiFi name & password
- When the blue indicator is on, it means the camera has connected with WiFi

* Make sure the UID No. is displayed before tapping [OK]

The paired camera will be displayed in the video list.

Note: For safety, it is recommended to change the password of your camera on the setting menu after pairing.

smanos®

Settings

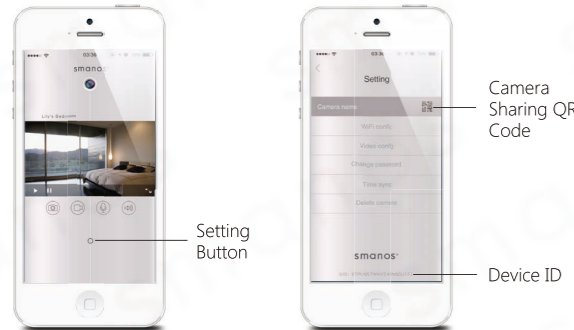

Share or Stop Sharing Camera with Your Friends



Tap and save the QR code icon on your camera's [Settings] interface, send to your friends so they can watch your camera from his/her App by scanning the given QR code.

If you want to stop sharing the camera, please change the password of camera.

Password

All the successfully paired phones have the same authority as administrator who can view and set the camera (including changing the password), so it is recommended to pair the phones of users with caution. For non-administrator users, you can share the camera by sending the QR code for them to scan.

Sync the Date and Time

Check if the camera's date and time are set correctly. Sync them with your phone's time if necessary.

Enjoy the App



Installation

Important: This camera should be placed where the WiFi signal is strong for optimal performance.

1. Separate the mounting template on the bottom of this camera from the bracket by pressing the snap as picture shows

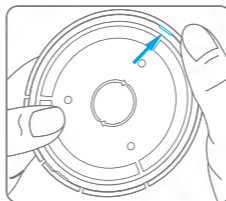

2. Mount the template on the wall by using the supplied screws

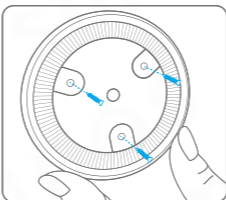

3. Push and press the bracket of the camera into the template carefully, and then adjust the angle to achieve best shooting effect



Specifications

Image sensor	Sony 1/3" CMOS sensor
Min. illumination	Color: 0.01Lux@ (F1.2, AGC ON) Black and white : 0.001Lux@ (F1.2, AGC ON)
Shutter time	1/50s to 1/100,000s
Lens	2.4mm F2.0
Angle of view	110°
Video compression	H.264
Bit rate	Self-adaption
Max. image resolution	1280 x 720
Frame rate	30fps (1280 × 720)
Storage	Built-in microSD card slot, up to 32GB
Wireless standards	IEEE802.11b/g/n
Frequency range	2.4 GHz ~ 2.4835 GHz
Channel bandwidth	20/40MHz Support
Operating conditions	Temperature: -30 °C - 60 °C (-22 °F - 140 °F) Humidity: < 95% (non-condensing)
Power supply	DC 5V 1A
Power consumption	5W MAX
Dimensions (L x W x H)	80 x 80 x 150 mm

smanos®
Dream Big. Live Smart.

QUICK GUIDE

IP6 HD WiFi Camera