

Headlight Manual

PR900

900
LUMENS

Technical Specifications

LED : 2* Cree XP-G2 with a lifespan of 50000 hours
Battery: 5200mAh/3.7V rechargeable Lithium-ion battery
Dimensions (Headlight): 100mm (L)*48mm (W)*27mm (H)
Weight (Headlight): 202g
Materials: The front and main body is made by aluminum with Mil Type III Hard Coat Anodizing; the rear part and the handlebar mount are made by durable plastic
Package includes: front Bike light*1, handlebar mount*1, M form rubber pad*1, EVA bar pad*2, USB cable*1, wired remote button*1, O ring *2

Performance Parameters

Mode	Brightness level	Brightness (Lumens)	Run Time (hrs)	Max distance	Impact resistance	Waterproof
ROAD Biking	High	400	4.5	125 meters	1 meter	IPX8 Underwater 2m
	Mid	200	7.5			
	Low	100	13.5			
	Eco	50	20			
MOUNTAIN Biking	Pulse flashing	100	/	125 meters	1 meter	IPX8 Underwater 2m
	High	800	2.5			
	Mid	500	3.5			
Emergency	Low	300	7	125 meters	1 meter	IPX8 Underwater 2m
	Turbo	900	/			

Notes:

- 1) The above data are tested in Lab in line with ANSI/NEMA FL1 standard and may vary by environment and user conditions;
- 2) Only the low beam will be on in Road Biking mode; Both the high beam and the low beam will be on in Mountain Biking and Emergency modes;
- 3) The max output in Emergency mode is 900Lumens and may decrease as battery drains;
- 4) To meet IPX8 waterproof standard, please make sure the tail USB and Micro USB caps are securely mounted after usage.

Quick Guide

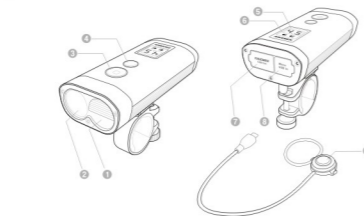

NO.	Item	Description
1	Low beam	Engineered Dual Lens optical design for road biking and providing anti-glare closed range flood light, perfect for commuting.
2	High beam	Provides far reaching beam in Mountain Biking and Emergency modes.
3	Power button	1) Long press the button 0.5s to turn on/off power. 2) Single click for mode changing between Road Biking and Mountain Biking modes.
4	Menu button	1) When power is on, single click to change brightness levels in Road Biking or Mountain Biking modes. 2) When power is on, press the button 0.3s and hold to activate Emergency mode, release to go back to previous mode and brightness level.

LED runtime display

- 1) To display the runtime of each brightness levels; It is calculated and displayed by hour when remaining runtime is above 10 hours; and it will be calculated by 0.5 hour when it is below 10 hours.
- 2) The display refreshes at intervals of 0.5 when remaining runtime is above 1 hour, and refreshes at intervals of 0.1 when below 1 hour.
- 3) Low battery indicator: A "Lo" signal will flash when the light is running out of power.

Note: The LED display will flash firstly when the light is turned on for calibration. The remaining runtime is calculated under the current brightness and will vary along with the brightness changing.

Mode indicators

- When icon is on, indicating the light is in Road Biking Mode;
- When icon is on, indicating the light is in Mountain Biking Mode.

USB output port

- Max output: 5V, DC/1.5A. use as power bank to charge digital products: cell phone, tablets, MP3/MP4, etc; build in over-discharge protection;
- The LED display will show "CC" when charging the connected device.

Micro USB input port

- 1) Max input: 5V, DC/ 1.5A; build in over-charge protection;
- 2) To connect with the wired remote button

Wired remote button

- Plug into the Micro USB port:
- 1) When power is on, single click to change brightness levels in Road Biking or Mountain Biking modes.
- 2) When power is on, press the button 0.3s and hold to activate Emergency mode, release to go back to previous mode and brightness level.

Other features

- 1) Intelligent thermal management circuit to prevent overheat of LEDs.
- 2) Intelligent Memory circuit remembers the last used brightness level and mode when turned on again.

Mounting Your Light

- 1) Select the suitable configuration for your handlebar:

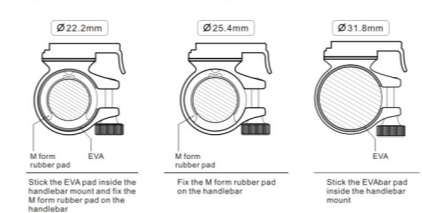

- 2) Mount the handlebar mount and screw the dial to tighten it: (check the screw whether it is tightened or not before riding)

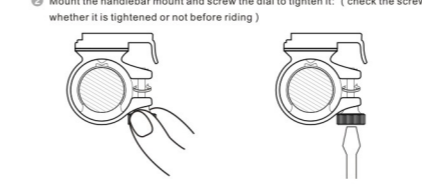

- 3) Slide the headlight in the right direction to connect with the handlebar mount and adjust the angle for actual needs



- 4) Press and hold the quick release tab and slide out the light



- 5) Plug the wired remote button into the tail Micro USB port and use the O ring to fix it near the grip as below:

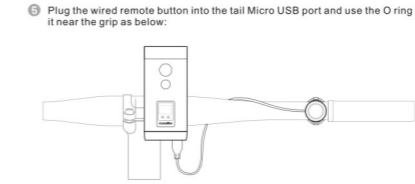

Battery Charging

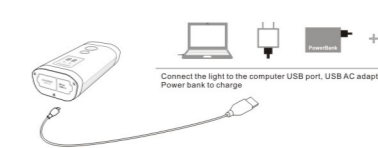

Standard charging time: 5.5h (5 V, DC/ 1.5A), approximate values and may vary by user conditions.
 The LED display will flash in the form of marquee sign during charging process, and the screen will display number 88 when charging is completed.

Attention!

- For your safety, please read this manual thoroughly and use your light accordingly. Make sure the Light is mounted securely on the handlebar each time before riding. Release the bike light from the handlebar mount while in the outdoors in case of theft. To maintain the best performance and extending the life of the Lithium-ion battery:
1. Check the battery and charge the battery up before your first riding.
2. Avoid completely discharging, allow partial discharges and avoid over charging (usually)
3. Keep and storage your light at room temperature
4. Charge your light every 3 months for long term storage
5. Make two complete charging and discharging cycle to calibrate the led display after long term storage

Alert!

Don't stare the light directly when on, otherwise it may cause temporally blindness. For others' safety, don't shine the light(high beam) directly to oncoming vehicles and pedestrians. Keep the light away out of Children's reach. And children should be accompanied by adults when using the light. Don't disassemble or modify the light, otherwise it may cause danger and void your warranty.

Danger!

Lithium-ion battery inside, don't put the light in a fire, otherwise it may cause explosion! Please charge the light with qualified USB power adapter, using defective USB power adapter may cause power leakage or fire disaster, etc. Ravemen is not responsible for any of such consequences.

Warranty

We proudly claim and warrant our products free of defects in material and workmanship for 2 years from the day of purchase under normal use. If a covered defect occurred, return the light to the place of purchase. If this happens within 15 days from the day of purchase, we will replace the defect model with a brand new one without extra charges; After 15 days from the day of purchase, handling and transportation charges shall be borne by person desiring service. Limited lifetime warranty is also available after 2 years free warranty period and the cost of service and spare parts will be charged accordingly.

Warranty Exclusions:

1. Without original sales receipt or proof of the purchase
2. Normal wear and tear and normal battery deterioration
3. Unauthorized modifications or alterations, improper use and maintenance

Web site: www.ravemen.com
 Tel/Fax: +86-755-29064166
 Email: support@ravemen.com
 Address: 6F YouLian Building, GuShu road, Bao'an Avenue, ShenZhen 518126, China

