



Contents

1. Important Safety Instructions.....	2
2. Package Contents and Technical Specifications.....	6
2.1 Package Contents.....	6
2.2 Specifications.....	6
2.3 Product Diagram.....	7
3. Operating and Programming.....	9
3.1 Notes Before Cleaning.....	9
3.2 Quick Start.....	10
3.3 Cleaning Mode Selection.....	13
3.4 Programming the Robot.....	15
3.5 Optional Advanced Wet/Dry Mopping System.....	17
3.6 Alarm Indicator and Sounds.....	19
4. Maintenance.....	20
4.1 Dust Bin and Filters.....	20
4.2 Advanced Wet/Dry Cleaning Cloth, Advanced Wet/Dry Reservoir.....	21
4.3 Main Brush and Side Brushes.....	22
4.4 Other Components.....	23
4.5 Regular Maintenance.....	24
5. Troubleshooting.....	25



1. Important Safety Instructions

When using an electrical appliance, basic precautions should always be followed, including the following:

READ ALL INSTRUCTIONS BEFORE USING THIS APPLIANCE.

SAVE THESE INSTRUCTIONS

1. This Appliance can be used by children aged from 8 years and above and persons with reduced physical, sensory or mental capabilities or lack of experience and knowledge if they have been given supervision or instruction concerning use of the Appliance in a safe way and understand the hazards involved. Children shall not play with the Appliance. Cleaning and user maintenance shall not be made by children without supervision.
2. Clear the area to be cleaned. Remove power cords and small objects from the floor that could entangle the Appliance. Tuck rug fringe under the rug base, and lift items such as curtains and tablecloths off the floor.
3. If there is a drop off in the cleaning area due to a step or stairs, you should operate the Appliance to ensure that it can detect the step without falling over the edge. It may become necessary to place a physical barrier at the edge to keep the unit from falling. Make sure the physical barrier is not a trip hazard.
4. Only use as described in this manual. Only use attachments recommended or sold by the manufacturer.
5. Please make sure your power supply voltage matches the power voltage marked on the Charging Dock.
6. For INDOOR household use ONLY. Do not use the Appliance in outdoor, commercial or industrial environments.
7. Non-rechargeable batteries are prohibited. For battery information, please refer to Specifications section.
8. Do not use without dust bin and/or filters in place.



1. Important Safety Instructions

9. Do not operate the Appliance in an area where there are lit candles or fragile objects.
10. Do not use in extremely hot or cold environments (below -5°C/23°F or above 40°C/104°F).
11. Keep hair, loose clothing, fingers, and all parts of body away from any openings and moving parts.
12. Do not operate the Appliance in a room where an infant or child is sleeping.
13. Do not use Appliance on wet surfaces or surfaces with standing water.
14. Do not allow the Appliance to pick up large objects like stones, large pieces of paper or any item that may clog the Appliance.
15. Do not use Appliance to pick up flammable or combustible materials such as gasoline, printer or copier toner, or use in areas where they may be present.
16. Do not use Appliance to pick up anything that is burning or smoking, such as cigarettes, matches, hot ashes, or anything that could cause a fire.
17. Do not put objects into the suction intake. Do not use if the suction intake is blocked. Keep the intake clear of dust, lint, hair, or anything that may reduce air flow.
18. Take care not to damage the power cord. Do not pull on or carry the Appliance or Charging Dock by the power cord, use the power cord as a handle, close a door on the power cord, or pull power cord around sharp edges or corners. Do not run Appliance over the power cord. Keep power cord away from hot surfaces.
19. If the power cord is damaged, it must be replaced by the manufacturer or its service agent in order to avoid a hazard.
20. Do not use the Charging Dock if it is damaged.



1. Important Safety Instructions

21. Do not use with a damaged power cord or receptacle. Do not use the Appliance or Charging Dock if it is not working properly, has been dropped, damaged, left outdoors, or come in contact with water. It must be repaired by the manufacturer or its service agent in order to avoid a hazard.
22. Turn OFF the power switch before cleaning or maintaining the Appliance.
23. The plug must be removed from the receptacle before cleaning or maintaining the Charging Dock.
24. Remove the Appliance from the Charging Dock, and turn OFF the power switch to the Appliance before removing the battery for disposal of the Appliance.
25. The battery must be removed and discarded according to local laws and regulations before disposal of the Appliance.
26. Please dispose of used batteries according to local laws and regulations.
27. Do not incinerate the Appliance even if it is severely damaged. The batteries can explode in a fire.
28. When not using the Charging Dock for a long period of time, please unplug it.
29. The Appliance must be used in accordance with the directions in this Instruction Manual. ECOVACS ROBOTICS cannot be held liable or responsible for any damages or injuries caused by improper use.
30. The robot contains batteries that are only replaceable by skilled persons. To replace or remove the battery, please contact Customer Service.
31. If the robot will not be used for a long time, fully charge the robot and power OFF for storage and unplug the Charging Dock.
- 32. WARNING:** For the purposes of recharging the battery, only use the detachable supply unit CH1465A provided with this appliance.



1. Important Safety Instructions

- 33. The Remote Control pre-installs two non-rechargeable AAA batteries. To replace the battery of the Remote Control, please turn over the Remote Control, press and remove its Battery Cover. Remove the batteries, and insert the new batteries with the correct polarity. Reassemble the Battery Cover.
- 34. Non-rechargeable batteries are not to be recharged.
- 35. Different types of batteries or new and used batteries are not to be mixed.
- 36. Batteries of the Remote Control are to be inserted with the correct polarity.
- 37. Exhausted batteries are to be removed from the Appliance and safely disposed of.
- 38. If the Remote Control is to be stored unused for a long period, the batteries should be removed.
- 39. The supply terminals are not to be short-circuited.

For EU Countries



Correct Disposal of this Product

This marking indicates that this product should not be disposed of with other household waste throughout the EU. To prevent possible harm to the environment or human health from uncontrolled waste disposal, recycle it responsibly to promote the sustainable reuse of material resources. To recycle your used device, please use the return and collection systems or contact the retailer where the product was purchased. They can safely recycle this product.



2. Package Contents and Technical Specifications

2.1 Package Contents

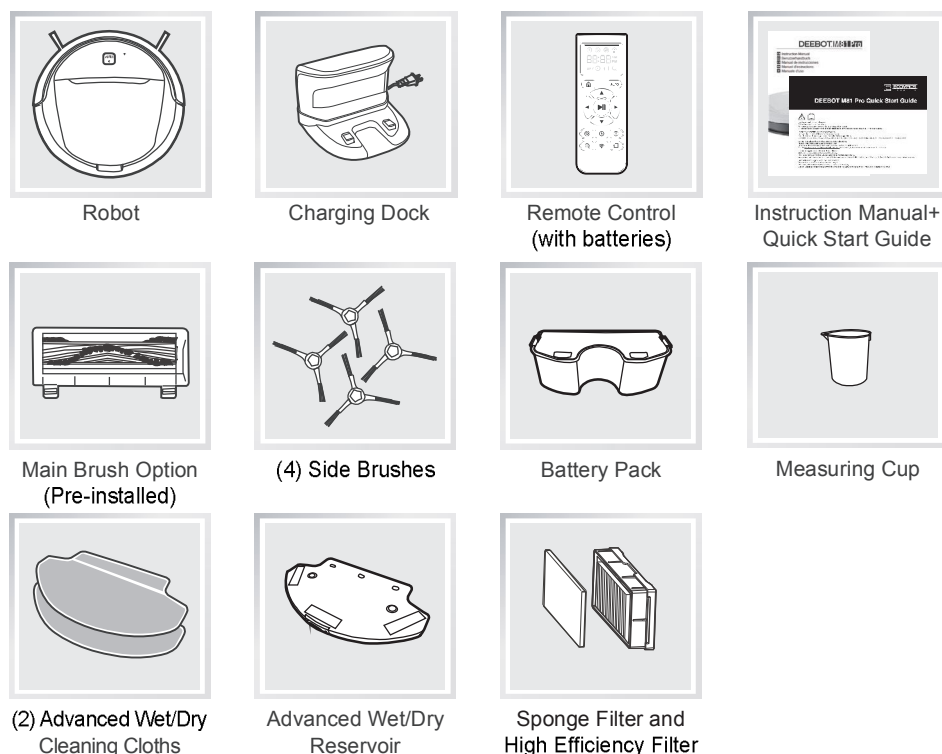

2.2 Specifications

Model	DB3G.21		
Working Voltage	12V DC	Rated Power	40W
Battery Model	DN700-BYD	Battery Specification	Ni-MH 12 V DC, 3000 mAh
Charging Dock Model	CH1465A		
Rated Input Voltage	100-240V AC	Rated Output Voltage	20V DC
Rated Output Current	1A	Rated Power	20W
Remote Control Model	RC1507	Remote Control Battery Model	AAA
Remote Control Battery Input Voltage	1.5V DC	Remote Control working voltage	3V DC
Frequency bands	2412-2472MHz		
Maximum RF power transmitted in the frequency band	Max PA output power at 72.2 Mbps: 17.5 dBm		
	Max PA output power in 11b mode: 21.5 dBm		

* Technical and design specifications may be changed in the course of continuous product improvement.



2. Package Contents and Technical Specifications

2.3 Product Diagram

Robot

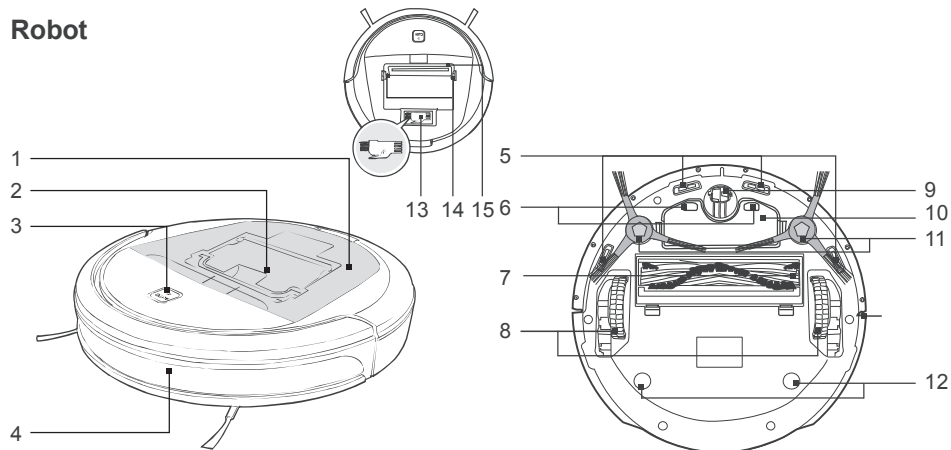

- | | | |
|---------------------------|----------------------|--|
| 1. Top Cover | 6. Charging Contacts | 11. Side Brushes |
| 2. Dust Bin | 7. Main Brush | 12. Advanced Wet/Dry Reservoir Slots |
| 3. AUTO Mode Button | 8. Driving Wheels | 13. Multi-Function Cleaning Tool |
| 4. Anti-Collision Sensors | 9. Universal Wheel | 14. Upgrade Port (for Customer Service only) |
| 5. Anti-Drop Sensors | 10. Battery Pack | 15. Infrared Receiver for the Remote Control |

Control Panel



- | |
|--------------------------|
| 1. AUTO Mode Button |
| 2. Wi-Fi Indicator Light |

Charging Dock

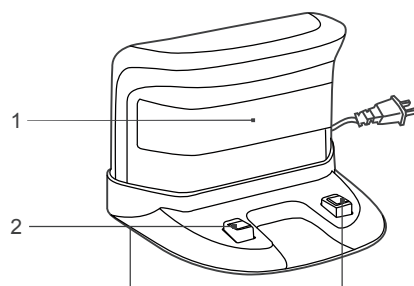

- | |
|-------------------------------|
| 1. Infrared Signal Generators |
| 2. Charging Dock Pins |



2. Package Contents and Technical Specifications

Remote Control

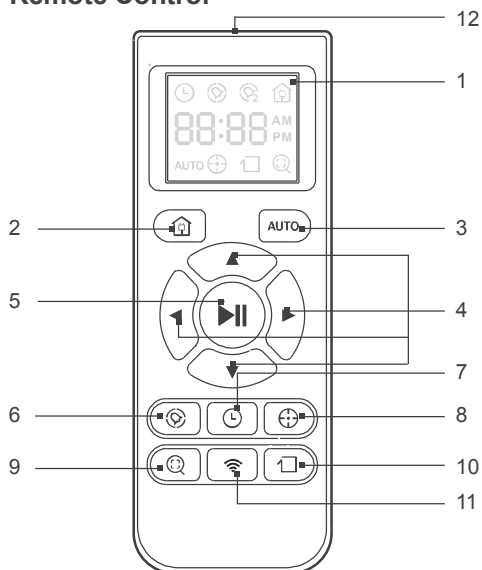

1. LCD Screen
2. Return to Charger Mode Button
3. AUTO Mode Button
4. Direction Control Buttons
5. START/PAUSE Button
6. Time Scheduling Button
7. Set Current Time Button
8. Spot Cleaning Mode Button
9. Intensive Cleaning Mode Button
10. Edge Cleaning Mode Button
11. Network Setup Button
12. Infrared Emitter

Dust Bin

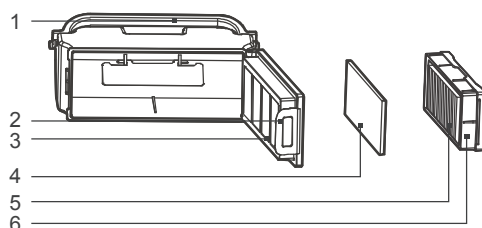

1. Dust Bin Handle
2. Dust Bin Lock
3. Filter Net
4. Sponge Filter
5. High Efficiency Filter
6. Dust Bin Cover

Advanced Wet/Dry Reservoir

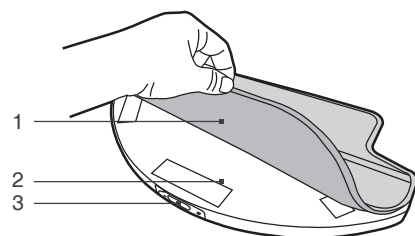

1. Advanced Wet/Dry Cleaning Cloth
2. Advanced Wet/Dry Reservoir
3. Water Inlet

3. Operating and Programming

3.1 Notes Before Cleaning

Before operating DEEBOT, take a few moments to survey the area to be cleaned and remove any obstacles.

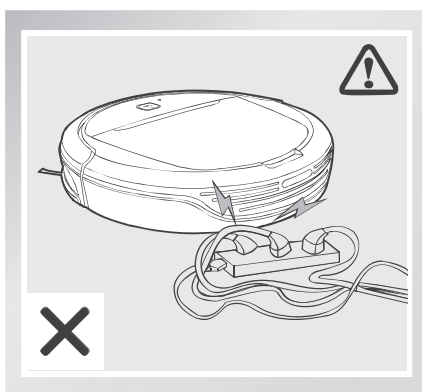

Remove power cords and small objects from the floor that could entangle the product.

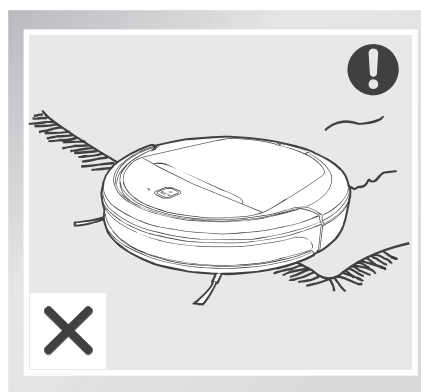

The product is not suitable for use on long-pile carpet. Before using the product near an area rug or on a short-pile area rug with tasseled edges, please fold area rug edges under themselves.



Please be aware that the robot needs at least an 8 cm (3") clearance to clean under furniture without complications.

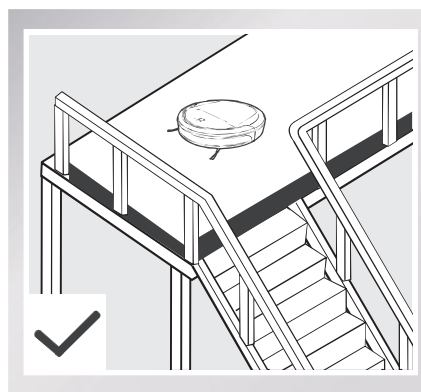

If there is a step or stairs in the cleaning area, please operate DEEBOT to ensure its Anti-Drop Sensors can detect the drop off. It may be necessary to place a physical barrier at the edge of the drop off to keep the unit from falling over the edge.

3. Operating and Programming

3.2 Quick Start

1 Charging Dock Placement

- Place the Charging Dock on a level floor surface against the wall with the base perpendicular to the ground. Keep the immediate area 1.5m (5') in front of the charger and 0.5m (1.6') on both sides of the charger clear of objects and reflective surfaces.
- Plug the Charging Dock in.

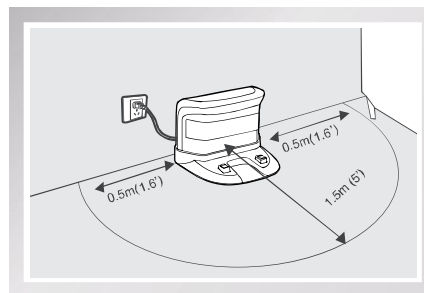

2 Install the Battery Pack

- Place the Battery Pack into the battery slot on the bottom of DEEBOT. Press the Battery Pack into the slot until it clicks.

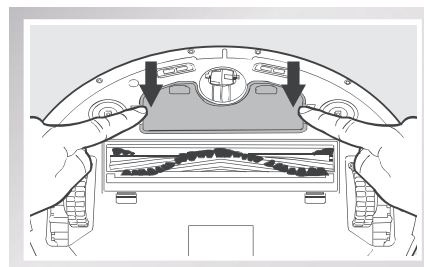
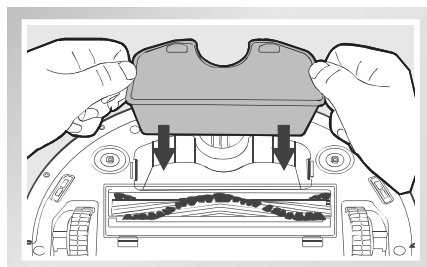

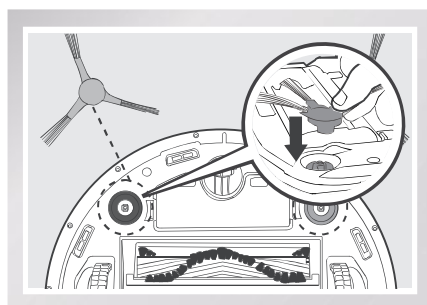

3 Install Side Brushes

- Attach Side Brushes to the bottom of DEEBOT by pressing a brush into each slot with the matching color until it clicks.



4 Power ON

- Press and hold the  button on the robot. DEEBOT is powered ON when the  glows a continuous BLUE.

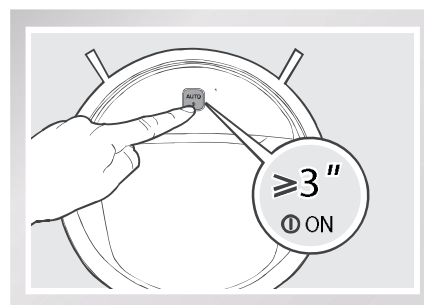

3. Operating and Programming

5 Charge DEEBOT

- Remove the Advanced Wet/Dry Reservoir before charging DEEBOT.
- Place DEEBOT on the Charging Dock making sure the Charging Contacts on DEEBOT and the Charging Dock Pins make a connection.
- Charge DEEBOT for at least 4 hours before the first use.

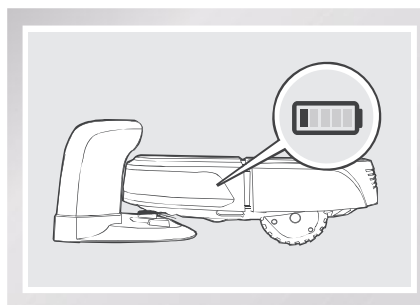

*  button blinks when DEEBOT is charging and stops glowing when DEEBOT is fully charged.

6 Attach a Cleaning Cloth, if Desired

- To use DEEBOT's Optional Advanced Mopping System, attach the provided Cleaning Cloth.

* When using the optional mopping feature, fold area rug edges under themselves so DEEBOT will avoid the rug.
 * Please see section 3.5 Optional Advanced Wet/Dry Mopping System for complete instructions.



3. Operating and Programming

7 Start

- Press the  button on DEEBOT or the AUTO Mode Button on the Remote Control. DEEBOT starts to work immediately in AUTO Cleaning Mode.

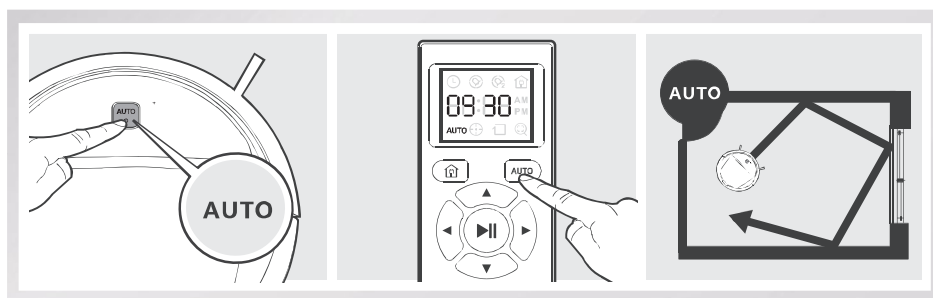

- * To choose another Cleaning Mode, please refer to section 3.3 Cleaning Mode Selection for details.
- * DEEBOT can be directed using the Direction Control Buttons on the Remote Control or App when Paused.

8 Pause

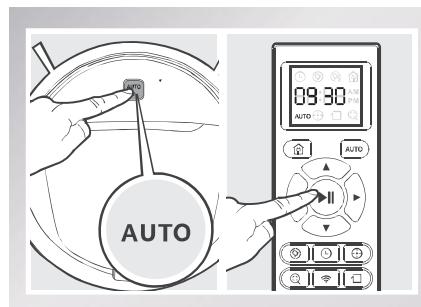

- Pause DEEBOT by pressing the  button on DEEBOT or the START/PAUSE Button on the Remote Control.



- * The AUTO Mode Button on the robot's Control Panel stops glowing when the robot is paused for more than 10 minutes. Press AUTO Mode Button on the robot to wake up the robot, or press any button on the Remote Control to start the DEEBOT immediately.

3. Operating and Programming

9 Power OFF

- Pause DEEBOT. Press and hold the  button on the robot. DEEBOT is powered OFF when the  button stops glowing.

* When DEEBOT is not cleaning, it is suggested to keep it powered ON and charging instead of powered OFF.

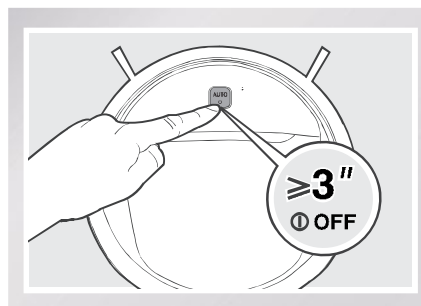

* For models with app-connectivity, various functions can be performed using the ECOVACS App.

3.3 Cleaning Mode Selection

DEEBOT has several cleaning modes to choose from to effectively clean different floors. Cleaning modes are selected using the Remote Control.

1 AUTO Cleaning Mode

- This is the most commonly used mode. In AUTO Cleaning Mode, DEEBOT cleans in a straight line and changes direction when it meets an obstacle.

* To start AUTO Cleaning Mode, press the AUTO Mode Button on the robot.

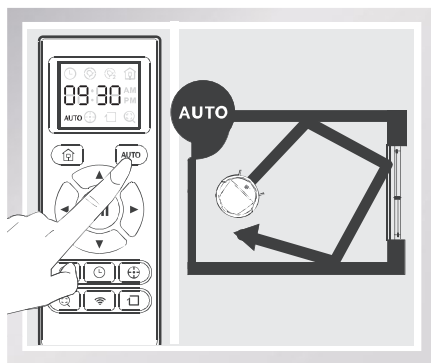

2 Intensive Cleaning Mode

- This mode is good for aggressive cleaning or for extremely dirty or dusty floors. To start Intensive Cleaning, press the Intensive Cleaning Button on the Remote Control. In this mode, DEEBOT follows the same cleaning pattern as Automatic Cleaning Mode, but with stronger suction power and higher Main Brush rotating speed and performs a more thorough cleaning.

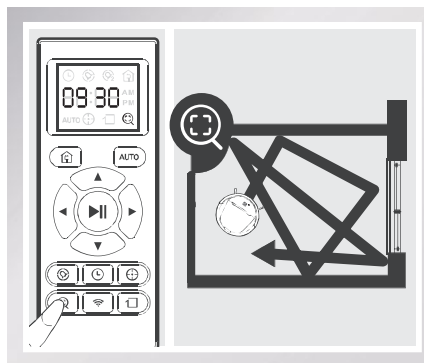

3. Operating and Programming

3 Spot Cleaning Mode (2-5 minutes)

- This mode is applicable for an area of highly concentrated dirt or dust. In Spot Cleaning Mode, DEEBOT focuses on a specific area to clean. DEEBOT cleans the area in a spiral pattern and stops when it completes Spot Cleaning.
- To start Spot Cleaning Mode, press the Spot Mode Button on the Remote Control, or  on the App main screen.

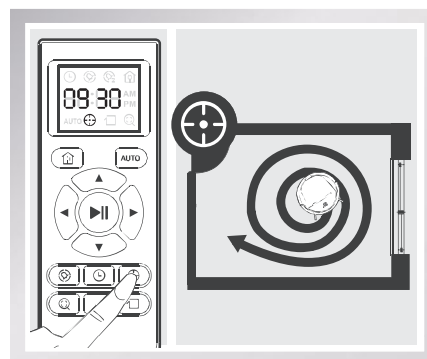

4 Edge Cleaning Mode

- This mode is good for cleaning the edges and corners of a room. To start Edge Cleaning Mode, press the Edge Cleaning Mode Button on the Remote Control. In Edge Cleaning Mode, DEEBOT cleans along a border (e.g. wall).

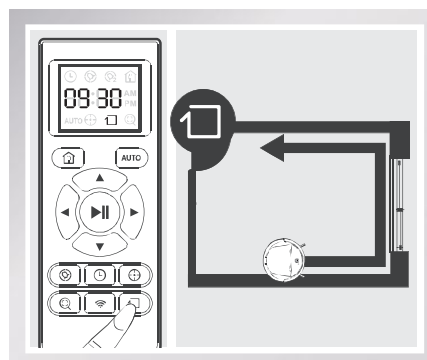

5 Return to Charger Mode

- When battery power gets low, DEEBOT automatically switches to Return to Charger Mode and returns to the Charging Dock to recharge itself.

* DEEBOT can also be sent back to the Charging Dock at any time by pressing the Return to Charger Button on the Remote Control.

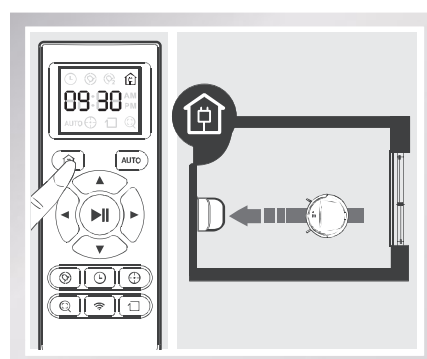

3. Operating and Programming

3.4 Programming the Robot

DEEBOT has a Time Scheduling function. DEEBOT can be programmed to automatically clean once per day, at a specific time using the Remote Control, even if nobody is at home. The current time of day and the cleaning times are scheduled using the Remote Control.

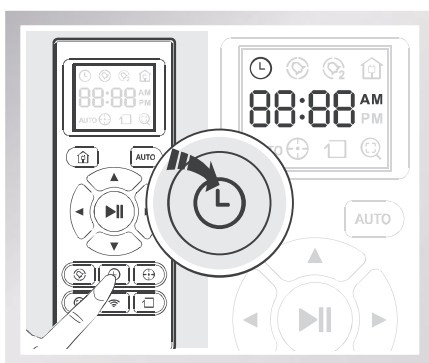

- * All scheduled cleanings are performed in AUTO Cleaning Mode.
- * The Remote Control uses a 12-hour clock with "AM" and "PM" indicators.

1 Set the Current Time of Day

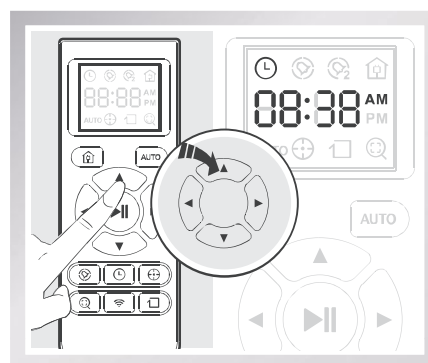

Press  button on the Remote Control and the "hour" (first two digits) flashes on the Remote Control LCD Screen.



Press the up and down Direction Control Buttons  to adjust "hour" and "minute" number. Press the left and right Direction Control Buttons  to switch between "hour" and "minute."

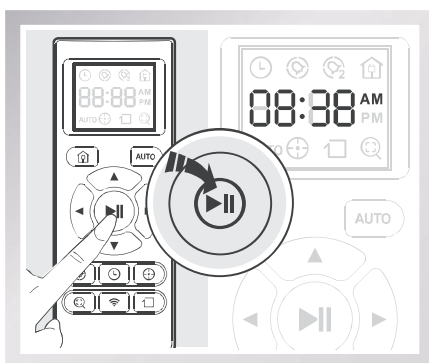



Press  button on the Remote Control to confirm and save the current time of day.

3. Operating and Programming

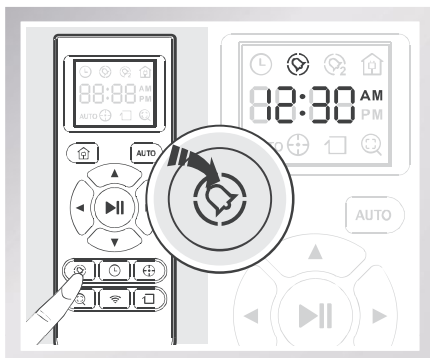

2 Schedule the Cleaning Time using Remote Control



Press  button on the Remote Control and the "hour" (first two digits) flashes on the Remote Control Screen.

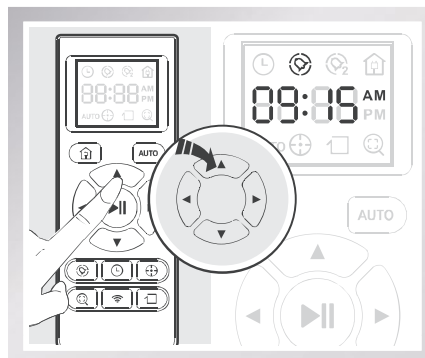

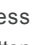
Press  button on the Remote Control to confirm and save the scheduled cleaning time. DEEBOT emits two beeps. DEEBOT automatically cleans at the scheduled cleaning time every day.

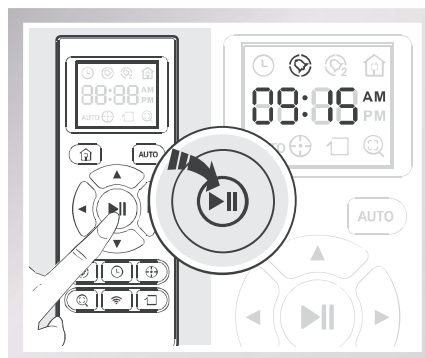

Press the up and down Direction Control Buttons  to adjust "hour" and "minute" number. Press the left and right Direction Control Buttons  to switch between "hour" and "minute."

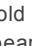

3 Cancel Scheduled Cleaning Time using Remote Control

To cancel the scheduled cleaning time, press and hold  button for 3 seconds until  disappears from the Remote Control LED Screen and the robot emits three beeps. The scheduled cleaning time is cancelled.

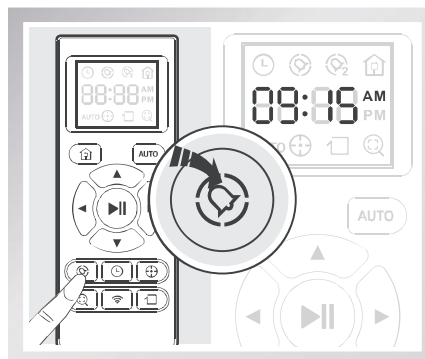

3. Operating and Programming

3.5 Optional Advanced Wet/Dry Mopping System

DEEBOT has an Optional Advanced Mopping System using an Advanced Wet/Dry Cleaning Cloth attached to a proprietary Advanced Wet/Dry Reservoir. The washable/reusable Cleaning Cloth automatically damp mops and then dries the floor to a spotless clean.

- * Do not use the mopping system on carpet.
- * When using the mopping system, fold area rug edges under themselves so DEEBOT will avoid the rug.
- * When using the mopping system, do not stop the robot and allow it to stand still. This prevents the Advanced Wet/Dry Cleaning Cloth from leaving water on the floor.
- * Remove the Advanced Wet/Dry Reservoir before charging DEEBOT.

1 Attach Advanced Wet/Dry Cleaning Cloth

- Attach the Advanced Wet/Dry Cleaning Cloth to the Advanced Wet/Dry Reservoir.

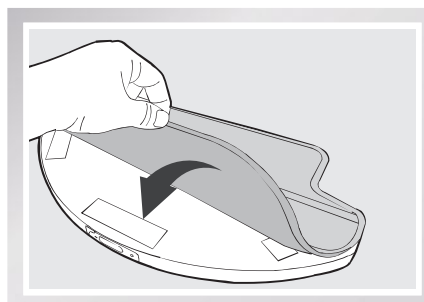

2 Add Water to the Advanced Wet/Dry Reservoir

- * Before adding water to the Advanced Wet/Dry Reservoir, remove the Advanced Wet/Dry Reservoir from the bottom of the robot.

Fill the provided Measuring Cup with water. Open the lid of the Water Inlet on the Advanced Wet/Dry Reservoir and slowly pour water from the Measuring Cup into the Reservoir. Close the Water Inlet lid.

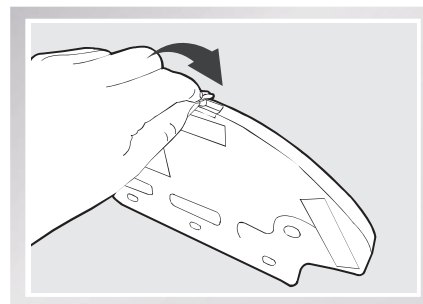
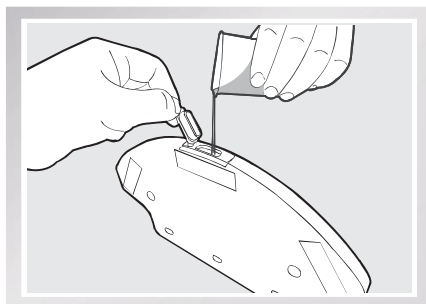

3. Operating and Programming

Attach the Advanced Wet/Dry Reservoir to the bottom of the robot. Insert the tabs on the Advanced Wet/Dry Reservoir into the Advanced Wet/Dry Reservoir Slots on the bottom of the robot until you hear a click.

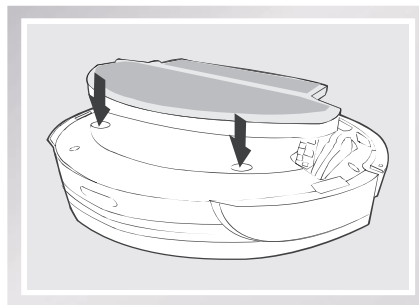

3 Start

- Select the desired Cleaning Mode. DEEBOT sweeps, lifts, vacuums, mops and dries in the selected mode.

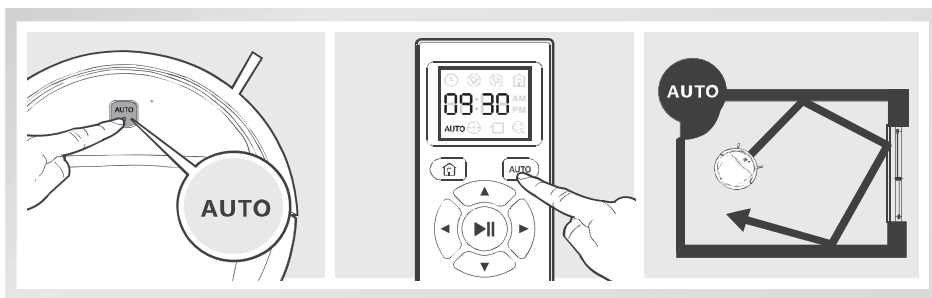

4 Remove

- After DEEBOT finishes cleaning, remove the Advanced Wet/Dry Reservoir from DEEBOT, empty any remaining water from the Reservoir, and remove the Advanced Wet/Dry Cleaning Cloth.

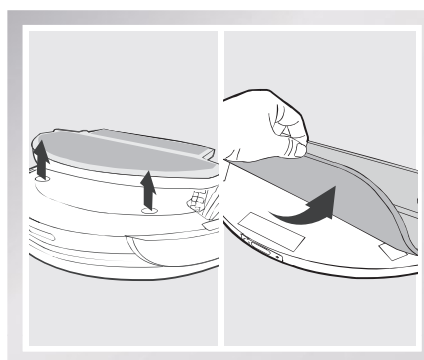



3. Operating and Programming

3.6 Alarm Indicator and Sounds

If DEEBOT detects a problem and needs your assistance, it emits alarm beeps and the AUTO Mode Button flashes RED.

Alarm Sound	Problems	Solution
One Beep	Driving Wheel Malfunction	Check Driving Wheels for tangled hair or debris and clean as described in section 4 Maintenance.
Three Beeps	Driving Wheel Malfunction	Turn over the robot. Press Driving Wheels to check for a clicking sound. If they do not click, please contact Customer Service.
	DEEBOT gets into trouble while working and stops	Manually remove the obstacles and restart DEEBOT.
Four Beeps	Dust Bin Malfunction	Remove the Dust Bin and re-install it properly. If the robot still emits the alarm, please contact Customer Service.
Five Beeps	Low Battery	Manually place the robot on the Charging Dock to charge.
Six Beeps	Side Brush Malfunction	Check Side Brushes for tangled hair or debris and clean as described in section 4 Maintenance.
Seven Beeps	Anti-Drop Sensor Malfunction	Check Anti-Drop Sensors for dust and clean as described in section 4 Maintenance.

4. Maintenance

Before performing cleaning and maintenance, power OFF DEEBOT and unplug the Charging Dock.

4.1 Dust Bin and Filters

Open DEEBOT's Top Cover and remove the Dust Bin. Open the Dust Bin Cover and empty the Dust Bin.

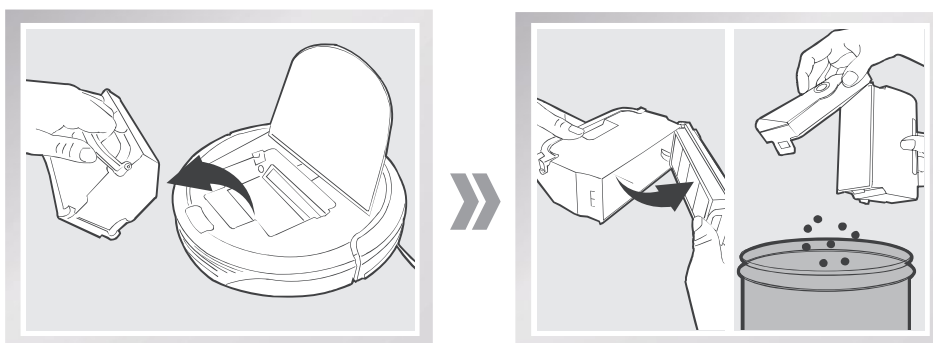

Remove the Sponge Filter and High Efficiency Filter. Pat the High Efficiency Filter clean. Do not rinse the High Efficiency Filter under water.

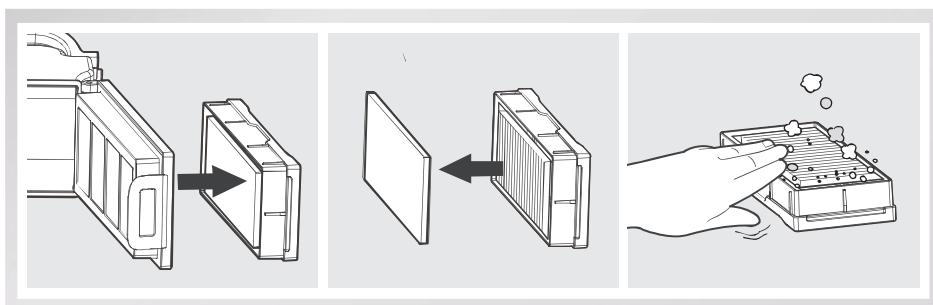

Rinse the Sponge Filter, Dust Bin and Filter Net under running water.

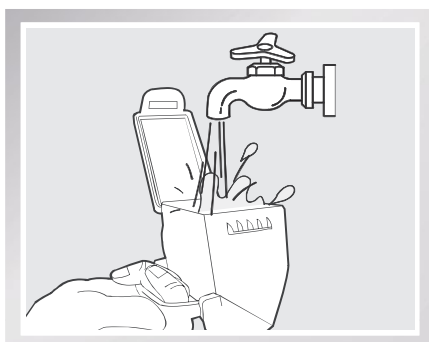

Dry the Sponge Filter, Dust Bin and Filter Net completely before reinstalling.

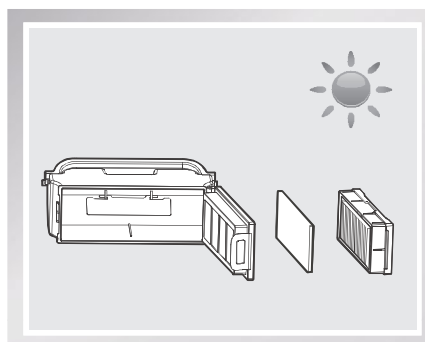

4. Maintenance

4.2 Advanced Wet/Dry Cleaning Cloth, Advanced Wet/Dry Reservoir

Cleaning the Advanced Wet/Dry Cleaning Cloth

If the mopping system was used, remove the Advanced Wet/Dry Reservoir from the bottom of DEEBOT and remove the Cleaning Cloth.

Empty any remaining water from the Reservoir.

Wash the Advanced Wet/Dry Cleaning Cloth by hand or in the washing machine, and lay flat to dry.

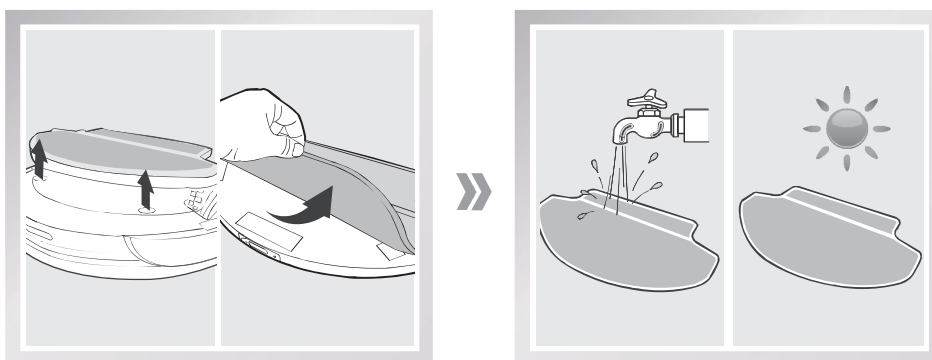

Cleaning the Advanced Wet/Dry Reservoir

If the mopping system was used, remove the Advanced Wet/Dry Reservoir from the bottom of DEEBOT.

Empty any remaining water from the Reservoir and set out to dry.

Wipe the outside of the Advanced Wet/Dry Reservoir with a dry cloth.

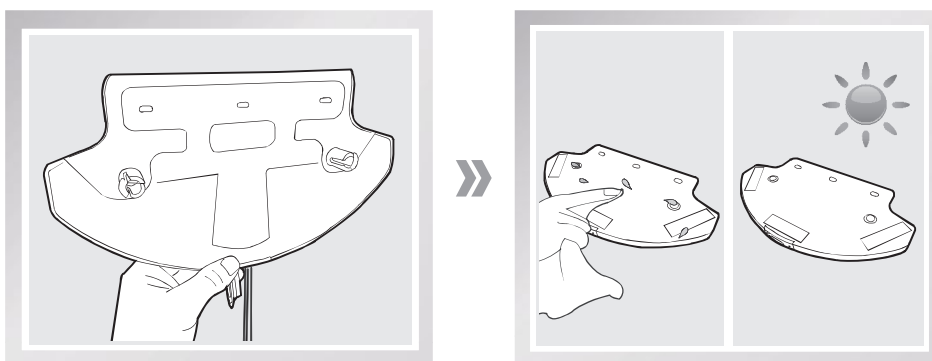

4. Maintenance

4.3 Main Brush and Side Brushes

* A Multi-Function Cleaning Tool is provided for easy maintenance. Handle with care, this cleaning tool has sharp edges.

Cleaning the Main Brush

Turn the robot over. Push both buttons on the Main Brush Cover and remove it.

Remove the Main Brush.

Use the Multi-Function Cleaning Tool to cut off and remove any hair tangled around the Main Brush.

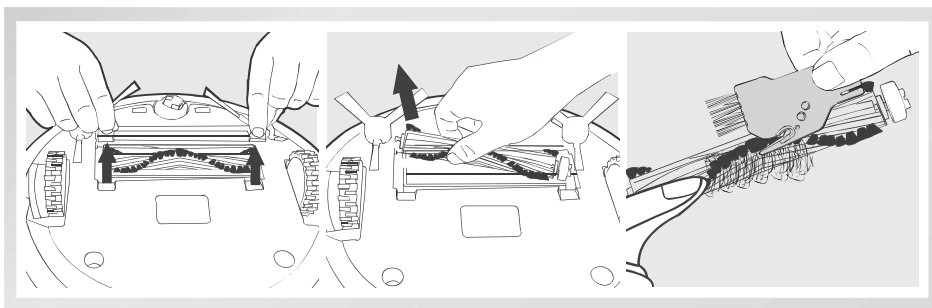

Cleaning the Side Brushes

Remove any hair or debris tangled around the Side Brushes with the provided Multi-Function Cleaning Tool. Remove the Side Brushes and wipe the Side Brushes and their slots with a clean cloth.

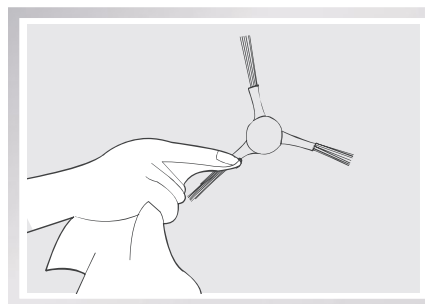

4. Maintenance

4.4 Other Components

Use the Multi-Function Cleaning Tool to cut off and remove any hair tangled around the Universal Wheel.

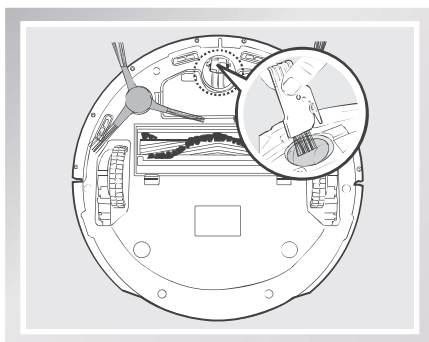

Wipe the Anti-Drop Sensors with the brush or the felt side of the Multi-Function Cleaning Tool to maintain their effectiveness.

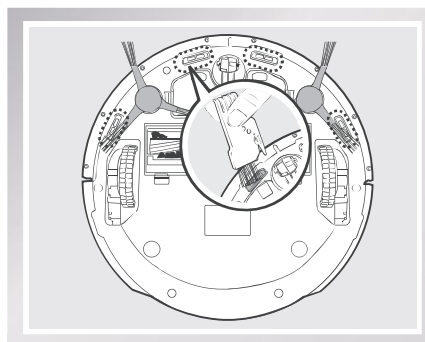

Wipe the Charging Contacts and Charging Dock Pins with the brush of the Multi-Function Cleaning Tool or a dry clean cloth to maintain their effectiveness.

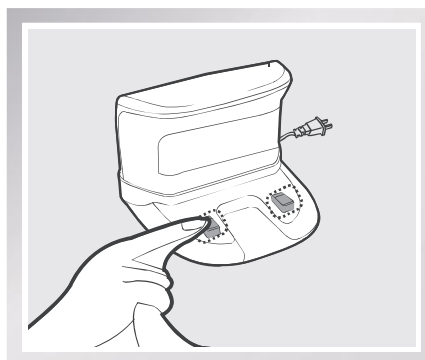
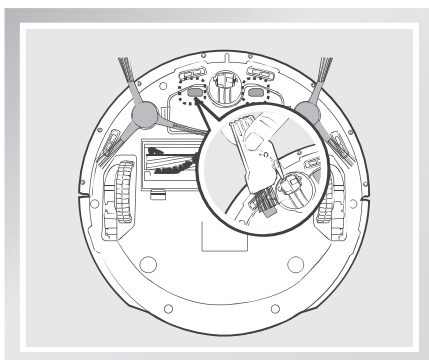



4. Maintenance

4.5 Regular Maintenance

To keep DEEBOT running at peak performance, perform the maintenance and replacement according to the following frequency. A multi-Function Cleaning Tool is provided for easy maintenance. Handle with care, this cleaning tool has sharp edges.

Robot Part	Maintenance Frequency	Replacement Frequency
Cleaning Cloth	After each use	Every 50 washings
Dust Bin Advanced Wet/Dry Reservoir	After each use	/
Side brush	Once every 2 weeks	Every 3-6 months
Main Brush	Once per week	Every 6-12 months
Sponge Filter/ High Efficiency Filter	Once per week (twice per week with pets in home)	Every 4-6 months
Universal Wheel Anti-Drop Sensors Charging Contacts Charging Dock Pins	Once per week	/

Note: ECOVACS manufactures various replacement parts and assemblies. Please contact Customer Service for more information on replacement parts.



5. Troubleshooting

Please use this chart to troubleshoot common problems using DEEBOT.

No.	Malfunction	Possible Causes	Solutions
1	DEEBOT will not charge.	DEEBOT is not powered ON.	Press and hold AUTO Mode Button on DEEBOT to power ON.
		DEEBOT has not made a connection with the Charging Dock.	Be sure that DEEBOT's Charging Contacts have made a connection with the Charging Dock Pins. You may move the robot manually to make the connection if necessary.
		Charging Dock is unplugged while DEEBOT is powered ON, which causes battery consumption.	Plug in the Charging Dock and ensure DEEBOT is powered ON. Keep DEEBOT on the Charging Dock to make sure it has a full battery to work at any time.
		The battery is completely discharged.	Re-activate the battery. Place DEEBOT on the Charging Dock by hand, remove after charging for 3 minutes, repeat 3 times; then charge normally.
2	DEEBOT gets into trouble while working and stops.	DEEBOT is tangled with something on the floor (electrical cords, drooping curtains, carpet fringe etc.).	DEEBOT will try various ways to get itself out of trouble. If it is unsuccessful, manually remove the obstacles and restart.
		Side Brush is stuck or the rotation speed of the Side Brush decreases.	Remove the debris tangled around the Side Brush. If the Side Brush still rotates slowly, contact Customer Service.
		Main Brush is stuck or the rotation speed of the Main Brush decreases.	Remove the debris tangled around the Main Brush with the provided Multi-Function Cleaning Tool. If the Main Brush still rotates slowly, contact Customer Service.
3	DEEBOT returns to the Charging Dock before it finishes cleaning.	When battery power gets low, DEEBOT automatically switches to Return to Charger Mode and returns to the Charging Dock to recharge itself.	This is normal. No solution necessary.
		Working time varies according to floor surface, room complexity and the selected Cleaning Mode.	This is normal. No solution necessary.



5. Troubleshooting

No.	Malfunction	Possible Causes	Solutions
4	DEEBOT will not clean automatically at scheduled time.	Time Scheduling function is cancelled.	Set Time Scheduling function as described in section 3.4.
		DEEBOT is powered OFF.	Power ON DEEBOT.
		The robot's battery is low.	Keep DEEBOT powered ON and on the Charging Dock to make sure it has a full battery to work at any time.
		The robot's components are tangled with debris.	Power OFF DEEBOT, clean the Dust Bin, and invert the robot. Clean Side Brushes and the Main Brush as described in section 4.
5	Remote Control failure (effective control range of Remote Control is 5m (16')).	The batteries in the Remote Control need to be replaced.	Replace with new batteries making sure they are installed correctly.
		DEEBOT is powered OFF or DEEBOT's battery is low.	Make sure DEEBOT is powered ON and fully charged.
		The infrared signal cannot be transmitted because the Infrared Emitter on the Remote Control or DEEBOT's Infrared Receiver on DEEBOT is dirty.	Use a dry cloth or the Multi-Function Cleaning Tool to wipe the Infrared Emitter on Remote Control and the Infrared Receiver on DEEBOT.
		There is other equipment interfering with the infrared signal to DEEBOT.	Avoid using the Remote Control near other equipment using infrared signals.