

DENVER®



Quick Start guide

BFH-11

WWW.DENVER-ELECTRONICS.COM

Please read this user manual carefully before start using the product.

Please charge the fitness band 30mins before using it.

Minimum requirement for your smartphone



IOS 7.1 & above



Android 4.4 & above



Support Bluetooth 4.0

1. Download BFH-11 app

The BFH-11 fitness band need to pair with the smart phone through app.

Search for **DENVER BFH-11** APP on Apple App Store or Google Play store

for android version and install the DENVER BFH-11 APP.



2. Device Activate & Charge

Make sure the DENVER BFH-11 device is charged before before initial use.

In case device is low on battery, connect the device to the charger clip and connect USB cable to your PC. The device will automatically boot up (please clamp the charging clip to the back 3 point position of bracelet as below)



3. Pair the device

Please make sure the Bluetooth is ON in your smartphone settings and then open app “DENVER BFH-11”. When searching and pairing device, please press on the key of device and activate the device (screen on). App will search the device automatically, choose the device name and connect the device to the app. Select the device in the smart phone searching list:

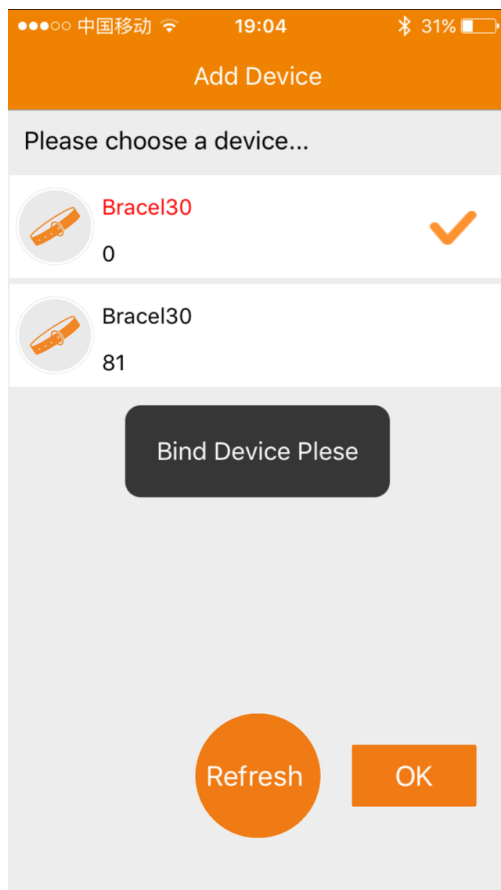

4. How to Use

Once the device connected to the app successfully, it will record and analyze your activities and sleep status automatically, please press the key on the device to switch into different display modes as following:

4.1. Normal Mode

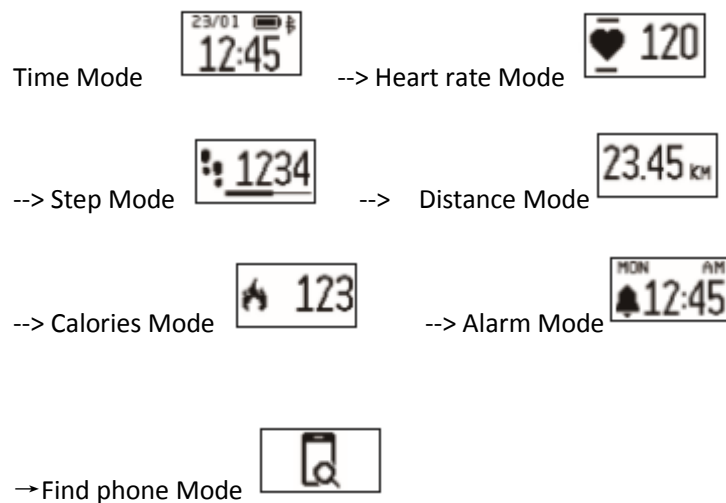

Note: Alarm Mode and Find phone Mode will only display on the device screen after switch turn ON in the APP!

4.2 Under normal mode, long press the key 2 seconds to enter into the history sports mode, (the latest sports data), then switch into different display modes as following when normal press on the key:

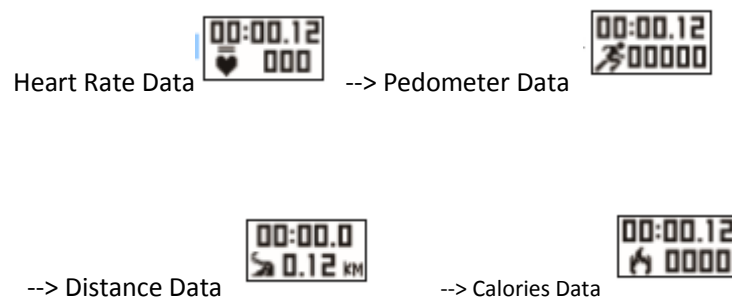

5. Sports Mode

Double click the key under history sports mode, the new activity will start (Clear the latest history data, once new activity started, double click on the key will be invalid), device switch into different display modes as following when normal press on the key:

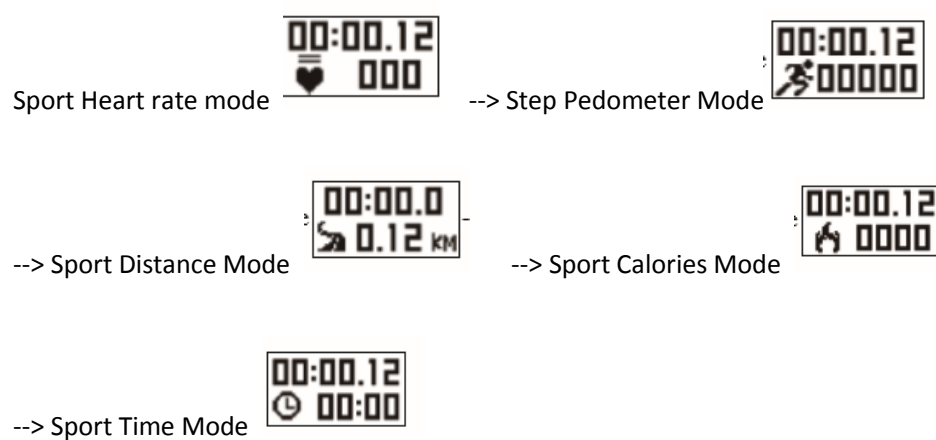

Note: Long press the key 2 seconds to exit the Sports Mode

6. Find phone function.

Switch on the "find phone" in the APP.

Long press the looking phone icon  till in shakes, the searching mobile will ring if it is under ringing mode, will shakes one time if it under vibration mode.

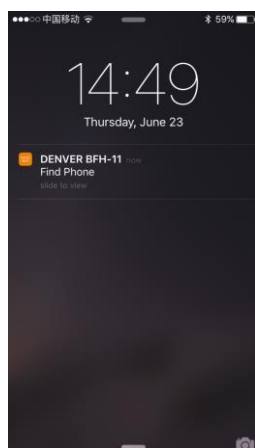

7. Remote Camera Control

Device key or wrist gesture could control remote photograph shooting.

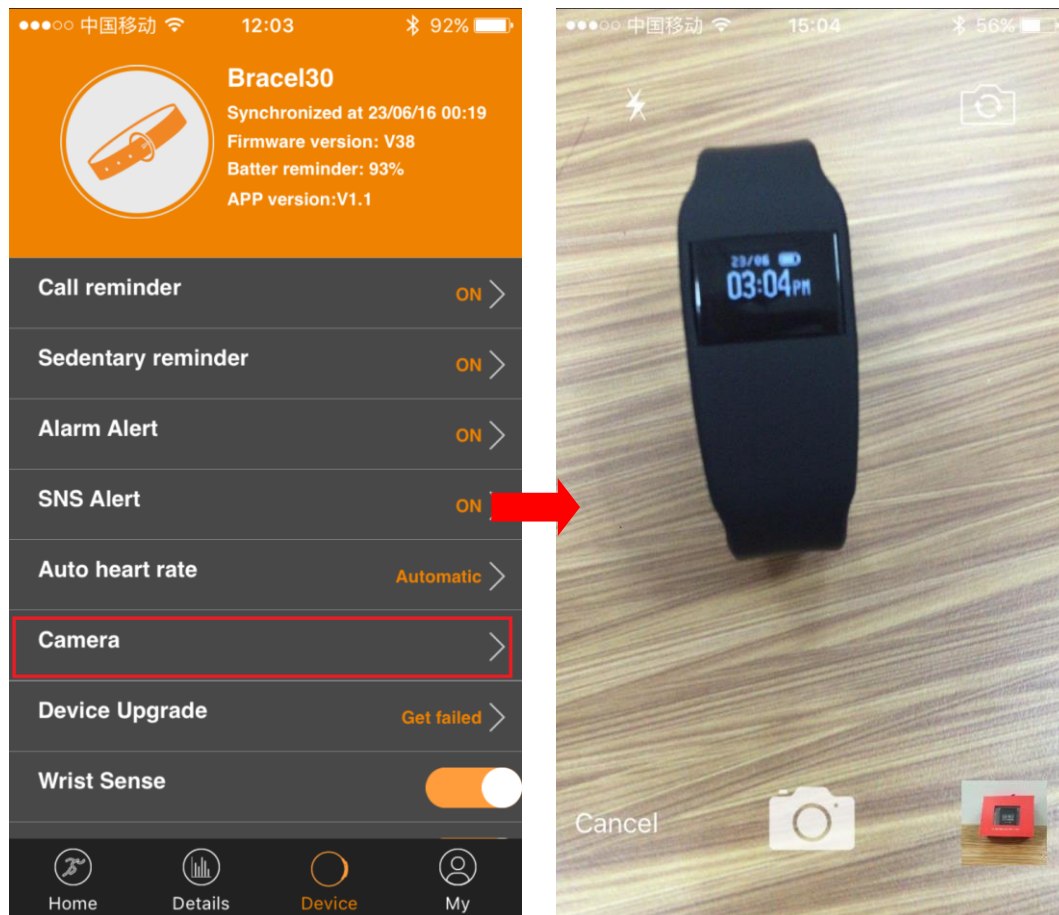

8. Wrist gesture

You can use the bracelet by “wrist gesture” It is convenient to check the time by “wrist gesture”.

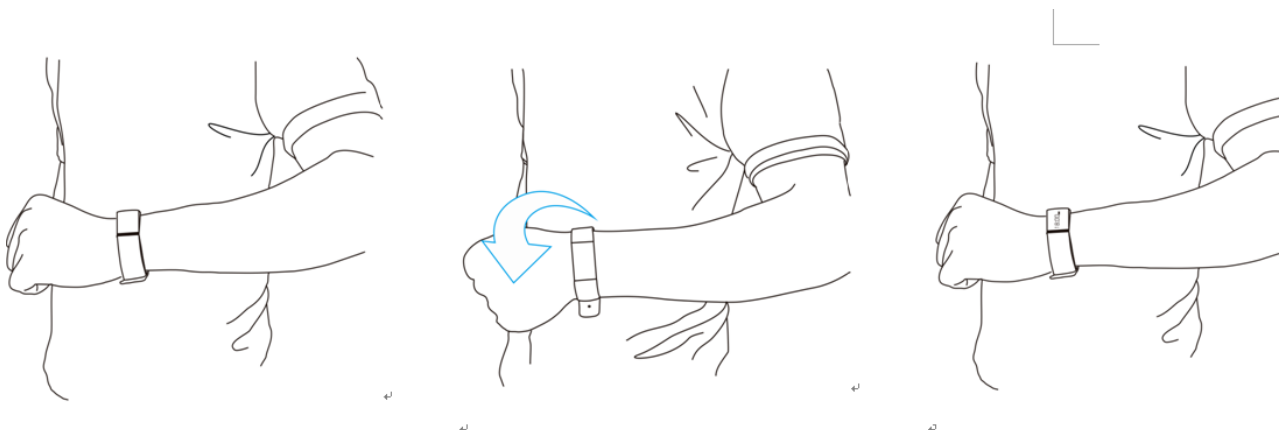

ALL RIGHTS RESERVED, COPYRIGHT DENVER ELECTRONICS A/S

DENVER®

www.denver-electronics.com



Electric and electronic equipment and included batteries contains materials, components and substances that can be hazardous to your health and the environment, if the waste material (discarded electric and electronic equipment and batteries) is not handled correctly.

Electric and electronic equipment and batteries is marked with the crossed out trash can symbol, seen below. This symbol signifies that electric and electronic equipment and batteries should not be disposed of with other household waste, but should be disposed of separately.

As the end user it is important that you submit your used batteries to the appropriate and designated facility. In this manner you make sure that the batteries are recycled in accordance with legislature and will not harm the environment.

All cities have established collection points, where electric and electronic equipment and batteries can either be submitted free of charge at recycling stations and other collection sites, or be collected from the households. Additional information is available at the technical department of your city.

Imported by:

DENVER ELECTRONICS A/S

Stavneagervej 22

DK-8250 Egaa

Denmark

www.facebook.com/denverelectronics

Hereby, Inter Sales A/S, declares that this model DENVER BFH-11 is in compliance with the essential requirements and other relevant provisions of Directive 2014/53/EU. A copy of the Declaration of Conformity may be obtained at

Inter Sales A/S
Stavneagervej 22
DK-8250 Egaa
Denmark