

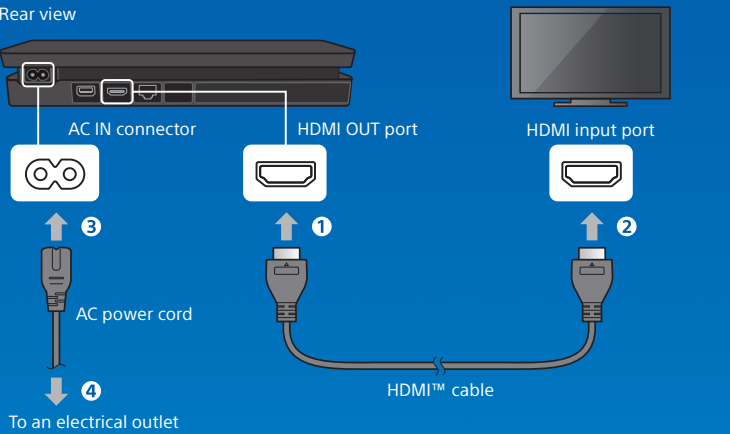

## Let's get started

### 1 Connect to your TV.

Follow steps 1 to 4 below to connect your PlayStation®4 system to your TV.



### 2 Connect to the Internet.

We recommend use of a LAN cable (sold separately) for a more stable network connection. If you prefer to use a wireless connection (Wi-Fi), don't connect a LAN cable.

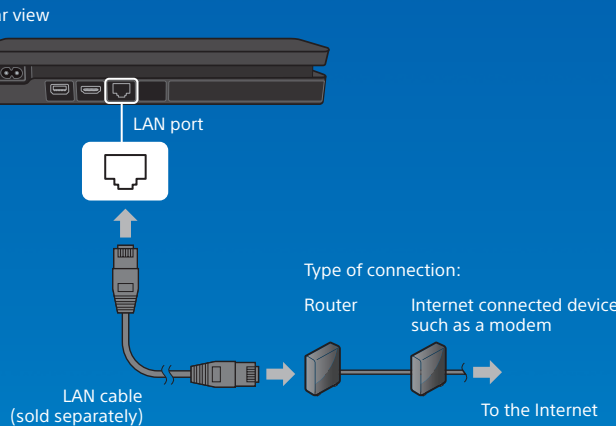

### 3 Turn on your TV and set the input to HDMI.

### 4 Turn on your PS4™ system by pressing the (power) button.

The power indicator blinks blue, and then turns white.

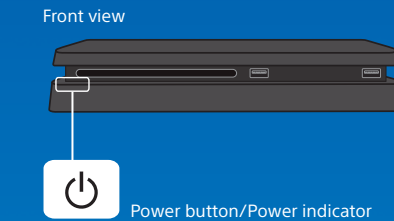

### 5 Connect your DUALSHOCK®4 wireless controller to your system using the USB cable, and then press the (PS) button.

Your controller pairs with your system and turns on.

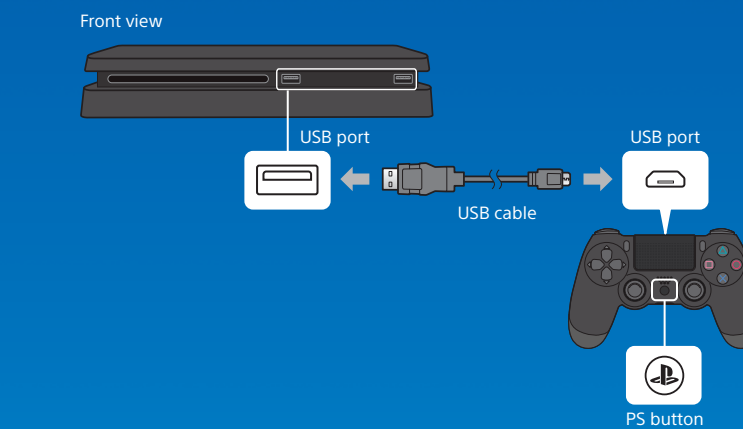

### 6 Make it your own.

You're almost done! Follow the on-screen instructions to set up an Internet connection, set the date and time, and configure other settings - then select [Start Now] from the setup screen. After you set up your Internet connection, a system software update automatically downloads. Future updates will improve performance and add new features.

Will a child be using your PS4™ system? If so, be sure to read the "Parental controls" section.

## Parental controls

If children will be using the PS4™ system, parents or guardians can restrict access to certain content or features using parental controls. For details on what can be restricted and how to set restrictions, refer to the User's Guide. [manuals.playstation.net/en/01.html](http://manuals.playstation.net/en/01.html)



You can restrict the use of games that have age limitations by setting the parental control level according to the following table.

Parental control level	2	3	4	5	9
Approximate age of user	3~	6~	10~	12~	17~
Game rating labels					

## Quick Start Guide

English

CUH-2015A

Get the most out of your PS4™ system by connecting to the Internet. You'll be able to play games online and connect with Friends.

If your TV does not display a picture when the power indicator turns white, restart your system. Press the (power) button for at least 7 seconds to turn off your system, and then turn it on again.

- You'll need to pair a controller when you use it for the first time and when you use your controller on another PS4™ system. If you want to use two or more controllers, you must pair each controller.
- After you've paired your controller, you can disconnect the USB cable and use your controller wirelessly.
- It's possible to use up to four controllers at the same time. When you press the (PS) button, the light bar glows in your assigned color. The first controller to connect is blue, with subsequent controllers glowing red, green, and pink.

To later change any settings that you skipped, select (Settings) from the function screen.



© 2016 Sony Interactive Entertainment Inc. Printed in China



4-594-732-11(1)

SONY®

# Take a look around

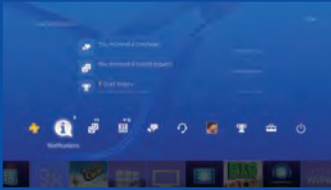

**Function screen**  
Access PS4™ system features, including notifications, your Friends List, and settings.

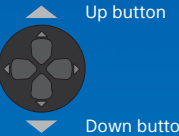

**Home screen**  
**Content area**  
Access your games and other content.

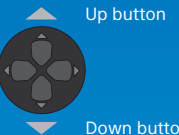

**Content info screen**  
The latest information about the selected content is displayed.

# Let's play

**Start the game**  
Insert a disc. Select the game from the content area to start playing.

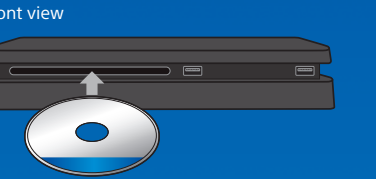

**Return to the home screen from a game**  
To return to the home screen without ending a game, press the (PS) button.  
To resume playing the game, select it from the content area.

**End the game**  
Press and hold the (PS) button, and then select [Close Application].

**Eject the disc**  
Press the (eject) button.

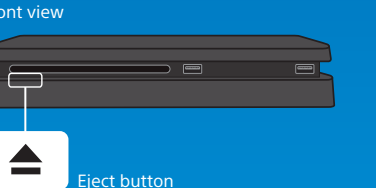

**Connect the mono headset**  
For in-game voice chat, plug the mono headset into your controller's stereo headset jack.

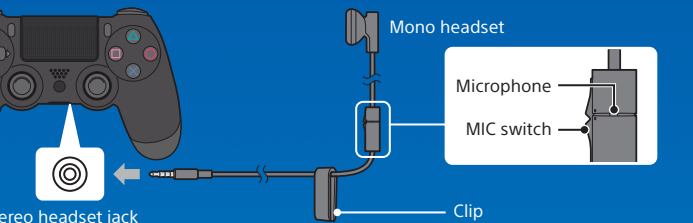

**Charge your controller**  
With your PS4™ system either on or in rest mode, connect your controller using a USB cable. For details on rest mode, read the "Shutting down" section.

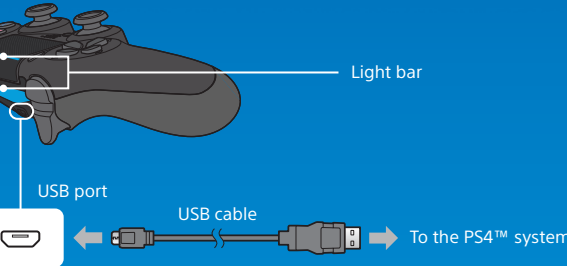

To charge your controller while your system is in rest mode, select an option other than [Off] in (Settings) > [Power Save Settings] > [Set Features Available in Rest Mode] > [Supply Power to USB Ports].

# Share your gaming experience

**Share your gameplay online**  
Press the SHARE button and choose one of these options for sharing your gameplay online.



**Upload a screenshot**  
Capture a screenshot of your gameplay and upload it to your social networks, or use (Messages) to send it to Friends.

**Upload a video clip**  
Your PS4™ system continuously records the last 15 minutes of gameplay. You can upload a video clip of the recorded gameplay to your social networks.

**Broadcast your gameplay live**  
Broadcast your gameplay to a live streaming service so others can watch your adventures.

**View shared gameplay**  
Use (Live from PlayStation) to view broadcasts, video clips, or screenshots shared by other players.



**Play a game together**  
Use (Share Play) to share the game screen with another player and play the same game together.



For details on the share feature, refer to the User's Guide.  
manuals.playstation.net/en/02.html



# Sign in to PlayStation™Network

PlayStation™Network is an online service that lets you expand your enjoyment of your PS4™ system. When you sign in, you can use the share feature as well as a wide variety of other features and services.

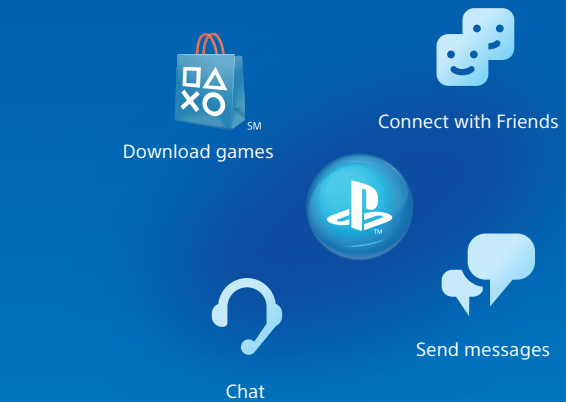

To sign in to PlayStation™Network, you must have a Sony Entertainment Network account. For details on signing in, refer to the User's Guide.  
manuals.playstation.net/en/03.html



# Shutting down

**Caution**  
Disconnect the AC power cord from the electrical outlet only when the power indicator is off. If you disconnect it while the power indicator is lit or blinking, data might be lost or become corrupted, and you might damage your system. Be sure to read the "Turn off your system completely" section below.

**Put your system in rest mode**  
It's best to keep your PS4™ system in rest mode when you're not using it. When your system is in rest mode, it keeps operating, but at a lower power consumption. You can configure your system to download files and charge a controller while it's in rest mode.

Select (Power) from the function screen, and then select [Enter Rest Mode]. The power indicator blinks white, and then turns orange.  
To exit rest mode, press the (PS) button.

**Turn off your system completely**  
Select (Power) from the function screen, and then select [Power Options] > [Turn Off PS4]. The power indicator blinks white, and then turns off.

Power indicator	
White	System is on.
Orange	System is in rest mode.
Off	System is off.

# Further information

**User's Guide**  
Find out about everything your PS4™ system can do. Learn how to configure settings and how to use each function. Select (Settings) > (User's Guide) from the function screen.  
You can also view the User's Guide by visiting:  
manuals.playstation.net/document/en/ps4/



**Safety Guide**  
Learn how to use your PS4™ system safely. This manual also contains product warranty terms and information about specifications. Be sure to read it before using your system.

"PS", "PlayStation", "PS4", "DUALSHOCK" and "PS Move" are registered trademarks or trademarks of Sony Interactive Entertainment Inc.  
"SONY" is a registered trademark of Sony Corporation. "Sony Entertainment Network" is a trademark of the same company.  
The terms HDMI and HDMI High-Definition Multimedia Interface, and the HDMI Logo are trademarks or registered trademarks of HDMI Licensing, LLC in the United States and other countries.  
Design and specifications are subject to change without notice.  
Information about system functionality and images published in this document may vary from those for your system, depending on the system software version in use. Also, the illustrations and screen images used in this guide may vary from the actual product.