

SENCOR®

Let's live!



MOBILE PHONE

Element P502

USER'S MANUAL

EN



Contents

1.	Safety instructions.....	2
2.	Getting started.....	6
2.1.	Buttons and connectors	6
2.2.	Inserting SIM and memory cards.....	7
2.3.	Switching the phone on.....	8
2.4.	Switching the phone off.....	9
2.5.	Charging the battery.....	9
2.6.	Home screen.....	10
2.7.	Touch screen controls.....	12
3.	Basic features.....	13
3.1.	Entering text.....	13
3.2.	Calling.....	14
3.3.	Contacts – People app.....	15
3.4.	Messages.....	16
3.5.	Data connection.....	17
3.6.	Browser	17
3.7.	Camera	17
3.8.	Computer connection	18
3.9.	Alarm, stopwatch, timer	19
4.	Phone Settings	20
4.1.	Wireless connections and networks.....	20
4.2.	Devices	21
4.3.	Personal.....	22
4.4.	SIM card security.....	23
4.5.	Accounts	24
4.6.	System.....	24
5.	Application of wireless sensor SWS 500	26
6.	Technical specifications.....	27

1. Safety instructions

**WARNING:**

Pay attention to the following instructions. The manufacturer does not assume any responsibility towards a user that does not follow these recommendations or uses the smartphone in an unsuitable manner. By using the device unsuitably, the user risks violating the relevant acts. Read this user's manual carefully before use. Keep the manual for future reference.

- Always follow the basic safety instructions when using this device to prevent the risk of fire, electric shock or injury.
- Please read this manual and follow all instructions for use, maintenance and installation. Do not use the mobile phone for purposes other than the intended use.
- Failure to observe the rules specified in the user's manual or inappropriate use results in losing the warranty and can lead to injury or damage to property. The manufacturer is not liable for any damages in such cases.
- Using a mobile phone is prohibited in some areas. If you find yourself in an area where the use of mobile phones is prohibited, follow the instructions contained in this manual to switch the phone off. The usual areas where the use of mobile phones is prohibited include: Planes, Petrol stations with flammable fuels, locations where demolition work is being executed, etc. Operating smartphones can influence electronic devices and medical devices, such as pacemakers, hearing aids and other electronic medical devices.
- Switch off the phone when you find yourself near fuels, chemical substances or explosives. Keep the device away from children.
- Follow local rules regarding the use of mobile phones while driving. As the driver, you are primarily responsible for the given vehicle. Use the hands-free function of your smartphone, if available. Stop your vehicle in bad driving conditions before making or taking a call.
- If your phone supports "Aeroplane mode", enable "Aeroplane mode" prior to boarding a plane. If your phone does not support this mode, switch the device off prior to boarding a plane, as your device can interfere with plane instruments. Please follow the plane cabin instructions.
- Always use genuine accessories. Using a non-genuine battery or charger can result in losing the warranty, causing damage to the phone and injury.
- Modifying or changing the features of the phone or tampering with the device is prohibited. Modifying the device can result in serious failures and damage to property, or even injure the user. Unless approved by the manufacturer, updating the operating software is also considered a modification.
- Do not connect the battery charger to your smartphone before the battery is installed. Do not short circuit the battery.

- Charge the smartphone battery in well-ventilated and cooled areas and far from flammable and explosive materials.
- To prevent demagnetization, keep your smartphone away from magnetic materials, such as hard drives, credit cards etc.
- Mobile phones are sensitive to external interference, which can seriously affect functionality, in some environments, mobile phones cannot be used at all.
- Neither the mobile phone or charger are toys, smaller parts can be swallowed by children. The charger and connecting the charger into the electrical outlet is very risky for small children. The charger shall not be used by children.
- Do not unplug the charger by pulling on the power cord – risk of damaging the power cord/socket or charger. Unplug the power cord by pulling on the charger unit.
- Be very careful when the display glass on the phone breaks, sharp glass parts may cause injury. Do not use a damaged phone and seek professional help to repair the device.
- High volume set on the mobile phone can result in damage to your hearing, be careful when adjusting the volume. Using your phone to listen to loud music can have serious consequences. Be careful when adjusting the volume to listen to music.
- Do not use liquid or aerosol cleaning agents, benzene, solvents or similar products. Use a lightly damped cloth for cleaning.
- Do not use the device near water, e.g. in the tub, shower or pool. Immersing the device into water can lead to injury by electric shock. Do not place any containers with water on the device, for example, vases.
- Place the device on stable surfaces. The device may become damaged if it falls on the ground.
- Do not cover the air vents on the device. These are used to prevent overheating.
- Keep the device in areas not prone to someone stepping on it.
- Do not place any objects into the air vents. Risk of fire or electric shock. Do not allow the device to be sprayed with liquid.
- To reduce the risk of electric shock, do not dismantle the device. If your device requires service or repair, take the device to an authorized service centre or qualified technician. Opening the device or removing the cover can uncover areas with dangerous voltage or other risks. Risk of electric shock when using a device that is not properly reassembled.
- Do not expose the device to extreme temperatures, e.g. near a hot radiator or stove or in a heated car.
- Do not place burning objects on the device, such as candles or cigarettes.
- Do not use the device to report gas leaks near the source of the leak.
- This smartphone is capable of capturing photos, recording video and sound; respect the relevant laws and regulations for using these features. Under certain circumstances, capturing photos, video and sound recordings without permission can be considered as breaking the law and valid regulations.



- When using network features, please do not download files infected with a virus, do not install damaged photos and ringtones. Our company is not liable for defects caused by the phone behaving abnormally after downloading files.
- Follow local regulations for disposing of the battery. Recycle if possible. Do not throw the battery into standard waste.

**WARNING**

To prevent the risk of fire or injury by electric shock, do not expose this device to rain or wetness.

DECLARATION: Our company reserves the right to review the contents of this manual without prior notice.

Notes

Some device properties and accessories described in this user's manual depend on the software installed and the capacity and configuration of the local network, and do not necessarily have to be available or can be limited by mobile carriers. Thus, the descriptions provided do not necessarily correspond precisely to the specific phone or accessories, which you purchased. The manufacturer is not responsible for the quality and legality of any contents, which you upload or download to the mobile phone, whether it concerns text, pictures, music, films, additionally installed software protected by copyright etc. You are liable for consequences following the installation or using the contents of the above stated on this mobile phone.

All screenshots, symbols and icons in the user's manual are simulated. Actual screenshots, symbols and icons may differ.

Step-by-step procedures can differ from those provided in this manual, depending on the firmware version in the phone.

Unless stated otherwise, the home screen is the presumed starting point for all procedures described.

The phone is a device, the behaviour of which can be altered by the user via additional apps. Procedures and individual steps can therefore differ from those contained in this manual.

Note on the service provider: The phone is configured from the factory to fully utilize available services. Your provider can limit or change some functions, security measures or behaviour of the phone, as opposed to the description in this manual. Ask your provider about any changes.

SENCOR®

Appendix to the user's manual for the LCD panel

Measures for static image; red/blue/green/black spots on the screen

A static image can damage the LCD display permanently.

- Do not leave a static image on the LCD panel for more than 2 hours. This may result in a damaged panel. This damage is known as "screen burn-in".

The warranty does not apply to screen damage caused by the reasons stated above!



Red, blue, green, and black dots may appear on the screen

- This is typical for liquid crystal displays and does not indicate any problems. LCD screens are made using precision technology to provide even the finest image details. Several defective pixels can appear on the screen from time to time, indicated as red, blue, green or black dots (up to 0.001% of the total pixel count of the screen). This does not affect the properties and performance of your device.

2. Getting started

2.1. Buttons and connectors



1. **Headphones** jack is located in the upper part of the telephone.
2. **Camera** is located on the front of the telephone and can be activated as a camera or for a call.
3. **Charging connector** is located in the upper part of the telephone and is used to connect the USB charging cable. Connecting your phone to the computer allows you to take advantage of additional functions that are available (see PC connection for more information).
4. **Volume** button allows quick change in volume of the ringtone/notification or volume during a call. When the volume is set to the lowest levels, the phone switches to Vibration or Silent mode, based on the selected level.
5. **Power** is used to turn on/off the display (by pressing) and opening quick selection of ringing profile or option to turn off the phone (button is held longer).
6. Press **Back** to return to the last steps performed by the currently active application (e.g. does not apply in case of confirmation of a command to remove a contact, uninstall application, etc.).

7. Press **Home** to exit the current application and the main screen appears. Press and hold the button on home screen to display the list of recently used apps. Press the respective application to re-open the app. Sliding from the list (by pressing and moving it to the side), you can turn off the running application and release resources (memory) that use them.
8. Press **Settings** to view the available options of the currently launched application, if they are available. Press and hold the button Settings to take a current screenshot.

2.2. Inserting SIM and memory cards

In the place of the cut on the lower left side of the phone's back cover, lift the cover with your fingernail or a blunt object upwards from the unit. Using fingernail or a blunt object gradually release the cover off the phone around the entire perimeter of the device and after its release lightly lift the cover. Remove the **battery** from the phone using fingernail or a blunt object – in the place of the cut on the bottom side of the battery lift the battery up and remove it from the device.



WARNING: before handling the cards (SIM and memory), disconnect the charger, switch off the phone and remove the battery.

There are three slots above the phone battery. The slot on the left is for **memory card**. Attach the memory card contacts facing up to the phone and gently push upwards into the memory card slot (edge of the memory card slots facing right, memory card contacts on the bottom of the card are touching the contacts in the phone).

The SIM cards in your phone are prevented from moving by metal mechanism. To release it, gently press and slide it upwards (for SIM card 1) or downward (for SIM card 2) approximately 2 mm (you will hear a click), and then open it.

Insert **SIM 1** card into the middle slot, with contacts towards the phone and the cut-off corner located on the upper left so that the SIM card contacts touch the built-in phone contacts. The picture beside the slot and the shape of the slot will help you to determine easily the correct position of the SIM card and placement of the cut-off corner. Insert **SIM 2** card in the right slot with contacts downwards toward the phone and the cut-off corner located on the bottom left.

Smooth the installed SIM card with a finger so that it fits properly and then cover its entire length with metal cover. Push the firmly pressed cover on the SIM card by sliding it gently down (for SIM card 1) or up (for SIM card 2) approximately 2 mm (you will hear a click), and thus secure the card against motion.

When you **insert battery** in the phone, connect first the battery contacts with the contacts located in the phone on the upper edge of the battery compartment. Then gently push the battery upwards toward the contacts and at the same time push on the bottom of the battery so that it fits properly in the battery compartment. To replace

the back cover of the phone attach it from above to the top edge of the phone, while pressing gently and gradually on the cover edges from the top down around the perimeter of the cover until the cover is correctly attached to the phone.



NOTICE: Phone functions such as voice calls and video calls, receiving and sending text messages and multimedia and data transfers of various speeds are possible and available only when at least one of the SIM card with activated operator functions is inserted and within reach of its wireless network. Ask your carrier about services available on your SIM card and network availability.

2.3. Switching the phone on

If you want to turn on the turned off phone, press for a few seconds the button **“Power”**, until the phone turns on. The operating system and other components of the phone then start. Wait until the phone completely loads and the system home screen or security screen (e.g. SIM card lock) is displayed.

If you turn on the phone without inserting the SIM card, the message **“No SIM card”** appears on the phone. After the SIM card is inserted, the phone automatically checks whether the card can be used. Without inserting a functional SIM card, however, you can connect to a Wi-Fi network and, for example, sign in to your Google account and use some of the phone's features.

Setting up your phone for the first time

If you are switching on the new phone for the first time, the **“Setup Wizard”** will guide you through the first launch and basic settings. Phone settings you perform before switching on the phone for the first time (language, date and time, SIM card management, default SIM setup, import contacts from SIM, WiFi networks) can be changed any time under Settings.

Select the language in the first step. The **“Setup Guide”**, which consists of several screens between which you can navigate by pressing a button on the bottom of the screen, will also continue in this language. Continue with setting the date, time and date/time display options. Under SIM card management settings, you can activate/deactivate available SIM cards in the phone and configure their default use (see Settings – Wireless Connections and Networks). Additionally, you can start importing phone contacts and configure Wi-Fi network connections (see Settings – Wireless Connections and Networks).

The following messages may appear on the display when you switch on the phone:

- **“Input Phone Lock Code”** – The phone is locked. Insert the correct code to unlock the phone.
- **Input PIN** – SIM is locked. Insert the correct code to unlock the SIM card.
- **Searching** – The phone is searching for network connection.

Tip:

Short pressing the power button Power is used to “wake up” when the phone is switched on, but in the sleep mode to conserve battery with the screen off.

2.4. Switching the phone off

To switch the phone off, press and hold the **Power** button until a menu dialog appears on the display. Select **Power Off** (no. 1 on the image below) and press **OK** to confirm.

After you have pressed and held down the **Power** button, you can also select the phone **Reboot** option (2) or activate a selected phone profile: Aeroplane (3), Silent (4), Meeting (5), General (6).

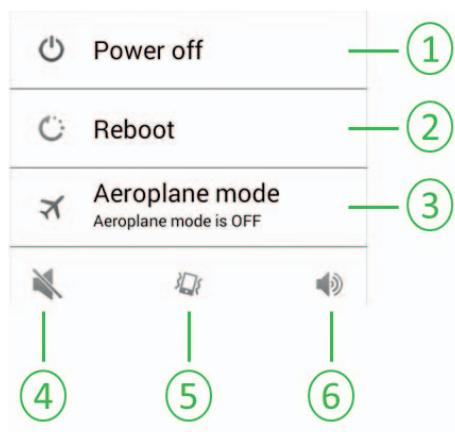
**Tip:**

A short press of the Power start button is used to put the phone to “sleep” and activate standby mode.

2.5. Charging the battery

The charging connector is located on the top side of the phone above the display. Plug the charger connector into the phone, and plug the charger into the socket. If the phone is on, the charging process will be indicated by the battery icon moving in the status bar. A big charging icon (battery) will appear shortly on the screen when the phone is turned off.

If the mobile phone was used until the battery was fully depleted, it may take a while (several minutes) until the charging process is indicated on the screen. The mobile phone cannot be immediately switched on when the battery is fully depleted until the battery is charged to the minimum necessary for switching on the phone.

The charging cycle duration is usually longer than 2.5 hours (we recommend charging the battery to 100% and fully depleting the battery until the phone is switched off for the first three cycles. This achieves the highest battery power for a longer product service life). It is normal for the phone and charger to heat up during the charging process.

The full battery icon on the display informs the user that the battery is full and the charging cycle has ended.

After the charging cycle, unplug the charger from the socket and the connector from the mobile phone.

**NOTICE:**

- Charging must be done in a well ventilated area at a temperature between -10°C and + 45°C. You must use the charger provided in the package. Using another charger may be dangerous or you will not reach the expected performance or you will shorten the life of the battery in particular.
- If the mobile phone automatically shuts down or displays "Battery is low" (the capacity of the battery is low), you should charge the battery. If the battery was not fully depleted prior to charging, the charging period will be shorter.

2.6. Home screen

Note:

In the following text we will call the simple and short touch of the control surface **tap**, for better intelligibility, the field designed for entering specific values into the system **button**, Long touch or swipe of finger on the touch surface for entering range or for moving an object we will call **hold**.

**WARNING**



Do not use force for touch control and do not push on the screen. If the system does not respond per your expectations, eliminate the cause (e.g. moisture on the display, gloves) or wait until the system responds provided the system is busy with a different application or operation.

Status line (top line of the display, no. 1 in the picture below) may display e. g. signal indicator, charging battery status, icon of WiFi connection to the internet, ongoing data transmission, missed call, received message and notice about installed applications.

Status and notification icons

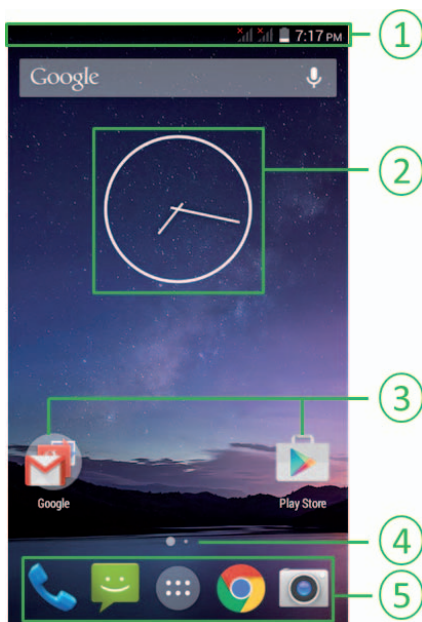
The home screen (default) contains the icons of most frequently used items. Here you can place applications, widgets of applications (no. 2), the representatives or folders (no. 3) for quick access. If you have many items that you use frequently, you can expand the home screen (the home screen contains several screens, which you can go through by swiping left or right). The graphic indicator always shows you which part of the home screen you are in (4). The bottom panel (5) contains icons for accessing basic phone features (e.g. Messages, Contacts). You customize the applications on this panel (see Touch screen controls – move icon).



Information panel with information about current notices of applications can be viewed by pressing and pulling the status line downward. Tapping on an item opens the associated application, swiping to the side removes the notification from the list. In the upper right corner of the information panel you can find icon for removal of all displayed notifications  and also switch to phone settings menu .

The quick access menu allows the user to quickly enable/disable selected phone functions or display detailed information. Quick selection menu consists of items: WiFi (A), Bluetooth (B), position (C), Airplane mode (D), data connection (E), sound profiles (F), automatic display rotation (G). You can see always on the screen only five quick selection menu items. You can display other items by shifting quick selection menu to the right or left.

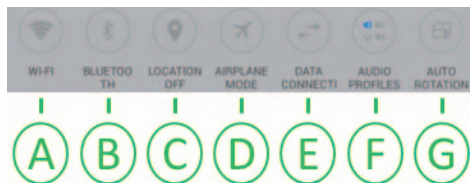

2.7. Touch screen controls

Various finger gestures on the screen can be used to control the phone menu and enter commands. **Tapping** an icon on the main screen or in the phone menu launches/opens the respective application, selects the desired list item or executes the selected option (e.g. Call contact, Edit, Save). You can achieve **Moving icon** on the main screen by touching, holding and then moving the icon to another place. You can **swipe your finger** across the screen (down, up or to the side) to navigate through phone contacts, while browsing web pages, or going through stored photos. To zoom in and out of a web page or a picture, place the index finger and thumb on the screen and by **closing them together or pulling them apart** from each other you can change the scale of the view. You can also set the auto-rotate display option, which automatically changes the display orientation when switching the phone to landscape mode. This feature is configured under Settings – Display.

Note:

High sensitivity of the capacitive touch screen controls may affect the accuracy of the entry, as well as current and personal conditions or inappropriate protective film cover. Try and learn to use touch controls. Use controls only in dry environment without gloves or other obstacles.

3. Basic features

3.1. Entering text

The keyboard automatically appears on the screen of the phone when it is necessary to enter text or numbers (usually after tapping on a text field entry within an application or item, e.g. tapping on the field for typing an SMS message, no. 1 in the image below). The size of the keyboard on the screen can be changed by turning the phone to "landscape" (if automatic display rotation is allowed).

Select a character with accent (e.g. the letter "š" after pressing, holding and moving in the selection for the letter "s") or number (number "2" in the menu for the letter "w") **by holding and moving**.

Remove incorrect characters using the button "**Backspace**" (no. 2) on the right side of the keyboard (left arrow with cross). If you need to delete or insert symbols to text located above, select the desired position by tapping on the spot, make the desired changes and then return to the spot to continue typing by selecting that position.

Using the key **emoticons** (no. 3) insert the image of so-called smiley face made of special characters.

Key **special characters** (no. 4) shows you when held the menu of punctuation marks. **You can make a space in the entered text using space key** (no. 5).

When you hold the key for inserting **punctuation comma** (no. 6) menu appears for text input setting and the menu for keyboard setting. Tap the "**?123**" key (7) to switch the keyboard to special characters and numbers, tap "ABC" to switch back to the keyboard containing letters. Press the key "**Shift**" (no. 8) to switch on the capital letter writing mode, press twice to continue to write in capital letters. Press again to switch this mode off.

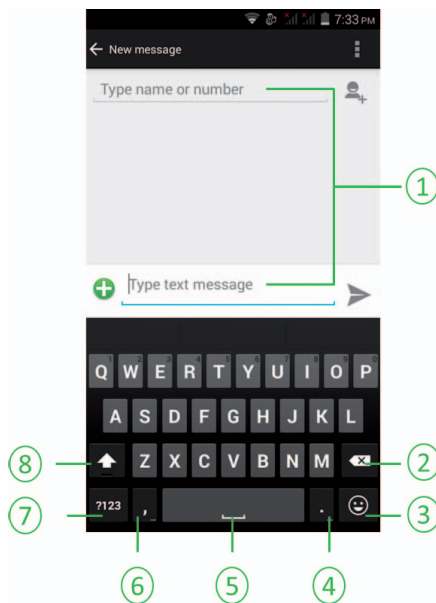

3.2. Calling



Initiating a call – a call can be made via the Phone application (phone icon). Using the middle icon at the bottom of the screen select a numeric entry and enter the phone number including the area code, select one SIM card (if it is not fixed default SIM card) and press the green handset. Call information is displayed during an active call. For international calls, tap “0” to switch until the international phone prefix “+” appears on the screen. Enter the country code and full phone number to call.

You can also choose the desired number from the list of saved contacts or calling history. If you enter an incorrect character, use the arrow with a cross to delete. The number you enter can also be stored in the list of contacts.

During the phone call, you can use the respective buttons on the screen to perform various actions, for example, to display the numerical keyboard, activating/deactivating speaker, muting the microphone, put a call on hold/resume a call.

Call history – you can switch in this list of all dialed/missed/rejected calls between a summary view and individual categories (incoming calls, outgoing calls, missed calls).

Set speed dial – Press and hold key “1” dial voicemail, if your service is active (contact your network provider for more information). Long-press numerical keys 2–9 to activate the speed dial option for the respective key. If you have a number already allocated to speed dial option, you can make a call by long-pressing the respective

number on the numerical keyboard. Removing and editing the speed dial and assigned keys can be performed in the options of Next selection (icon with three dots) in the phone Memory menu.

Hang up – To conclude a call, tap on the red phone displayed on the screen.

Accept/Reject an incoming call – Tap the phone icon on the screen when you receive an incoming call. The available options will appear (see image below). Press the icon and swipe to the right to accept the call. Press the icon and swipe to the left to reject the call. Press the icon and swipe up to reject the call and send the caller a predefined message. If a headset is connected, you can also use the button located on the headset to accept a call.

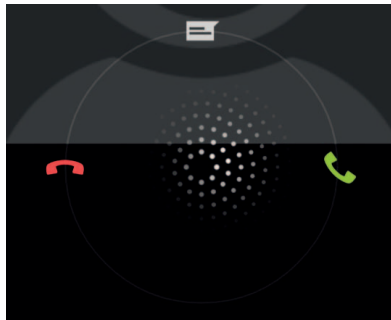

The ringtone volume of an incoming call can be reduced by pressing the volume up/down rocker.

Emergency calls: Regardless of whether or not a SIM card is installed in the phone, the phone can be used to make emergency calls by dialling: 112.

3.3. Contacts – People app



You can view, create or synchronize the contacts in the People application on your phone with your Gmail contacts or other applications on the Internet or phone. At the top of the Application menu, you can toggle between the contacts marked as favourites, the list of all your stored contacts and contact groups.

Search in stored contacts – you can search for a contact in the app by moving up/down or via function Search (magnifying glass icon in the bottom left corner), where you enter the beginning or part of the name of the searched contact.

Create new contact – select in the application the function add new contact (icon with plus sign at the bottom of the screen). Then choose where the contact shall be saved (e.g. SIM card, phone), enter the contact name, phone number and any additional information. To save the contact, tap “Done” in the top left corner of the screen.

**NOTICE:**

The amount of data stored about the contact varies depending on the selected storage type.

Contacts import/export – press the navigation key “Setting” in the app, select Import/Export. First select the location from where the contacts will be selected, then choose the location to where the contacts will be saved. You can then identify only selected contacts or use the bulk selection for all available contacts (top part of the screen, the number of selected contacts is indicated). Press **OK** to confirm and initiate the contact import/export process.

3.4. Messages



The message overview contains all SMS and MMS messages that were received and sent, as well as message drafts, all divided into conversation threads. When a new message is received, the respective conversation thread is highlighted bold until the conversation is opened.

Writing new message – at the bottom of the screen with a list of conversations press the icon of message with the “plus” sign. You will be prompted to enter the phone number or the name of the person, which you have stored in the contact list. After entering a few characters (e.g. the first letters of the saved name), you can select a contact from the offered list of all contacts that match the pre-filled characters. Tap the contact you wish to select. Next, tap the area for entering the text message (bottom part of the screen) and enter the SMS or MMS message text. Tap the “arrow” in the bottom right corner of the screen near the entered text to send the message.

Tip:

You can attach your video, photo, audio or contact to your message using the green icon “plus”. By inserting such a file, an SMS message automatically converts into an MMS message, where a different fee may apply. For more information, contact your network provider.

Deleting messages – In the overview of all conversations press and hold the selected conversation to activate menu for deleting messages. Tap to highlight all conversations, which you would like to delete and confirm by tapping on the waste bin icon located in the bottom part of the screen.

Message settings – message settings can be configured from the menu upon tapping the “Settings” navigation key on the screen containing all conversations. Under “Settings”, you can configure options for SMS/MMS messages (e.g. delivery notifications, storage type), message notifications (e.g. ringtone, vibration), general settings (e.g. conversation background, font size, CB messages).

Call from the message – if the message contains more numbers, the phone menu can be automatically activated for selection of the required number from the message. Tap on the call button (phone icon on the screen) to dial the number.

3.5. Data connection

Your phone allows you to connect to the Internet using GPRS, EDGE, 3G or Wi-Fi. You can control turn on/off of data transfer in the phone settings (see Phone Settings – Wireless & Networks) or touch menu screen. Current data transfers are shown in the status bar on the SIM card signal icon/with small arrows on the Wi-Fi icon.

Note:

When starting your phone for the first time with a SIM card inserted, network services GPRS, EDGE or 3G will automatically be configured. In case of problems, contact your network provider. The phone automatically switches between faster and slower services according to the current availability and state of the mobile network. Faster transmissions require a stronger signal than slower ones.



WARNING: data transfer through the network of the mobile operator is charged. And that even in the case of transfer in the background, e.g. when sending attachments of multimedia messages. Check with your service provider for the range of services and prices.

3.6. Browser



Basic browser is pre-installed in the phone. This browser may not support the correct visualization of all types of web pages. An active data transfer is required to ensure proper Browser functionality.

Tap the browser icon to open the application. The address line is located in the upper part of the screen. The quick access toolbar appears on the bar at the bottom of the screen when you move your finger along the screen (shown on the image below, from left to right: Back, Forward, Open browser pages, Bookmarks/History).



To view the selected web page tap the browser address bar and use the keypad to enter its web address. Confirm your selection by tapping Go, which is located at the bottom right part of the keypad.

3.7. Camera



You can toggle between the front and back camera, capture photos or videos, activate/deactivate flash, all from the camera home screen.

To zoom in or out of, place your index finger and thumb on the screen (moving the fingers closer together or further apart changes the scale of display). Tapping on a desired location in preview mode for taking photo activates auto-focus in the respective position (the viewfinder colour changes to green after focusing). You can take a picture using the volume button on the side of the phone or using the capture icon (icon the shape of a camera shutter (no. 3 in the picture below)) on the screen. Tap the video camera icon (no. 2) to start video recording.

If you select a video camera recording, it starts immediately – you can stop and save it using the red camera icon or tap Home or Back. You can pause recording using "Pause" icon which is located at the counter of the length of the recording. You can view the captured photos/videos immediately by dragging the screen from right to left (with opposite movement you can return to capturing mode). The Camera app (and similarly also the viewing Gallery app) stores pictures and recordings into preset memory for storing (Settings / Store) of your choice, either to the phone's internal memory or to your inserted card.

Adjust the camera and video camera setting in Settings (no. 1). When you open the Camera application, you can switch in the upper part of the screen to e.g. the option of shooting in Normal mode or to the option to capture panoramic photos.

When shooting panoramic photo capture the first image first and then move the camera in the chosen direction so that the arrows on the screen overlap. In the moment of overlap another picture is taken. You can continue this way or stop taking pictures and save.



3.8. Computer connection

Plug the USB cable to your computer and phone. Wait until the computer operating system installs the driver necessary for communicating with the phone. You can expand the information panel on the main screen and select the option "Connected as..." You can select one of the following options: USB storage, Media device, Camera or Charging only.

**NOTICE:**

Operating system Microsoft Windows 7 and higher supports connecting the phone to a computer.

Note:

During software connection of the internal memory or card to a computer system, the mobile phone will not have access to them. Some applications for the mobile phone, e.g. the camera, cannot be used. The phone restores access to these applications once disconnected from the computer.

3.9. Alarm, stopwatch, timer

Setting alarm – In the application Clock on the tab for alarm (left upper icon)  tap the icon “plus” in the bottom part of the screen and slide the finger on the dial to set the required alarm time. Next, you can activate/deactivate the configured alarm (tap the activation button on the top right), choose the occurrence for each day of the week, select the alarm ringtone and enable/disable vibrations when the alarm goes off.

Tip:

In the Clock app, you can also use it to view the current time in selected cities, use countdown timer or stopwatch (top icons following the icon for the alarm clock in the upper part of the screen from left to right).



4. Phone Settings

Phone settings are divided into several sections. In the upper right corner of the screen you can use the icons to switch between the simplified general menu or the display of all available items, which are for clarity ordered into various sub-categories. Below are the most frequently used phone settings features.

4.1. Wireless connections and networks

SIM management – used to setup available SIM cards in your phone. To make voice calls, send SMS messages and establish a data connection, you can specify a SIM card (default SIM) or use the “always ask” option and change the SIM card for each call made, text message sent or data connection established. You can select the default services for a selected SIM card, disable or enable their use and configure easy SIM card recognition in case two SIM cards are used in the phone.

WiFi – button for switching WiFi connection on/off is located beside the item name. If Wi-Fi is enabled, a list of available networks will appear as soon as all are loaded and detected. To activate a new connection, click on the selected Wi-Fi network and enter the password, if required. In case of difficulties, contact the administrator of the network to which you cannot connect.

Bluetooth – button for switching Bluetooth connection on/off is located beside the item name. Once the phone is switched on, it gradually searches and attempts to detect devices, which are set to Visible to all nearby devices. You can find another device using **Search device** in the upper part of the screen. To activate a new connection, tap on the selected device and enter the pairing code, if required. By default, the phone itself is set as Invisible (for your security), click Element P502 to change it to Visible, but only for two minutes. The visibility of your phone can be turned on or prohibited by touching the first item Element P502 (the name of your device).

Transferred data – the feature is used to display information about the history of data transferred and provides an overview of the amount of data for each phone application for the selected period (custom settings available), as interpreted by the phone. The parent systems however can count also some service transfers, which are not available in the phone itself.

Next...

- a) **Airplane mode** – here you can switch on/off the Airplane mode (the phone is not logged on the operator network and no data transfers take place, other applications can be used)
- b) **Default SMS application** – if two or more applications, which work with the SMS/MMS feature, are installed in the phone, you can set which application will be used by default. It also specifies the application if the messaging service is required by connecting to a computer.

- c) **Tethering a portable hotspot** – with this function you can create your own WiFi/Bluetooth hotspot and share data connection with your close surroundings. In this mode, the phone switches roles from user (client) to provider (wifi/bt). Tethering needs to be disabled to restore the client role.
- d) **Mobile networks** – e.g. automatic or manual search of mobile network for individual operators, setting data services (in case of problems contact your mobile network operator), option to set network mode 3G/2G. (TIP: for longer standby time of the phone on battery use 2G network.)

4.2. Devices

Sound profiles – this item offers the option to add a new sound profile using the icon “+” in the upper part of the screen, reset of all default sound profiles using the icon “cogwheel” in the upper right corner, selection of a sound profile or adjustment of the setting of the ringtone General profile.

Gesture wake up – the on/off connection button is located beside the name of the item. In case of active function, you can draw with finger on the unlit screen of the display the appropriate character for selected app and the phone will open this app. In case when you have set up a screen lock, your phone will prompt you, before running the selected application, first to unlock the screen. Application for start can be assigned to several activities - double tap screen (double tap on the screen), swipe up/down/left/right (swipe across the screen up/down/left/right), draw (draw a shape of the appropriate letter on the screen).

Display – used to adjust the wallpaper, brightness, automatic screen rotation, sleep mode, screen saver, letter size and remote screen. Using the remote screen you can share the screen of your phone using WiFi connection to the remote device (e.g. a supported TV monitor).

Storage – the default write memory can be configured (phone memory or SD card), display the internal memory overview, utilize the feature that safely removes the SD card or erases the memory card, provided the memory card is inserted into the phone. Data cannot be restored after the memory card is erased.

Battery – displaying the overview of each application and their share of battery use.

Applications – list of applications installed on the phone. Tapping on a selected application displays details about the application including the option to uninstall/delete the application from the phone. It is not possible to uninstall preset applications. Slide the screen sideways to move between tabs (categories) of applications: Downloaded, Started, All.

Users – you can set up additional phone users and if necessary restrict access to applications and content of your account.

4.3. Personal

Location – some applications require specifying the location of your phone or having GPS enabled to ensure proper operation (e.g. Maps, Navigation). The on/off switch is located on the top right. Locate mode provides the option to configure how location information shall be obtained.

Tip:

In Positioning mode select the option “Device only”. Other modes may be charged by your operator – find out from him. To read the location from the GPS satellite system, it is imperative to have a clear view of the sky and the locating process takes some time.

Security – offers the ability to manage the security of the SIM cards using PIN codes (basic information is provided below, for more information contact your mobile network provider), security, the option of automatic screen lock after a specified time interval or encryption of the phone. You can also configure the Device Manager (applications), permit the installation of applications from unknown sources, the installation of suspicious files and configure application rights to using phone features.

Tip:

By filling out the “About the Owner” item, selected contact information of the owner can be shown on the phone lock screen in the event that you lose your phone.

Language and input – here you can change e.g. the language of the phone, of the keyboard and the text input methods.

Backup and restore data – the function “Restore factory defaults” restores the phone defaults and permanently deletes all data stored in the phone (e.g. music, contacts, pictures).

Tip:

Before running this function, back up all data from the phone that will be restored to factory settings.

App permissions – button to activate/deactivate function is located on the top right. Installed applications on your phone may require access to various phone functions. Here you have the option to modify these permissions of individual applications.

Call settings – option to set voice mail number, redirecting or e.g. blocking calls.

Message setting – here is the possibility to adjust the options of SMS/MMS messages (e.g. delivery report, storage type), messages notification (e.g. ringtone, vibration), general setting (e.g. conversation wallpaper, letter size of messages, CB news).

4.4. SIM card security

Being the explicit personal communication tool it is, the SIM card is duly secured against abuse. The most typical operators' procedures are below. Read the SIM card documentations provided by your carrier carefully.

SIM card PIN code:

The PIN code (personal identification number, 4–8 digits) is used to prevent the unauthorized use of your SIM card. If PIN verification is active, you will be prompted to enter your PIN code each time you power on your device. The SIM card will be blocked after three incorrect attempts at entering the PIN code. The following instructions will show you how to unlock the SIM card:

- 1) Enter the correct PUK code into the field displayed to unlock the SIM card.
- 2) Enter the new PIN code and confirm.
- 3) If you are prompted to re-enter the new PIN code, re-enter the new PIN code and confirm.
- 4) If the PUK code is correct, the SIM card will be unlocked and the new PIN code will be activated.

Attention: The SIM card will automatically be locked after three incorrect attempts at entering the PIN code. In this case you will have to use the PUK code to unblock the card. The PUK code is kept with the network carrier.

PUK code:

The PUK code (PIN unlock number, 8 digits) is used to unlock the SIM card after entering an incorrect PIN code. The PUK code is provided by the phone carrier together with the SIM card. If you enter the PUK code incorrectly ten times in a row, the SIM card will be invalidated. Request a new SIM card from your carrier.

PIN2 code:

The PIN2 code (4–8 digits) is used together with the SIM card to configure fixed options and other features. Refer to your carrier and check whether your SIM card supports this feature. The PIN2 code will be blocked after three incorrect attempts at entering the PIN2 code. The following instructions will show you how to unlock the SIM card:

- 1) Enter the correct PUK2 code into the field displayed to unlock the PIN2 code.
- 2) Enter the new PIN2 code and confirm.
- 3) If you are prompted to re-enter the new PIN2 code, re-enter the new PIN2 code and confirm.

PUK2 code:

The PUK2 code (password for unlocking the PIN2 code, 8 digits) is used to unlock a locked PIN2 code. The PUK2 code is provided by the phone carrier together with the SIM card. In case that you were not provided with PUK2 code, contact your telephone operator. If you entered the PUK2 incorrectly ten times, you will not be able to use the PUK2 code features. To use these features, request a new SIM card from your carrier.

4.5. Accounts

It is recommended to link your phone to a Google account to utilize all features of your phone (e.g. Google Play services, synchronizing photos and documents, Google Maps). You can add a new or existing account. Navigate between the setup steps for adding an account via the triangle arrows at the bottom of the screen (one step back/forward).

Connecting to existing Google account – in the menu “Add account” select the option “Google” and next select “Existing” and fill out login details for your Google account, which you use (email address and password).

Create new Google account – in the menu “Add account” select the option “Google” and then select “New” and fill out your name and surname, select an appropriate and unique user name (email address) and next select a password, which you will use for login (you have to enter the password twice to eliminate possible unintended typo). You can also enter contact information for renewing a forgotten password via SMS or alternative email address. Some steps in the setup can be completely skipped or deferred to a later time, without it having an effect on the functionality of your Google account (e.g. account upgrade, payment details setup).

The phone supports simultaneous connection to several different e-mail accounts via IMAP, POP3 or in the case of corporate e-mail account via Exchange. Contact your e-mail server administrator to ensure a proper setup of your e-mail account.

Tip:

You do not have to enter payment card information into your account unless you plan to use the card to purchase paid applications from the Play store.



NOTICE:

When creating a your new account, a reliable internet connection is necessary.

4.6. System

Date and time – the current date and time of the phone can be configured, as well as automatic GSM network or GPS synchronization, time and date format.

Schedule on/off – this function allows to schedule automatic turning on or off of the phone at a scheduled time and day of the week.



NOTIFICATION

In the event that your SIM card is protected by a PIN code, your phone will not log on the network after automatically switching on until you enter a valid PIN code.

Accessibility – used to customize your phone in case of problems with its control (e.g. gestures for zooming, large text, pronouncing the password, length of delay of touch and hold).

Print – this menu item is prepared for installing printing services.

Phone information – find device system information here.

5. Application of wireless sensor SWS 500

In the application list, you can also find application for connecting wireless sensor SWS 500, using which you will be able to view the status of current temperature and humidity measured by the sensor.

IMPORTANT: WIRELESS SENSOR SWS 500 IS NOT INCLUDED !!!

Connection

Open the settings on your smartphone and make sure that the Bluetooth is enabled. Wireless sensor appears under the name NGE76.

Start

Start the application on your phone and wait until the sensor automatically connects. First connection takes 1 to 30 seconds. Automatic update of data from the sensor every 5 minutes. After connecting the sensor, the screen displays the current time, temperature and humidity.

Viewing the 24-hour history of measurements

To view the 24-hour measurement history simply switch to green tile of temperature or blue tile of humidity.

The 24-hour measurement history page shows the current temperature, dew point, heat index and the minimum, maximum and average temperatures for the last 24 hours as well as 24-hour column chart.

Tip:

Follow the instructions in the manual for using the wireless sensor SWS 500.

6. Technical specifications

Display size: 5" (IPS LCD technology)

Resolution: HD 1280 × 720 (16.7 million colours)

3 Axis G sensor, gyroscope , proximity sensor, e-compass

Dual SIM

CPU: MTK MT6592 (Octa Core A7 1.3 GHz)

GPU: Mali-450 MP

RAM memory: 1 GB

Storage memory: 8 GB e-Nand

Micro SDHC card slot (up to 32 GB)

Front camera: 2 MPx

Back camera: 5.0 MPx (Auto Focus, Panorama, digital zoom, LED light)

GSM 850/900/1800/1900 MHz

WCDMA 900/2100 MHz

GPRS/EDGE/HSPA/HSUPA

Battery: 2500 mAh Li-Pol battery (300 hour battery life in standby mode – one SIM card)

Input power: 5V, 1000 mA

OS: Android 4.4.2 Kit Kat

WiFi: IEEE 802.11 b/g/n

Bluetooth: BT 4.0 EDR, A2DP

GPS/AGPS

FM radio (87.5–108 MHz)

Micro USB 2.0

Dimensions: 143.3 x 72.2 x 9.3 mm

Weight: 165 g (including battery)

Accessories: USB cable, charger, headphones

The above given specifications can change without prior notice.

Manufacturer address: FAST ČR, a.s., Černokostelecká 1621, 251 01 Říčany

The original version is in Czech.

The CE symbol shown on the unit, in the user's manual and on the package indicates the unit meets the basic requirements of guideline R&TTE, 1995/5/EC, Guideline for low voltage 73/23/EEC. The declaration of conformity can be found at www.sencor.cz.

INSTRUCTIONS AND INFORMATION REGARDING THE DISPOSAL OF USED PACKAGING MATERIALS

Dispose of packaging material at a public waste disposal site.



DISPOSAL OF USED ELECTRICAL AND ELECTRONIC APPLIANCES

The meaning of the symbol on the product, its accessory or packaging indicates that this product shall not be treated as household waste. Please, dispose of this product at your applicable collection point for the recycling of electrical & electronic equipment waste. Alternatively in some states of the European Union or other European states you may return your products to your local retailer when buying an equivalent new product.

The correct disposal of this product will help save valuable natural resources and help in preventing the potential negative impact on the environment and human health, which could be caused as a result of improper liquidation of waste. Please ask your local authorities or the nearest waste collection centre for further details. The improper disposal of this type of waste may fall subject to national regulations for fines.

For business entities in the European Union

If you wish to dispose of an electrical or electronic device, request the necessary information from your seller or supplier.

Disposal in other countries outside the European Union

If you wish to dispose of this product, request the necessary information about the correct disposal method from local government departments or from your seller.



This appliance complies with EU rules and regulations regarding electromagnetic and electrical safety.

Changes to the text, design and technical specifications may occur without prior notice and we reserve the right to make these changes.

SENCOR®

EN Warranty conditions

Warranty card is not a part of the device packaging.

This product is warranted for the period of 24 months from the date of purchase to the end-user. Warranty is limited to the following conditions. Warranty is referred only to the customer goods using for common domestic use. The claim for service can be applied either at dealer's shop where the product was bought, or at below mentioned authorized service shops. The end-user is obligated to set up a claim immediately when the defects appeared but only till the end of warranty period. The end user is obligated to cooperate to certify the claiming defects. Only completed and clean (according to hygienic standards) product will be accepted. In case of eligible warranty claim the warranty period will be prolonged by the period from the date of claim application till the date of taking over the product by end-user, or the date the end-user is obligated to take it over. To obtain the service under this warranty, end-user is obligated to certify his claim with duly completed following documents: receipt, certificate of warranty, certificate of installation.

This warranty is void especially if apply as follows:

- Defects which were put on sale.
- Wear-out or damage caused by common use.
- The product was damaged by unprofessional or wrong installation, used in contrary to the applicable instruction manual, used in contrary to legal enactment and common process of use or used for another purpose which has been designed for.
- The product was damaged by uncared-for or insufficient maintenance.
- The product was damaged by dirt, accident of force majeure (natural disaster, fire, and flood).
- Defects on functionality caused by low duality of signal, electromagnetic field interference etc.
- The product was mechanically damaged (e.g. broken button, fall).
- Damage caused by use of unsuitable media, fillings, expendable supplies (batteries) or by unsuitable working conditions (e.g. high temperatures, high humidity, quakes).
- Repair, modification or other failure action to the product by unauthorized person.
- End-user did not prove enough his right to claim (time and place of purchase).
- Data on presented documents differs from data on products.
- Cases when the claiming product cannot be indentified according to the presented documents (e.g. the serial number or the warranty seal has been damaged).

Authorized service centers

Visit www.sencor.eu for detailed information about authorized service centers.

SENCOR®

Let's live!

www.sencor.cz

Designed in Europe by Sencor®, Made in China

