

## How to tilt TMK bike carriers

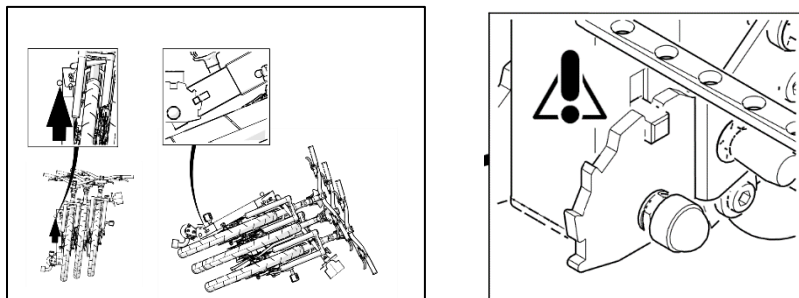

Push your carrier towards the car, lift the control ball and tilt slowly to position 1 or 2.

Back to driving position – push the bikes (by handlebars) towards your car until the square bar fits in (as illustrated)

## How to remove TMK bike carriers from the bar

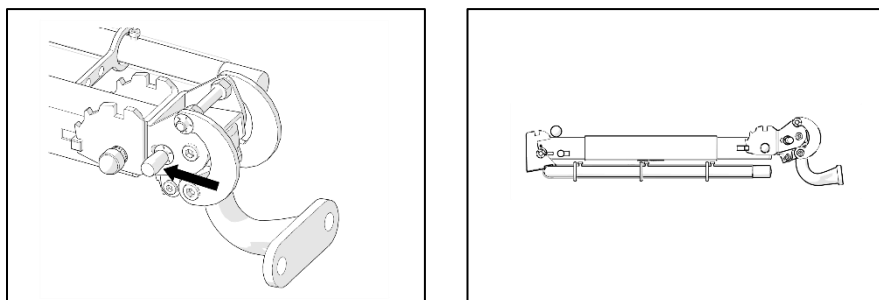

Push the locking peg in your direction (as arrow shows) and simultaneously tilt up upwards the body of the bike rack.

## Approval number - ATEST 8SD 3785

This product is identical to the type approved by Ministry of transport of the Czech Republic under approval number ATEST 8SD 3785.

Bike carrier can be used for approved for tow bars from producers with ISO 50 norm.

Load transport must comply with the requirements of Act No. 361/2000 Coll., on Road Traffic.

# TMK

system

Use instructions for TMK e-Classic and TMK Reflex

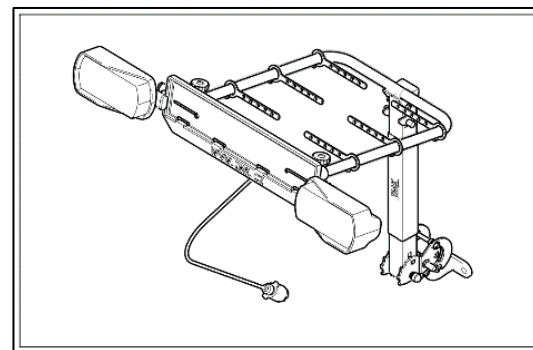

Instructions also on [www.tmk.cz/nosice-kol-tmk](http://www.tmk.cz/nosice-kol-tmk)

or



Suitable for 2 e-bikes (TMK e-Classic), or 3 regular bikes (TMK Reflex)

Load capacity:

50kg (TMK e-Classic)

60kg (TMK Reflex)

### Producer:

TMK system, s.r.o.

Husova 863

277 13 Kostelec nad Labem, Czech Republic

Package includes: **bicycle carrier** (incl. rubber belts) and **light panel**.

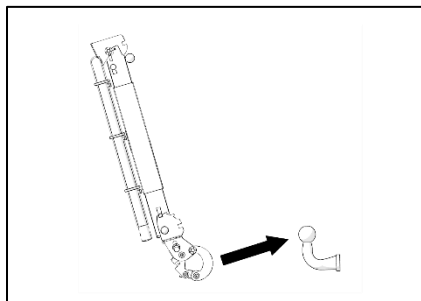

1) Place the bike carrier on the tow bar (lower "jaw" and upper "bowl" encircle the tow bar), push the body of the carrier in the direction of the arrow.

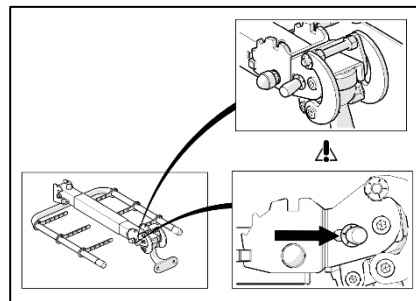
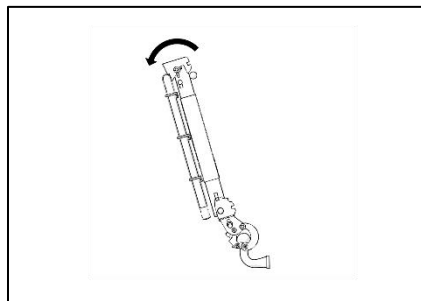

2) Check the peg fits as in the detail.

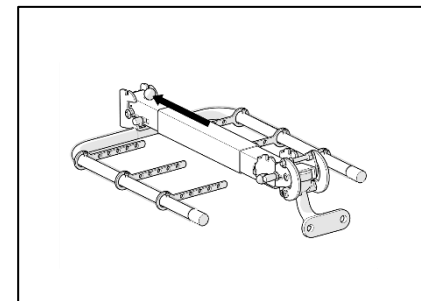

3) Move the control ball in the direction of arrow.

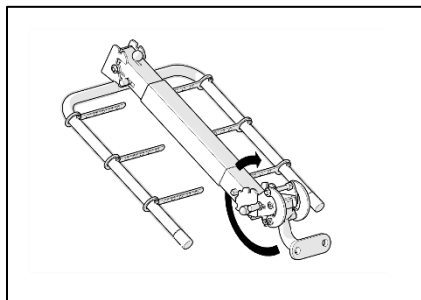

4) Hold the control ball and lift the carrier into driving position. Check the square bar fits as illustrated in the picture.

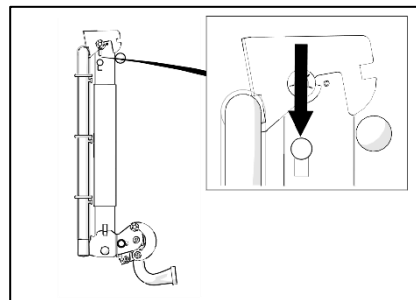
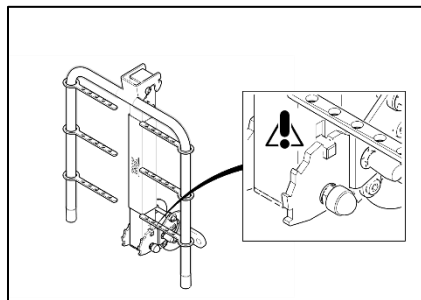

5) Press the peg in the direction of arrow, set the bended rods into horizontal position, check the peg fits correctly.

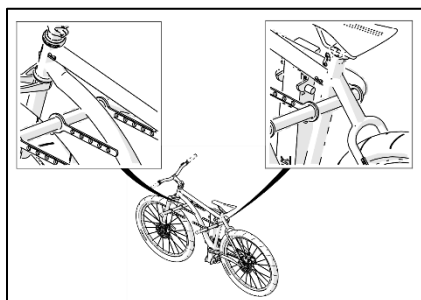
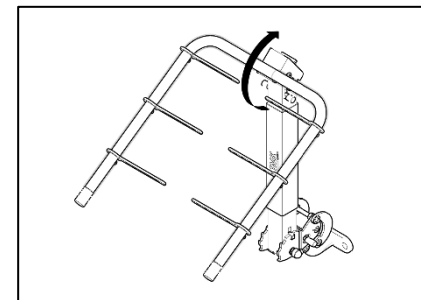

5) Hang up the bike on the bike carrier as illustrated (on lower frame and below seatpost), tighten the frame with rubber belts by the screw heads located at the bottom of the bended rods.

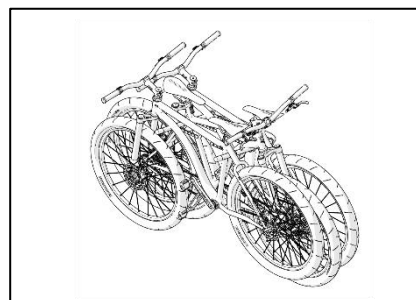
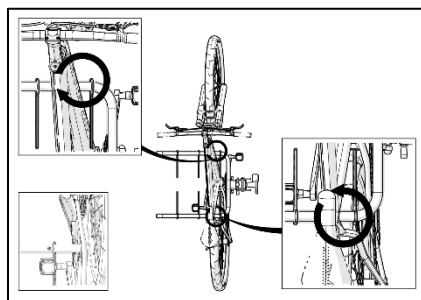

6) Mount the bikes inversely (seat to handlebars), tie a pedal of the first bike to the bike carrier, tie remaining bikes with straps together.

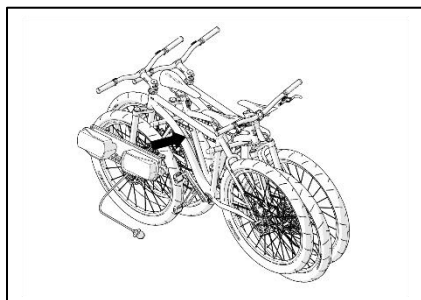
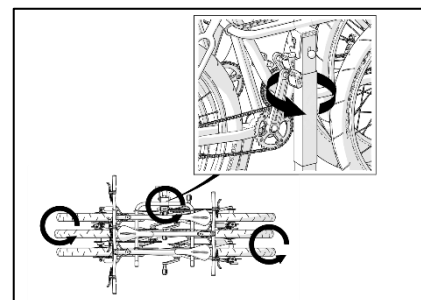

7) Place the light panel at the end of the bended rods, tighten the screws.

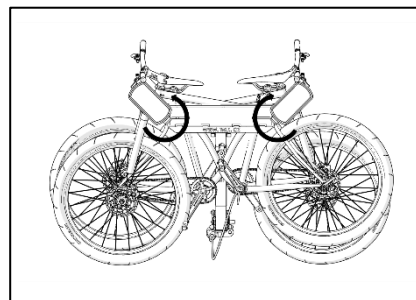
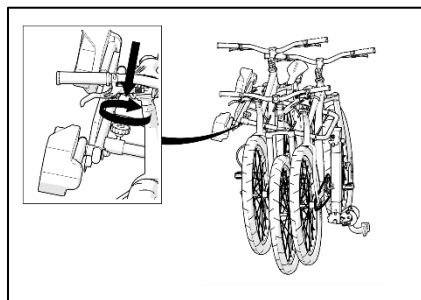

8) Move the lights CAREFULLY in the direction of arrows (DO NOT PUSH OVER), plug in

