

HEINNER

ELECTRIC KETTLE

Model: PF-47



- Electric kettle with 360 degrees rotating base and detachable filter
- Capacity: 1.5L
- Power: 2200W

www.heinner.com

Thank you for purchasing this product!

I. INTRODUCTION

Before using the appliance, please read carefully this instruction manual and keep it for future reference.

This instruction manual is designed to provide you with all required instructions related to the installation, use and maintenance of the appliance.

In order to operate the unit correctly and safety, please read this instruction manual carefully before installation and usage.

II. CONTENT OF YOUR PACKAGE

- **Electric kettle**
- **User manual**
- **Warranty card**



III. SAFETY PRECAUTIONS

- Before commissioning this kettle, please read the instruction manual carefully.
- Please keep the instruction manual, guarantee certificate, the sales receipt and if possible, the carton with the inner packaging.
- This kettle is intended exclusively for private use and not for commercial use
- Switch off the kettle and remove the plug from the socket when the kettle is not in use or before cleaning it. When you disconnect the power cord of the kettle, grasp and pull the plug, not the cord/cable.
- Switch off the kettle before cleaning the kettle.
- Keep the kettle out of the reach of children. Do not leave children unsupervised with the kettle.
- This appliance should not be used by persons (including children) with reduced physical, sensory or mental capabilities, or lack of experience and knowledge, unless they have are supervised by the person who is responsible for their safety. Children should be supervised to ensure that they do not play with the appliance.
- Test the kettle and the cord/cable regularly for damage. Check that the kettle and is operating properly. If there is damage of any kind or if the kettle is not operating properly, stop using the kettle and unplug it immediately.
- Do not attempt to repair the kettle yourself, only authorised and qualified personnel may repair this kettle.
- Keep the kettle and cord/cable away from heat, direct sunlight, water, moisture, sharp edges etc.
- Use only original accessories, do not connect incompatible products.
- Do not use the kettle outdoors.
- The base and exterior of the kettle are not water-resistant, keep it dry at all times.
- Under no circumstances must the kettle be placed in water or any liquid or come in contact with liquid. Do not handle the kettle with wet or moist hands. If the kettle become wet or moist, remove the main plug from the socket immediately.
- **Do not** touch the contents of the kettle.
- Use the kettle only for its intended purpose.
- The kettle is only to be used with the stand provided
- **Special safety instructions for the kettle**
- Use only cold water when filling the device.
- The water level must be between the MAX. and MIN. marks.
- Switch the kettle off before removing it from the base.
- Always ensure that the lid is tightly closed.
- The base and exterior of the kettle must not become wet.

IV. USING INSTRUCTION

Attention: Before using the kettle for the first time, fill the kettle with cold water and boiled it twice without any additives.

1. Fill the kettle with water. Do not overfill. Use the water level indicator.
2. Place the kettle on its base.
3. Electrical connection
 - Check whether the electrical voltage which you intend to use is the same as that of the kettle. Details can be found on the label on the kettle's base.
 - Only connect the kettle to a properly installed 220-240V 50/60Hz socket.
4. Switch the kettle to position '1'. The control lamp on the water indicator shows that the water is being boiled.
5. After boiling, the kettle switches off automatically.
 - Disconnect the kettle from the mains electricity supply.
 - Do not open the lid when pouring.
 - If the kettle is overfilled, boiling water may be ejected.
6. This appliance is intended only for household use.

V. CLEANING AND MAINTENANCE

- Always remove the plug from the mains supply before cleaning the kettle.
- The exterior of the kettle should be cleaned, if necessary, with a slightly damp cloth without additives.
- The calcium filter can be removed for cleaning.

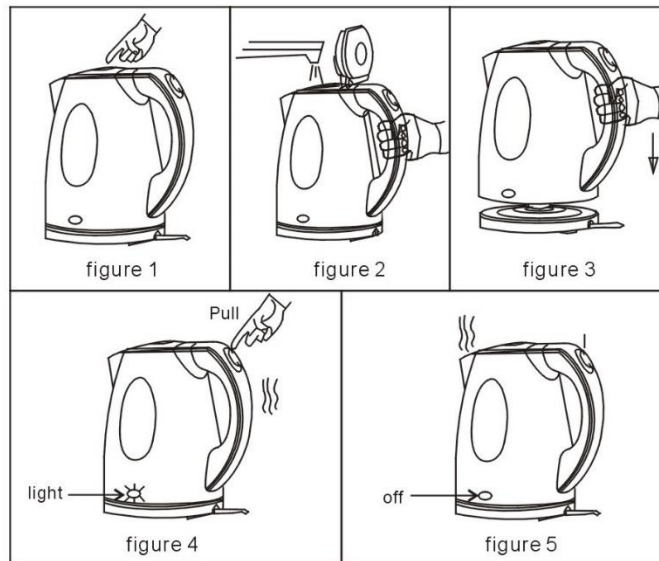

VI. TECHNICAL FICHE

Power:	2200W
Voltage:	220-240V, 50/60Hz
Capacity:	1.5L



Environment friendly disposal

You can help protect the environment!

Please remember to respect the local regulations: hand in the non-working electrical equipment's to an appropriate waste disposal center.



HEINNER is a registered trademark of **Network One Distribution SRL**. Other brands and product names are trademarks or registered trademarks of their respective holders.

No part of the specifications may be reproduced in any form or by any means or used to make any derivative such as translation, transformation, or adaptation without permission from NETWORK ONE DISTRIBUTION.

Copyright © 2013 Network One Distribution. All rights reserved.

www.heinner.com, <http://www.nod.ro>

<http://www.heinner.com>, <http://www.nod.ro>



This product is in conformity with norms and standards of European Community.

Importer: **Network One Distribution**

Marcel Iancu Street, 3-5, Bucharest, Romania

Tel: +40 21 211 18 56, www.heinner.com, www.nod.ro