

SENCOR®

SMG 4410WH



MEAT GRINDER

Translation of the original manual



SENCOR®

SMG 4410WH



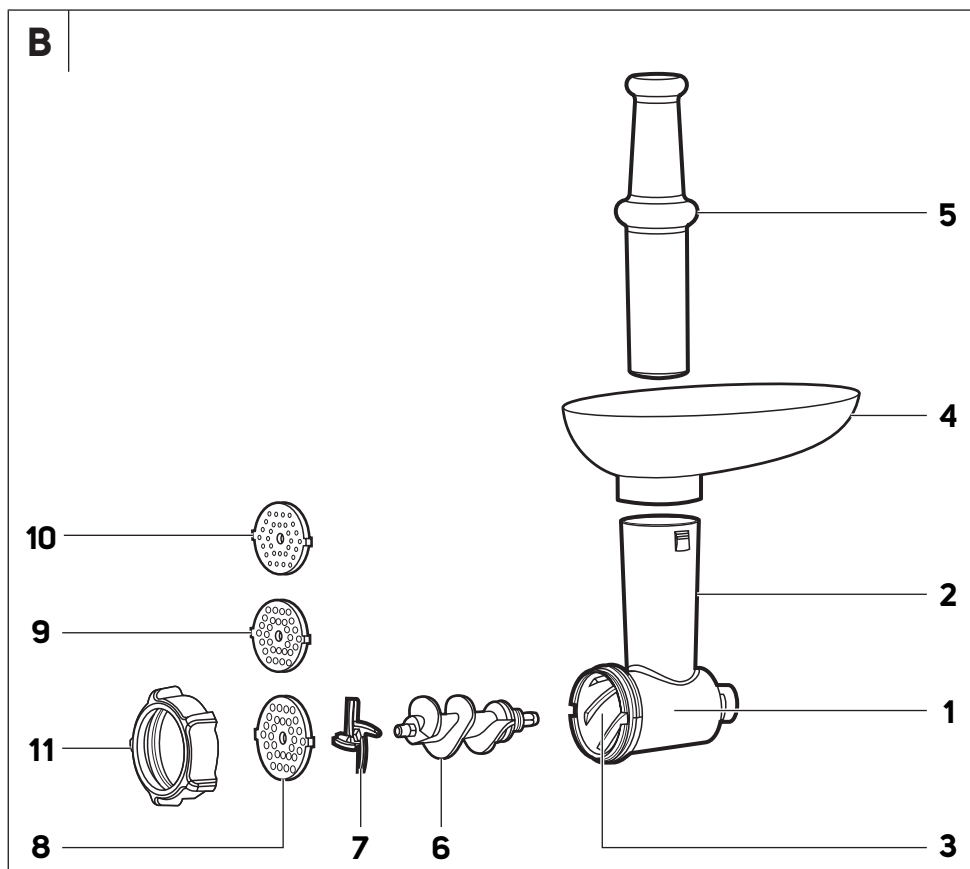
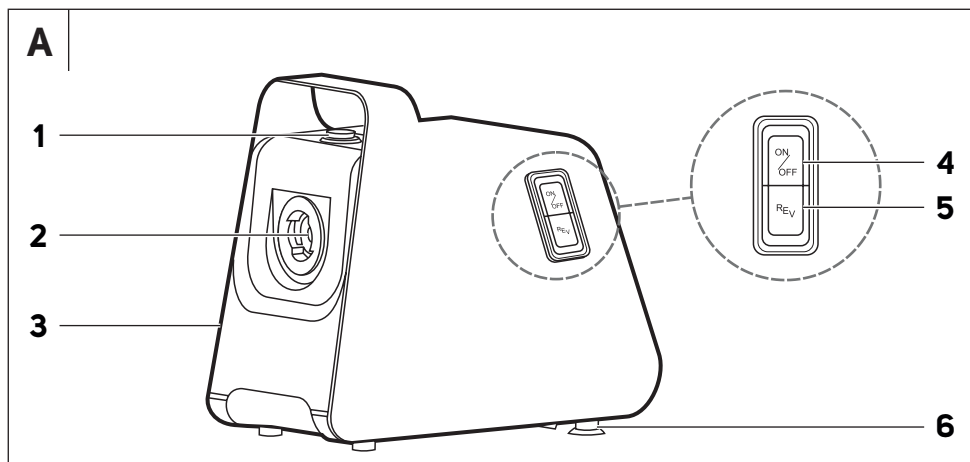

C

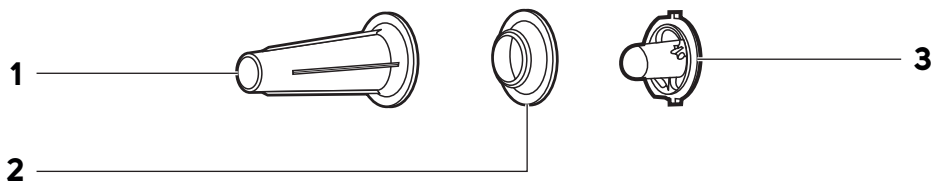

D

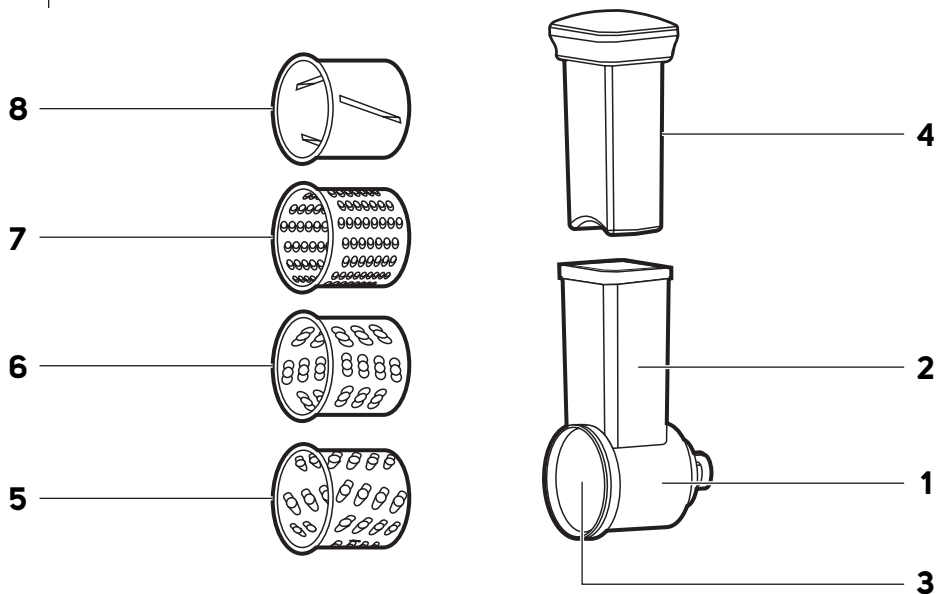

E

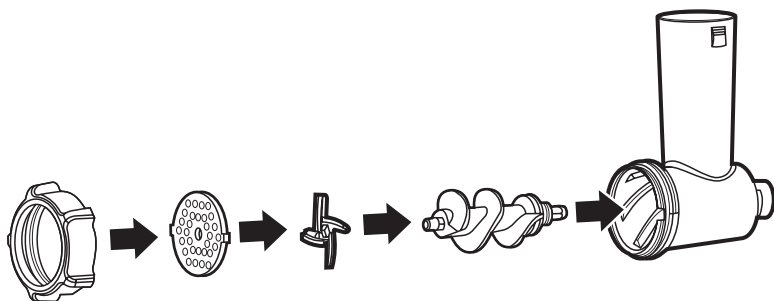

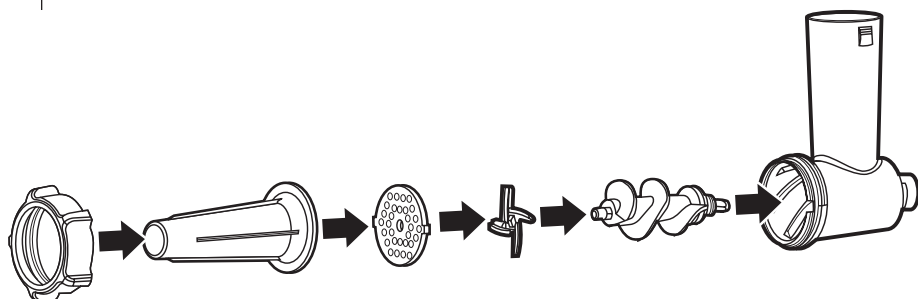
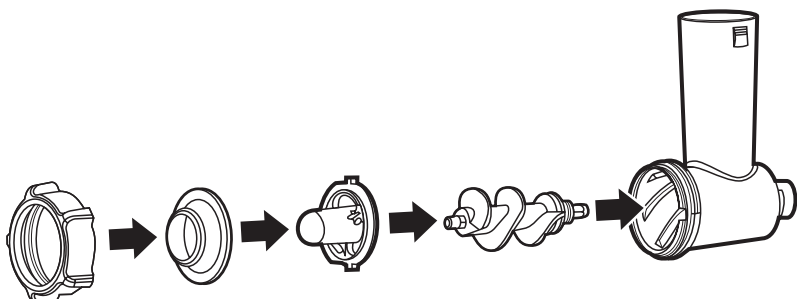
F**G**

H

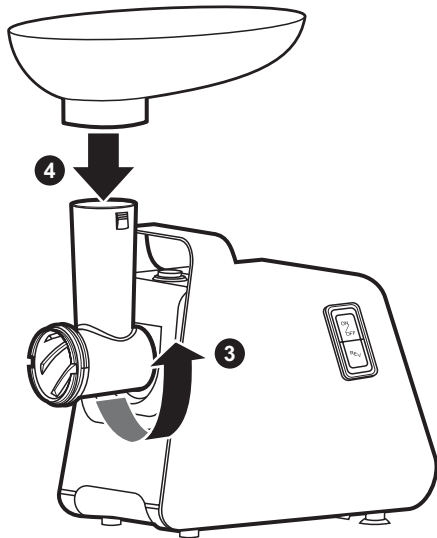
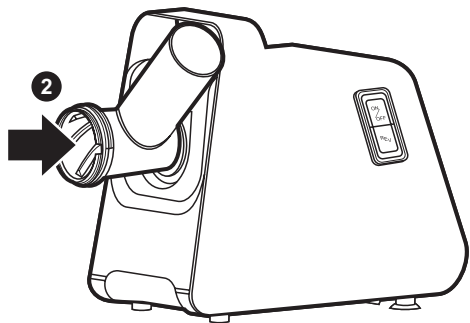
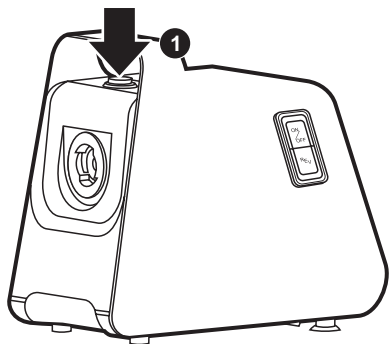

I

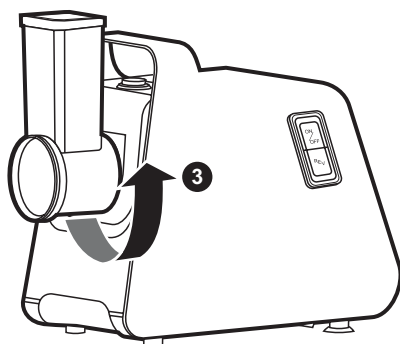
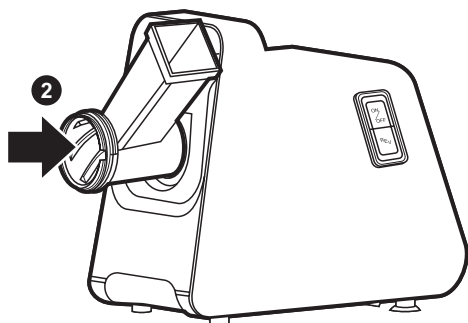
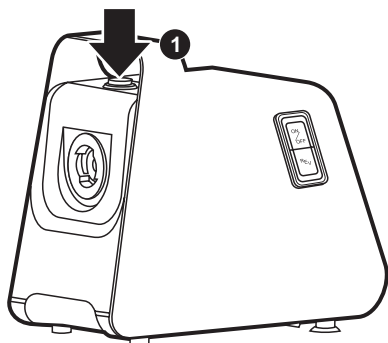

EN Meat grinder

Important safety instructions

READ CAREFULLY AND STORE FOR FUTURE USE.

- General warnings
- This appliance may be used by persons with physical, sensory or mental impairments or by persons with insufficient experience and knowledge, if they are properly supervised or have been informed about how to use the appliance in a safe manner and understand the potential dangers.
- This appliance may not be used by children. Keep the appliance and its power cord away from children.
- Children must not play with the appliance.
- In the event that the power cord is damaged, have it repaired at a professional service centre to prevent causing a dangerous situation. It is forbidden to use the appliance if it has a damaged power cord.
- Be especially careful not to injure yourself on the screw shaft and the cross blade when handling these parts, especially when inserting or removing them from the grinder and pay increased attention when cleaning them so as not to injure yourself on the sharp parts.
- The surfaces of the appliance and its accessories that come into contact with food must always be cleaned according to the instructions in this user's manual.

- Always turn off the appliance and disconnect it from the power socket if you will not be using it and if you will be leaving it without supervision, before assembly, disassembly, cleaning or moving it.
- Before replacing the accessories or accessible parts that move during use, turn the appliance off and disconnect it from the power supply.
- Never push the food into the feed tube using fingers or other utensils. Always use the provided pusher.



Warning:

Incorrect use may lead to injuries.

Electrical safety

- Before connecting this appliance to an electrical power socket, make sure that the voltage stated on its rating label corresponds to the voltage in your power socket.
- Connect the appliance only to a properly grounded socket. Do not use an extension cord.
- Fully unwind the power cord before use.
- Do not connect and disconnect the appliance's power cord to and from the power socket with wet hands.
- Ensure that the power plug contacts do not come into contact with water or any other liquid. If precisely this happens, carefully dry the power plug before using it again.
- Do not disconnect the appliance from the power socket by pulling on the power cord. This could damage the cord or the el. power socket. Disconnect the power cord from the power socket by pulling on the plug.
- Do not place heavy items on the power cord. Make sure the power cord does not hang over the edge of a table and that it is not touching a hot surface or sharp objects.
- Keep the power cord dry.
- Do not wind the power cord around the appliance.
- Always turn off the appliance and disconnect it from the power socket when not using it, when leaving it without supervision and before removing or replacing accessories, and before cleaning, maintenance or storage.
- Do not repair the appliance yourself or make any adjustments to it. Have all repairs or adjustments of the appliance performed at an authorised service centre. Tampering with the appliance during the warranty period may void the warranty.
- To prevent the risk of injury by electrical shock, never submerge the motor base unit and its power cord in water or any other liquid, or wash these parts under running water.
- Always turn off the appliance and disconnect it from the power socket when you have finished charging it.
- If the appliance falls into water, under no circumstances continue using it, but rather hand it over to an authorised service centre for inspection.
- This appliance is designed for household use. Do not use it for commercial purposes or for other purposes for which it is not intended.

Safety during use

- This appliance is designed only for household use and constructed for processing the usual amount of food in a household. Do not use this appliance for commercial purposes.
- Do not use the appliance in an industrial environment or outdoors. Do not use it for any other purposes than those intended.
- The appliance is intended for domestic use and similar locations such as:
 - kitchens in stores; offices and other workplaces;
 - in agriculture;
 - for guests of hotels, motels and other similar locations;
 - in bed and breakfast establishments.
- This appliance is not intended to be operated using an external timer switch or a remote control system.
- Use the appliance and its accessories in accordance with the instructions contained in this user's manual.
- Only use the appliance with the original accessories that came with it.
- Before every use, check the selected accessory for damage. Never use the appliance with a damaged accessory.

- Do not place the appliance or its accessories on an electric or gas stove or in its vicinity, on the edge of a table or on an unstable surface. Only place the appliance on an even, dry and stable surface.
- Do not expose the appliance and its accessories to the outdoor environment, extreme temperatures, direct sunlight, excessive humidity or excessively dusty environments.
- Do not place the appliance and its accessories near heaters, open fires or other sources of heat.
- Make sure that the appliance is correctly assembled before putting it into operation.
- Pay increased attention whenever handling the cross blade to prevent injury on the edges of the blade.
- Do not touch moving rotating parts during operation. Otherwise, this could result in injury.
- Always adhere to the operating time and the time intended for the cooling down of the appliance prior to it being started again. These times are provided in this user's manual in the relevant chapter.
- Do not turn on the appliance when it is empty. Incorrect use of the appliance may negatively affect its lifetime.
- Before disassembling the appliance into its individual parts, ensure that the appliance is disconnected from the electrical power socket.
- Do not use the appliance for crushing bones, nuts or other hard foods. Before using it, remove any bones, skin, cartilage, etc.
- Never process frozen food. Frozen food must be defrosted prior to being processed in the appliance.
- To prevent the appliance from clogging, push down gently on the pusher when adding the food into the feed tube.
- Always use the pusher supplied with the appliance. Never use your fingers or other items to push ingredients through the feed tube while the appliance is running.
- Do not perform any maintenance on the appliance other than cleaning the individual components as described in this user's manual.
- Never use an appliance that is damaged in any way.
- Do not use the appliance if it has fallen on the floor, if it was submerged in water, if it is not functioning correctly or if it is damaged in any other way.
- Do not submerge the motor base unit or its power cord in water or any other liquid, or wash these parts under running water. The motor base unit is not designed to be washed in a dishwasher.
- Do not use the appliance when it is not functioning properly or showing signs of damage.
- In order to prevent a hazardous situation arising, do not repair the appliance yourself or modify it in any way. Have all repairs performed at an authorised service centre. By tampering with the appliance, you risk voiding your legal rights arising from unsatisfactory performance or quality warranty.
- Store the appliance in a dry environment.

- Thank you for purchasing a SENCOR brand product and we hope that you will be happy with it.
- Prior to using this appliance, please read the user's manual thoroughly, even in cases, when one has already familiarised themselves with previous use of similar types of appliances. Only use the appliance in the manner described in this user's manual. Keep this user's manual in a safe place where it can be easily retrieved for future use. In the event that you hand this appliance over to somebody else, make sure to also include this user's manual.
- Carefully unpack the appliance and take care not to throw away any part of the packaging before you find all its parts. We recommend saving the original cardboard box, packaging material, purchase receipt and responsibility statement of the vendor or warranty card for at least the duration of the legal liability for unsatisfactory performance or quality. In the event of transportation, we recommend that you pack the appliance in the original box from the manufacturer.

- Clean the motor base unit using only a dampened cloth. At the same time, ensure that water does not enter into the base unit, especially into the control switches.
- Clean the grinder or grater attachment mounting hole only using a dry wiping cloth.
- Only clean the power cord of the motor base unit using a dry wiping cloth.

**Warning:**

Never rinse the motor base unit or its power cord under water or submerge it in water.

DESCRIPTION OF THE APPLIANCE

A1 Grinder or grating attachment lock/release button	A4 On/Off switch (ON/OFF)
A2 Hole for mounting the grinder or the grating attachment	A5 Reverse rotation button (REV)
A3 Motor base unit	A6 Anti-slip feet
B1 Grinder	B7 Cross blade
B2 Feed tube	B8 Coarse grinding plate (7 mm)
B3 Grinding chamber	B9 Fine grinding plate (5 mm)
B4 Feeder tray	B10 Extra fine grinding plate (3 mm)
B5 Pusher	B11 Screw ring
B6 Screw shaft	
C1 Sausage stuffer attachment	C3 Shaper (for making Kebbe)
C2 Separator (for making Kebbe)	

D1 Grater attachment	D5 Grater for coarse grating
D2 Feed tube	D6 Grater for fine grating
D3 Grating chamber	D7 Grater for very fine grating
D4 Pusher	D8 Grater for making slices

PURPOSE OF USE

- The grinder is intended for processing meat, poultry, fish, fruits and vegetables. Enables the grinding of all types of meats free of bones, sinew and skin.
- The grating attachment can be used for chopping, peeling, grating and slicing practically all types of fruits and vegetables. The grating attachments are used for the processing of fruit, vegetables, cheese and similar types of food.

BEFORE FIRST USE

- Before first use, wash all parts that come into contact with food in hot water using neutral dishwashing detergent. Then rinse these parts with clean water and allow them to dry naturally or dry them out their using a wiping cloth.

**Attention:**

No part of this appliance is designed to be washed in a dishwasher!
When cleaning the cross blade and the graters, be very careful not to injure yourself on their sharp parts.

USING THE MEAT GRINDER

ASSEMBLING THE GRINDER for grinding meat

(Fig. E)

- One by one, gradually insert the screw shaft, cross blade and the grinding disc into the grinding chamber, based on the preferred grinding fineness. Finally, screw the screw ring on to the grinding chamber and tighten it firmly.

**Attention:**

When attaching the cross blade, be very careful not to injure yourself on its sharp cutting edges.

ASSEMBLING THE GRINDER for sausage making

(Fig. F)

- One by one, gradually insert the screw shaft, shaper and the sausage stuffer attachment. Finally, screw the screw ring on to the grinding chamber and tighten it firmly.

ASSEMBLING THE GRINDER for making kebbe

(Fig. G)

- One by one, gradually insert the screw shaft, shaper and the separator attachment. Finally, screw the screw ring on to the grinding chamber and tighten it firmly.

LOCATION OF THE MOTOR BASE UNIT

- Place the motor base unit on an even, dry, clean and especially stable surface, for example on a kitchen countertop. Insert the motor base unit power cord into a power socket.

**Attention:**

Always locate the motor base unit in such a way that nobody can brush against it and thereby pull or push it over. Never locate it on the edge of the countertop or table, the vibrations during use may cause it to move resulting in a subsequent fall.

MOUNTING THE GRINDER ON THE BASE UNIT

(Fig. H)

- Press and hold down the lock/release button **A1** on the motor base unit.
- Tilt the assembled grinder to the right at an angle of approximately 45°, push it against the hole on the base unit and turn it anticlockwise to set it into the operating position.
- Release the grinder lock/release button.
- Insert the feeder tray into the feed tube.

GRINDING

- Before grinding, remove any bones, cartilage and tendons from the meat. Cut the meat into pieces measuring approximately 20 x 20 x 40 mm.
- Cut fruit and vegetables into pieces that will freely pass through the feed tube.



Attention:

Never attempt to grind frozen meat or other types of frozen food. It is necessary to allow frozen food to defrost completely before grinding it.

- Underneath the grinder, place an appropriate bowl into which the ground food will fall.
- Place the food that you wish to grind on to the feeder tray.
- Start the motor base unit by pressing the **ON/OFF** button.
- Gradually place the food into the feed tube, and using the pusher, push it down into the grinding chamber. To prevent the grinder from clogging, do not overfill the feed tube. Push down gently on the pusher.



Warning:

Never use fingers or other items to push the ingredients in. For this, always use the provided pusher.

- In the event that the feed tube becomes clogged, first turn off the grinder using the **ON/OFF** button and attempt to release it using reverse rotation (see chapter REVERSE ROTATION). If reverse rotation does not release the grinder, disconnect it from the power socket, take the grinder off the base unit and clean it out. If necessary, completely disassemble the grinder, clean it out and reassemble it. Mount it back on to the motor base unit and continue working.



Attention:

The maximum continuous operating time of the appliance is 5 minutes. Then allow it to cool down for approximately 10 minutes.

- When you have finished using it, stop the base unit using the **ON/OFF** button and disconnect the power cord from the power socket. Ensure that the rotating parts have stopped rotating, take the grinder off the base unit (see REMOVING THE GRINDER FROM THE BASE UNIT) and disassemble it into its individual parts. Then clean all used parts according to the instructions in chapter CLEANING AND MAINTENANCE.

REVERSE ROTATION

- In the event that the grinder behaves in an unusual manner (e.g. it is noisier or vibrating, the grinding chamber is clogged), turn it off by pressing the **ON/OFF** button. Then press the **REV** button (reverse rotation).
- The screw shaft will start rotating in reverse direction and the grinding chamber will start emptying itself.
- If this does not happen, disconnect the base unit from the power socket, completely disassemble the grinder, clean it out and reassemble it. Mount it back on to the motor base unit and continue working.

MAKING SAUSAGES OR KEBBE

- Prepare a ground meat mixture and a casing for stuffing. Place the casing into lukewarm water for 10 minutes before filling it. Slide the wet casing on to the attachment. Leave a few free centimetres at the end of the casing and then tie it or skewer it.
- Insert the feeder tray into the feed tube.
- Start the motor base unit by pressing the **ON/OFF** button.
- Put the meat mixture on to the feeder tray, and using the pusher, push it down into the grinding chamber. To prevent the grinder from clogging, do not overfill the feed tube. Push down gently on the pusher.



Warning:

Never use fingers or other items to push the ingredients in. For this, always use the provided pusher.

- When making Kebbe, the grinder will extrude hollow tubes that you can cut to the required length.
- In the event that the feed tube becomes clogged, first turn off the grinder using the **ON/OFF** button and attempt to release it using reverse rotation (see chapter REVERSE ROTATION). If reverse rotation does not release the grinder, disconnect it from the power socket, take the grinder off the base unit and clean it out. If necessary, completely disassemble the grinder, clean it out and reassemble it. Mount it back on to the motor base unit and continue working.



Attention:

The maximum continuous operating time of the appliance is 5 minutes. Then allow it to cool down for approximately 10 minutes.

- When you have finished using it, stop the base unit using the **ON/OFF** button and disconnect the power cord from the power socket. Ensure that the rotating parts have stopped rotating, take the grinder off the base unit (see REMOVING THE GRINDER FROM THE BASE UNIT) and disassemble it into its individual parts. Then clean all used parts according to the instructions in chapter CLEANING AND MAINTENANCE.

REMOVING THE GRINDER FROM THE BASE UNIT

- Press and hold down the lock/release button **A1** on the motor base unit.
- Turn the grinder clockwise (to the right) to an angle of approximately 45° and slide it off the hole of the base unit.
- Release the lock/release button.

USING A GRATING ATTACHMENT

ASSEMBLY

(Fig. D)

- Depending the preferred grating fineness, select a grater and insert it into the grating chamber of the attachment. Turn the grater clockwise to lock it in the chamber.



Attention:

When handling the graters, be very careful not to injure yourself on their sharp parts

MOUNTING THE GRATING ATTACHMENT TO THE BASE UNIT

(Fig. I)

- Press and hold down the lock/release button **A1** on the motor base unit.
- Tilt the attachment to the right at an angle of approximately 45°, push it against the hole on the base unit and turn it anticlockwise to set it into the operating position.
- Release the lock/release button.

GRATING

- Place an appropriate container, into which the grated food will fall, underneath the outlet of the attachment.
- Cut the food into pieces that are suitable for insertion into the feed tube of the attachment.
- Start the motor base unit by pressing the **ON/OFF** button.
- Gradually place the food into the feed tube, and using the pusher, push it down into the chamber. To prevent the grater from clogging, do not overfill the feed tube. Push down gently on the pusher.

**Warning:**

Never use fingers or other items to push the ingredients in. For this, always use the provided pusher.

- When you have finished using it, stop the base unit using the **ON/OFF** button and disconnect the power cord from the power socket. Ensure that the rotating parts have stopped rotating, take the grater attachment off the base unit (see REMOVING THE GRATER ATTACHMENT FROM THE BASE UNIT) and disassemble it into its individual parts. Then clean all used parts according to the instructions in chapter CLEANING AND MAINTENANCE.

REMOVING THE GRATING ATTACHMENT FROM THE BASE UNIT

- Press and hold down the lock/release button **A1** on the motor base unit.
- Turn the attachment clockwise (to the right) to an angle of approximately 45° and slide it off the hole of the base unit.
- Release the lock/release button.

CLEANING AND MAINTENANCE**Warning:**

Prior to any cleaning or maintenance, always turn off the appliance, disconnect it from the power socket and disassemble it into its individual parts. Never clean any part when the grinder or a grating attachment is mounted on the base unit and the base unit is connected to a power socket. Never use chemicals, dishwashing abrasive wool, steel wool or cleaning products with abrasive components for cleaning. Otherwise the surface of the parts may be damaged.

**Note:**

Remains of unground meat may remain in the grinding chamber that are hard to clean away. To make their removal easier, you can grind a piece of bread or bread roll. We recommend disassembling the grinding attachment in a kitchen sink or a larger bowl to prevent potentially soiling the work surface.

If the grinder or the grating attachment is used for an extended period of time, it is possible that the base unit may be hot to touch. Allow it to cool down before cleaning it.

- We recommend cleaning all the parts as soon as possible after use, before the food scraps dry on. These are harder to remove later.
- Disassemble the grinder or the grating attachment into its individual parts. Clean the all the removed parts from food remains, wash in warm water with dish washing detergent and rinse under clean running water. Then allow them to dry naturally or dry them out thoroughly using a wiping cloth. Do not use abrasive cleaning products.

**Attention:**

No part of this appliance is designed to be washed in a dishwasher! When cleaning the cross blade and the graters, be very careful not to injure yourself on their sharp parts.

- Clean the motor base unit using only a dampened cloth. At the same time, ensure that water does not enter into the base unit, especially into the on/off and reverse rotation switches.
- Clean the grinder or grater attachment mounting hole only using a dry wiping cloth.
- Only clean the power cord of the motor base unit using a dry wiping cloth.

**Warning:**

Never rinse the motor base unit or its power cord under water or submerge it in water.

STORAGE

- When you have finished using the appliance and its parts, store these in a clean, dry place out of children's reach. Keep the stored appliance and its parts away from extreme temperatures, direct sunlight and excessive humidity and do not store these in an overly dusty environment.

TECHNICAL SPECIFICATIONS

Rated voltage range.....	220-240 V
Rated frequency.....	50-60 Hz
Rated power input.....	500 W
Max. input.....	1400 W
Capacity.....	1.7 kg/min
Weight (approximate).....	3.4 kg
Electrical shock protection class.....	II
Noise level.....	90 dB(A)

The declared noise emission level of the appliance is 90 dB(A), which represents a level A of acoustic power with respect to a reference acoustic power of 1 pW.

Explanation of technical terminology**Safety class for electrical shock protection:**

Class II – Electrical shock protection is provided by double or heavy-duty insulation.

Changes to text and technical parameters are reserved.

INSTRUCTIONS AND INFORMATION REGARDING THE DISPOSAL OF USED PACKAGING MATERIALS

Dispose of used packaging material at a site designated for waste in your municipality.

DISPOSAL OF USED ELECTRICAL AND ELECTRONIC EQUIPMENT

This symbol on products or original documents means that used electric or electronic products must not be added to ordinary municipal waste. For proper disposal, renewal and recycling, hand these appliances over to determined collection points. Alternatively, in some European Union states or other European countries you may return your appliances to the local retailer when buying an equivalent new appliance. Correct disposal of this product helps save valuable natural resources and prevents potential negative effects on the environment and human health, which could result from improper waste disposal. Ask your local authorities or collection facility for more details. In accordance with national regulations penalties may be imposed for the incorrect disposal of this type of waste.

For business entities in European Union states

If you want to dispose of electrical or electronic equipment, ask your retailer or supplier for the necessary information.

Disposal in other countries outside the European Union.

This symbol is valid in the European Union. If you wish to dispose of this product, request the necessary information about the correct disposal method from the local council or from your retailer.



This product meets all the basic requirements of EU directives related to it.

