



FZD 4015-E

English.....	3 - 18
Čeština.....	19 - 34
Slovenščina.....	35 - 50
Magyarul.....	51 - 66
Polski.....	67 - 82

Garden shredder

USER'S MANUAL

Thank you for purchasing this shredder. Before you start using it, please carefully read this user's manual and save it for possible future use.

TABLE OF CONTENTS

1. GENERAL SAFETY REGULATIONS	4
Important safety information	4
Packaging.....	4
User Manual.....	4
2. EXPLANATION OF INSTRUCTION LABELS ON THE MACHINE.....	5
3. DESCRIPTION OF THE MACHINE AND CONTENTS	6
4. SAFE OPERATION RULES.....	7
Instructions	7
Operation setup.....	7
Operation	7
5. MAINTENANCE AND STORAGE	8
6. SAFETY PRECAUTIONS AND INSTRUCTIONS.....	8
7. PRODUCT ASSEMBLY	11
8. HOW TO USE THIS PRODUCT.....	12
9. HOW TO HANDLE THIS PRODUCT.....	13
Turning the shredder on and off	13
Using the plunger	14
How to collect the shredded material	14
Knife replacement procedures	14
10. TROUBLESHOOTING PLAN	15
11. TECHNICAL SPECIFICATIONS	16
12. DISPOSAL	17

1. GENERAL SAFETY REGULATIONS

Important safety notice

- ✿ Unpack the product carefully and do not throw away any of the packaging until you have found all the parts of the product.
- ✿ Store the product in a dry place out of reach of children.
- ✿ Read all the warnings and instructions. Failure to comply with the warnings and instructions may lead to electric shock, fire and/or serious injuries.

Packaging

The product's packaging prevents damage during transport. This packaging is a resource and can be recycled.

User Manual

Before starting to work with the machine, please read the following safety regulations and instructions for use. Get familiar with the controls and correct use of the equipment. Keep the user's manual in a safe place for easy future reference. Save the original packaging, including the internal packing material, guarantee card and proof of purchase receipt for at least the time of the guarantee.

If you need to ship this machine, pack it in the original cardboard box to ensure maximum protection during shipping or transport (e.g. when moving or when you need to send this product for repair).

 **Note:** If you hand over the appliance to somebody else, do so together with this user's manual. Make sure you use the appliance properly by following the instructions in the included User manual. The user's manual also contains operating, maintenance, and repair instructions.

The manufacturer assumes no responsibility for accidents or damages arising from failure to comply with these instructions.

2. EXPLANATION OF THE INSTRUCTION LABELS ON THE MACHINE



ATTENTION: Please read the instructions carefully and get familiar with the controls and correct tool operation procedure.



ATTENTION: Keep hands, feet, hair and clothes at a safe distance from the shredder's moving parts.



Because of the potential risk of the processed material being thrown out of the shredder, keep other persons away from the machine.



Don't get close to the hopper or the spout. The edge still rotates 5 seconds after the machine has stopped.



ATTENTION: If the cable is damaged, don't touch it. Immediately unplug the cable from the mains, even if the equipment is not in operation or some service action is being performed (such as part replacement, repairs, modifications, cleaning).



ATTENTION: Always use hearing protectors, protection glasses and gloves.



ATTENTION: Do not use the shredder in wet or rainy weather and protect it against moisture.

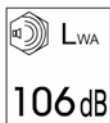

Noise level

This equipment has been tested and complies with the requirements of EN13683:2003, see Attachment F.

3. DESCRIPTION OF THE MACHINE AND CONTENTS

Machine description (Fig. 1.2)

Fig. 1

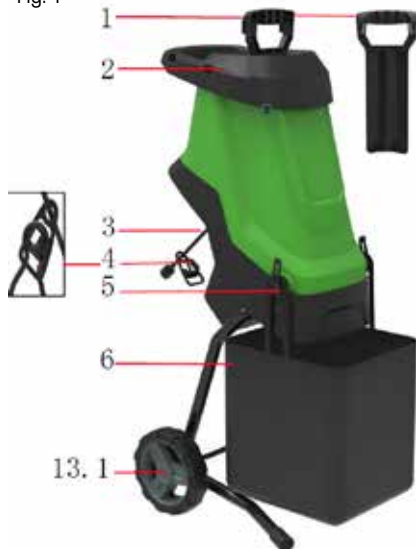

Fig. 2



- 1 - Stamper
- 2 - Cover with handle
- 3 - Power cable
- 4 - Cable holder
- 5 - Collection bag attachment
- 6 - Collection bag
- 7 - Allen key

- 8 - Knife plate cover release screw
- 9 - Mains switch
- 10 - Left shredder foot
- 11 - Right shredder foot,
- 12 - Axle
- 13 - Wheel
- 13.1 - Wheel cover

 **Note:** The above specification characterizes the machine's MAXIMUM CAPACITY.

Maximum limb thickness processed in this shredder is not specified as it depends on the wood thickness.

4. SAFE OPERATION RULES

Instructions

Before you start working with this equipment, please read the user's manual carefully.

Operation setup

- ✿ Do not allow children to operate the equipment.
- ✿ Do not use the machine near other persons.
- ✿ Don't use the power cord if damaged. If the power cord is damaged while working with the machine, don't touch the cable until the current supply is cut off. A damaged cord with live voltage could cause serious injury.
- ✿ Always wear protective glasses when operating the machine.
- ✿ Do not use loose clothes with loose strings, ribbons etc.
- ✿ Only use the equipment in open space (i.e. at a safe distance from walls and similar objects, for example). Work on firm and level surface.
- ✿ Do not use the equipment on paved or gritty surface where danger of injury could occur due to the processed material being thrown out.
- ✿ Before starting the machine, make sure that all bolts, clamps, nuts and other fasteners are correctly fitted and protective devices such as covers and barriers are in place. Remove damaged and illegible labels from the machine.

Operation

- ✿ Before starting the machine, please check if the filling chamber is empty.
- ✿ Keep your face and body at a safe distance from the feed opening.
- ✿ Do not move your hands or other body parts or clothes closer to the filling chamber (hereinafter only the hopper), output chute (hereinafter only the spout) or any other moving part of the machine.
- ✿ Don't lean. When filling the hopper, never stand above the machine base level.
- ✿ When using this equipment, always keep away from the output, or spout zone.
- ✿ Make sure that no foreign objects such as stones, glass or metal get into the shredder.
- ✿ If a shredding element collides with a foreign object or if unusual noise or vibrations appear, turn off the power supply and stop the machine. Perform the following steps:
 - check and fix loose movable parts.
 - repair damaged parts or change them for new ones with equivalent properties.
- ✿ Prevent the processed material from gathering in the spout area, as otherwise damage might occur leading to a possible backlash in the hopper zone.
- ✿ If a machine blocking occurs, turn off the drive unit before you start removing the dirt. Prevent the processed material chips from getting into the unit and protect the material from permanent damage or ignition.
- ✿ Keep all covers and deflectors in good condition and in place.
- ✿ Never move the equipment while the drive unit is running.
- ✿ Whenever you leave the equipment, please turn off the drive unit and unplug the equipment.
- ✿ Never tilt the shredder if powered.
- ✿ Keep the extension cord(s) away from the shredding mechanism parts. This may result in their damage and electric shock.

5. MAINTENANCE AND STORAGE

- ✿ If you are about to perform a service inspection of the equipment, store the equipment or replace any of its parts, turn off the drive, unplug the equipment and make sure that all movable machine parts have stopped. Before you start to perform the scheduled activity, wait until the equipment has completely cooled down.
- ✿ Allow the equipment to cool down before cleaning.
- ✿ When performing a service repair of the machine's shredding mechanism, please note that the mechanism can be also started manually despite the safety switch stop.
- ✿ Keep the valves/motor openings clear - not only of the shredded material residues, but also of all debris gathered here. This will eliminate risk of fire.
- ✿ If an extension cord is used to connect the equipment to the mains, such cord must not have a smaller cross-section area than the equipment's own power cord.
- ✿ Check the condition of the power and extension cord (if used) on regular basis for any signs of damage or wear. If so, don't use the equipment again.
- ✿ Never disable the safety switch.

6. SAFETY PRECAUTIONS AND INSTRUCTIONS

⚠ ATTENTION! When using electric garden tools, observe preventive safety measures to eliminate the risk of fire, electric shock or health impairment.

IMPORTANT – Safety, health and environment

- ✿ To ensure safety when using this electric tool, it's vital that you should understand and observe the equipment's safety operation rules.
- ✿ Before using the product, please also read this user's manual carefully and save it for further use.
- ✿ Before using the product for the first time, please read the instructions below and make sure that:
 - The power cord jacketing is clamped securely.
 - The extension cord jacketing is not damaged.
 - The cable(s) is (are) routed to eliminate the risk of damage and/or unplanned shutting the equipment off.
 - The line cable is fully unwound from the coil to avoid overheating.

⚠ ATTENTION! Please read carefully!

- ✿ When an equipment powered by alternating voltage is turned on, a short-time voltage drop (in V) may occur. Such drop may also affect other equipment (such as light flickering). However, if the AC power supply's impedance (Z_{max}) is less than 0.40 Ohms at 50 Hz, such malfunction cannot occur. For more detailed information, please contact your electric energy supplier.

Please use an extension cord for outdoor use.

- ✿ If you use your garbage shredder outdoors, always use extension cords designed for outdoor applications to connect the appliance to the mains.

Keep the work area clean!

- ✿ Mess and dirt may lead to accidents.

Take care to ensure appropriate working conditions.

- ✿ Do not expose your electric tools to rain.
- ✿ Do not use your electric tools in rain or wet weather.
- ✿ The working area must be well lightened.
- ✿ Do not use your electric tools in flammable or explosive environment.

Protect yourself against electric shock!

- ✿ Avoid close contact with grounded surfaces such as pipes, cables etc.

⚠ ATTENTION! Keep children and animals in safety!

- ✿ Do not let random incomers touch the machined or the extension cable. All non-participating persons, mainly children and animals, must not linger in the working area.

Store the machine if not used!

- ✿ Store the equipment in a dry place inaccessible to children if not in use.

Use appropriate tools!

- ✿ Do not use this electric tool for operations it's not designed or intended for.

Be dressed appropriately!

- ✿ Do not wear loose clothes or jewels when working with your shredder. These may get caught in the machine! For working with the equipment outdoors, wear gloves and shoes with anti-slip sole. Adjust and cover your long hair to prevent them from being caught on the machine.

Use personal protective working aids!

- ✿ Wear protective glasses, a face protection mask or a special mask protecting against dust, if required by the planned activity. During long working sessions or especially noisy activities, wear hearing protection.

It may come in handy...

- ✿ To optimally perform the set task, a relevant tool must be selected appropriately. It's not recommended to use an inappropriate tool to perform the required activity. So, think twice which tool to use for a given activity.

Hold firmly!

- ✿ To fasten the tool, always use clamps or a vice.

Beware of electric line!

- ✿ Make sure that the cable is clamped correctly and safely to prevent its disconnection, interruption or other damage such as due to excessive load.

Do not pull the power cord!

- ✿ Never handle the equipment by pulling the cord. Also, don't try to disconnect the equipment from the mains in this manner. Protect the extension cord against fire, oil and sharp edges.

Keep upright posture!

- ✿ Always keep upright and balanced posture.

Maintain your tools!

- ✿ Keep the shredding mechanism's edge sharp and clean to increase its performance. Also, be sure to perform lubrication and replacement of worn parts. Check the power cord on regular basis and return it to an authorized service centre for repair if needed. Also, pay attention to the extension cord's condition. Keep the equipment handled dry, clean and free of oil and lubricant residues.

Be always ready!

- ✿ Before further use, it's necessary that a damaged stop or other component should be checked and repaired to ensure proper functioning. Inspect the function and adjustment of all the machine's movable parts and their components. If protective covers and other similar devices get damaged, have them replaced in an authorized service centre unless otherwise specified in this user's manual. Similarly, have defective controls (switches/buttons) replaced in an authorized service centre. Don't use the equipment if these controls don't work correctly.

Danger of electrical shock!

- ✿ If you don't use the equipment or you are about to perform a repair or the replacement of a faulty component (such as a blade), always turn off and unplug the equipment first.

Habit is second nature!

- ✿ Before turning the machine back on after a service repair, make sure you have removed the just applied tools (such as spanners, pipe wrenches etc.) from the equipment.

Be always alert!

Do not move the powered equipment with your finger on the switch. Before connecting to the mains, make sure that the switch is in the off position.

Use your judgement!

- ✿ Think logically and don't use the equipment if you are tired, for example!

⚠ ATTENTION! Using parts or components that are not stated / recommended in the user's manual increases the risk of injury.

Seek a professional!

- ✿ This electric equipment complies with the relevant safety requirements. Please entrust all repairs to a qualified professional who uses only original spare parts. Otherwise you as the users put your health at risk. Do not attempt to open the tool cover. A qualified professional is authorized to replace the power cords.

Additional safety instructions

- * The power source voltage must match the voltage stated on the relevant equipment name plate.
- * It's useful if the shredder is used with a residual current device with sensitivity up to 30mA.
- * Use only cables with a weight of at least the weight of a rubber-insulated cable (H07RN-F type).
If possible, when selecting an extension cord, choose clear (easy to recognize) colours to facilitate their recognition.
- * Use common sense! Think twice before you act.
- * Be careful if you started the equipment's knives.
- * Do not use the cable for other purposes. Never use the cable as a towing device for handling or as a "remote control" of the power socket when unplugging remotely. Protect the cable from heat sources, oil and sharp objects (be careful of edges!). Route and secure the cable so that it does not obstruct or endanger anything and to prevent it from damage. Do not attempt to remove the equipment cover. Do not attempt to repair the equipment.
- * The power cord may only be repaired by authorized service staff.
- * If the cables are damaged or worn, don't use the shredder!
- * Do not connect a damaged cable in the mains. Do not touch a damaged cable if connected to the mains. A damaged cable is powered and dangerous.
- * Do not touch the shredding mechanism components if the equipment is powered and the shredding knives aren't fully stopped.
- * Keep the extension cords at a safe distance from the shredding mechanism. The mechanism edge could damage the cables leading to a possible contact with voltage.
- * Unplug the power cord in the following cases:
 - you are leaving the equipment which becomes unattended,
 - before inspection, cleaning or servicing the equipment.
 - collision with a foreign object has occurred. Verify if the equipment damage requires a repair.
 - the equipment starts to vibrate abnormally.

Plug replacement procedure

- * If any damage to the plug occurs where a replacement is required, please seek an electrician.
- * Never use the plug if damaged or incomplete.

7. PRODUCT ASSEMBLY

Fig. 3



Fig. 4

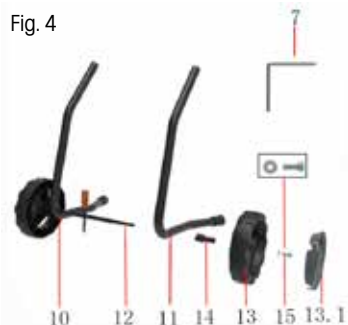

- ✿ Turn the machine upside down.
- ✿ Insert left and right foot (10;11) in the shredder's body (2) and secure them with the screws attached (16) (Fig. 3)
- ✿ Thread the axle (12) through the undercarriage holes (10; 11) (Fig. 4)
- ✿ Attach the wheels as per the drawing (Fig. 4)
 - 14 - wheel axle
 - 13 - wheel
 - 15 - tighten the fastening screw with washer using the Allen key (7)
 - 13.1 - wheel cover
- ✿ Tighten the knife plate cover release screw (8) (Fig. 2)

 **Note:** Using the shredder without a cover (1) is very dangerous.

8. HOW TO USE THIS PRODUCT

- ✿ Get well familiar with the user's manual and the machine itself before use.
- ✿ Before any intervention in the machine, stop the machine, unplug the power cord and make sure that all moving parts have come to a full stop.
- ✿ First thoroughly inspect the material you are about to process. Remove all foreign object that could be thrown out / be jammed in the machine during processing. Remove soil from the roots. Do not insert foreign objects such as stones, glass, metals, fibres or plastics in the hopper! This would cause damage to the shredding knives.
- ✿ Always place machine on an even and stable surface. Do not lean or make unnecessary movements while you operate the machine.
- ✿ Do not insert the material to be processed by shredding in the hopper until the shredding mechanism's rotating knives have reached their maximum speed.
- ✿ Use the machine to shred only the following material:
 - Twigs and limbs (with a maximum diameter of 40mm)
 - Bush pruning debris
 - Hedge pruning debris
 - Plant residues and other garden debris
 - Leaves and plant roots (remove soil from the roots before shredding)
- ✿ Do not insert soft kitchen biowaste in the machine and compost it instead.
- ✿ If the material to be processed is not excessively large, insert it in the hopper corner. It will be pulled inside by the knives.
- ✿ Fill the hopper to a reasonable level to avoid clogging and blocking.

 **ATTENTION!** You may be hit by longer oblong material pieces while being pulled into the shredding mechanism. Thus, keep away from the hopper!

- ✿ Make sure that the shredded material could freely exit the spout.
- ✿ In order to improve the composting usage, you can process the material twice in the shredder.
- ✿ Avoid situation when the material is gathering under the spout so much as to reach the shredding mechanism level. This would lead to blocking the knives and also the hopper.

- ✿ Organic materials contain large amount of water and sap that may get stuck on / clog the equipment. Therefore, it's useful to have the material dried a couple of days before processing.
However, the above is not applicable for bigger limbs that are optimally process in fresh condition.
- ✿ If the knives stop while the shredding is in progress, immediately stop the shredder. Then unplug it from the mains and only then start investigating the problem cause.
- ✿ Remove all processed material residues from the knife edges; then inspect the knives carefully to make sure they are not damaged. Only then continue with the shredding.
- ✿ If the edge stops for more than 5 seconds, the machine will be shut off by the overvoltage switch. Before turning the machine back on, wait at least one minute and let the machine cool down.
Then press the overvoltage switch first and then press the mains switch (On/Off) to restart the machine.
- ✿ If there is a collision between the shredding mechanism edge and a foreign object or if you hear the machine make unusual noise or abnormal vibrations, turn it immediately off and wait until the edge stops and remains at standstill. Unplug the power cord and proceed as follows:
 - Check for damage.
 - Replace or repair faulty parts.
 - Check and tighten all components that came loose due to the incident.
- ✿ If the equipment gets blocked, turn the machine off and wait until the edge stops. Before cleaning the equipment, unplug the power/extension cord from the mains.
- ✿ Clear the motor cooling vents of material residues and other deposits to reduce the risk of motor damage and possible fire.
- ✿ Turn the machine off, wait until the shredding mechanism knives stop and unplug the power cord from the mains whenever you interrupt your work to leave the workplace.
- ✿ Do not allow the processed material to gather in the hopper area. This will eliminate the risk of backlash that could otherwise occur in the hopper area.

9. HOW TO HANDLE THIS PRODUCT

Turning the shredder on and off

- ✿ Use the main switch (9) to turn the shredder on and off (Fig. 2) - Machine on - position "I", machine off - position "O"
- ✿ Let the machine run at idle for several seconds before you start shredding.

⚠ ATTENTION! Never remove the knife plate cover release screw without turning off the mains switch ("On/Off" button) and unplugging the power cord first.

⚠ ATTENTION! The shredder will stop working within 5 seconds after shutting off by pressing the mains switch.

Using the plunger

Fig. 5



Fig. 6



- ✿ The plunger is an aid to fill the hopper by smaller materials (such as tiny twigs, leaves, other garden debris and vegetation).
- ✿ Fill the hopper (Fig. 5).
- ✿ Press the plunger (1) (Fig. 6) to push the material inside onto the knife disc (Fig. 6)
- ✿ Wait until the material is crushed and then continue with inserting.

⚠ ATTENTION! Never insert your fingers in the hopper chute!

⚠ ATTENTION! Never use the equipment without the hopper!

⚠ ATTENTION! Do not lean over the hopper!

How to collect the shredded material

- ✿ Before you move the bag closer or further, please shut off the drive unit.
- ✿ To collect the material, you can use a collection bag (if supplied) or place the shredder on a canvas to capture the shredded material.
- ✿ If you use a collection bag it's necessary to attach both bag hooks onto the hopper chute.

⚠ ATTENTION! Don't cover the ventilation openings located on the machine body with a collection bag or crushed material.

Knife replacement procedures (Fig. 7)

Fig. 7

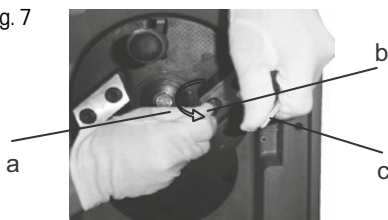

- ✿ Shut the shredder off and unplug it from the mains.
- ✿ Loosen the knife plate cover release screw to remove the top of the hopper assembly.
- ✿ The knives are both-sided. When the edge gets blunt, you can turn it upside down and use the other side.
- ✿ It's recommended to wear gloves when replacing the knives.
- ✿ To lock the shredding disc, please use an Allen wrench (c). Unscrew both internal hex nuts (b), paying close attention to the knife cutting angle (Fig. 7).
- ✿ Remove the knife and turn it by 180 degrees (a); seat the edge on the disc so that the edge bottom section points downwards (Fig.7).
- ✿ Repeat the same procedure for the second knife.
- ✿ If both knife edges get blunt, they should be replaced simultaneously. The edges can be sharpened again. (The sharpening must be only done by a skilled professional). However, this solution is not much recommended as it's vital for the correct machine functionality that the knives on the disk should be absolutely balanced. A slightest imbalance may lead to machine damage or even operator injury.

Product care

⚠ ATTENTION! When performing maintenance and cleaning of the machine, make sure that it's unplugged from the mains.

- ✿ If you are about to perform a service inspection of the equipment, store the equipment or replace any of its parts, turn off the drive and unplug the equipment.
- ✿ If you use an extension cord, this should not be lighter than the equipment's own power cord.
- ✿ Please check power cord and/or extension cord (if used) for possible signs of wear on regular basis. In the event of damage, don't use the equipment.
- ✿ When performing service jobs on the shredding mechanism, please note that the mechanism can be started manually even if the motor is locked by the safety switch tripping.
- ✿ Never disable the safety switch.
- ✿ Please use brush to remove dirt deposits from the equipment.
- ✿ Always clean the machine after use. To clean plastic components, use soap and a wet cloth. Never use aggressive substances and solvents.
- ✿ Never clean the shredder with water stream. Make sure that no liquid enters the shredder.
- ✿ Only use the shredder with recommended accessories.

10. TROUBLESHOOTING PLAN

The equipment won't operate	a) No power in the socket b) Shut the equipment off c) The overload switch has tripped d) Eject channel is blocked e) Feed hopper	a) Check cables and fuses b) Turn the equipment on c) Press the switch pin on the overload switch d) Clean the eject channel e) Clean the interior and tighten the lock screw
Poor shredding performance	a) Blunt knives	a) Turn the knives upside down, sharpen or replace them
Shredding performance decrease	a) Blunt knives	a) Turn the knives upside down, sharpen or replace them

11. TECHNICAL SPECIFICATIONS

Model #	FZD 4015-E
Rated voltage (V)	230 ~ 50Hz
Rated power input (W)	2800
No load speed (min-1)	4500
Maximum cutting thickness (mm)	40
Acoustic pressure dB(A)	95,8
Acoustic power dB(A)	106
Net weight (kg)	8
Ingress protection class	IPX4

User's manual is in original language.

12. DISPOSAL

The shredder and its accessories are manufactured from various materials, e.g. metal and plastics. Take damaged parts to a recycling centre. Inquire at the relevant government department.

INSTRUCTIONS AND INFORMATION ABOUT THE HANDLING OF USED PACKAGING

Dispose of used packaging material at the location designated by the municipality for waste disposal.

DISPOSAL OF USED ELECTRICAL AND ELECTRONIC EQUIPMENT



This symbol on products or original documents means that used electric or electronic products must not be added to ordinary municipal waste. For proper disposal and recycling of these products, deliver them to designated collection points. Alternatively, in some European Union states or other European countries the products can be returned to the local retailer when buying an equivalent new product. By properly disposing of this product, you help preserve valuable natural resources and contribute to preventing potential negative impacts on the environment and human health resulting from improper waste disposal. For further details, contact your local authorities or the nearest collection point. In accordance with national regulations penalties may be imposed for the incorrect disposal of this type of waste.

For Business Entities in European Union States

To dispose of electric or electronic equipment, request necessary information from your retailer or supplier.

Disposal in Other Countries Outside the European Union

This symbol is valid in the European Union. If you wish to dispose of this product, request the necessary information about the correct disposal method from the local council or from your retailer.



This product meets all the basic requirements of the applicable EU directives.

The text, design and technical specifications may be changed without prior notice and we reserve the right to make these changes.



FAST ČR, a.s.
 U Sanitasu 1621, 251 01 Říčany, Czech Republic
 tel.: +420 323 204 111, fax: +420 323 204 110

EU DECLARATION OF CONFORMITY

Product / brand: Electric Shredder / **FIELDMANN**

Type / model: **FZD 4015-E** as factory model WR4001-2800
 AC 220 – 240 V; 50Hz; 2400W (2800W-P40); Class II, IPX4
 $L_{PA} = 98,8 \text{ dB(A)}$, $L_{WA} = 106 \text{ dB(A)}$

Manufacturer: FAST ČR, a.s.
 U Sanitasu 1621, 251 01 Říčany, Czech Republic
 VAT no: CZ24777749

This declaration of conformity is issued under the sole responsibility of the manufacturer.
Person in charge of completing the technical documentation: FAST ČR, a.s.

The object of the declaration described above is in conformity with the relevant Union harmonization legislation:

Directive MD 2006/42/EC	Directive EMC 2014/30/EU
Directive NEOE 2000/14/EC	Directive RoHS 2011/65/EU+(EU)2015/863

The relevant harmonized standards and the other technical specifications:

EN 60335-1:2012+A11+A13+A1+A14+A2+A15	EN IEC 55014-1:2021
EN 50434:2014	EN IEC 55014-2:2021
EN 62233:2008	EN IEC 61000-3-2:2019+A1
	EN 61000-3-3:2013+A1+A2



Place of issuance: Prague
Date of issuance: 21. 05. 2024

Name: Miroslav Vácha - Responsible Person
Signature:

FAST FAST ČR, a.s.
 U Sanitasu 1621, 251 01 Říčany
 tel.: +420 323 204 111
 IČO: 247 77 749, DIČ CZ247 77 749

