

Infrared heating panel
SMART MIRROR-WLH series
INSTALLATION AND OPERATING INSTRUCTION







SYMBOLS



This signal word indicates a hazard with an average risk level which, if not avoided, can result in serious injury or death.



This symbol indicates dangers to the life and health of persons due to electrical voltage.

Symbols	Meaning
	This symbol located on the device indicates that it is prohibited to place objects (such as towels, clothes etc.) above or directly in front of the device. In order to avoid overheating and fire hazards, the device must not be covered.
	This symbol located on the device indicates dangers to the life and health of persons due to hot surface.
	This symbol located on the device indicates that it is prohibited to spray the device.
	This symbol located on the device and information marked indicates that operating manual must be observed.

CONTENT

- 1 | WARNING & PRECAUTION
- 2 | FEATURES
- 3 | TECHNICAL INFORMATION
- 4 | SCOPE OF SUPPLY
- 5 | DEVICE STRUCTURE
- 6 | INSTALLATION
- 7 | TROUBLESHOOTING
- 8 | MAINTENANCE & SERVICING
- 9 | STORAGE
- 10 | TECHNICAL ANNEX
- 11 | DISPOSAL

1 | WARNING & PRECAUTION

This smart mirror is a bathroom wall mirror with some utility functions include displaying weather/calendar/temperature & humidity, LED illuminant, and defogging function etc. Users can select the product with different functions according to the different needs. Please ignore the related operating instructions in this booklet if you didn't subscribe some functions.

Read this manual carefully before starting or using the device. Always store the manual in the immediate vicinity of the device or its site of use!



Do not ceiling mount those devices designed for wall only!
Or else it may cause burning, fire and falling off risk!



This appliance can be used by children aged from 8 years and above and persons with reduced physical, sensory or mental capabilities or lack of experience and knowledge if they have been given supervision or instruction concerning use of the appliance in a safe way and understand the hazards involved.

Children shall not play with the appliance. Cleaning and user maintenance shall not be made by children without supervision.



Children of less than 3 years should be kept away unless continuously supervised.
Children aged from 3 years and less than 8 years shall only switch on/off the appliance provided that it has been placed or installed in its intended normal operating position and they have been given supervision or instruction concerning use of the appliance in a safe way and understand the hazards involved.

Children aged from 3 years and less than 8 years shall not plug in, regulate and clean the appliance or perform user maintenance.



Do not use the device in small rooms if persons are present who cannot leave the room independently and who are not under constant supervision.



Some parts of this product can become very hot and cause burns. Particular attention has to be given where children and vulnerable people are present. Its dangerous of installation close to curtains and other combustible materials. To avoid the possibility of burns, the following people should be much more careful when using the heaters: infants and kids, people with sensitive skin, the old, the sick, people who is drunk, people who takes sleeping pills.

- Remove all the blue protective films (both on the front and on the back) before using.
- Be sure the usage voltage conform to local voltage, and power supply has been strictly in accordance with IEC, left is null wire and right is live wire, and also well grounded.
- The devices will draw more current than small appliances, so a separate 5A socket is required.
- Do not use the device in potentially explosive rooms.
- Do not use the device in aggressive atmosphere.
- Set the device up in an upright and stable position.
- Let the device dry out after a wet clean. Do not operate it when wet.
- Do not use the device with wet or damp hands.
- Do not expose the device to directly squirting water.
- Never insert any objects or limbs into the device.
- Do not cover or transport the device during operation.
- Do not sit on the device.
- This appliance is not a toy! Keep away from children and animals. Do not leave the device unattended during operation.
- Check accessories and connection parts for possible damage prior to every use of the device. Do not use any defective devices or device parts.
- Ensure that all electric cables outside of the device are protected from damage (e.g. caused by animals). Never use the device if electric cables or the power connection are damaged!
- The electrical connection must be according to the specifications in chapter Technical data.
- Insert the mains plug into a properly secured mains socket.
- Do not use the device when the socket or wire overloaded.
- Observe the device's power input, cable length and intended use when selecting extensions to the power cable. Completely unroll extension cables. Avoid

electrical overload.

- Before carrying out maintenance, care or repair work on the device, remove the mains plug from the mains socket. Hold onto the mains plug while doing so.
- Switch the device off and disconnect the power cable from the mains socket when the device is not in use.
- Do not under any circumstances use the device if you detect damages on the mains plug or power cable. If the supply cord is damaged, it must be replaced by the manufacturer, its service agent or similarly qualified persons in order to avoid a hazard. Defective power cables pose a serious health risk.
- During the installation of the device observe the minimum distances from walls and other objects as well as the storage and operating conditions specified in the Technical data chapter.
- Never drill into the heating device.
- Do not use the device once any damage found on the glass or mirror surface.
- Do not use the device in immediate proximity to curtains.
- Do not place the device on combustible ground.
- Do not transport the device during operation.
- Do not touch the surface during the device working to avoid burns.
- Allow the device to cool down before transport and / or maintenance work.
- Do not use this device near bathtubs, shower trays, swimming pools or other water containers. Risk of electric shock!
- The device must be placed where the switches and controllers cannot be touched by a person in a bathtub or shower.
- Do not use this device in a child-care centre and bathroom.(Only for Sweden)
- Do not place any objects, e.g. clothing, on the device.
- Do not use the device outdoors. Do not place the device on wet or flooded ground.
- Do not unplug by pulling on the cable. To unplug, grasp the plug, not the cable.
- Do not stretch the cable or place the cable under strain. Keep cable away from

heated surfaces.

- Do not run the cable under carpeting. Do not cover the cable with throw rugs, runners, or similar coverings. Do not route the cable under furniture or appliances. To avoid a tripping hazard arrange the cable away from traffic areas so that it will not be tripped over.
- Do not use on soft surfaces, such as a bed, where openings may become blocked.
- Keep combustible materials, such as furniture, pillows, bedding, papers, clothes and curtains, at least 0.9m (3 feet) from the front of the appliance and keep them away from the sides and rear when the appliance is plugged in.
- If there is a loose fit between the plug and the socket or the plug becomes very hot, the socket may need to be replaced. Check with a qualified electrician to replace the socket.
- Turn off all controls before unplugging. Unplug before connecting any tool or accessory.
- Allow the device to cool down before transport or maintenance work.
- Do not privately disassemble the device or replace parts, otherwise it may cause mechanical failure, electric shock, fire or body injury.
- The warranty is not applicable for the product fault caused by private disassembly.

2 | FEATURES

- The device is designed to provide an efficient, comfortable and
- healthy heating system for any domestic users.
- These devices can reduce air circulation and help to maintain a
- clean, silent, dust free environment.
- A wide range of devices available in a huge choice of colors, sizes and styles.

3 | TECHNICAL INFORMATION

⚠ Warning:

Do not cover.

Insert the mains plug into an outlet that is properly installed and grounded.

Do not locate directly below a mains electricity supply socket.

Voltage	220-240V/50Hz
Surface	Tempered mirror
Material	Mirror + Aluminum
IP grade	IP54 (exclude plug)
Power cord length	1.9m
LED Light	3000K or 6000K or 4500K
Weather Server	Internet Weather
Touch Switch	One or Two Touch Switch
Thermostat	Optional

Model NO.	Size(mm)	Heating Power(W)	LED Power (W)	Voltage Frequency
IGT2-G0606-WLH	600*600*22	200	10	230V/50Hz
IGT2-G0806-WLH-H/V	800*600*22	250	12	
IGT2-G1006-WLH-H/V	1000*600*22	350	13	
IGT2-G1206-WLH-H/V	1200*600*22	500	15	

4 | SCOPE OF SUPPLY

- 1 x heating device
- 4 x Screws
- 4 x Dowel
- 1 x Drilling template
- 1 x Manual

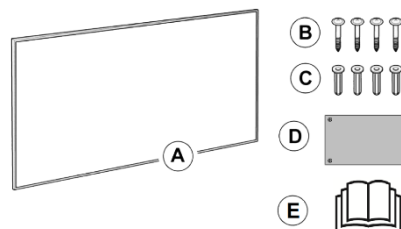

These kits can be used for wall mounting only, special kits shall be used for ceiling mounting, please consult the supplier before installation.

5 | DEVICE STRUCTURE

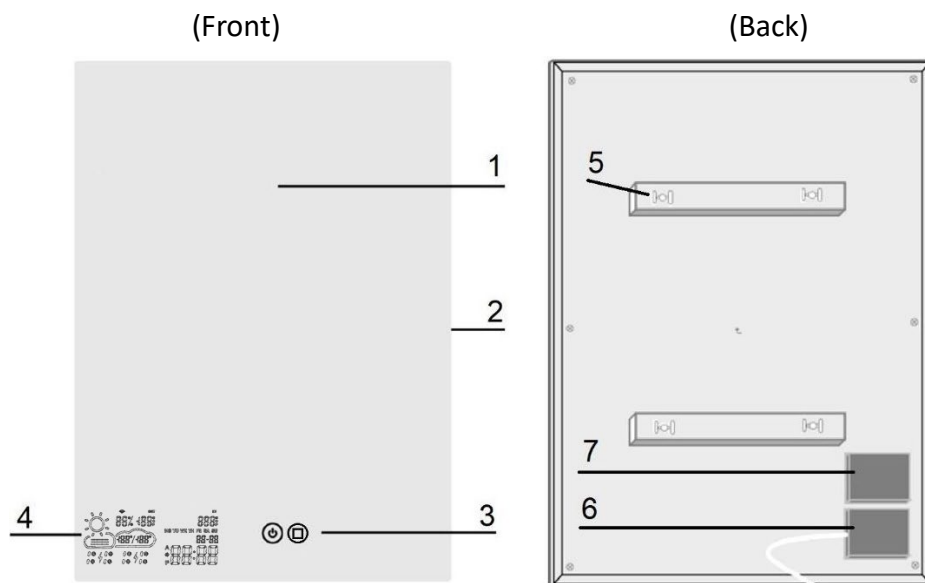

- ① Mirror Surface
- ② LED Lighting
- ③ Touch switch for smart functions
- ④ Display Screen (Visible when double-click)
- ⑤ Mounting Brackets
- ⑥ Temperature Sensor
- ⑦ Built-in thermostat(optional)

6 | INSTALLATION

- (1) Choose the mounting position, keep the required minimum distances;
- (2) Mark the positions for the bore holes onto the drilling template (D) if there are no existing marks. Stick the drilling template on the wall;

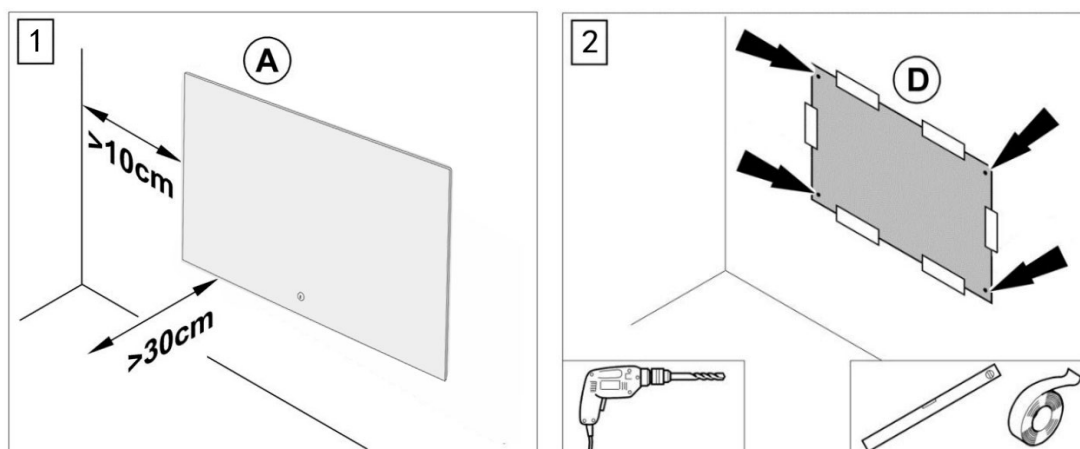

- (3) Drill the holes. Insert the screws into the dowels and fasten the screws. The screws should protrude approx.1.5 cm from the dowels;

(4) Tear off the back protective film, Hang the mirror (A) on the screws and move it to one direction.

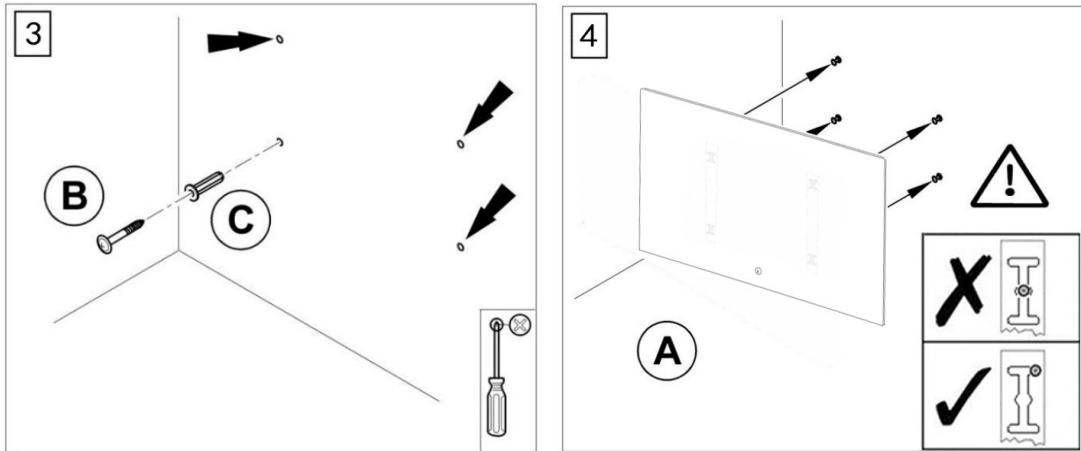



Note: please tear off the front and back protective film once you start using the device.

SMART function settings

1. Check if the power cord is intact.
2. Check if the power supply voltage is consistent. ***(The power socket is required to have a grounding terminal and good grounding performance.)***
3. Whether the power cord plug and socket are matched, the socket can withstand minimum circuit requirement. If not, it cannot be used to avoid accidents.

Touch buttons function on the mirror

Plug in power, the backlit of the touch buttons are in the active status.

Functions	Button	Events	Retrieved from
LED light		1x click	Switching LED lighting on/off
		2x clicks	Changing the color of the light White/yellow/dual
		Holding	Brightness adjustment +/-
Weather		Double click	Turning on/off the display
Heating		Long press	Switching on/off the heater (without built-in thermostat)

Heating		<p>If a thermostat is built-in, the heating function will be controlled by the built-in thermostat (second black junction box)</p> <p>See the user manual for the built-in thermostat.</p>
---------	--	--

Note: Weather display needs to be configured in advance, please check the following instruction.

Instructions for setting up the weather display

1. Make sure that your router, phone and the mirror are as close as possible during the process of WIFI connecting; Make sure that the mirror can get good WIFI coverage after mounting; and **Make sure that the smart phone are connected to the 2.4Ghz WIFI network invariably during the following configuration process.**
2. For Android users, please search “WiseMirror” App in Google Play Market, download and install it on mobile phone.
For IOS system, please search and install the APP named “WiseMirror” in App Store.



WiseMirror App

3. After the app has been successfully installed, please click the WiseMirror App as shown in above figure and enable Bluetooth and GPS etc related permissions according to the pop-up reminders

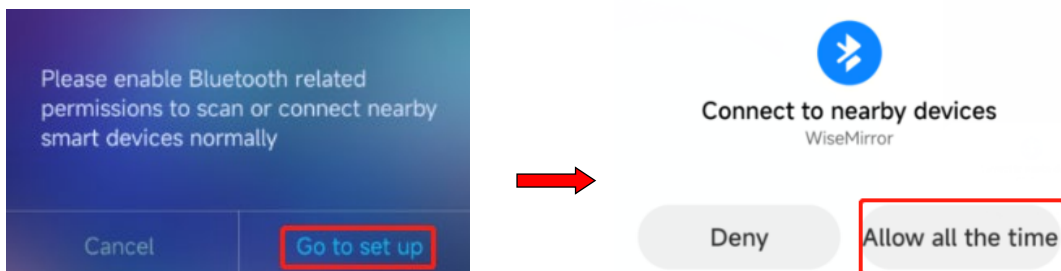

4. Once authorization is completed, the following interface is displayed on the APP, click + to add a WiseMirror. In next interface, please enter the password of your

2.4Ghz network (If at step 1,your phone has already connected to a 2.4Ghz home wifi, it will automatically pickup this network in this interface, you just need to type its password; If your phone hasn't connected to a 2.4Ghz home wifi or connected to a 5Ghz network, please connect or change to a2.4Ghz network firstly by following the instruction on interface.)

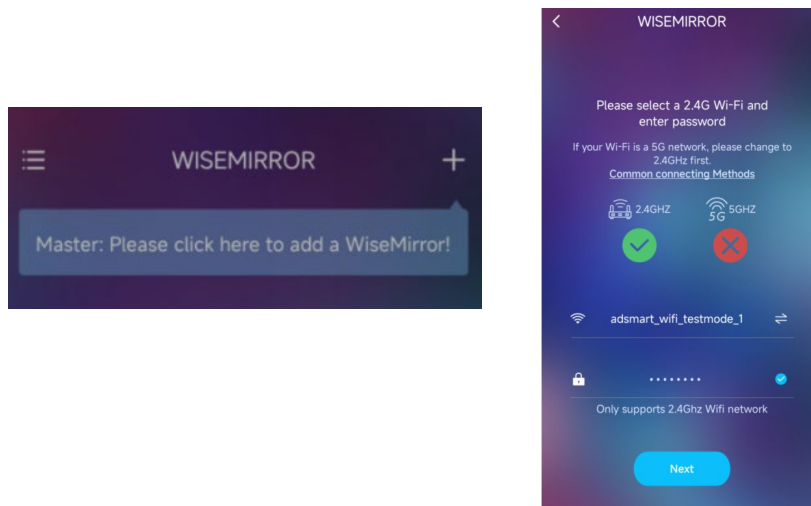

5. Check the status of mirror display to find if it's showing SCAN or AP SCAN as shown below;
Note: Users can click [O,!How to switch device status on App at next interface to find more information](#)).

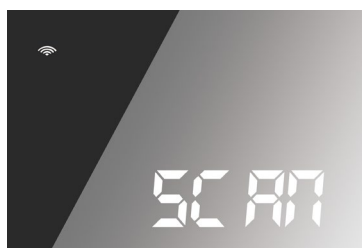

1)SCAN



2) SCAN^{AP}

6. 1) If the mirror display is showing SCAN, Please select SCAN (SCAN displayed and Wi-Fi logo flashing) as showing below to go into EZ MODE for adding device, it will add device automatically in next interface. The mirror screen will display SCAN- JOIN- PAIR in turn during this process, waiting for about 120 seconds to finish.

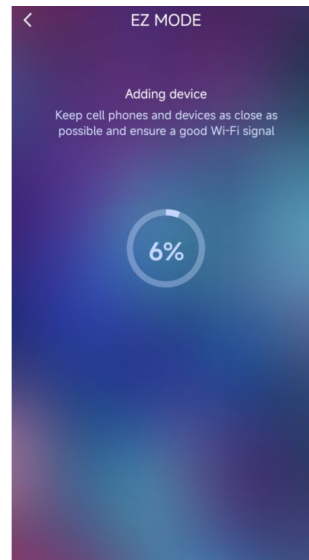
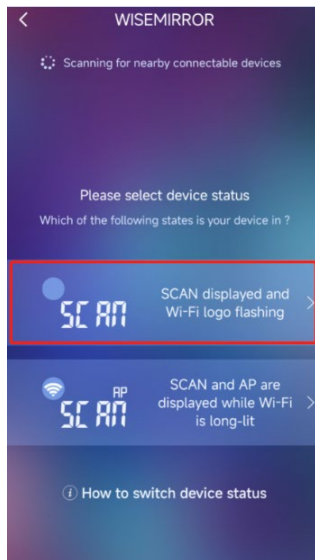

2) If the mirror display is showing AP SCAN, Please select AP SCAN (SCAN and AP are displayed while Wi-Fi is long-lit) as showing below to go into AP MODE. In next interface, please Click To CONNECT to go to Setting, connect your phone to the hotspot that displayed as “WiseMirror-xxxx” in W-LAN list. And enter default password 12345678 to connect, then return to this App and wait for WIFI connection. The mirror screen will display APSCAN-APJOIN- APPAIR in turn during the configuration process.

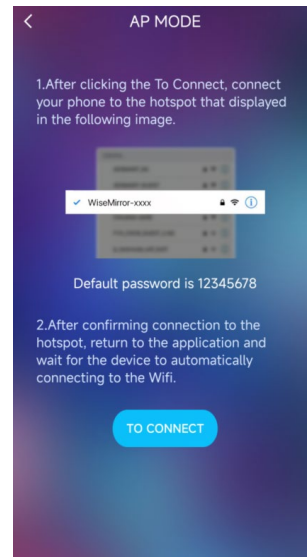
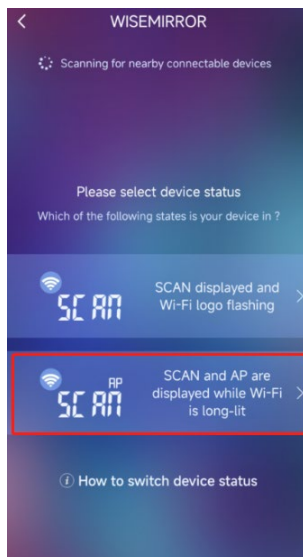

Default password is 12345678

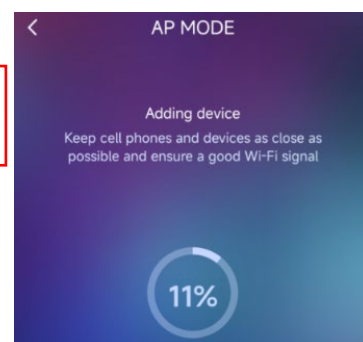

7. After a successful pairing, the following interfaces are displayed in App and Mirror Display Screen, respectively.

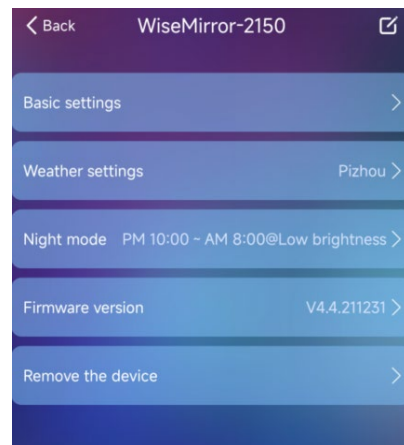
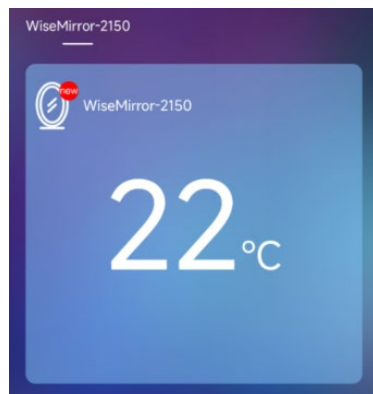

8. For each WIFI clock device, you can make the following settings.

1) Basic settings: You can set 24 hours/12 hours display selection; day and month mode selection; temperature unit selection; digital tube display brightness adjustment on the mirror.

2) Weather settings: Weather for two days--After the weather scroll screen is turned on, the screen will scroll the weather of the day and tomorrow (d2); Regional settings is used to select the area where the weather is to be displayed. The default is automatically set to the local area where the network IP belongs. If the automatic positioning is not successful, you need to manually set the area; Server selection means that if the user finds that the displayed weather is quite different from the actual weather, you can replace another server to get a more accurate weather display.

Note: The weather information source of this APP application is from internet, and it may not be updated in time.

3) Night mode: Refers to setting the digital light screen display timing, the screen system will automatically reduce the brightness during sleep, to achieve the purpose that energy saving or not affect the user's sleep;

4) Firmware version: Refers to the current software version, follow the steps below if necessary;

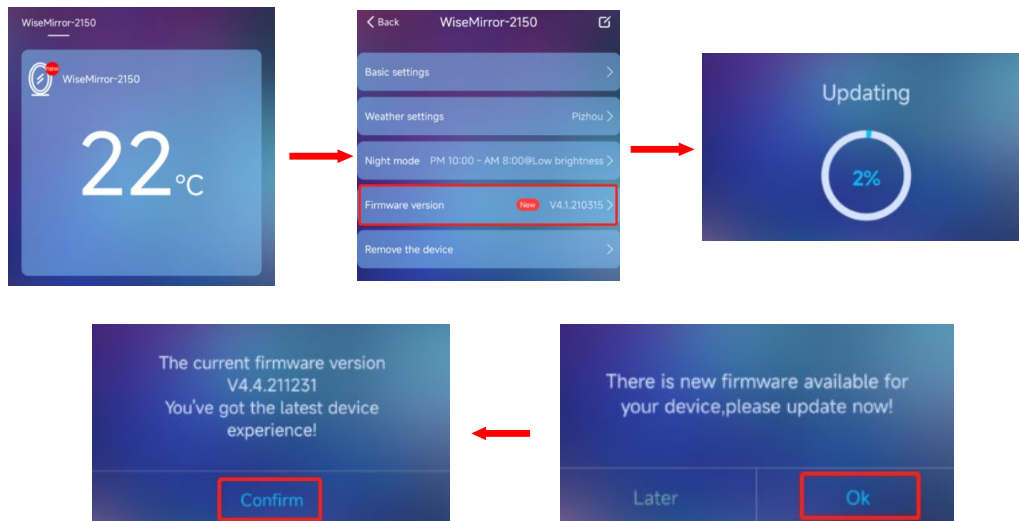

5) Delete the device: Refers to the mobile phone is no longer connected to the device, after deleting, you need to restart the connection.

Important Note: If home wifi changes or password changes, you need to restart the device to reconnect. The specific operation is to unplug and plug the mirror from power source for three times. After three power-offs, the SCAN status will be displayed on mirror display. Users can re-connect the mirror in WiseMirror App again.

The device displays 11 different icons, including sunny, overcast, cloudy, light rain, heavy rain, thunderstorm, shower, light snow, heavy snow, sleet and haze / fog. The icons is shown in the following table:

Weather	Icon	Weather	Icon
Sunny		Shower	
Overcast/Cloudy		Light snow	
Cloudy to clear		Heavy snow	
Light rain		Sleet	
Heavy rain		Foggy	
Thunderstorm		Unknown	

7 | TROUBLESHOOTING

The device has been checked for proper functioning several times during production. If malfunction occur nonetheless, check the device according to the following list.

Problem	Reason	Measure
The touch button does not light	The device does not start	1)Check the power connection 2)Use fingerprints instead of fingertips
The surface bulges slightly	The material expands due to heating	It's a normal process. No measure are required.
Indoor Temperature are displayed inaccurately	The sensor maybe covered	Make sure that the sensor is placed at a right position, should not be covered or touched by other materials.
The device is unable to connect WIFI	Wifi signal is poor or network failures	Restart the router and device.
The real-time weather is displayed inaccurately	weather data is not updated	Connect another sever in your APP.
Display code Err	The device failed to connect to configured network, and the previous data already expired.	Restart your router, make sure that the wifi signal strength as good as enough. Reconnect the mirror with wifi by powering on/off the mirror three times.
Display code 05	The configured router is connected to too many devices	Replace another router or reduce connected devices.
Display code 201	The configured network is unreachable or . WIFI hotspot is replaced	Make sure the device, Wi-Fi router and the smartphone closer together. Refer to Step 8-(7).

Please follow the steps below to diagnose WiFi connection issues:

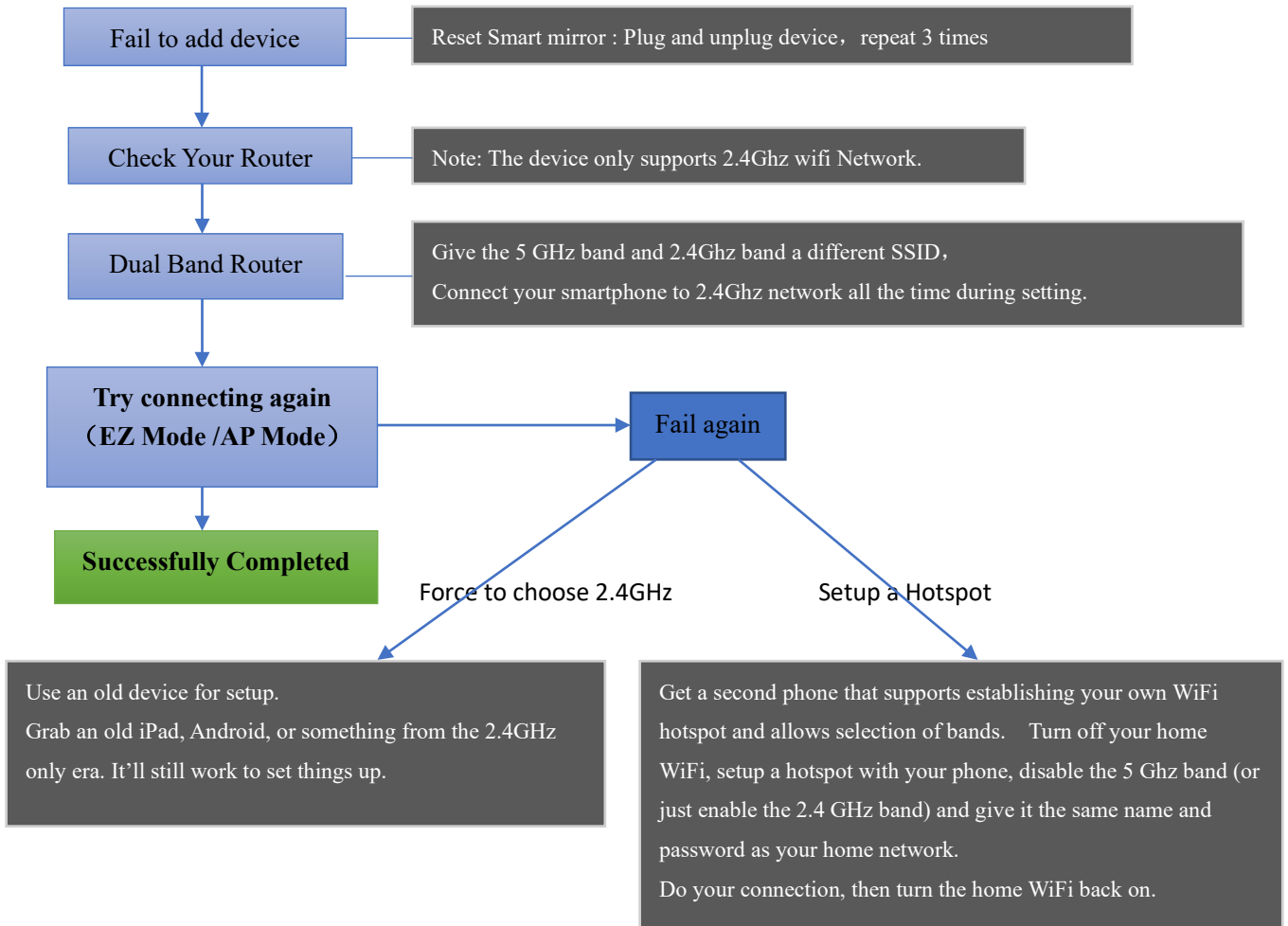

Important Notes:

- In the process of connecting, routers, phones and devices should be as close as possible.
- The device only supports 2.4Ghz wifi network, your smart phone should connect to 2.4Ghz network during setting. Sometimes the 5Ghz network will affect the connection due to frequency interference. So the best way is to separate the SSID during setting.

8 | MAINTENANCE & SERVICING

Activities required before starting maintenance



Warning of electrical voltage

Do not touch the mains plug with wet or damp hands.

- Hold onto the mains plug while pulling the power cable out of the mains socket.

- Allow the device to cool down completely.



Warning of electrical voltage

Tasks which require the housing to be opened must only be carried out by authorized specialist companies.

Cleaning the device



Warning of electrical voltage

Never immerse the device in water!

Clean the device with a soft, damp and lint-free cloth. Ensure that no moisture enters the housing. Protect electrical components from moisture. Do not use any aggressive cleaning agents such as cleaning sprays, solvents, alcohol-based or abrasive cleaners to dampen the cloth.

Wipe the housing dry after cleaning

9 | STORAGE

When the device is not being used, observe the following storage conditions:

- dry and protected from frost and heat
- in an upright position where it is protected from dust and direct sunlight
- with a cover to protect it from invasive dust, if necessary
- Place no further devices or objects on top of the device to prevent it from being damaged.

10 | TECHNICAL ANNEX

Information requirements for electrical local space heaters

Item	Unit
Type of heat input, for electric storage local space heaters only (select one)	
manual heat charge control, with integrated thermostat	N/A
manual heat charge control with room and/or outdoor	N/A
electronic heat charge control with room and/or outdoor	N/A
fan assisted heat output	N/A
Type of heat output/room temperature control (select one)	

single stage heat output and no room temperature control	[no]
Two or more manual stages, no room temperature control	[no]
with mechanic thermostat room temperature control	[no]
with electronic room temperature control	[no]
electronic room temperature control plus day timer	[no]
electronic room temperature control plus week timer	[yes]
Other control options (multiple selections possible)	
room temperature control, with presence detection	[no]
room temperature control, with open window detection	[no]
with distance control option	[no]
with adaptive start control	[yes]
with working time limitation	[no]
with black bulb sensor	[no]

11 | DISPOSAL



The icon with the crossed-out waste bin on waste electrical or electronic equipment stipulates that this equipment must not be disposed of with the household waste at the end of its life. You will find collection points for free return of waste electrical and electronic equipment in your vicinity. The addresses can be obtained from your municipality or local administration.

The separate collection of waste electrical and electronic equipment aims to enable the re-use, recycling and other forms of recovery of waste equipment as well as to prevent negative effects for the environment and human health caused by the disposal of hazardous substances potentially contained in the equipment.