

# Xiaomi Mijia Rotary Tool Kit User Manual

Original instructions



Read this manual carefully before use, and retain it for future reference.

## Safety Instructions

---

- This power tool is suitable for grinding, cleaning, polishing, engraving, drilling, and other tasks. Read all safety warnings, instructions, illustrations, and specifications provided with this tool. Failure to follow these instructions may result in electric shock or serious injury.
- Do not use accessories that are not specifically designed and recommended by the tool manufacturer. Even if accessories can be connected to your power tool, safe operation cannot be guaranteed.
- The rated speed of grinding accessories must at least match the maximum speed marked on the power tool. Operating the accessory above its rated speed may cause it to burst and eject fragments.
- The outer diameter and thickness of accessories must be within the rated capacity of your power tool. Accessories that do not meet specifications cannot be properly controlled.
- The arbor must match the spindle or chuck of the power tool. Mismatched accessories with mounting hardware may cause instability, excessive vibration, and loss of control.
- Do not use damaged accessories. Inspect all accessories before each use, such as checking grinding heads for cracks, fractures, or excessive wear. If the power tool or any accessory is dropped, inspect it for damage or replace it with an undamaged one. After inspecting and installing, keep yourself and others away from the accessory's rotating plane, and then run the power tool at maximum unloaded speed for one minute. During this test, damaged accessories will typically detach from the tool.
- Wear personal protective equipment (PPE). Depending on the application, use a face shield, safety goggles, or safety glasses. When necessary, wear a dust mask, hearing protection, gloves, and a work apron resistant to small abrasive particles and debris. Eye protection must be capable of stopping debris from various operations. Dust masks or respirators should filter particles generated during use. Prolonged exposure to high-intensity noise may cause hearing loss.

- Keep bystanders at a safe distance. Anyone entering the work area must wear personal protective equipment. Debris of the workpiece or damaged accessories may fly off and injure anyone near the operating area.
- Always hold the tool firmly during startup. Reaction torque may cause the tool to twist as the motor accelerates to full speed.
- It is recommended to secure the workpiece with a clamp during use. Once small workpieces are secured with a clamp, the tool may be operated with one or both hands.
- Do not place the power tool until the accessory has completely stopped. Rotating accessories may strike nearby objects, causing loss of control.
- After replacing grinding heads or making any adjustments, ensure the chuck nut or any adjusted part is securely tightened. Loose adjusted components may move unexpectedly, causing loss of control. Additionally, loose rotating accessories may be violently ejected.
- Do not operate the power tool when it is resting at your side. Any accidental contact may cause rotating accessories to catch on clothing and yank them toward you.
- It is recommended to regularly clean the power tool and charging port. Excessive metal dust buildup could cause electrical accidents.
- Do not operate the power tool near flammable materials. Sparks could ignite these materials.
- Do not use accessories that require liquid coolants. Water or other liquid coolants could cause electric shock.

## Product Overview

---

Thank you for using the Mijia Rotary Tool Kit. This tool kit is suitable for grinding, cleaning, polishing, engraving, drilling, and more.

- 1 On/Off Button
- 2 Rubber Sleeve
- 3 Lock Nut
- 4 Chuck Nut
- 5 Chuck
- 6 Speed Control Knob
- 7 Battery Level Indicator
- 8 Charging Port

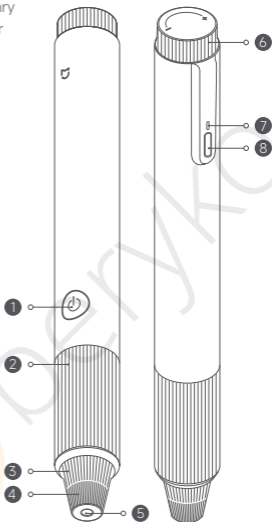

Note: Illustrations of product and accessories in the user manual are for reference purposes only. Actual product and functions may vary due to product enhancements.

## Accessory Instructions

Wool Brush × 1

---



Suitable for cleaning, deburring, surface pretreatment, and polishing on metal, wood, and plastic.

Twist Drill Bit × 1

---



Suitable for drilling in soft materials such as wood and plastic.

Emery Grinding Head × 6

---



Suitable for fine carving and grinding on hard materials.

Grinding Wheel Head × 4

---



Suitable for rough grinding and semi-finishing grinding of both metal and non-metal materials.

## Rubber Grinding Head × 2

---



Suitable for fine polishing, rust removal, and grinding on materials such as metal, plastic, and glass.

## Wool Grinding Head × 2

---



Suitable for mirror polishing and grinding of materials such as metal, glass, wood, and jade.

## How to Use

---

### Charging and battery display

#### Charging

Before initial use, fully charge the tool .  
Use a power adapter with a rated output of 5 V  $\overline{\text{---}}$  3 A (sold separately) and the included charging cable.

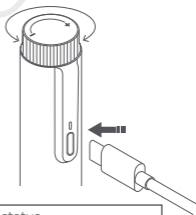

#### Battery level indicator descriptions

Rotary tool status	Battery level indicator status
Charging	Breathing white
Low battery level	Breathing red
Fully charged	Keeping white for 20 seconds then going off
During use	Off

**CAUTION:** This tool supports plug-in operation. During plugged-in operation, the battery level indicator stays on. After being turned off, the tool automatically enters charging mode.

## Installing accessories

1. Hold the lock nut with one hand, and loosen the chuck nut by turning it in the direction of arrow A with the other.
2. Insert the accessory shank through the chuck nut into the chuck, ensuring it reaches the bottom.
3. Hold the lock nut, then tighten the chuck nut in the direction of arrow B to complete the installation.

Note: Ensure the accessory shank is fully inserted to the bottom of the chuck before installing.

WARNING: Do not start the tool before tightening the chuck nut. Ensure that both the chuck nut and lock nut are securely fastened before operation.

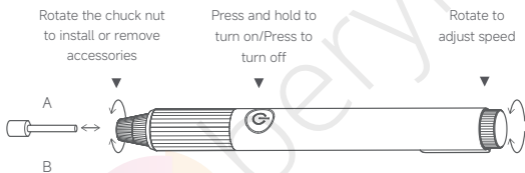

## Instructions

Turning on/off: Press and hold to turn on, and press to turn off.

Speed adjustment: While in use, rotate the speed control knob on top of the tool. At maximum or minimum speed, the battery level indicator blinks white three times and further rotation will not change speed.

## CAUTIONS:

1. Before using, verify the chuck nut and lock nut are securely tightened. Periodically check for chuck nut loosening during extended operation.
2. If working on valuables, consult a professional or operate under their supervision to prevent irreversible damage.
3. The grinding head is a consumable item, and it is normal for it to wear out.

## General Power Tool Safety Warnings

---

**Warning!** Read all safety warnings, instructions, illustrations and specifications provided with this power tool. Failure to follow all instructions listed below may result in electric shock, fire or serious injury.

Save all warnings and instructions for future reference.

The term "power tool" in the warnings refers to your mains-operated (corded) power tool or battery-operated (cordless) power tool.

### Work area safety

- **Keep work area clean and well lit.** Cluttered or dark areas invite accidents.
- **Do not operate power tools in explosive atmospheres, such as in the presence of flammable liquids, gases or dust.** Power tools create sparks which may ignite the dust or fumes.
- **Keep children and bystanders away while operating a power tool.** Distractions can cause you to lose control.

### Electrical safety

- **Power tool plugs must match the outlet. Never modify the plug in any way. Do not use any adapter plugs with earthed (grounded) power tools.** Unmodified plugs and matching outlets will reduce risk of electric shock.
- **Avoid body contact with earthed or grounded surfaces, such as pipes, radiators, ranges and refrigerators.** There is an increased risk of electric shock if your body is earthed or grounded.
- **Do not expose power tools to rain or wet conditions.** Water entering a power tool will increase the risk of electric shock.
- **Do not abuse the cord. Never use the cord for carrying, pulling or unplugging the power tool. Keep cord away from heat, oil, sharp edges or moving parts.** Damaged or entangled cords increase the risk of electric shock.
- **When operating a power tool outdoors, use an extension cord suitable for outdoor use.** Use of a cord suitable for outdoor use reduces the risk of electric shock.
- **If operating a power tool in a damp location is unavoidable, use a residual current device (RCD) protected supply.** Use of an RCD reduces the risk of electric shock.

## Personal safety

- **Stay alert, watch what you are doing and use common sense when operating a power tool. Do not use a power tool while you are tired or under the influence of drugs, alcohol or medication.** A moment of inattention while operating power tools may result in serious personal injury.
- **Use personal protective equipment. Always wear eye protection.** Protective equipment such as a dust mask, non-skid safety shoes, hard hat or hearing protection used for appropriate conditions will reduce personal injuries.
- **Prevent unintentional starting. Ensure the switch is in the off-position before connecting to power source and/or battery pack, picking up or carrying the tool.** Carrying power tools with your finger on the switch or energising power tools that have the switch on invites accidents.
- **Remove any adjusting key or wrench before turning the power tool on.** A wrench or a key left attached to a rotating part of the power tool may result in personal injury.
- **Do not overreach. Keep proper footing and balance at all times.** This enables better control of the power tool in unexpected situations.
- **Dress properly. Do not wear loose clothing or jewellery. Keep your hair and clothing away from moving parts.** Loose clothes, jewellery or long hair can be caught in moving parts.
- **If devices are provided for the connection of dust extraction and collection facilities, ensure these are connected and properly used.** Use of dust collection can reduce dust-related hazards.
- **Do not let familiarity gained from frequent use of tools allow you to become complacent and ignore tool safety principles.** A careless action can cause severe injury within a fraction of a second.

### Power tool use and care

- **Do not force the power tool. Use the correct power tool for your application.** The correct power tool will do the job better and safer at the rate for which it was designed.
- **Do not use the power tool if the switch does not turn it on and off.** Any power tool that cannot be controlled with the switch is dangerous and must be repaired.
- **Disconnect the plug from the power source and/or remove the battery pack, if detachable, from the power tool before making any adjustments, changing accessories, or storing power tools.** Such preventive safety measures reduce the risk of starting the power tool accidentally.
- **Store idle power tools out of the reach of children and do not allow persons unfamiliar with the power tool or these instructions to operate the power tool.** Power tools are dangerous in the hands of untrained users.
- **Maintain power tools and accessories.** Check for misalignment or binding of moving parts, breakage of parts and any other condition that may affect the power tool's operation. If damaged, have the power tool repaired before use. Many accidents are caused by poorly maintained power tools.
- **Keep cutting tools sharp and clean.** Properly maintained cutting tools with sharp cutting edges are less likely to bind and are easier to control.
- **Use the power tool, accessories and tool bits etc. in accordance with these instructions, taking into account the working conditions and the work to be performed.** Use of the power tool for operations different from those intended could result in a hazardous situation.
- **Keep handles and grasping surfaces dry, clean and free from oil and grease.** Slippery handles and grasping surfaces do not allow for safe handling and control of the tool in unexpected situations.

### Battery tool use and care

- **Recharge only with the charger specified by the manufacturer.** A charger that is suitable for one type of battery pack may create a risk of fire when used with another battery pack.
- **Use power tools only with specifically designated battery packs.** Use of any other battery packs may create a risk of injury and fire.
- **When battery pack is not in use, keep it away from other metal objects, like paper clips, coins, keys, nails, screws or other small metal objects, that can make a connection from one terminal to another.** Shorting the battery terminals together may cause burns or a fire.
- **Under abusive conditions, liquid may be ejected from the battery; avoid contact. If contact accidentally occurs, flush with water. If liquid contacts eyes, additionally seek medical help.** Liquid ejected from the battery may cause irritation or burns.
- **Do not use a battery pack or tool that is damaged or modified.** Damaged or modified batteries may exhibit unpredictable behavior resulting in fire, explosion or risk of injury.
- **Do not expose a battery pack or tool to fire or excessive temperature.** Exposure to fire or temperature above 130°C may cause explosion.
- **Follow all charging instructions and do not charge the battery pack or tool outside the temperature range specified in the instructions.** Charging improperly or at temperatures outside the specified range may damage the battery and increase the risk of fire.

### Service

- **Have your power tool serviced by a qualified repair person using only identical replacement parts.** This will ensure that the safety of the power tool is maintained.
- **Never service damaged battery packs.** Service of battery packs should only be performed by the manufacturer or authorized service providers.

## Rotary tool safety warnings

- When operating in areas where fasteners may contact hidden wiring, always hold the tool by its insulated gripping surfaces. Contact with live wires may energize exposed metal parts of the tool, posing an electric shock hazard to the operator.

### Safety warnings for tools with in-built batteries

- Do not disassemble, open, or cut up the tool.
- Do not expose the tool to heat or flames. Avoid storing it in direct sunlight.
- Do not short-circuit exposed terminals. Do not put multiple tools together in a box or drawer to avoid short circuits between them or with other metal objects.
- Do not subject the tool to mechanical shock.
- In case of battery leakage, avoid direct contact of the leaked liquid with skin or eyes. In case of contact, rinse with plenty of water and seek medical attention promptly. Do not use chargers that are not specifically designed for the tool kit.
- Keep tools away from children.
- Do not use batteries not dedicated for the tool kit.
- Keep the tool clean and dry.
- If the charging contacts of the tool are dirty, wipe them with a clean, dry cloth.
- Charge the tool before using. Use the correct charger in accordance with the manufacturer's instructions or the product's user manual.
- Do not leave the tool on charge for a long period of time when it is not in use.
- After prolonged storage, perform several charge-discharge cycles to restore the tool's optimal performance.
- The lithium-ion battery is at its best performance when used at room temperature ( $20^{\circ}\text{C} \pm 5^{\circ}\text{C}$ ).
- Keep the product's original user manual for future reference.
- Dispose of the battery correctly.

## Troubleshooting

---

Errors	Possible causes	Solutions
Unable to turn on	Battery depleted.	Charge the tool kit.
Tool kit stops rotating during operation	Continuous high-load operation triggers overheat protection or under-voltage protection.	Allow the tool kit to cool down or charge it.
Unable to install accessories	Accessory size incompatible with the size of the chuck.	Use accessories from the accessory kit or accessories with 2.35 mm diameter.
Unable to charge	Charging cable not securely connected.	Replug the charging cable.

## Specifications

---

Name: Mijia Rotary Tool Kit

Model: MJDMB001QW

Item Dimensions:

Approx. 210 × 88 × 28 mm

Net Weight: Approx. 310 g

Unloaded Rotational Speed:  
15000–22000 /min

Operating Temperature: 0°C to 40°C

Charging Temperature: 5°C to 40°C

Storage Temperature: -10°C to 45°C

Battery Type: Lithium-ion battery

Declaration of the noise emission values according to EN 60745  
(considered uncertainty 3 dB(A)):

Sound Pressure Level: 40.1 dB(A)

Sound Power Level: 51.1 dB(A)

Declaration of the vibration emission according to EN 60745  
(considered uncertainty 1.5 m/s<sup>2</sup>): 2.5 m/s<sup>2</sup>

Rated Capacity: 800 mAh

Rated Voltage: 3.7 V $\overline{\text{---}}$

Operating Input (Plugged-in): 5 V $\overline{\text{---}}$  3 A

Charging Input: 5 V $\overline{\text{---}}$  1 A

Charging Port: Type-C

Charging Time: Approx. 90 minutes

Chuck Size:  $\Phi$ 2.35 mm

## Notes:

- The declared vibration total value and the declared noise emission value have been measured in accordance with a standard test method and may be used for comparing one tool with another;
- The declared vibration total value and the declared noise emission value may also be used in a preliminary assessment of exposure.

## Warnings:

- The vibration and noise emissions during actual use of the power tool can differ from the declared values depending on the ways in which the tool is used especially what kind of workpiece is processed;
- It is necessary to identify safety measures to protect the operator that are based on an estimation of exposure in the actual conditions of use (taking account of all parts of the operating cycle such as the times when the tool is switched off and when it is running idle in addition to the trigger time).

The battery is undetachable.

## Regulatory Compliance Information

---

### Europe — EU declaration of conformity



We, Xiaomi Communications Co., Ltd., hereby, declare that this equipment is in compliance with the applicable Directives and European Norms, and amendments. The full text of the EU

declaration of conformity is available at the following internet address: <https://www.mi.com/global/support/terms/declaration>

### Disposal and recycling information



All products bearing this symbol are waste electrical and electronic equipment (WEEE as in directive 2012/19/EU) which should not be mixed with unsorted household waste.

Instead, you should protect human health and the environment by handing over your waste equipment to a designated collection point for the recycling of waste electrical and electronic equipment, appointed by the government or local authorities. Correct disposal and recycling will help prevent potential negative consequences to the environment and human health. Please contact the installer or local authorities for more information about the location as well as terms and conditions of such collection points.



Before commissioning the device, read the operating manual and observe the safety instructions!



Wear ear-muffs!

### Note for packaging



The packaging materials are recyclable. Please dispose of packaging in an environmentally friendly manner.



Manufacturer: Xiaomi Communications Co., Ltd.  
Address: #019, 9th Floor, Building 6, 33 Xi'erqi Middle Road, Haidian  
District, Beijing, 100085, China

For further information, please go to [www.mi.com](http://www.mi.com)  
User Manual Version: V1.0

Importer:

Beryko s.r.o.

Pod Vinicemi 931/2, 301 00 Plzeň

[www.beryko.cz](http://www.beryko.cz)

EU REP.

Xiaomi Technology Netherlands B.V.

E5, WTC The Hague, Prinses Beatrixlaan 582, 2595 BM, The Hague,

The Netherlands

[contact@support.mi.com](mailto:contact@support.mi.com)



PAP