

Power Plug H2 EU Power Plug H2 EU (RGB)



Product Introduction

The Aqara Power Plug H2 EU is a smart plug based on the Thread/Zigbee wireless communication protocol. It features power monitoring and LED indicator light configuration. With built-in scheduling, power-off memory, child lock, overload and overheat protection, it enables intelligent energy management and seamless integration into smart home ecosystems when paired with a compatible hub.

*To use the device with a particular Matter ecosystem, a Matter Controller of said ecosystem and a Thread Border Router are required. In most cases, a Thread Border Router is integrated in your Matter Controller, combining both functions in one device.



Warnings

1. This product is not a toy. Please keep children away from this product.
2. This product is designed for indoor use only.
3. Do not use in humid environments or outdoors.
4. Beware of moisture. Do not spill water or other liquids onto the product.
5. Do not place this product near a heat source. Do not place it in an enclosed space unless there is normal ventilation. Do not attempt to repair this product by yourself. All repairs should be performed by an authorized professional.
6. This product is designed to enhance your home experience and keep you informed about device status. If a user violates the product use instructions, the manufacturer will not be liable for any damage and/or property losses.

Installation Method

1. Please Insert the Power Plug H2 EU into the wall outlet.

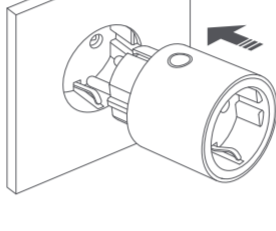

2. Once the switch is powered on, the blue indicator light will flash rapidly (Matter Protocol), signaling that the device has entered the network configuration mode.

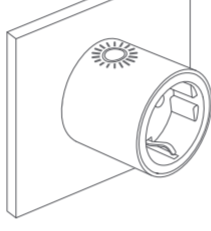

3. Please scan the QR code on the electronic instruction manual and follow the prompts to install the switch correctly.

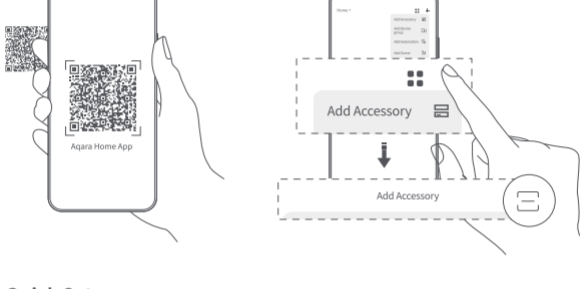

Quick Setup

To use the device with a particular Matter ecosystem (Thread Mode), a Matter Controller of said ecosystem and a Thread Border Router are required.

1. Double-press any button, then press and hold it for 5 seconds until the blue indicator light starts blinking. This indicates that the device is in pairing mode.

*When powered on for the first time, the device will automatically enter pairing mode.

2. Open the app that supports Matter, scan the Matter code on the manual or product, or enter the setup code to add the device to the app.
3. Proceed following the app's instruction.

To use the device in Aqara Home (Thread Mode), an Aqara Hub with border router function (for example, Hub M3) is required:

1. Double-press any button, then press and hold it for 5 seconds until the blue indicator light starts blinking. This indicates that the device is in pairing mode.

*When powered on for the first time, the device will automatically enter pairing mode.

2. In the Aqara Home app, tap Add Accessory, choose Power Plug H2 EU or Power Plug H2 EU (RGB). Scan the Matter code on the manual or product or enter the setup code to add the device to the app. Select Thread under Switch Protocol page.
3. Proceed following the app's instruction.

To use the device in Aqara Home (Zigbee Mode), an Aqara Zigbee Hub is required:

1. Double-press any button, then press and hold it for 5 seconds until the purple indicator light starts blinking. This indicates that the device is in pairing mode.

*When powered on for the first time, the device will automatically enter pairing mode.

2. In the Aqara Home app, tap Add Accessory, keep the phone close to the device, and Power Plug H2 EU or Power Plug H2 EU (RGB) will show in the app's discovery section (at the top left). Tap the icon and select Zigbee under Switch Protocol page.
3. Proceed following the app's instruction.

Button Operations

Button	Operation	Function
ON/OFF button	Press 3 times	Locate device
	Double-press, then press and hold for 5 s (within 3 s)	Reset device and enable pairing
	Press 10 times in a row	Restore factory settings and enable pairing
	Single press	Relay on and off control

Indicator Light Description

Indicator light status	Description
Blue indicator light flashes 1 time	Device powered on
Blue indicator light flashes quickly	Pairing in progress/ finding device (Thread protocol)
Blue indicator light stays on for 1s	Pairing successful
The blue indicator light stays on	Load Power-On
Red indicator light stays on	Pairing timeout/Overheat or Overload Protection
Red indicator light flashes slowly 3 times	Pairing failed
Purple indicator light flashes slowly 3 times	Child lock mode
Purple indicator light flashes quickly	Pairing in progress/ finding device (Zigbee protocol)

Product Specifications

Product Name	Power Plug H2 EU	Power Plug H2 EU (RGB)
Model	SP-P05E	SP-P05D
Indicator Light	Blue & Red & Purple	RGB
Wireless Protocols	Thread, Bluetooth, Zigbee	
Dimensions	Ø52 × 83 mm	
Electrical Rating	100-240 VAC, 50/60 Hz, Max 16 A, Max 3680W, μ	
Thread Operation Frequency	2405 – 2480 MHz	
Thread Maximum Output Power	≤ 13 dBm	
Zigbee Operation Frequency	2405 – 2480 MHz	
Zigbee Maximum Output Power	≤ 13 dBm	
Bluetooth Operation Frequency	2402 - 2480 MHz	
Bluetooth Maximum Output Power	≤ 13 dBm	
Operating Temperature	-10°C ~ 40°C	
Operating Humidity	0 ~ 95% RH, no condensation	

Technical Specifications

Switch information	Means of information:
Characteristic	<input checked="" type="checkbox"/> C.T. <input type="checkbox"/> U.T.
SWITCH IDENTIFICATION	
Manufacturer's name or trademark.	Aqara
Type reference.	SP-P05E, SP-P05D
SWITCH ENVIRONMENT/MOUNTING	
Degree of protection provided for the switch when mounted according to documentation.	Code of IEC 60529 IP20
Degree of protection against electric shock, from outside an appliance.	Class I
Method of mounting and actuating the switch.	Plug-in type; push-button actuating
Method of providing earthing if appropriate.	NA
Method(s) of mounting and orientation(s) declared.	P Refer to the manual
Pollution degree micro.	2
Pollution degree macro.	NA
TEMPERATURE	
Ambient temperature limits if ≠ 0 – 55°C.	40°C
ELECTRICAL LOAD / CONNECTION	
Rated voltage or voltage range.	100-240VAC
Nature of supply.	<input checked="" type="checkbox"/> AC <input type="checkbox"/> AC and DC <input type="checkbox"/> Different AC and DC rating.
Frequency or frequency range.	50/60 Hz
The rated current and the electrical load type.	See "Electrical Rating".
For switches for more than one circuit, the current applicable to each circuit and to each terminal.	See "Electrical Rating".
Rated impulse withstand voltage.	2500V
Overvoltage category.	OVCII
Duty-type and relevant (ON/OFF-time)	S1
Type and/or connection of switch.	Single pole, single load
Configuration of switching device:	Relay
OPERATING CYCLES / SEQUENCE	
Number of operating cycles.	1E4 (not required to mark)
CIRCUIT DISCONNECTION	
<input type="checkbox"/> Electronic <input checked="" type="checkbox"/> Micro	μ
<input type="checkbox"/> Combination <input type="checkbox"/> Full	
INSULATING MATERIALS	
Tracking <input checked="" type="checkbox"/> PTI or <input type="checkbox"/> CTI (V) :	PTI175
Glow-wire temperatures (°C) :	GWT: 650C&850
Type of coating for rigid printed board assemblies :	
COOLING CONDITION	
<input checked="" type="checkbox"/> Not requiring forced cooling :	Not requiring forced cooling
<input type="checkbox"/> Requiring cooling :	
<input type="checkbox"/> Direction of air for forced cooling :	
<input type="checkbox"/> Speed of air for forced cooling :	
<input type="checkbox"/> Thermal resistance of heat sink :	
<input type="checkbox"/> Incoming temperature, density and other details of the air stream :	