

PHILIPS

MG7720



© 2017 Koninklijke Philips N.V.
All rights reserved
保留所有权利
4222.002.8810.1 (26/6/2017)
> 75% 循环再造纸



>75% recycled paper
>75% papier recyclé

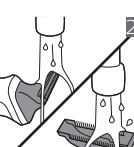
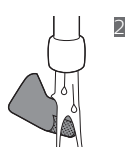
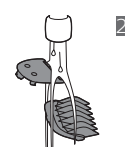
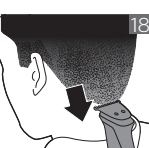
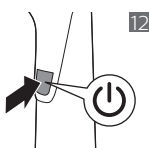
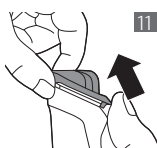
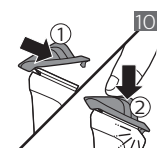
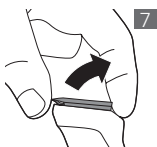
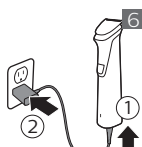
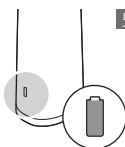
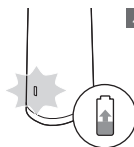

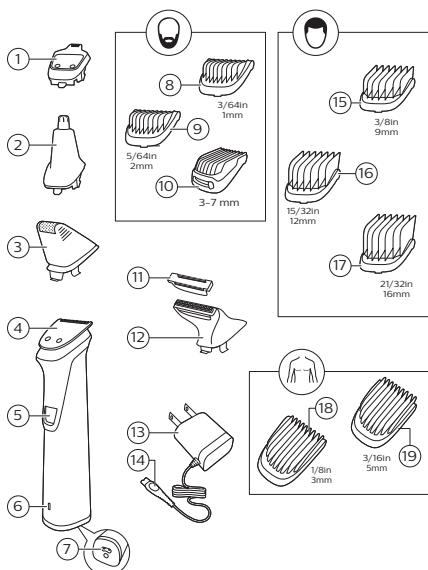

English

Introduction

Congratulations on your purchase and welcome to Philips! To fully benefit from the support that Philips offers, register your product at www.philips.com/welcome.

General description (Fig. 1)

- 1 Precision trimmer
 - 2 Nose trimmer
 - 3 Precision shaver
 - 4 Full-size hair trimmer
 - 5 On/off button
 - 6 Battery status indicator
 - 7 Socket for small plug
 - 8 Stubble comb 3/64in. (1mm)
 - 9 Stubble comb 5/64in. (2mm)
 - 10 Adjustable comb 1/8in. – 9/32 in. (3–7mm)
 - 11 Skin protector
 - 12 Body shaver
 - 13 Supply unit
 - 14 Small plug
 - 15 Hair comb 3/8in. (9mm)
 - 16 Hair comb 15/32in. (12mm)
 - 17 Hair comb 21/32in. (16mm)
 - 18 Body comb 1/8in. (3mm)
 - 19 Body comb 3/16in. (5mm)
- Not shown: cleaning brush, pouch

Important safety information

Read this important information carefully before you use the appliance and its accessories and save it for future reference. The accessories supplied may vary for different products.

Danger

- Keep the supply unit dry (Fig. 2).

Warning

- To charge the battery, only use the detachable supply unit (HQ8505) provided with the appliance.
- The supply unit contains a transformer. Do not cut off the supply unit to replace it with another plug, as this causes a hazardous situation.
- This appliance can be used by children aged from 8 years and above and persons with reduced physical, sensory or mental capabilities or lack of experience and knowledge if they have been given supervision or instruction concerning use of the appliance in a safe way and understand the hazards involved. Children shall not play with the appliance. Cleaning and user maintenance shall not be made by children without supervision.
- Always unplug the appliance before you clean it under the tap.
- Always check the appliance before you use it. Do not use the appliance if it is damaged, as this may cause injury. Always replace a damaged part with one of the original type.
- Do not open the appliance to replace the rechargeable battery.

Caution

- Never immerse the charging stand in water and do not rinse it under the tap (Fig. 2).
- Do not use the supply unit in or near wall sockets that contain an electric air freshener to prevent irreparable damage to the supply unit.
- Only use this appliance for its intended purpose as shown in the user manual.
- For hygienic reasons, the appliance should only be used by one person.
- Never use water hotter than 60°C to rinse the appliance.
- Never use compressed air, scouring pads, abrasive cleaning agents or aggressive liquids such as petrol or acetone to clean the appliance.

Electromagnetic fields (EMF)

- This Philips appliance complies with all applicable standards and regulations regarding exposure to electromagnetic fields.

General

- This appliance is waterproof (Fig. 3). It is suitable for use in the bath or shower and for cleaning under the tap. For safety reasons, the appliance can therefore only be used without cord.
- The supply unit is suitable for mains voltages ranging from 100 to 240 volts.
- The supply unit transforms 100–240 volts to a safe low voltage of less than 24 volts.

Charging

Battery status indications

- When the battery is almost empty, the battery status indicator flashes orange.
- When the appliance is charging, the battery status indicator flashes white slowly (Fig. 4).
- During quick charge, the battery status indicator flashes white quickly. After approx. 5 minutes of charging, the battery indicator flashes white slowly. The appliance now contains enough power for one cordless trimming session.
- When the battery is fully charged, the battery status indicator lights up white continuously (Fig. 5).

Note: After approx. 30 minutes, the light goes out automatically.

Charging

Charge the appliance before you use it for the first time and when the display indicates that the battery is almost empty. When the appliance has charged for 1 hours, it has a cordless operating time of up to 2 hours.

- 1 Make sure the appliance is switched off.
- 2 Insert the small plug into the appliance and put the supply unit in the wall socket (Fig. 6).
- 3 After charging, remove the supply unit from the wall outlet and pull the small plug out of the appliance.

Quick charge

After approx. 5 minutes charging, the appliance contains enough power for one cordless trimming session.

Using the appliance

Note: This appliance can only be used without cord.

Note: Switch off and clean the appliance after each use.

Detaching and attaching cutting elements

- 1 To detach a cutting element, push upwards against the teeth of the cutting element and take it off the handle (Fig. 7).
- 2 To attach a cutting element, insert the lug of the cutting element into the guiding slot at the front and push the back of the cutting element onto the appliance ('click') (Fig. 8).

Detaching the precision shaver and nose trimmer

- 1 Place your finger on the arrow at the back of the attachment and push it off the handle in the direction of the arrow (Fig. 9).

Attaching and detaching combs

- 1 To attach any type of guard onto a cutting element, slide the front part of the guard onto the teeth of the cutting element. Then push down the center of the guard with your fingers or the palm of your hand ('click') (Fig. 10).
- 2 To detach any type of comb from the cutting element, carefully pull its back part off the appliance and then slide it off the cutting element (Fig. 11).

Note: When trimming for the first time, start by using the comb with the maximum trimming length setting to familiarize yourself with the appliance.

Turning the appliance on and off

Press the on/off button once to turn the appliance on or off (Fig. 12).

Attachments for use on beard

Full-size hair trimmer

Use the full-size hair trimmer without a comb to trim hair close to the skin (to a length of 1/32in (0.5mm) or to create clean lines around your beard, neck and sideburns.

- 1 To trim hair close to the skin, place the flat side of the cutting element against your skin and make strokes against the direction of hair growth (Fig. 13).
- 2 For contouring, hold the cutting element perpendicular to the skin and move it upwards or downwards with gentle pressure (Fig. 14).

Beard combs

Attach a beard comb to the full-size hair trimmer to trim your beard and moustache evenly. The appliance comes with 3 beard combs. The hair length settings are indicated on the combs. The settings correspond to the remaining hair length after trimming.

Comb	inch	mm
Stubble comb	3/64in.	1mm
Stubble comb	5/64in.	2mm
Adjustable comb	1/8in.– 9/32in.	3mm–7mm

- 1 Attach the comb to the full-size hair trimmer.
- 2 Adjustable comb: Push the length selector to the left or right to select the desired hair length setting.
- 3 To trim the most effective way, move the comb against the direction of hair growth (Fig. 15). Make sure the surface of the comb always stays in contact with the skin.

Attachments for use on body

- Use the green body combs to trim body hair.

- When you trim for the first time, use the 5mm/3/16in. body comb to familiarize yourself with the appliance.
- Make sure hair is clean and dry as wet hair tends to stick to the body and, when trimming sensitive areas, always use a body comb.
- Since all hairs do not grow in the same direction, you may want to try different trimming positions (i.e. upwards, downwards, or across). Practice is best for optimum results.
- Always make smooth and gentle movements and be sure the surface of the comb always stays in contact with your skin.
- When too many hairs have accumulated on the appliance, blow the hairs out before use, for best trimming results.

Body combs

Attach a body comb to the full-size hair trimmer to trim hairs below the neckline. The appliance comes with 2 body combs. The hair length settings are indicated on the combs. The settings correspond to the remaining hair length after trimming.

Comb	inch	mm
Body comb (green)	1/8in.	3mm
Body comb (green)	3/16in.	5mm

- 1 Attach a body comb to the full-size hair trimmer.
- 2 To trim in the most effective way, stretch the skin with your free hand and move the comb against the direction of hair growth (Fig. 17). Make sure the surface of the comb always stays in contact with the skin.

Body shaver

Attach the body shaver to the appliance, to shave hairs below the neckline such as your armpits and chest. Only use the body shaver with the skin protector. Do not use the body shaver with water or shaving foam.

- 1 Attach the body shaver to the appliance.
- 2 Attach the skin protector to the full-size hair trimmer (Fig. 16).
- 3 To shave in the most effective way, stretch the skin with your free hand and move the shaver against the direction of hair growth (Fig. 17). Make sure the surface of the shaver always stays in full contact with the skin.

Attachments for use on head

Full-size hair trimmer

Use the full-size hair trimmer without a comb to clip the hair on your head very close to the skin (1/32in (0.5mm) or to contour the neckline and area around the ears.

- 1 To contour the hairline around the ears, comb the hair ends over the ears.
- 2 Tilt the appliance in such a way that only one edge of the cutter blades touches the hair ends when you shape the contours around the ears.
- 3 To contour the nape of the neck or sideburns, turn the appliance and make downward strokes (Fig. 18).
- 4 Move the appliance slowly and smoothly following the natural hairline.

Hair combs

Attach a hair comb to the full-size hair trimmer to evenly trim the hairs on your head. The appliance comes with 3 hair combs. The hair length settings are indicated on the combs. The settings correspond to the remaining hair length after trimming.

Comb	inch	mm
Hair comb	3/8in.	9mm
Hair comb	15/32in.	12mm
Hair comb	21/32in.	16mm

- 1 Attach a comb to the full-size hair trimmer.
- 2 Move the trimmer slowly over the crown from different directions to achieve an even result. Make sure the surface of the comb always stays in contact with the skin.
 - Always move the trimmer against the direction of hair growth (Fig. 19). Press lightly.
 - Make overlapping passes over the head to ensure that all hair that should be cut has been cut.

Precision attachments for use on face

Precision trimmer

Use the precision trimmer to create fine lines and contours around your facial style, close to the skin (to a length of 1/32in./0.5mm).

- 1 Hold the precision trimming head perpendicular to the skin and move the trimming head upwards or downwards with gentle pressure (Fig. 20).

Nose trimmer

Use the nose trimmer to trim your nose hair and ear hair.

- Make sure nasal passages are clean. Make sure outer ear channels are clean and free from wax.
- Do not insert the tip more than 3/16in./5mm.
- Always clean the attachment after each use.

Trimming nose hair

- 1 Gently move the tip in and out of nose while turning it around to remove unwanted hairs (Fig. 21).

Trimming ear hair

- 1 Slowly move the tip round the ear to remove hairs that stick out beyond the rim of the ear.
- 2 Gently move the tip in and out of the outer ear channel to remove unwanted hairs (Fig. 21).

Precision shaver

Use the precision shaver after trimming, to shave unwanted hairs on cheeks, chin and along the beard with precision. Make sure to pre-trim your beard first, with the full-size hair trimmer without comb, to obtain the best result.

Note: Use the precision shaver to remove remaining hairs and detailing your beard style. It is not suitable for a full face shave.

- 1 Gently press the precision shaver onto the skin and shave along contoured edges to remove any unwanted hairs (Fig. 22).

Cleaning

Never use scouring pads, abrasive cleaning agents or aggressive liquids such as gasoline or acetone to clean the product.

Never dry the trimmer teeth with a towel or tissue, as this may damage the trimmer teeth.

After every use: cleaning under the tap

- 1 Turn off the appliance and disconnect from the power outlet.
- 2 Remove any comb or cutting element from the appliance.
- 3 Rinse the hair chamber under a warm tap.
- 4 Clean the cutting element and comb under a warm tap (Fig. 23).
- 5 Carefully shake off excess water and let all parts air dry completely.

Thorough cleaning

- 1 Turn off the appliance and disconnect from the power outlet.
- 2 Wipe the handle of the appliance with a dry cloth.
- 3 Remove any comb or cutting element from the appliance.
- 4 Remove any hairs that have accumulated in the hair chamber with the cleaning brush supplied.
- 5 Remove any hairs that have accumulated in the cutting elements and/or combs with the cleaning brush supplied.
- 6 Clean the cutting elements under a warm tap.
- 7 Clean the combs under a warm tap.
- 8 Carefully shake off excess water and let all parts air dry completely.

Cleaning the nose trimmer

Clean the nose trimmer immediately after use and when a lot of hair or dirt has accumulated on the nose trimmer head.

- 1 Rinse the nose trimmer head with hot water (Fig. 24).
- 2 Turn on the appliance and rinse the nose trimmer head once more to remove any remaining hairs. Then turn off the appliance again.

For a thorough clean, immerse the nose trimmer head in a bowl with warm water for a few minutes and then turn on the appliance to remove stubborn hair/debris.

- 3 Carefully shake off excess water and let all parts air dry completely.

Cleaning the precision shaver

- 1 Hold the precision shaver at the grooves on each side and pull the top part off the bottom part (Fig. 25).
- 2 Blow and/or shake out any hair that has accumulated inside the precision shaver.
- 3 Clean the top part of the precision shaver under a warm tap (Fig. 26).
- 4 Carefully shake off excess water and let all parts air dry completely.
- 5 Reattach the top part onto the bottom part of the precision shaver.

Cleaning the body shaver

- 1 Remove the skin protector upwards off the shaver (Fig. 27).
- 2 Clean the skin protector and body shaver under a warm tap (Fig. 28).
- 3 Carefully shake off excess water and let both parts air dry completely.
- 4 Reattach the skin protector onto the body shaver (Fig. 16).

Storage

- Store the appliance in the pouch supplied.

Note: Make sure the appliance is dry before you store it in the pouch.

Ordering accessories

To buy accessories or spare parts, visit **www.shop.philips.com/service** or go to your Philips dealer. You can also contact the Philips Consumer Care Center in your country (see the international warranty leaflet for contact details).

Recycling

- Do not throw away the product with the normal household waste at the end of its life, but hand it in at an official collection point for recycling. By doing this, you help to preserve the environment.
- This product contains a built-in rechargeable battery which shall not be disposed of with normal household waste. We strongly advise you to take your product to an official collection point or a Philips service centre to have a professional remove the rechargeable battery.
- Follow your country's rules for the separate collection of electrical and electronic products and rechargeable batteries. Correct disposal helps prevent negative consequences for the environment and human health.

Removing the rechargeable battery

Only remove the rechargeable battery when you discard the product. Before you remove the battery, make sure that the product is disconnected from the wall socket and that the battery is completely empty.

Take any necessary safety precautions when you handle tools to open the product and when you dispose of the rechargeable battery.

- 1 Check if there are screws in the back or front of the appliance. If so, remove them.

- 2 Remove the back and/or front panel of the appliance with a screwdriver. If necessary, also remove additional screws and/or parts until you see the printed circuit board with the rechargeable battery.
- 3 Remove the rechargeable battery.

Warranty and support

If you need information or support, please visit **www.philips.com/support** or read the international warranty leaflet.

Warranty restrictions

Cutting units are not covered by the terms of the international warranty because they are subject to wear.

简体中文

简介

感谢您的惠顾，欢迎光临飞利浦！为了让您能充分享受飞利浦提供的支持，请在 **www.philips.com/welcome** 上注册您的产品。

基本说明（图 1）

- 1 精修修剪器
 - 2 鼻毛修剪器
 - 3 精修剃须刀
 - 4 标准尺寸须发修剪器
 - 5 开/关按钮
 - 6 电池状态指示灯
 - 7 充电插口
 - 8 胡茬修剪梳齿 3/64 英寸（1 毫米）
 - 9 胡茬修剪梳齿 5/64 英寸（2 毫米）
 - 10 可调节梳齿 1/8 英寸 - 9/32 英寸（3-7 毫米）
 - 11 皮肤保护器
 - 12 体毛剃刀
 - 13 电源部件
 - 14 充电插头
 - 15 定长梳齿 3/8 英寸（9 毫米）
 - 16 定长梳齿 15/32 英寸（12 毫米）
 - 17 定长梳齿 21/32 英寸 16 毫米
 - 18 体毛修剪梳齿 1/8 英寸（3 毫米）
 - 19 体毛修剪梳齿 3/16 英寸（5 毫米）
- 未显示：清洁刷、软袋

重要安全信息

使用本产品及其附件之前，请仔细阅读本重要信息，并妥善保管以供日后参考。随附的附件可能因产品而异。

危险

- 保持电源部件干燥 (图 2)。

警告

- 要给电池充电，请仅使用产品随附的可拆卸电源部件 (HQ8505)。
- 电源部件中包含一个变压器。请勿自行更换电源部件的插头，否则将导致严重后果。
- 本产品也可以由 8 岁或以上年龄的儿童以及肢体不健全、感觉或精神上有障碍或缺乏相关经验和知识的人士使用，但前提是有人对他们使用本产品进行监督或指导，以确保他们安全使用，并且让他们明白相关的危害。切勿让儿童玩弄本产品。不要让儿童在无人监督的情况下对本产品进行清洁和保养。
- 手持部分与电源软线分开后，才能在水中清洗手持部分。
- 使用前，请务必检查产品。请勿使用损坏的产品，否则可能对人体造成伤害。请务必用原装型号更换损坏的部件。
- 切勿拆开本产品更换充电电池。

警告

- 切勿将充电座浸入水中，也不要在水龙头下冲洗 (图 2)。
- 请勿在包含电动空气清新器的墙壁插座上或其周围使用电源部件，以免电源部件受到不可修复的损坏。
- 只能将本产品用于用户手册中所示的原定用途。
- 出于卫生的目的，本产品只能供一个人使用。
- 切勿使用温度高于 80° C 的热水冲洗本产品。
- 切勿使用压缩气体、钢丝绒、研磨性清洁剂或腐蚀性液体（例如汽油或丙酮）来清洁产品。

电磁场 (EMF)

- 本 Philips 产品符合所有有关暴露于电磁场的适用标准和法规。

概述

- 该产品具有防水性能 (图 3)。适合在沐浴或淋浴时使用，也可以放在水龙头下清洗。出于安全原因，该产品在使用时不能连接电线。
- 电源部件适合在 100 - 240 伏的电源电压下工作。
- 该电源部件可将 100-240 伏的电压转换为 24 伏以下的安全低电压。

充电

电池状态指示

- 当电池的电量几乎耗尽时，电池电量状态指示灯会呈橙色闪烁。
- 当产品充电时，电池状态指示灯呈白色缓慢 (图 4) 闪烁。
- 在快速充电期间，电池状态指示灯呈白色快速闪烁。充电大约 5 分钟后，电池指示灯会呈白色缓慢闪烁。现在，本产品所含的电量足以进行一次不接电源的修剪。
- 当电池充满电后，电池指示灯会呈白色持续 (图 5) 亮起。

注意： 指示灯将大约 30 分钟后自动熄灭。

充电

第一次使用本产品之前，或当显示屏指示电池电量快要耗尽时，请先为产品充电。本产品充电 1 小时后，可不接电源工作长达 2 小时。

- 1 确保产品电源已关闭。
- 2 将充电插头插入产品，然后将电源部件插入电源插座 (图 6)。
- 3 充电之后，从电源插座上拔下电源部件，并从产品上拔下充电插头。

快速充电

本产品充电约 5 分钟即可完成一次不接电源的修剪。

使用本产品

注意： 本产品只能在不接电源的情况下使用。
注意： 每次使用后，请关闭并清洁产品。

拆卸和安装刀头部件

- 1 要拆卸刀头部件，请顺着刀头部件的啮合部位向上推，将其从手柄 (图 7)上取下。
- 2 要安装刀头部件，请将刀头部件的凸缘插入前端的导向槽内，然后将刀头部件的后部推入产品中（听到“咔哒”一声） (图 8)。

拆卸精修剃须刀和鼻毛修剪器

- 1 将手指置于附件背面的箭头处，按箭头 (图 9)方向将其从手柄中推出。

安装和拆卸梳齿

- 1 要将任意类型的网罩安装到修剪部件上，请将网罩的前部滑到修剪部件的梳齿上。然后用手指或手掌在网罩的中心向下按（可听到“咔哒”一声） (图 10)。
- 2 要从刀头部件上拆卸任意类型的梳齿，请小心地将梳齿的后部从产品上拔下，然后将其从刀头部件 (图 11)上滑出。

注意： 第一次进行修剪时，应从最大的修剪长度设置开始使用梳齿，以熟悉产品的使用。

打开或关闭产品

按一下开/关按钮，打开或关闭 (图 12)产品。

用于剃须的附件

标准尺寸须发修剪器

使用不带梳齿的标准尺寸须发修剪器，以非常紧贴皮肤的距离（0.5 毫米 - 1/32 英寸长）修剪须发或在胡须、颈部和鬓角周围打造明晰的线条。

- 1 如需贴近皮肤修剪须发，请将刀头部件平坦的一侧贴近皮肤放置，然后逆着须发生长 (图 13)的方向来回移动。
- 2 如需修剪轮廓，请手执修剪器，使刀头部件与皮肤呈垂直角度，并上下移动刀头部件，同时轻轻按压 (图 14)。

胡须修剪梳齿

将胡须修剪梳齿安装到标准尺寸须发修剪器上，以均匀地修剪胡须和须髥。 本产品随附 3 款胡须修剪梳齿。梳齿上显示有须发长度设置。 设定值对应修剪后须发剩余的长度。

梳齿	英寸	毫米
胡茬修剪梳齿	3/64 英寸	1 毫米
胡茬修剪梳齿	5/64 英寸	2 毫米
可调节梳齿	1/8 英寸-9/32 英寸	3 毫米 - 7 毫米

- 1 将梳齿安装到标准尺寸须发修剪器上。
- 2 可调节梳齿： 向左或向右推动长度选择器，以选择所需的须发长度设置。
- 3 为了实现最佳的修剪效果，请逆着毛发生长 (图 15)的方向移动梳齿。 请确保梳齿表面始终与皮肤相接触。

用于身体的附件

- 使用绿色体毛修剪梳齿修剪体毛。
- 第一次进行修剪时，应使用 5 毫米（3/16 英寸）的体毛修剪梳齿，以熟悉产品的使用。
- 请确保毛发清洁干燥，因为湿的毛发容易贴在身体上。当修剪敏感部位的毛发时，请务必使用体毛修剪梳齿。
- 由于并非所有的毛发均按相同的方向生长，因此您可能需要尝试不同的修剪位置（即向上、向下或交叉）。 不断实践才能获得最佳效果。
- 始终轻柔平稳地移动，确保梳齿表面始终与皮肤相接触。
- 如果产品中积聚了过多的毛发，请在使用前先将毛发吹掉，以获得最佳的修剪效果。

体毛修剪梳齿

将体毛修剪梳齿安装到标准尺寸须发修剪器上，以修剪领口以下任意部位的体毛。 本产品随附 2 款体毛修剪梳齿。梳齿上显示有须发长度设置。 设定值对应修剪后须发剩余的长度。

梳齿	英寸	毫米
体毛修剪梳齿（绿色）	1/8 英寸	3 毫米
体毛修剪梳齿（绿色）	3/16 英寸	5 毫米

- 1 将体毛修剪梳齿安装到标准尺寸须发修剪器上。
- 2 为实现最佳的修剪效果，请用另一只手绷紧皮肤并逆着毛发生长 (图 17)的方向移动梳齿。 请确保梳齿表面始终与皮肤相接触。

体毛剃刀

将身体剃毛刀安装到产品上，以剃除领口以下（如腋窝和胸部）的体毛。 身体剃毛刀只能搭配皮肤保护器使用。 切勿将身体剃毛刀与水或剃须泡沫配合使用。

- 1 将身体剃毛刀安装到产品上。
- 2 将皮肤保护器安装到标准尺寸须发修剪器 (图 16)上。
- 3 为实现最佳的剃毛效果，请用另一只手绷紧皮肤并逆着毛发生长 (图 17)的方向移动剃毛刀。 请确保剃毛刀表面始终与皮肤充分接触。

用于头部的附件

标准尺寸须发修剪器

使用不带梳齿的标准尺寸须发修剪器，以非常贴近皮肤的距离（0.5 毫米或1/32 英寸）修剪头部须发，或在领口和耳朵附近区域修剪出轮廓。

- 1 如需修整耳朵周围的发际线轮廓，请梳理耳朵上方的发梢。
- 2 在修整耳朵周围的轮廓时，倾斜本产品，仅让修剪刀头的一边接触发梢。
- 3 要修饰颈背或鬓角的轮廓，请转动产品并向下修剪 (图 18)。
- 4 沿着发际线的自然生长线条缓慢、平稳地移动产品。

定长梳齿

将定长梳齿安装到标准尺寸须发修剪器上，以均匀地修剪头发。 本产品随附 3 款定长梳齿。梳齿上显示有须发长度设置。 设定值对应修剪后须发剩余的长度。

梳齿	英寸	毫米
定长梳齿	3/8 英寸	9 毫米
定长梳齿	15/32 英寸	12 毫米
定长梳齿	21/32 英寸	16 毫米

- 1 将梳齿安装到标准尺寸须发修剪器上。

- 2 缓慢从各个方向沿头顶再向下移动修剪器，以修剪出均长的发型。请确保梳齿表面始终与皮肤相接触。
 - 始终逆着毛发生长 (图 19) 的方向移动修剪器。轻轻按压。
 - 在整个头部重复修剪动作，以确保剪到所有需要修剪的头发。

用于面部的精修附件

精修修剪器

使用精修修剪器，在您的面部周围以非常贴近皮肤的距离 (0.5 毫米 - 1/32 英寸长) 修剪出细致的线条和轮廓。

- 1 手持修剪器，使精修修剪刀头与皮肤呈垂直角度，并上下移动修剪刀头，同时轻轻按压 (图 20)。

鼻毛修剪器

使用鼻毛修剪器，修饰鼻毛和耳毛。

- 请确保鼻腔清洁无异物。请确保外耳道清洁，没有耳垢。
- 修剪头插入鼻腔的深度不得超过 5 毫米 (3/16 英寸)。
- 务必在每次使用后清洁附件。

修剪鼻毛

- 1 将修剪头轻轻插入和移出鼻孔，同时转动修剪头，以去除多余的毛发 (图 21)。

修剪耳毛

- 1 在耳部周围缓缓移动修剪头，以去除突出耳缘的毛发。
- 2 将修剪头轻轻插入和移出外耳道，以去除多余的毛发 (图 21)。

精修剃须刀

在修剪后使用精修剃须刀精确剃除脸颊、下巴和胡子周围多余的毛发。请务必先使用不带梳齿的标准尺寸须发修剪器预先修剪您的胡须，以获得最佳的效果。

注意： 使用精修剃须刀去除剩余的毛发，精心打造胡须造型。它不适用于全脸剃须。

- 1 将精修剃须刀轻按到皮肤上，沿着轮廓边缘剃除所有多余的毛发 (图 22)。

清洁

切勿使用钢丝绒、研磨性清洗剂或腐蚀性液体（例如汽油和丙酮）来清洁本产品。

切勿用毛巾或纸巾擦干修剪器齿，否则可能会损坏修剪器齿。

每次使用后：在水龙头下清洁

- 1 关闭产品并断开电源插座连接。
- 2 从产品上拆下所有梳齿或修剪部件。
- 3 在温水龙头下冲洗胡茬储藏室。
- 4 在温水龙头 (图 23) 下冲洗修剪部件和梳齿。
- 5 小心地甩掉多余水分并彻底晾干所有部件。

彻底清洁

- 1 关闭产品并断开电源插座连接。
- 2 使用干布擦拭产品手柄。
- 3 从产品上拆下所有梳齿或修剪部件。
- 4 使用附带的清洁刷清除胡茬储藏室中积聚的毛发。
- 5 使用附带的清洁刷清除修剪部件和/或梳齿中积聚的毛发。
- 6 在温水龙头下冲洗修剪部件。
- 7 在温水龙头下冲洗梳齿。
- 8 小心地甩掉多余水分并彻底晾干所有部件。

清洁鼻毛修剪器

在使用后以及在鼻毛修剪器刀头积聚大量毛发或灰尘时，请立即清洁鼻毛修剪器。

- 1 用热水 (图 24) 冲洗鼻毛修剪器刀头。
- 2 打开产品，再次冲洗鼻毛修剪器刀头，以去除所有残留的毛发。然后再次关闭本产品。

为了进行彻底的清洁，可将鼻毛修剪器刀头置于碗中，用温水浸泡几分钟，然后打开产品去除残留的毛发/碎屑。

- 3 小心地甩掉多余水分并彻底晾干所有部件。

清洁精修剃须刀

- 1 握住精修剃须刀凹槽部分的两侧，将顶部部件从底部部件 (图 25) 上拔出。
- 2 吹掉和/或甩掉积聚在精修剃须刀内部的毛发。
- 3 在温水龙头 (图 26) 下冲洗精修剃须刀的刀头。
- 4 小心地甩掉多余水分并彻底晾干所有部件。
- 5 将精修剃须刀的刀头重新安装到底部部件上。

清洁身体剃毛刀

- 1 从剃毛刀 (图 27) 向上推拆下皮肤保护器。
- 2 在温水龙头 (图 28) 下冲洗皮肤保护器和身体剃毛刀。
- 3 小心地甩掉多余水份并彻底晾干这两个部件。
- 4 将皮肤保护器重新安装到身体剃毛刀 (图 16) 上。

存放

- 将产品存放在随附的软袋中。

注意： 将本产品存放到软袋之前，应确保其干燥。

订购配件

要购买附件或备件，请访问

www.shop.philips.com/service 或联系您的飞利浦经销商。您还可以联系所在国家/地区的飞利浦客户服务中心（请参阅全球保修卡了解详细联系信息）。

回收

- 弃置本产品时，请不要将其与一般生活垃圾放在一起，应将其交给政府指定的回收中心。这样做将有利于环保。
- 此产品包含内置充电电池；请勿将充电电池与一般生活垃圾一起弃置。强烈建议您将自己的产品送到官方收集点或飞利浦服务中心，让专业人士移除充电电池。
- 遵循您的国家/地区有关分类回收电子电气产品和充电电池的规定。正确弃置产品有助于避免对环境和人类健康造成不良后果。

拆下充电电池

仅在丢弃本产品时方可取出充电电池。卸下电池之前，请确保本产品与电源断开连接并且电池电量已耗尽。

当您使用工具打开本产品时以及在您弃置充电电池时，请采取必要的安全保护措施。

- 1 检查产品的前面和后面是否有螺丝。如果有，请将其拆下。
- 2 用螺丝刀卸下产品的前面板和/或后面板。必要时还需要拆下更多的螺丝和/或部件，直到您看见装有充电电池的印刷电路板为止。
- 3 拆下充电电池。

PHILIPS

产品：飞利浦多功能造型理容器
型号：MG7720
额定电压：220V~
额定频率：50Hz
额定输入功率：9 W
生产日期：请见产品本体
产地：印度尼西亚



制造商：飞利浦电子香港有限公司
香港新界沙田香港科学园科技道东五号

经销单位：飞利浦（中国）投资有限公司
上海市天目西路218号1602-1605
全国顾客服务热线: 4008 800 008

本产品根据国标 GB4706.1-2005,
GB4706.9-2008制造

保留备用
发行日期: 26/06/2017

产品中有害物质的名称及含量						
部件名称	有害物质					
	铅 (Pb)	汞 (Hg)	镉 (Cd)	六价铬 (Cr (VI))	多溴联苯 (PBB)	多溴二苯醚 (PBDE)
PCB's 集成电路板	X	O	O	O	O	O
Electrical contact pins 电接触片	X	O	O	O	O	O
Power plug 电源插头	X	O	O	O	O	O
本表格依据SJ/T 11364的规定编制。						
O: 表示该有害物质在该部件所有均质材料中的含量均在GB/T 26572规定的限量要求以下。						
X: 表示该有害物质至少在该部件的某一均质材料中的含量超出GB/T 26572规定的限量要求。						

- 该表格中所显示的“有害物质”在产品正常使用情况下不会对人身和环境产生任何伤害。
- 该表格中所显示的“有害物质”及其存在的部件向消费者和回收处理从业者提供相关物质的存在信息，有助于产品废弃时的妥善处理。

保修和支持

如需信息或支持，请访问 www.philips.com/support 或阅读国际保修卡。

保修条款

修剪部件不在国际保修条款的涵盖范围之内，因为修剪部件属于易磨损物品。

保修与服务

This guarantee card is valid in China.
This guarantee card should be retained by The USER
此保用卡在中国适用，用户请保留此卡。

保修及服务：

此产品是一件设计精良，用高品质元件制造之家用电器，在正常使用及保养下应能发挥其优越性能。在购买日期后二年内，若发生任何因制造工艺或元器件造成之损坏，飞利浦中国维修服务中心将为持证用户提供免费门市维修服务，视情况更换零件或整个产品。

无论在保期中或保期后，只要飞利浦正式行销该产品的任何国家皆可获得维修服务。

若飞利浦在当地无行销该项产品，飞利浦同样提供维修服务，但可能因未储备所需零件，维修时间可能较长，敬请见谅。请联络当地飞利浦经销商，或飞利浦服务部门。

若您需洽询相关资讯，或遇困难事项时，请联络当地飞利浦维修服务中心，或向飞利浦服务热线咨询。

中国顾客服务热线：4008 800 008 (用户需承担本地通话费)。

网址：<http://www.philips.com.cn>

保修条例：

- 在购买日期后二年内，凡经本公司特约维修站人员确认为正常使用情况下，因制造工艺或元器件造成之损坏，您都将获得免费保修服务。
- 此免费服务不包括需时常更换的易耗零配件（吸尘机纸袋，布袋，空气清新机滤网，滤芯，活性炭，咖啡壶过滤网）及附件（如须刀网膜、刀头，咖啡杯，食品加工机杯/刀具等），辅助装置，运输费及维修人员上门服务费。
- 用户请保留此联。
- 维修时请携同此证及发票正本。
- 此证若经涂改即作废。
- 此证须联同发票正本使用方为有效。
- 以下情况将不能获得免费服务
 - 1 使用不当引起的人为损坏，例如接入不当电源、使用不当配件、不适当之安装、不依说明书使用、错误使用或疏忽而造成损坏等。因运输及其他意外而造成之损坏。非经本公司认可之维修和改装。其他因不可抗力（如自然灾害、电压异常等）造成的损坏。
 - 2 一般家庭以外使用（如工业、商业用）而造成的损坏。
 - 3 正常使用引起的产品老化、磨损等，但不影响产品的正常使用。
- 此证仅在中国境内有效。
- 保修证作为在规定期限及条件之内进行免费维修的保证，并不限制消费者的法定权利。

网上会员注册与产品注册：

- 1 登陆 <http://www.philips.com.cn/welcome>
- 2 点击“创建新账户”，创建您的飞利浦账号。
- 3 点击“注册产品”，通过产品名称或产品型号查找产品，完成产品注册

Service information

For after-sales and maintenance service, please call service hotline 4008 800 008. Any comments and enquiries during the service, please Contact our Philips Consumer Lifestyle Customer Care Service Office.

Philips(china)Investment Co.,Ltd. Philips
Consumer Lifestyle Philips Innovation
Campus Shanghai NO.1 Building,
NO.10, Lane 888 Tian Lin Road Shanghai,
P. R. C. 200233

Fax: +86 21 5445 2663

服务须知

如需要此产品的售后服务，请拨打服务热线4008 800 008

如在维修服务过程中有任何意见，
欢迎致函飞利浦优质生活服务办事处解决疑难。

飞利浦（中国）投资有限公司

飞利浦优质生活客户服务部

中国上海市田林路888弄10号

飞利浦创新科技园1号楼

邮政编码：200233 传真：（021）5445 2663