

## Gigaset DA210 overview

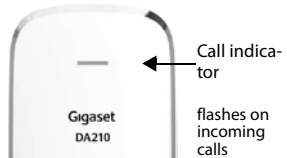

Call indicator

flashes on incoming calls

- 1 Speed dial key
- 2 Mute key with LED  
The LED flashes if the microphone is switched off.
- 3 Set key  
The mute key LED flashes while the telephone is in set mode.
- 4 Redial/Pause key
- 5 Recall key
- 6 Handset volume key
- 7 Switch for changing between pulse and tone dialling mode

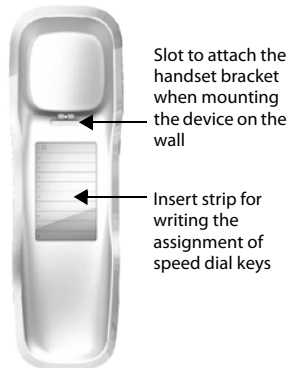

Slot to attach the handset bracket when mounting the device on the wall

Insert strip for writing the assignment of speed dial keys

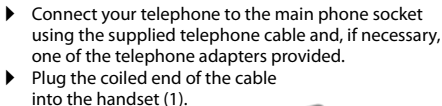

- Guide the cable through the cable channel of the handset cradle: upwards for operating the phone on the table (2); downwards when mounting the phone on the wall (3).

- ▶ Drill two dowel holes into the wall at a vertical distance of 85 mm and fix two screws.
- ▶ Lift out the handset bracket (4) with a screwdriver and clip it into the handset cradle (5).
- ▶ Hang the telephone on the projecting screw heads.

**Please note:** The handset bracket must be placed in the cradle with the slanting edge facing forwards (see graphic), as otherwise the handset will not be properly secured.

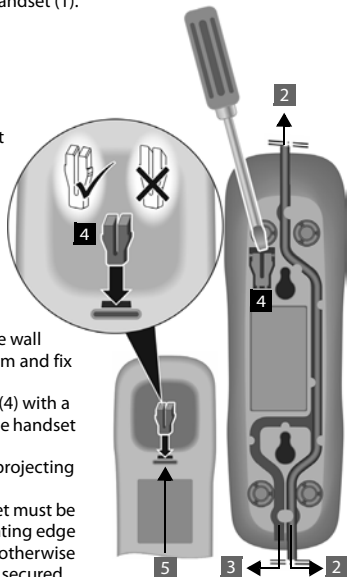

When installing, connecting and operating the telephone, always observe the following precautions:

- ◆ Only use the jacks and leads supplied.
- ◆ Only connect the connecting lead to the intended socket.
- ◆ Only connect approved accessories.
- ◆ Lay the connecting lead where it will not cause accidents.

- ◆ Position the telephone on a non-slip surface.
- ◆ For your safety and protection, the telephone may not be used in the bath or shower rooms (wet locations). The telephone is not splash proof.
- ◆ Never expose the telephone to sources of heat, direct sunlight or other electrical devices.
- ◆ Protect your telephone from moisture, dust, corrosive liquids and vapours.

- ◆ Never open up the telephone yourself.
- ◆ Do not touch the plug contact with pointed or metallic objects.
- ◆ Do not carry the telephone by the leads.
- ◆ If you give your telephone to someone else, make sure you also give them the operating manual.

## Setting up the telephone for use

Recommended installation of telephone:

- ◆ Do not expose the telephone to direct sunlight or other sources of heat.
- ◆ Operate at temperatures of between +5°C and +40°C.
- ◆ Maintain a distance of at least one metre between the telephone and radio equipment, e.g. radio telephones, radio paging equipment or TV sets. Otherwise, telephone communication could be impaired.
- ◆ Do not install the telephone in dusty rooms as this can limit the service life of the telephone.
- ◆ Furniture lacquer and polish can be adversely affected by contact with parts of the unit (e.g. feet).

## Dialling and saving numbers

### Dialling a number



Lift the handset, dial the number.

### Last number redial

The last number dialled is automatically saved.



Lift the handset, press the last number redial key.

### Speed dialling

You can save 10 numbers for speed dial on the number keys (0-9) (each with max. 21 digits).

### Saving number



Press the set key.



Press the speed dial key.



Define the speed dial number.



Enter the number for the speed dial.



Press the set key.

**Note:** The LED on the mute key flashes while the telephone is in set mode.

### Dialling a speed dial number



Lift the handset, press the speed dial key.



Press the speed dial number key.

### Notes on saving and deleting speed dial numbers

**\*** and **#** are saved regardless of the set dialling mode but are only dialled with tone dialling mode (→ page 4).

If the number entered is longer than 21 digits, the saved number is deleted.

### Dialling pauses

One or more dialling pauses can be entered using **↔ P** (not at 1st digit). Pauses are transferred to the memory and are necessary for certain extension systems (e.g.:

0 **↔ P** 2368).

- ◆ Dialling a dialling pause within the first 5 digits:

The entire number saved is dialled, including the 2-second dialling pause.

- ◆ Dialling a dialling pause after the first 5 digits:

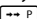
The portion of the number saved after the pause is only dialled after pressing the  key.

## Adjusting the telephone

### Setting the handset volume

The handset volume can be set to two levels.



Press the handset volume control key.

The primary volume is reset after hanging up.

### Mute

You can deactivate the telephone's microphone during a call.



Press the mute key.

To reactivate microphone: Press the mute key again or press any other key.

The mute key LED flashes while the microphone is deactivated.

### Setting the ringer

You can set the ringer melody and volume to 9 levels or turn it off (factory default: level 6).



Lift the handset, press the set key.



Press the hash key.



Press one of the number keys.  
(0: Ringer off until handset is next lifted).



Press the set key.

**Note:** The LED on the mute key flashes while the telephone is in set mode.

## Operation on a PABX

### Special functions/Recall key

During an external call, you can make an enquiry or forward the call. To do this, press the recall key . The subsequent procedure depends on your PABX.

To set the recall key, the telephone's flash time must be set consistent with your PABX. Please refer to the operating instructions for your PABX.

### Changing the dialling mode/flash time

The telephone supports the following dialling modes:

T1: Tone dialling, flash time 100 ms

T2: Tone dialling, flash time 280/  
600 ms  
(depending on device model)

P: Pulse dialling

Depending on your PABX, you may need to change your telephone's dialling mode or the flash time.

T1 T2 P



To do this, use the sliding switch below the keypad.

### Temporary tone dialling switching in "Pulse" position

To use functions that require tone dialling (e.g. remote control of answering machine), you can set the telephone to tone dialling for the duration of the call without adjusting the switch.

After the connection is established:



Press the star key.

After the connection is broken, the setting reverts to pulse dialling.

## Operation on public telephone systems

Public telephone systems - in some cases by special order/request – offer you a range of useful additional services (e.g. call divert, call back on busy, three-party conference etc.). These services can be selected using specified key combinations, which your network provider will notify you of. You can save the entire key combination, including the number of a fixed call divert destination, to your speed dial keys just like a normal number.

### Recall key

In public telephone systems, the recall key is required to use certain additional services; e.g. for "Call back on busy".

You may need to adjust the flash time of your telephone to the needs of the public telephone system. To do this, use the sliding switch below the keypad ( → page 4).

## Appendix

### Care

Wipe the unit with a **damp cloth** or an **antistatic cloth**. Do not use solvents or microfibre cloths.

**Never** use a dry cloth; this can cause static.

### Contact with liquid

If the device comes into contact with liquid:

- 1 Allow the liquid to drain from the device.
- 2 Pat all parts dry. Place the device (the keypad facing down) in a dry, warm place **for at least 72 hours (not in a microwave, oven etc.)**.
- 3 Do not switch on the device again until it is completely dry.

When it has fully dried out, you will normally be able to use it again. In rare cases, contact with chemical substances can cause changes to the telephone's exterior. Due to the wide variety of chemical products available on the market, it was not possible to test all substances.

### Questions and answers

**You lift the handset but you hear**

**no dialling tone:** Is the connecting lead correctly plugged into the telephone and the telephone socket?

**The dialling tone is audible but the telephone will not dial:** The connection is OK. Is the dialling mode set correctly?

**The other party cannot hear you:** Mute activated?

**Regular pulse noises can be heard during a call:** The connection is receiving metering pulses from the exchange, which the telephone cannot interpret. Contact your network operator.

### Protecting our environment

#### Our environmental mission statement

We at Gigaset Communications GmbH are aware of our social responsibility. That is why we actively take steps to create a better world. In all areas of our business - from product planning and production to sales and waste of disposal - following our environmental conscience in everything we do is of utmost importance to us.

Learn more about our earth-friendly products and processes online at [www.gigaset.com](http://www.gigaset.com).

## Environmental management system



Gigaset Communications GmbH is certified according to the international standards ISO 14001 and ISO 9001.

**ISO 14001 (Environment):** Certified since September 2007 by TÜV SÜD Management Service GmbH.

**ISO 9001 (Quality):** Certified since 17/02/1994 by TÜV SÜD Management Service GmbH.

## Contacts

If you should encounter any problems when operating the telephone connected to a communication system with analogue network access, please contact the network operator responsible or your dealer.

## Disposal

All electrical and electronic products should be disposed of separately from the municipal waste stream via designated collection facilities appointed by the government or the local authorities.



This crossed-out wheeled bin symbol on the product means the product is covered by the European Directive 2002/96/EC.

The correct disposal and separate collection of your old appliance will help prevent potential negative consequences for the environment and human health. It is a precondition for reuse and recycling of used electrical and electronic equipment.

For more detailed information about disposal of your old appliance, please contact your local council refuse centre or the original supplier of the product.

## Authorisation

This device is intended for analogue phone lines in the UK and on the Irish network.

Country-specific requirements have been taken into consideration.

We, Gigaset Communications GmbH, declare that this device meets the essential requirements and other relevant regulations laid down in Directive 1999/5/EC.

A copy of the 1999/5/EC Declaration of Conformity is available at this Internet address:

[www.gigaset.com/docs](http://www.gigaset.com/docs)

CE 0682



Issued by  
Gigaset Communications GmbH  
Frankenstrasse 2a, D-46395 Bocholt

© Gigaset Communications GmbH 2011  
All rights reserved. Subject to availability.  
Rights of modification reserved.

[www.gigaset.com](http://www.gigaset.com)  
A30054-M6527-R101-5-6Z19