

Electric Scooter

User Manual

Thank you for your purchasing! Please read this instruction carefully before you using the scooter for security.

Contents

Names and instructions of major parts	02
Safety Instruction	03
Product Presentation	04
Unfolding/ picture	04
Folding/ picture	05
Basic Operation	06
Display and Throttle	06
Brake controlling	07
Riding Operation	08
Get ready to start	08
Riding	08
Parking	08
Charger and battery	09
Maintenance	10
Lubricating	10
Battery	10
Place& Daily care	10
General troubleshooting	10
Product specification and parameters	11
Scope of warranty	13

Major Parts of Scooter

- 1 Handle bar
- 2 Accelerator
- 3 T bar
- 4 Front Tube
- 5 Quick release clamp
- 6 Display and Throttle
- 7 Brake Lever
- 8 Folding lever
- 9 Charger Socket
- 10 Hub Brake



Safety Instruction

- 1 This device is designed for single use, please do not carry any passenger during any riding; Children and juveniles can not play it.
- 2 Please wear the helmet and other protective equipments during riding this device.
- 3 Do not ride on the unsafe or unqualified road.
- 4 Please practise in open space and get familiar with the control method before riding.
- 5 Please do not do dangerous actions or put single hand in riding. Keep the feet on the device.
- 6 Do not turn off the power during riding.
- 7 Do not attempt to directly go through a stair which is 3cm or higher, as may make the device tip over, causing injury or damage the device.
- 8 Slow down and proceed with caution when user rides the device through a rough or uneven pavement.
- 9 Users must adjust the product height to the proper position before using to ensure safety.
- 10 Do not ride the device through the water, oil, and ice on the ground.
- 11 Do not use the device under -5°C .
- 12 Do not place the device in the water depth of 5cm or deeper. It would cause a short-circuit fault of the motor and circuit.
- 13 Try to avoid riding on bad weather.
- 14 Please charge the device at least once every 30 days.

Production Introduction

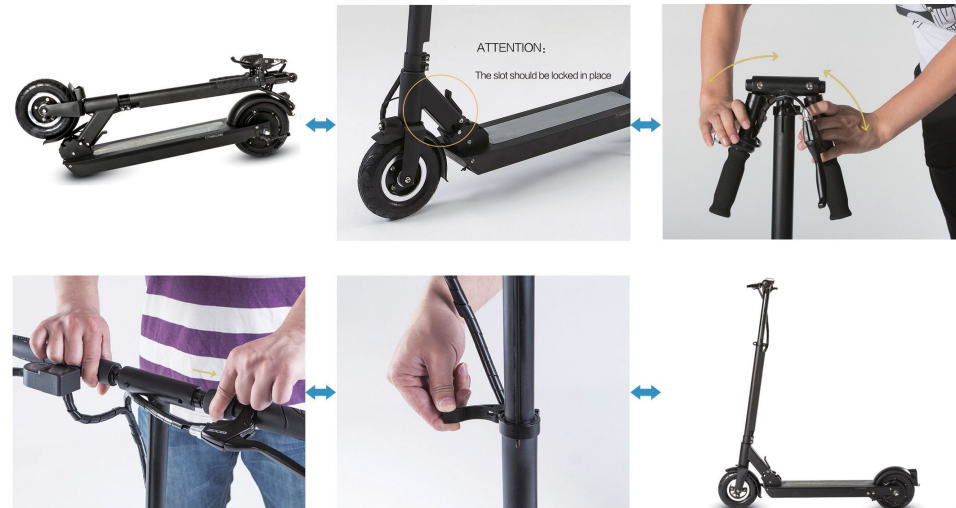

Product Introduction



- | | |
|---------------------------|------------------|
| 1. Power Switch | 4. Power Display |
| 2. Mode setting button | 5. Speed Show |
| 3. Speed Control Throttle | 6. Distance Show |



- | | |
|---------------------------|------------------|
| 1. Power Switch | 4. Power Display |
| 2. Mode setting button | 5. Speed Show |
| 3. Speed Control Throttle | 6. Distance Show |

Warning: Please keep the throttle and brake free before turning on

Function:

1. Display function:speed,power ,Fault Reason, distance,trip distance.
2. Control setting function: power switch control,wheel dismeter setting, dormancy setting, the brightness setting,boot setting,driving mode setting, voltage grade setting,the limit of controller setting.
3. communication protocol:UART displays all the content.
(starting up 1S display all the content)

KeyPress introduction function:

- 1.Shutdown mode:please press ON/OFF button,after start,please press the ON/OFF button,the display on ODO,TRIP,RM,TM,ERROR will transition
- 2.starting mode:please press ON/Off to turn off.
- 3.please long pressON/OFF+MODE into the mode settings,the short press the ON/OFF switching point.
- 4.please short press MODE to change the speed,when you press the speed in each time,the speed will cycle changes in SLO,MID,FAS;

the modification of the parameters:

Method1: in the condition of a certain parameter,please long press ON/OFF setting numerical flashing ,after flashing you can modify the parameter value,please short press the ON/OFF setting value decreases,after making modifications,please long press ON/OFF or Long press MODE setting the parameter stop flashing and save,Short press the ON/OFF again can switch to change other parameters;Again, long press ON/OFF + MODE key to exit the Settings interface;

Methed 2: in the condition of a certain parameter, please short press MODE key set numerical flicker and increases, please short press the ON/OFF set values increase or decrease in small,Again, long press ON/OFF + MODE key parameters of save the changes and exit interface; 4, rocker arm adjusting the motor speed by on strike down, motor speed increase;Let go back to 0.

RIDING OPERATIONS

Get ready to start

- 1 Choose an open space.
- 2 Unfold the device by previous steps.
- 3 Adjust the height of the tiller.

Riding

- 1 Press  button to turn on the power, the speed mode defaults to the first level.
- 2 The device has safe-start function. Place one foot on the pedal, the other foot on the ground and taxing slowly while gently pull the throttle; Start riding.
- 3 You can choose different speed levels according to different road conditions to adjust riding speed; and you can control speed by pulling the throttle.
- 4 When riding, if someone or barriers in front of you, please use the brake lever to cut off the motor power to decelerate or stop the device , and at the same time, using the bell to remind others.

Parking

Pull back the brake lever would cut off the power supply and decelerate immediately. Place one foot on the ground after the speed is proper. Avoid emergency braking to prevent skidding fall, or will worn the tire and lead to instability in riding.

Notice:Do not recommend to use this device during the raining day or freezing weather. If necessary, user has to keep the speed under 10 km/h and avoid the emergency braking to prevent skidding fall.

BATTERY AND CHARGER

Each scooter is equipped a specific lithium battery and a specific charger. Every scooter and parts have its own serial number.

Please do not charge the battery by the other charger and do not charge other battery by the charger either, or will be dangerous.

Our company is not responsible for the damage of the battery or charger if users do not do as the instruction.

Lithium Battery

Please fully charge the battery before using when you get a new scooter.

You' d better charge the battery when the battery capacity is lower than 2 levels to avoid influencing your trip.

When the battery is not used for a long time, please charge at least once per month;

The battery protection will be triggered when the device is not used for a long time, users could contact regional distributor to activate the battery.

The battery is damaged because of some abnormal factors like water、crash and so on, the warranty will be void.

Charger

The overcharge protection function of the intelligent charger will automatically stop the charging process when the battery is 100% full.

The charger is damaged because of some abnormal factors like water、crash and so on, the warranty will be void.

Charging instruction

- 1 Open the rotation protection cover of the charger socket; connect the charger plug to charging socket on the frame.
- 2 Plug the charger into general power dock (AC100V-240V).
- 3 The charging process is running when the illustration light is red, the charging process is completed when the light turns green, power is full at this stage.
- 4 Please place the charger in dry and ventilated environment.

Maintenance

Lubricating: To add a small amount of white grease or lubricant to the handle every three months.

Tire: Rubber elastic tire is used in the product. The tires need to be changed immediately when it has obvious rupture.

Please contact the dealer to replace the original tires. Please check the scooter every month, to see if there are screw loose, tighten them.

Brake: Disc brake is applied in the product. Any wear of brake pad could impact brake performance, please contact the dealer to adjust the brake line tightness; need to change the brake pad when serious condition occur.

Battery: The equipped lithium battery has charging cycle at least 500 times, the normal use of the general can reach more than 600 times. When the battery is full of electricity, driving mileage only half of the factory mileage, it is recommended to replace the lithium battery.

Placement and daily care: Please don't expose the scooter in the sun or other serious damp places for a long time; please keep clean scooter.

General Troubleshooting

When the product is not working properly, please check if the following work has been completed:

a-power is turned on

b-Check the battery power through the screen

c-To check the left brake

d-Whether all sockets and connectors are correctly connected

If the above steps are completed, still not in normal operation, please contact the manufacturer or local dealer.

Product specification parameter list

Model		R1	R1 ⁺	R3	R3 ⁺	F5
Specifications	unfold size	980*520*(820-1100)mm	980*520*(820-1100)mm	980*520*(820-1100)mm	980*520*(820-1100)mm	980*500*1140mm
	fold size	880*150*310mm	880*150*310mm	880*150*310mm	880*150*310mm	980*180*360mm
	center distance	770mm	770mm	770mm	770mm	870mm
	weight(include battery)	11.3KG	11.8KG	11.3KG	11.8KG	14KG
Performance	max payload	120 KG	120 KG	120 KG	120 KG	120 KG
	max speed	≤22km/h	≤22km/h	≤22km/h	≤22km/h	≤35km/h
	climbing ability	15 °	15 °	15 °	15 °	15 °
	single endurance	20-25KM	35-40KM	20-25KM	35-40KM	50-55KM
Battery parameters	standard voltage	24V	24V	24V	24V	36V
	battery type	lithium battery	lithium battery	lithium battery	lithium battery	Three element lithium battery
	battery capacity	8AH	13AH	8AH	13AH	18AH
	motor type	Brushless DC motor	Brushless DC motor	Brushless DC motor	Brushless DC motor	Brushless DC motor
Motor parameters	output rating	250W	250W	250W	250W	350W
	max revolution	600r/min	600r/min	600r/min	600r/min	600r/min
	rated voltage	24V	24V	24V	24V	36V
	max output torque	15N.m	15N.m	15N.m	15N.m	9N.m
Charger parameters	input voltage	AC110-240V	AC110-240V	AC110-240V	AC110-240V	AC110-240V
	input current	2A	2A	2A	2A	2A
	charging time	3-4 hours	5-6 hours	3-4 hours	5-6 hours	4-4.5 hours
Display		Five Star Display	Five Star Display	Liquid crystal Display	Liquid crystal Display	
Front/Rear lights		No	No	Yes	Yes	

Product specification parameter list

Model		A1	A3	F1	F3	X1	X3	X5	X5S
Specifications	unfold size	980*500*1140mm	980*500*1140mm	980*500*1140mm	980*500*1140mm	1150*500*1180mm	1150*500*1180mm	1150*500*1180mm	1150*500*1180mm
	fold size	980*180*360mm	980*180*360mm	980*180*360mm	980*180*360mm	1050*190*380mm	1050*190*380mm	1050*190*380mm	1050*190*380mm
	center distance	870mm	870mm	870mm	870mm	890mm	890mm	890mm	890mm
	weight(include battery)	11.5KG	12KG	12KG	13KG	13.5KG	14.5KG	15.5KG	15.5KG
Performance	max payload	120 KG	120 KG	120 KG	120 KG	120 KG	120 KG	120 KG	120 KG
	max speed	≤25km/h	≤25km/h	≤35km/h	≤35km/h	≤35km/h	≤35km/h	≤35km/h	≤35km/h
	climbing ability	15 °	15 °	15 °	15 °	15 °	15 °	15 °	15 °
	single endurance	20-25KM	30-35KM	25-30KM	40-45KM	30KM	45KM	60KM	55KM
Battery parameters	standard voltage	24V	24V	36V	36V	36V	36V	36V	48V
	battery type	Three element lithium battery	Three element lithium battery	Three element lithium battery	Three element lithium battery	Three element lithium battery	Three element lithium battery	Three element lithium battery	Three element lithium battery
	battery capacity	8AH	13AH	8AH	13AH	8AH	13AH	18AH	13AH
	motor type	Brushless DC motor	Brushless DC motor	Brushless DC motor	Brushless DC motor	Brushless DC motor	Brushless DC motor	Brushless DC motor	Brushless DC motor
Motor parameters	output rating	250W	250W	350W	350W	350W	350W	350W	500W
	max revolution	600r/min	600r/min	600r/min	600r/min	930r/min	930r/min	930r/min	1050r/min
	rated voltage	24V	24V	36V	36V	36V	36V	36V	48V
	max output torque	9N.m	9N.m	9N.m	9N.m	15N.m	15N.m	15N.m	17N.m
Charger parameters	input voltage	AC110-240V	AC110-240V	AC110-240V	AC110-240V	AC110-240V	AC110-240V	AC110-240V	AC110-240V
	input current	2A	2A	2A	2A	2A	2A	2A	2A
	charging time	4-4.5 hours	4-4.5 hours	4-4.5 hours	4-4.5 hours	4-4.5 hours	5-7 hours	5-7 hours	5-7 hours

Attention: Specific parameters should according to the actual product

Scope of Warranty

Under normal usage, if the electric scooters are damaged with the following list of parts within the warranty period, please contact our company or dealer, we will provide complete sales within the warranty period.

Components	Problem	Warranty	Service	Service Record
Motor	Cannot function under normal usage	1 year	Free	
Controller	Cannot function under normal usage	1 year	Free	
Charger	Cannot function under normal usage	1 year	Free	
Lithium Battery	Cannot function under normal usage	1 year	Free	
Display and Throttle	Cannot function under normal usage (not cause by crash)	6 months	Free	
Body Frame	under normal usage (Frame bend, crack)	1 year	Free	

Note: Please follow instruction provided and use this scooter correctly. We will not hold any responsible for any cause under not normal usage.

What Does This Limited Warrenty Not Cover?

This limited warrent does not cover any problem that is caused by:

- 1.Commercial use, accident, abuse, neglect, shoct, heat or humidity beyond product specifications, improper installation, operation, maintenance or modification.
- 2.Any misuse contrary to the instructions in the user manual
- 3.Malfunctions caused by other equipment

This limited warrent is void if a product is returned with removed, damaged or tempered labels of any alterations (including the unauthorized removal of any component or external cover).

What Do You Have To Do?

We Will not provide any warrenty coverage unless your claim is in compliance with all terms of this limited warrenty statement and you follow proper return procedure.

To request warrenty service, you may contact with an authorized Joyor retailer or reseller.