







Feel free to share your photos and videos with us
and we might put them on our website. 

-  [Facebook.com/FreevisionVILTA](https://www.facebook.com/FreevisionVILTA)
-  [Twitter.com/FreeVisionVILTA](https://twitter.com/FreeVisionVILTA)
-  [instagram.com/freevision_vilta](https://www.instagram.com/freevision_vilta)

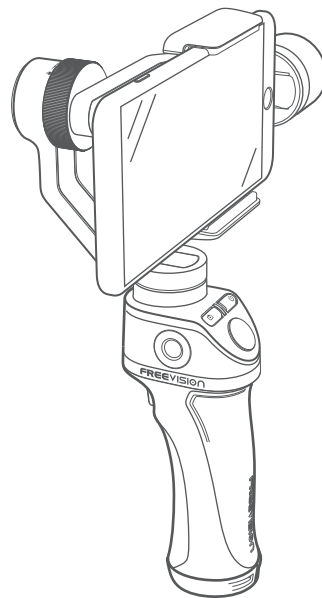

VILTA Mobile

User Manual

V1.0 2017.09

Contents

Overview	
Packing List	03
Product Overview	04
Quick Start	
App Installation	05
Smartphone Installation and Balance	06
App Connection	09
Start Up	
Control Panel Introduction	10
App Menu Introduction	15
App Operation	17
Specifications	
Specifications Parameter	20
Technical Parameter	20
Other Specification	21
Warranty Information	23

Packing List

- VILTA Mobile



- Portable Bag



- Charging Cable



- Lanyard



- User Manual



Product Overview

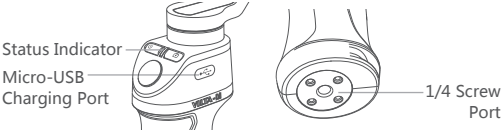
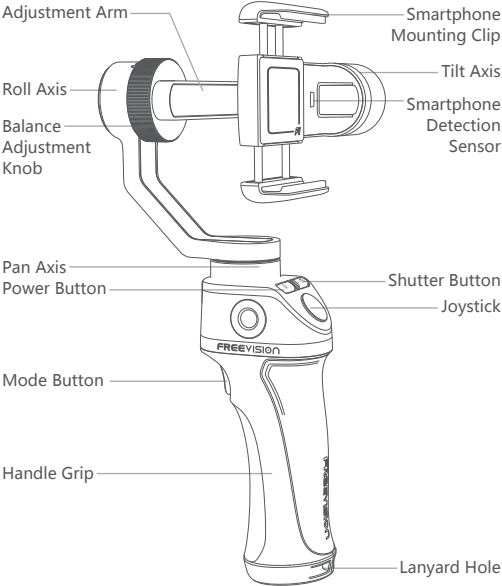

App Installation

- Download App on Freevision's official website www.freevisiontech.com.
- For iOS user, search "FV Share" in App Store.



- For Android user, search "FV Share" in Google Play or scan below QR Code



- Android 4.3 above or iOS 9.0 above required.

Smartphone Installation & Balance



- VILTA Mobile won't work unless mounting the phone. Smartphone detection can be closed in App.
- Always keep your phone well balanced in level prior to power on, or it will greatly affect working performance.

01 Smartphone Installation

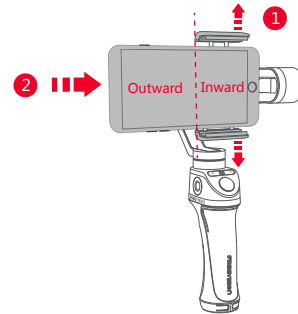

- 1 Pull open the smartphone mounting clip.
- 2 Put your phone in and keep it close to the tilt axis motor.



- Please ensure back camera of phone is outward and not covered.

02 Smartphone Balance

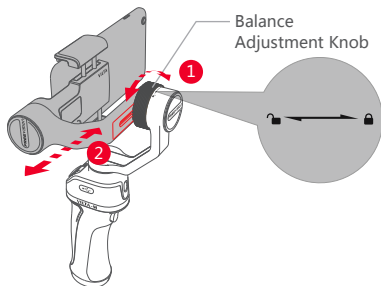

- 1 Unscrew the balance adjustment knob.
- 2 Slightly move the adjustment arm.

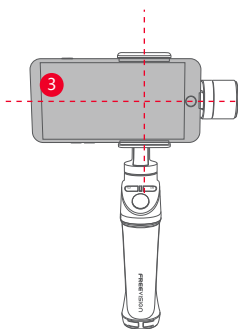

- 3 When your phone can stay level and balanced, screw up the balance adjustment knob.



Write scale of adjustment arm for easy reuse.

03 Power On/Off

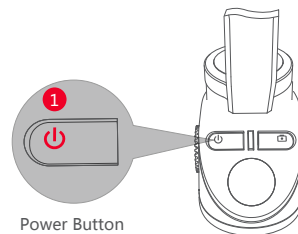

- 1 Long press power button for 3 seconds to power on/off.
Single tap power button to bring in/out of sleep mode.



If system halted, long press power button for 7.5 seconds to mandatory shutdown.

App Connection

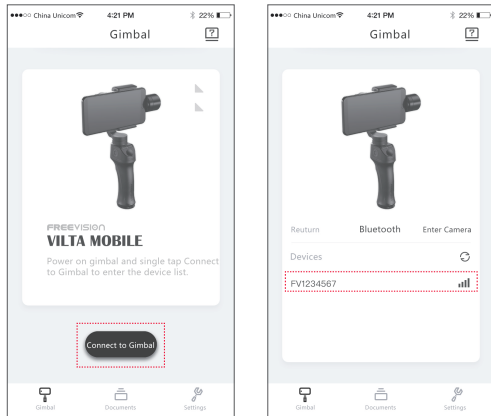

- Turn on bluetooth and unlock the phone screen rotation. Ensure phone can be displayed horizontally.
- Open App, tap Connect to enter the device list. Choose your gimbal to connect.
- The light of shutter button will go out after successfully connected.

Control Panel Instruction

01 Shutter Button

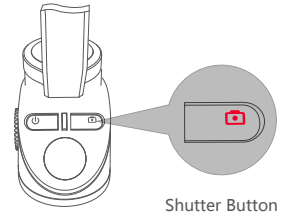

Shutter Button

Single Tap	Photo Mode	Take Photo
Double Tap	Selfie Mode	Front & Back Camera Switch
Long Press for 2s	Video Mode	Recording On/Off

02 Status Indicator

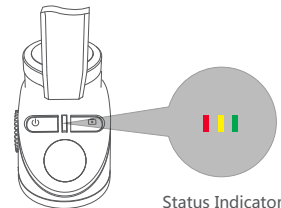

Status Indicator

Red light glints	Warning (Abnormal Condition)
Green light glints	Busy/Auto Calibration



Abnormal conditions of VILTA Mobile include absence of phone, motor damage, internal fault, etc.

03 Mode Button

Mode Button



- Semi-follow Mode (default)
Single tap Mode Button
Status Indicator is yellow

Tilt and Roll Axes are locked.
Pan Axis smoothly moves
with handle.

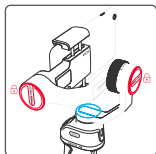

- Follow Mode
Double tap Mode Button
Status Indicator is red

Roll Axis is locked. Pan and
Tilt Axes smoothly move with
handle.

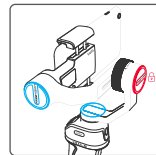

- Lock Mode
Quadruple tap Mode Button
Status Indicator is green

Tilt, Roll and Pan Axes are
locked. Smartphone always
keeps the current shooting
direction.

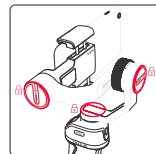

- Center the smartphone
Triple tap Mode Button

The smartphone returns
to the front.

- Focusing
Long press Mode Button.



04 Joystick

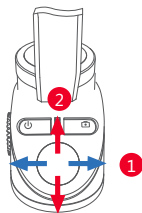

Basic Function

- 1 When toggling joystick to left or right, VILTA Mobile will rotate corresponding level direction.
- 2 When toggling joystick upward or downward, VILTA Mobile will rotate corresponding vertical direction.



Direction of control can be modified in App.

Advanced Function

- Zoom—Long press mode button and toggle joystick upward or downward.
- Exposure—Long press mode button and toggle joystick left or right.
- Roll Axis Angle—Long press mode button and toggle joystick left or right.



Adjustment of exposure and roll axis angle can be switched in App.

05 Micro-USB Charging Port



- When charging, status indicator alternately glints in red, yellow and green.
- When fully charged, the status indicator is green.
- Please apply charging cable with standard configuration to charge VILTA Mobile.
- When the power button glints, please charge VILTA Mobile.



When the charging current is 2A, it takes 2.0 hours to be fully charged, which allows 17 working hours. Datum come from laboratory test.

Phone Charge

Please use OTG cable and charging cable to charge your phone.

OTG cable is not included in official packing list.
Please purchase differently.

06 Manual

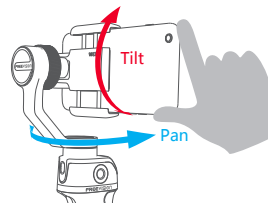

Directly adjust the shooting direction by hand. Manual mode can be turned off in VILTA Mobile App.

App Menu Introduction

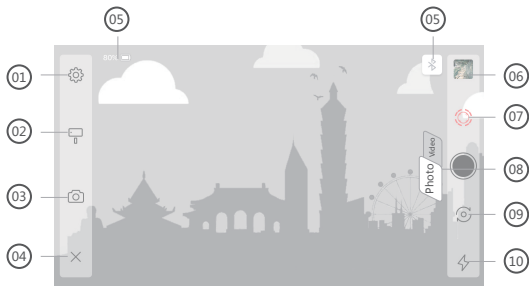

01 General Settings

- **Camera**
Video Resolution, Panorama Quality
- **Gimbal**
Rotation Speed Settings, Dead Zone Settings, Mode Button+Toggle Joystick, Phone Detection, Gimbal Calibration, Reset All
- **Joystick**
Sensitivity, Speed, Dead Zone, Direction
- **Information**
Gimbal Battery Information, Gimbal Information, App

02 Gimbal Settings

- **Scene Modes:**
Walk Mode, Sport Mode, Custom Mode

- **Follow Modes:**
Follow Mode, Semi-follow Mode, Lock Mode

- **Manual Mode**

03 Camera Settings

- **Camera Mode:**
Time-lapse, Panorama, Long Exposure, Beauty, HDR, Filter, White Balance, Grid
- **Video Mode:**
Slow Motion, Beauty, Filters, Time Lapse, Motion Time Lapse, Motion Lapse, White Balance, Grid

04 Return

Tap X to return to App home page

05 Information

Gimbal Battery, Bluetooth Connection Status

06 Documents

Preview and storage location of photos and videos.

07 IntelliTrace

Tap  to turn on IntelliTrace. Tap  to turn off IntelliTrace. Frame the subject and VILTA Mobile will track in real time.



Answering a phone when recording or in IntelliTrace, the shooting will be automatically stopped.





08 Photo/Video Switch

Tap  to switch

09 Front/Back Camera Switch

Tap  to switch

10 Flashlight Status

- Display the current flashlight status
- Tap  to switch working state    

App Operation





Photo Mode

01 Panorama



Tap  to enter panorama. Choose 180°, 330°, 3*3, 3*5, VILTA Mobile will automatically shoot and compund panorama. Photo will be automatically saved to documents.

Video Mode

01 IntelliTrace

1. Tap  and choose sport mode in scene mode.
2. Tap  to start IntelliTrace. Frame the subject on your phone screen.
3. Tap  to start recording. VILTA Mobile wil intelligently identify and automatically track the subject to take video.
4. Tap  to exit recording. Tap  to exit IntelliTrace. Video will be automatically saved to documents.

02 Time Lapse

1. Switch to video mode. Tap  and choose time lapse.
2. Set shutter interval and time of duration. Tap Start.
3. Tap  to exit recording. Video will be automatically saved to documents.

03 Motion Time Lapse

1. Switch to video mode. Tap  and choose motion time lapse.
2. Set shooting points

Auto Mode



- Manually adjust phone to ideal shooting point. Take photo at that direction and it will be shown as shooting point A on App. Likewise, the rest shooting points can be done in the same approach.
- According to the shooting points, VILTA Mobile will automatically generate shooting path.
- Adjust smoothness of the shooting path.

Manual Mode



- Freely set the shooting path by directly drawing on your phone screen.
3. Set shutter interval and time of duration. Tap Start.



04 Slow Motion Video

- 1. Tap  and open Slow Motion.
- 2. Tap  to start recording. Tap  to exit recording. Videos will be automatically saved to documents.

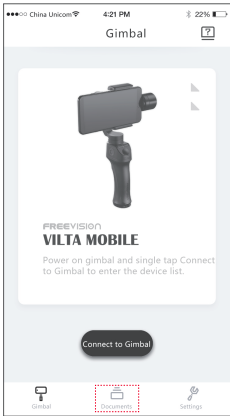

11 Photo/Video Editing



1. Photo Editing

- Enter App home page and tap  on the bottom
- Tap  to choose the photo and editing (Filter, Beautify, Adjust, Mosaic, Crop, Paint)
- Tap  to confirm editing

2. Video Editing

- Enter App home page and tap  on the bottom. Choose Videos
- Tap  to choose the video and editing (Add Video, Video Editing, Add Music, Filter, Adjust)
- Tap  to confirm editing

Specifications Parameter

Name	VILTA Mobile
Item No.	VT10
Dimensions	275*115*40mm (Folded)
Weight	520g
Supported Phones	Phones Width: 48 ~ 85mm

Technical Parameter

01 Mechanical Rotation Range

Tilt	±125°
Roll	±90°
Pan	360°(Infinite Rotation)

02 Controllable Rotation Range

Tilt	±115°
Roll	±45°
Pan	360°(Infinite Rotation)

03 Maximum Control Speed Adaptive Rotation Speed (±500°/s)

04 Accuracy

Static Accuracy	Dynamic Accuracy
Tilt: 0.003°	Tilt: 0.02°
Roll: 0.003°	Roll: 0.02°
Pan: 0.005°	Pan: 0.03°

05 Battery

Battery Type	Intelligent Lithium Battery
Voltage	7.4V
Working Current	Static: 100mA Dynamic: 5A
Battery Capacity	1900mAh
Energy	14.06Wh
Consumption	1W

Other Specification

Operating Temperature	-5°C~40°C
Wifi Type	Bluetooth 4.2

Warning

- Do not expose to fire or high heat
- Drop and collision will break VILTA. Please caution.
- Not water-proof. No water or liquid cleaning agent.
- Do not disassemble, repair or modify VILTA Mobile.
- Please apply charging cable complying with public safety regulation.
- Do not interfere VILTA Mobile operation when working.
- Not suitable for children.
- Not include smartphones.
- When mounting motion cameras, close the smartphone detection in App, or VILTA Mobile will not work.
- The lock button backward will be open in future as it is a reserved button for upgraded function. Now it can't be toggled.

Warranty Rules

From the purchase date, you enjoy free repair within 12 months with this card if it occurs any quality problems.

If your VILTA Mobile meets the following requirements, you can enjoy the warranty policy :

- If within 7 days of purchase and it occurs manufacturing defect, the customer can choose to have a full refund(based on the invoice price) or exchange the product for a new one;
- Within 1year of purchase, you can enjoy free repair if it is non man-made problem,
- The Product has not been refitted, dissembled or modified.
- Valid purchase proof is provided

Non Warranty Rules

If your VILTA Mobile falls under one of the following situations, we will charge appropriate maintenance cost :

- A man-made problem affecting the quality or product;
- Damage caused by refitting, disassemble, or opening of the shell;
- An uncontrollable incident (earthquake, fire, flood, war) resulting damage;
- Damage caused by not using as stated in the user manual

Warranty Information

- The customer is at first required to pay the product return delivery fee. After Freevision after-sale service center receives the product, it will undergo a test ;
- If the product does not conform to the conditions for free repair, Freevision will assess the problem and cost of repair, the customer has the right to repair or deliver it back.
- When you receive the repair service, please provide valid purchase proof and this warranty card. Please note: the warranty card only becomes valid after sale. The card can not be altered, or it will be deemed invalid.
- Freevision reserves the right of final interpretation.

Customer Information

Name: _____

TEL: _____

Zip Code: _____

Email: _____

Address: _____

Dealer Information

Name: _____

TEL: _____

Zip Code: _____

Email: _____

Address: _____

Product Information

Item No.: _____

Product Code: _____

Purchase Date: _____

Warranty Card

							Inspection Date
							Repair Date
							Cause
							Result
							Technician Signature

IC WARNING

ISED RSS warning

This device complies with Industry Canada licence-exempt RSS standard (s). Operation is subject to the following two conditions:
(1) this device may not cause interference, and
(2) this device must accept any interference,including interference that may cause undesired operation of the device.

Le présent appareil est conforme aux CNR d'Industrie Canada applicables aux appareils radio exempts de licence.
L'exploitation est autorisée aux deux conditions suivantes:

- (1) l'appareil ne doit pas produire de brouillage, et
- (2) l'utilisateur de l'appareil doit accepter tout brouillage radioélectrique subi, même si le brouillage est susceptible d'en compromettre le fonctionnement.

FCC WARNING

ISED Radiation Exposure Statement:

This equipment complies with ISED RF radiation exposure limits set forth for an uncontrolled environment. This transmitter must not be co-located or operating in conjunction with any other antenna or transmitter.

This equipment should be installed and operated with minimum distance 20cm between the radiator & your body.

Cet appareil est

conforme aux limites d'exposition de rayonnement RF ISED établies pour un environnement non contrôlé.

Cet émetteur ne doit pas être co-implanté ou fonctionner en conjonction avec toute autre antenne ou transmetteur.

Le matériel doit être installé et utilisé avec une distance minimale de 20cm entre le radiateur & votre corps.

Any Changes or modifications not expressly approved by the party responsible for compliance could void the user's authority to operate the equipment.

This device complies with part 15 of the FCC Rules.

Operation is subject to the following two conditions:

- (1) This device may not cause harmful interference, and
- (2) this device must accept any interference received, including interference that may cause undesired operation.

FCC Radiation Exposure Statement:

This equipment complies with FCC radiation exposure limits set forth for an uncontrolled environment. This equipment should be installed and operated with minimum distance 20cm between the radiator & your body.

This transmitter must not be co-located or operating in conjunction with any other antenna or transmitter.

Note

This equipment has been tested and found to comply with the limits for a Class B digital device, pursuant to part 15 of the FCC Rules. These limits are designed to provide reasonable protection against harmful interference in a residential installation. This equipment generates uses and can radiate radio frequency energy and, if not installed and used in accordance with the instructions, may cause harmful interference to radio communications. However, there is no guarantee that interference will not occur in a particular installation. If this equipment does cause harmful interference to radio or television reception, which can be determined by turning the equipment off and on, the user is encouraged to try to correct the interference by one or more of the following measures:

- Reorient or relocate the receiving antenna.
- Increase the separation between the equipment and receiver.
- Connect the equipment into an outlet on a circuit different from that to which the receiver is connected.
- Consult the dealer or an experienced radio/TV technician for help.

CE RoHS**FREEVISION VILTA**

Moving Stories. Revolutionary Visions.

www.freevisiontech.com 