

# Smoothie Maker

## User guide

EN



**SENCOR®**

SBL 2310

Before using this appliance, please familiarize yourself with its user guide, even if you are already familiar with using similar appliances. Use the appliance only as described in the user guide. Keep the guide for later use.

At least for the duration of the legal claim period or warranty period, we recommend storing the original transport carton, packing material, sales receipt and confirmation of seller's responsibility or the warranty certificate. In the event of transport, we recommend packing the appliance back into the manufacturer's original box.

**CONTENTS**

IMPORTANT SAFETY INSTRUCTIONS .....	3
DESCRIPTION OF THE APPLIANCE .....	6
INTENDED USE AND FUNCTIONS OF THE APPLIANCE.....	7
BEFORE FIRST USE .....	7
ASSEMBLING AND DISMANTLING THE APPLIANCE.....	7
USING THE APPLIANCE .....	8
QUICK GUIDE TO PROCESSING INGREDIENTS.....	8
CLEANING AND MAINTENANCE.....	9
STORAGE.....	9
TECHNICAL DATA .....	10
INSTRUCTIONS AND INFORMATION ON DISPOSING OF USED PACKAGING .....	10
DISPOSAL OF USED ELECTRICAL AND ELECTRONIC EQUIPMENT.....	10

## **IMPORTANT SAFETY INSTRUCTIONS READ CAREFULLY AND STORE FOR FUTURE USE.**

- This appliance may be used by persons with physical or mental impairments or by inexperienced persons, if they are properly supervised or have been informed about how to use the product in a safe manner and understand the potential dangers.
- Children must not use this appliance or play with it. Keep this appliance and the power cord out of reach of children.
- This appliance is intended for home use. It is not intended for use in locations such as:
  - staff kitchens in stores, offices and other workplaces;
  - agricultural farms;
  - hotel or motel rooms and other living areas;
  - bed and breakfast establishments.
- This appliance is designed for blending food. Do not use it for any other purposes than those intended.



### **Warning:**

Incorrect use may lead to injuries.

- Do not use the appliance in an industrial environment or outdoors.
- Do not place the appliance on an electric or gas stove or in its vicinity, on the edge of a table or on an unstable surface. Only place the appliance on an even, dry and stable surface.
- Before connecting this appliance to a power socket, make sure the voltage stated on its rating label corresponds to the voltage in your power socket.
- Only use the appliance with the original accessories that came with it.
- Do not fill the blending jar past its maximum nominal capacity.

- Make sure that the appliance is correctly assembled before putting it into operation. The appliance is equipped with a safety mechanism that will prevent it from being started unless the removable accessories are seated on the motor unit.
- Do not turn on the appliance when it is empty. Incorrect use of the appliance may negatively affect its lifetime.
- Pay increased attention when handling hot liquids, because they may release steam or they could spray and cause burns. Allow hot liquids to cool down to a temperature of at least 50 °C before pouring them into the blending jar.
- Do not leave the appliance in continuous operation for longer than 3 minutes. Before turning it on again, allow it to cool down for at least 10 minutes. When processing harder foods or thick liquids, do not leave the appliance in continuous operation for longer than 1 minute.
- The appliance is equipped with a thermal fuse protecting the motor from damage in case of overload. If the appliance shuts off as a consequence of the motor being overloaded, disconnect it from the power socket and allow it cool for at least 30 minutes. Then you can put into operation again.
- If ingredients stick to the blade assembly or the inside walls of the blending jar, turn the appliance off and unplug it from the power supply. Make sure that the blade assembly has stopped rotating. Take the blending jar assembly off the motor unit and turn it over so that the blade assembly points upwards. Remove the blade assembly and clean the removed parts using a plastic spatula. Assemble the appliance, plug the power cord into a power socket and continue blending.
- When handling the blade assembly, be very careful not to injure yourself on its sharp cutting edge. This applies especially when removing the blade assembly from the blending jar, when emptying the jar and when cleaning.

- The included blending jars are not intended for heating food in a microwave oven.
- Always turn off the appliance and disconnect it from the power socket if you will not be using it and if you will be leaving it without supervision, before assembly, disassembly, replacing accessories and before cleaning or moving it.
- Check that the motor unit is turned off, disconnected from the power socket and that the rotating parts have come to a complete stop before removing the blending jar assembly from the motor unit.
- Clean it according to the instructions in chapter Cleaning and maintenance. Do not submerge the motor unit or its power cord in water or any other liquid, or wash these parts under running water.
- Do not place heavy items on the power cord. Make sure that the power cord does not hang over the edge of a table or that it is not touching a hot surface.
- Disconnect the appliance from the power socket by pulling on the plug, never pulling on the power cord. Otherwise, this could damage the power cord or the socket.
- If the power cord is damaged, it must be replaced by an authorised service centre or by another similarly qualified person, this will prevent the creation of a dangerous situation.
- Do not use the appliance when it is not functioning properly or showing any signs of damage. In order to prevent a hazardous situation arising, do not repair the appliance yourself or modify it in any way. Have all repairs performed at an authorised service centre. By tampering with the appliance, you risk voiding your legal rights arising from unsatisfactory performance or quality warranty.

## DESCRIPTION OF THE APPLIANCE

A

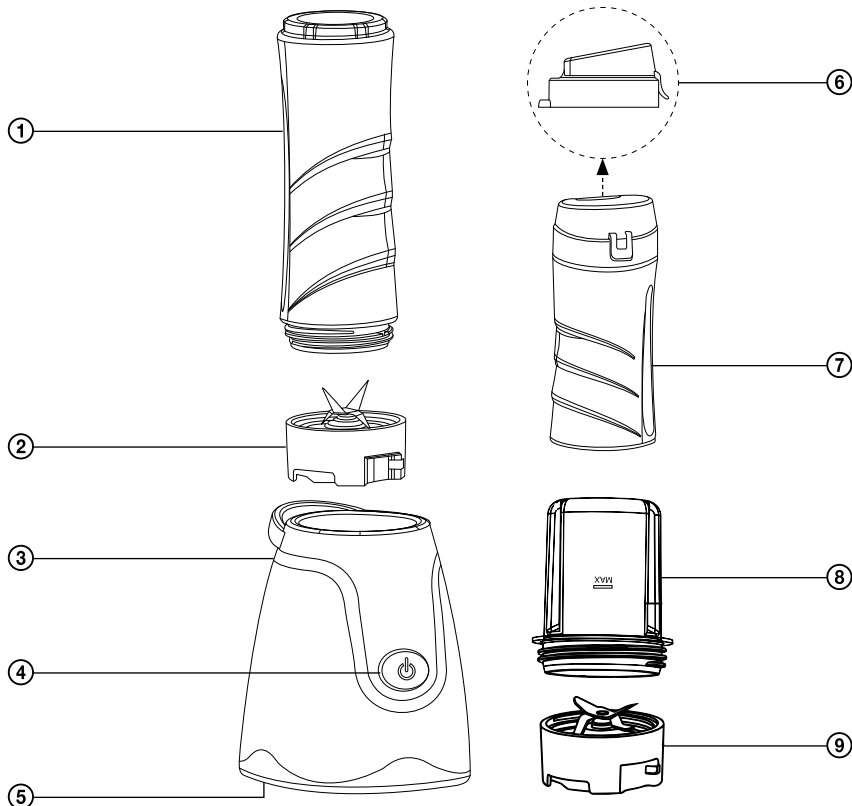

- ① The large 600 ml blending container is made of durable PVC plastic and also serves as a drinking bottle.
- ② Blade unit with four blades made of high-quality stainless steel
- ③ Motor unit
- ④ The pulse switch is for turning the motor unit on and off.
- ⑤ Anti-slip feet

- ⑥ The screw cap with spout can be screwed onto both drinking bottles.
- ⑦ The small 300 ml blending container is made of durable PVC plastic and also serves as a drinking bottle.
- ⑧ Universal Grinder for Herbs, Spices, Coffee and Nuts
- ⑨ Blade Unit for Universal Grinder

## INTENDED USE AND FUNCTIONS OF THE APPLIANCE

- This Smoothie Maker is ideal for preparing fresh fruit or fitness drinks, dairy and other sorts of cocktails, mixed drinks, excellent salsa, cream soups, sauces and mixed baby foods. It is equipped with a blade unit with four high-quality stainless-steel blades and a blending containers of two sizes, which are made of sturdy PVC plastic and also serve as a practical drinking bottle. The lid has a closable spout to allow easy carrying with no spilling. Both bottles fit perfectly into a car cupholder. Anti-slip feet with suction cups ensure excellent stability when the Smoothie Maker is in use. The bottle, lid and blade unit are dishwasher safe.

## BEFORE FIRST USE

1. Remove the appliance and its accessories from the packaging.
2. Thoroughly wash all removable parts intended for contact with food (large blending container A①, small blending container A⑦, lid A⑥ and the blade unit A②) in warm water with a neutral dish detergent. Then rinse them with clean water and let them dry or thoroughly dry them with a soft towel.



### Warning:

When cleaning the blade unit A②, be extra cautious to avoid injury. The blade edges A② are sharp.

## ASSEMBLING AND DISMANTLING THE APPLIANCE

- Before you begin to assemble or disassemble the appliance, make sure the motor unit A③ is turned off and unplugged from the wall outlet and the rotating parts are not in motion.
1. **Assembling and dismantling the blending container**
    - 1.1 Turn blending container A① or A⑦ so that its neck points upward.
    - 1.2 Place the blade unit A② against the neck of container A① or A⑦ so that the blades point into A① or A⑦. Screw the blade unit A② onto the neck of container A① or A⑦. Turn the assembled container downward with the blade unit A②.



### Note:

Put food and liquids into container A① or A⑦ before you attach the blade unit to it A②.

- 1.3 To dismantle, proceed in the opposite order.
2. **Attaching and removing the blending container from the motor unit**
  - 2.1 Place the motor unit A③ on a flat, dry surface, such as a kitchen counter. Onto the motor unit A③, place the blending container so that the arrow indicator on the blade unit A② lines up with the arrow on the motor unit A③. Turn the blending unit clockwise until it attaches firmly to the motor unit A③. If the blending container assembly is correctly attached to the motor unit A③, it cannot be lifted separately.
  - 2.2 To remove the blending container from the motor unit A③, proceed in the opposite sequence.
3. **Assembling the drinking bottle**

To assemble the drinking bottle, screw the lid A⑥ onto the neck of bottle A① or A⑦. Firmly tighten the lid A⑥. When carrying, make sure the spout is properly closed, so that the bottle's contents do not spill.

## USING THE APPLIANCE

1. Make sure that the motor unit A③ is turned off and unplugged.
2. Put the ingredients you want to mix into blending container A① or A⑦. We recommend putting the food into container A① or A⑦ in the order shown in the chapter "Quick guide to processing ingredients". Containers A① and A⑦ can hold food up to the 600 ml or 300 ml line. Do not put more food and liquid into container A① or A⑦.



### Warning:

Before pouring hot liquids into blending containers A① or A⑦ and blending them, let them cool to at least 40°C.

3. Assemble the blending container and then attach the blending container assembly to the motor unit A③ according to the instructions in the chapter "Assembling and dismantling the appliance".
4. Plug the power cable in and press the pulse switch A④ to start the smoothie maker. Press and hold switch A④ for as long as you want to mix. To turn the smoothie maker off, let up on switch A④.



### Warning:

The maximum operating time is 2 minutes. Do not let the appliance run continuously longer than the time indicated above. Then let the appliance cool for 2 minutes. When processing thicker foods or liquids, do not let the appliance run for more than 1 minute.

5. If food sticks to the blade unit A② or to the wall of the blending container A① or A⑦, turn the appliance off and unplug it. Make sure that the blade unit A② has stopped turning. Remove the container set from the motor unit A③ and turn it so that the blade unit A② points upward. Remove the blade unit A②. Use a plastic spatula to clean the blade unit A② and wall of container A① or A⑦. Put the blending container together and attach it back to the motor unit A③. Plug the cord in and continue blending.
6. After blending is finished, unplug the power cable. Make sure that the blade unit A② has stopped turning, and remove the blending container assembly from the motor unit A③.
7. Turn blending container A① or A⑦ so that the blade unit A② points upward. Remove the blade unit A② and, if necessary, close bottle A① or A⑦ with the lid A⑥ or pour the contents into another appropriate container.
8. Clean all parts used according to the instructions in the chapter "Cleaning and maintenance".

## QUICK GUIDE TO PROCESSING INGREDIENTS

- For optimal blending results, put the ingredients in blending container A① or A⑦ in the following order: liquids, fresh fruit, frozen fruit, yogurt and ice cream.
- First cut solid foods, such as fruit or vegetables, into smaller pieces of about 1 in (2.5 cm) and then mix them.
- This smoothie maker is not intended for mashing potatoes, blending dough, whipping egg whites or grinding raw meat.

Ingredients	Recommended blending time
Fruit and vegetables cut into smaller pieces	30 s
Smoothies and cocktails	40 s
Salsa	30 s
Soups	30 s
Baby food, side dishes	40 s



# Smoothie Maker

SBL 2310

EN

## Grinder

Ingredients	Speed selection	Recommended mixing time
Nuts (with shells removed)	P (Pulse level)	–
Coffee beans	P (Pulse level)	–



### Note:

The listed processing times are only for orientation. Actual blending time depends on the size of the food, the amount, and the desired final consistency.

## CLEANING AND MAINTENANCE

- Before cleaning, make sure the appliance is shut off and unplugged. Disassemble the appliance into its separate parts. Before disassembly, make sure the rotating parts have stopped.
- Thoroughly wash the blade unit A② and the emptied blending container A① or A⑦ in warm water with a neutral dish detergent. Then rinse these parts under clear running water, dry them with a soft towel or let them air dry. If you have used the lid A⑥, clean it in the same way. We recommend washing all parts immediately after use, so that food does not stick. Dried food is hard to remove. The blade unit A②, bottles A① and A⑦ and the lid A⑥ are all dishwasher safe.



### Warning:

When removing and cleaning the blade unit A②, be extra cautious to avoid injury. The blade edges A② are sharp.

Some foods may discolor blending containers A① and A⑦. However, this does not affect the operating of the appliance.

- To clean the outer surface of the motor unit A③ use a cloth soaked in a weak detergent solution. After applying the detergent, dry the surface with a cloth moistened with clean water, and then wipe it dry.
- Never immerse the motor unit A③ or power cable into water or any other liquid. When cleaning the appliance, do not use solvents, paint thinners or abrasive cleaners. This may damage the surface of the appliance.

## STORAGE

- When you are not using the appliance, store it in a clean, dry place out of the reach of children.

## TECHNICAL DATA

Rated voltage range .....	220–240 V
Rated frequency .....	50/60 Hz
Rated power .....	500 W
Protection class (against electric shock) .....	II
Noise .....	85 dB (A)

This appliance's declared noise emission value is 85 dB(A), which represents acoustic output level A in regard to the reference acoustic output 1 pW.

### Glossary of technical terms

#### Level of protection against electric shock:

Class II - Electric shock protection is provided by double or reinforced insulation.

We reserve the right to change text and technical parameters.

## INSTRUCTIONS AND INFORMATION ON DISPOSING OF USED PACKAGING

Dispose of used packaging at a designated waste disposal facility.

## DISPOSAL OF USED ELECTRICAL AND ELECTRONIC EQUIPMENT



This symbol on products or original documents indicates that used electrical and electronic equipment is not to be discarded with ordinary municipal waste. For proper disposal, recovery and recycling, take these products to designated collection points. Alternatively, in some countries of the European Union or other European countries, you can return your products to your local retailer when purchasing equivalent new products.

Correct disposal of this product helps save valuable natural resources and helps prevent potential negative effects on the environment and human health that would result from improper disposal. For more details, contact your municipal office or the nearest collection site.

Improper disposal of this type of waste may be subject to fines under national regulations.

#### For business entities in the European Union

To dispose of an electrical or electronic equipment, request the necessary information from your retailer or supplier.

#### Disposal in countries outside the European Union

This symbol is valid in the European Union. To dispose of this product, request the necessary information on the correct disposal method from your municipal office or retailer.



This product meets all the basic requirements of the EU directives that apply to it.