

ONKYO

SPEAKER SYSTEM

D-165

Instruction Manual

Thank you for purchasing an Onkyo Speaker System. Please read this manual thoroughly before using it. Following the instructions in this manual will enable you to obtain optimum performance and listening enjoyment from your new Speaker System. Please retain this manual for future reference.

Safety Information

WARNING

TO PREVENT THE RISK OF ELECTRIC SHOCK, DO NOT REMOVE COVER (OR BACK). NO USER-SERVICEABLE PARTS INSIDE. REFER SERVICING TO QUALIFIED SERVICE PERSONNEL.

This equipment is not waterproof. To prevent a fire or shock hazard, do not place any container filled with liquid near this equipment (such as a vase or flower pot) or expose it to dripping, splashing, rain or moisture.

To prevent a fire hazard, do not place any naked flame sources (such as a lighted candle) on the equipment.

Store small parts out of the reach of children and infants. If accidentally swallowed, contact a doctor immediately.

Precautions

Important Notice

The model number and serial number of this equipment are on the rear or bottom. Record these numbers on your enclosed warranty card and keep in a safe place for future reference.

This product is for general household purposes. Any failure due to use for other than household purposes (such as long-term use for business purposes in a restaurant or use in a car or ship) and which requires repair will be charged for even during the warranty period.

The Safety of Your Ears is in Your Hands

Get the most out of your equipment by playing it at a safe level – a level that lets the sound come through clearly without annoying blaring or distortion and, most importantly, without affecting your sensitive hearing. Sound can be deceiving. Over time, your hearing “comfort level” adapts to higher volumes of sound, so what sounds “normal” can actually be loud and harmful to your hearing. Guard against this by setting your equipment at a safe level BEFORE your hearing adapts.

Be Sure To Observe The Following Guidelines:

- Do not turn up the volume so high that you can't hear what's around you.
- Use caution or temporarily discontinue use in potentially hazardous situations.
- Do not use headphones while operating a motorized vehicle; the use of headphones may create a traffic hazard and is illegal in many areas.

Establish a Safe Level:

- Set your volume control at a low setting.
- Slowly increase the sound until you can hear it comfortably and clearly, without distortion.
- Once you have established a comfortable sound level, set the dial and leave it there.

For European models

Information for users on collection and disposal of old equipment and used batteries

(Symbol for equipment)



(Symbol examples for batteries)



Pb

These symbols on the products, packaging, and/or accompanying documents mean that used electrical and electronic products and batteries should not be mixed with general household waste.

For proper treatment, recovery and recycling of old products and used batteries, please take them to applicable collection points in accordance with your national legislation.

By disposing of these products and batteries correctly, you will help to save valuable resources and prevent any potential negative effects on human health and the environment which could otherwise arise from inappropriate waste handling.

For more information about collection and recycling of old products and batteries, please contact your local municipality, your waste disposal service or the point of sale where you purchased the items.

These symbols are only valid in the European Union.

For countries outside the European Union:

If you wish to discard these items, please contact your local authorities or dealer and ask for the correct method of disposal.

WEEE

<http://www.onkyo.com/manual/weee/weee.pdf>

Speaker Precautions

Placement

- The speaker cabinets are sensitive to extreme temperatures and humidity, do not put them in locations subject to direct sunlight or in humid places, such as near an air conditioner, humidifier, bathroom, or kitchen.
- Do not put water or other liquids close to the speakers. If liquid is spilled over the speakers, the drive units may be damaged.
- Speakers should only be placed on sturdy, flat surfaces that are free from vibration. Putting them on uneven or unstable surfaces, where they may fall and cause damage, will affect the sound quality.
- If the unit is used near a turntable, CD player or DVD player, howling or slipping of sound may occur. To prevent this, move the unit away from the turntable, CD player or DVD player otherwise lower the unit's output level.

Using Close to a TV or Computer

TVs and computer monitors are magnetically sensitive devices and as such are likely to suffer discoloration or picture distortion when conventional speakers are placed nearby. To prevent this, some speakers feature internal magnetic shielding.

Note that discoloration can also be caused by a magnet or demagnetizing tool that's too close to your TV or monitor. Check the speaker specification to see if your speakers are magnetic shielded or not.

For non-magnetic shielded speakers:

Try moving the speakers away from your TV or monitor. If discoloration should occur, turn off your TV or monitor, wait 15 to 30 minutes, and then turn it back on again. This normally activates the degaussing function, which neutralizes the magnetic field, thereby removing any discoloration effects.

Input Signal Warning

The speakers can handle the specified input power when used for normal music reproduction. If any of the following signals are fed to them, even if the input power is within the specified rating, excessive current may flow in the speaker coils, causing burning or wire breakage:

1. Interstation noise from an untuned FM radio.
2. Sound from fast-forwarding a cassette tape.
3. High-pitched sounds generated by an oscillator, electronic musical instrument, and so on.
4. Amplifier oscillation.
5. Special test tones from audio test CDs and so on.
6. Thumps and clicks caused by connecting or disconnecting audio cables. (Always turn off your amplifier before connecting or disconnecting cables.)
7. Microphone feedback.

Before Using Your New Speakers

Precautions

In catalogs and on packaging, the letter at the end of the product name indicates the color. Specifications and operation are the same regardless of the color.

The speakers contain powerful magnets. Do not put metal items, such as screwdrivers, close to the speakers, as they damage to the tweeter diaphragm.

Getting to Know the Speakers

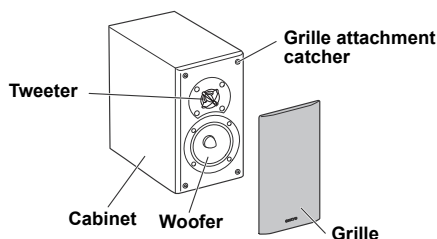

The two speakers are identical, so it doesn't matter which one you use on the left or right.

Removing the Grills

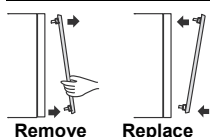

Using the Cork Spacers

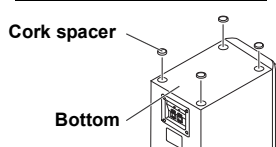

Connection the Speakers

- Before connecting the speakers, disconnect your amplifier's power cord from the wall outlet and set its volume control to minimum.
- The speaker's rated impedance is 4 Ω . Make sure you connect an amplifier that is compatible with a 4 Ω impedance.
- Use the supplied speaker cables to connect the speakers to your amplifier as shown.
- We will not accept responsibility for damage arising from the connection of equipment manufactured by other companies.

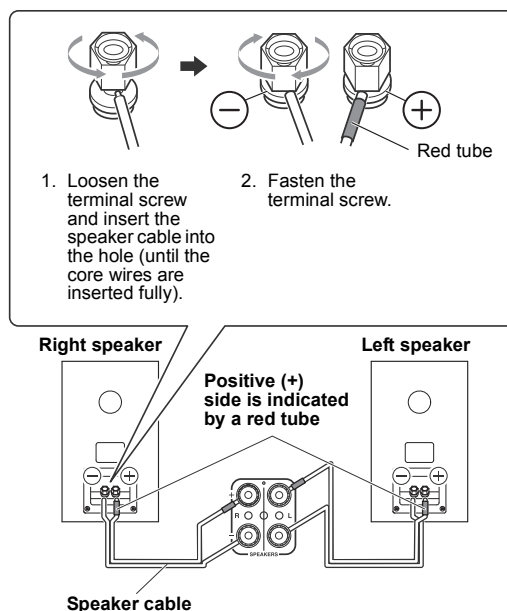

The type of speaker terminals used on the amplifier and their position depends on the model. Refer to the amplifier's instruction manual for details on connecting speakers to the amplifier.

- Make sure the speaker's positive (+) terminals are connected to the amplifier's positive (+) terminals, and the speaker's negative (-) terminals are connected to the amplifier's negative (-) terminals.
- Make sure that the positive (+) and negative (-) wires are not touching each other. If they are, a short circuit may occur, damaging your amplifier.



Specification

Type:	2-way bass reflex
Impedance:	4 Ω
Maximum input power:	120 W
Output sound pressure level:	84 dB/W/m
Frequency response:	50 Hz to 50 kHz
Crossover frequency:	2.5 kHz
Dimensions (W \times H \times D):	170 \times 283 \times 256 mm 6-11/16" \times 11-1/8" \times 10-1/16" (incl. grille and projection)
Weight:	4.3 kg (9.5 lbs.)
Speakers Woofer:	13 cm (5-1/8") N-OMF cone type
Tweeter:	3 cm (1-3/16") Ring type
Terminal:	Screw-type speaker terminal (Banana plug supported)
Grille:	Detachable
Accessories:	1.1 m (3.6 ft.) speaker cable \times 2 Cork spacer \times 8
Other:	Non magnetic shielding

* Specifications and appearance are subject to change without notice.

ONKYO

2-3-12 Yaesu, Chuo-ku, Tokyo 104-0028 JAPAN
<http://www.onkyo.com/>

<U.S.A.>

18 Park Way, Upper Saddle River, N.J. 07458, U.S.A.
For Dealer, Service, Order and all other Business Inquiries:
Tel: 201-785-2600 Fax: 201-785-2650
<http://www.us.onkyo.com/>

For Product Support Team Only:
1-800-229-1687
<http://www.us.onkyo.com/>

<Germany>

Gutenbergstrasse 3, 82178 Puchheim, Germany
Tel: +49-8142-4401-0 Fax: +49-8142-4208-213
<http://www.eu.onkyo.com/>

<UK>

Anteros Building, Odyssey Business Park, West End Road, South Ruislip, Middlesex,
HA4 6QQ United Kingdom
Tel: +44 (0)871-200-1996 Fax: +44 (0)871-200-1995
For Product Support only: +44 (0)208-836-3510
<http://www.uk.onkyo.com/en/>

<France>

6, Avenue de Marais F - 95816 Argenteuil Cedex FRANCE
For Product Support only: +33 969 368 138
<http://www.fr.onkyo.com/fr/>

<Hong Kong>

Unit 1033, 10/F, Star House, No 3, Salisbury Road, Tsim Sha Tsui Kowloon, Hong Kong.
Tel: +852-2429-3118 Fax: +852-2428-9039
<http://www.hk.onkyo.com/>

<PRC>

302, Building 1, 20 North Chaling Rd., Xuhui District, Shanghai, China 200032,
Tel: +86-21-52131366 Fax: +86-21-52130396
<http://www.cn.onkyo.com/>

<Asia, Oceania, Middle East, Africa>

Please contact an Onkyo distributor referring to Onkyo SUPPORT site.
<http://www.intl.onkyo.com/support/>

Корпорация О энд Пи
2-3-12, Яэсу, Чую-ку, г. Токио, 104-0028, ЯПОНИЯ

The above-mentioned information is subject to change without prior notice.
Visit the Onkyo web site for the latest update.

F1709-0

SN 29403255

(C) Copyright 2017 Onkyo & Pioneer Corporation Japan. All rights reserved.
Printed in China / Imprimé en Chine



* 2 9 4 0 3 2 5 5 *

ONKYO

SPEAKER SYSTEM

D-165

安装手册

感谢您购买一套日本安桥牌扬声器系统。在使用本扬声器系统之前，请认真阅读本手册。遵守本手册中的指示，您的新扬声器系统将具有最佳性能，您将会享受到声音的美妙。请保留本手册，以备将来查阅。

安全信息

警告

为避免触电危险，请勿拆卸盖子（或背面板）。机内没有可供用户自行修理的零部件。维修事宜交由有资格的维修人员进行。

本装置不具备防水性。为防止火灾或触电事故，请勿将任何装有液体的容器（如花瓶或花盆）安放在本装置附近，或将其暴露于滴水、飞溅、雨或湿气之中。

为防止火灾事故，请勿将任何明火源（如点燃的蜡烛等）安放在本装置上。

小部件应存放在儿童和婴儿触及不到的地方。如果不小心吞食，请立即就医。

注意事项

重要通知

本设备的型号和序列号位于后部或底部。请在随附的保修卡上记录这些编号并放在安全的位置供将来参考。

本产品只适宜一般家庭用途。如果是由于应用在其他非家庭用途（如做为商业用途而长期使用于餐厅中，或者使用于汽车或船中）而导致发生故障并需要修理，在保用期间必须承担修理费用。

为了能够正确处理、回收利用旧产品和旧电池，请依照所在国家的相关法规，将其送往相应收集点。

音箱的保养

放置

- 扬声器音响柜对极端温度和湿度敏感。请勿将其放置于易受阳光直射或潮湿处，如靠近空调，增湿器，浴室或厨房等。
- 严禁将水或其他液体放置在靠近音箱的地方。如果液体泼溅到音箱上，会造成驱动设备损坏。
- 音箱应放置在平坦牢固的表面，远离震动。将音箱放置在不平或不稳的表面，可能会导致滑落造成音箱受损，从而影响音质。
- 如果设备放置在靠近唱盘机，CD 播放器或 DVD 播放器的地方，会发出啸声或声音偏移。为防止这种情况发生，将设备放置在远离唱盘机，CD 播放器或 DVD 播放器的地方，或降低设备的输出音量。

靠近电视或计算机使用时

电视和计算机显示器是磁敏感设备，当附近放置普通扬声器时，很可能导致电视和计算机显示器退色或图像失真。为防止此类情况发生，某些扬声器采用内部磁屏蔽设计。请注意，距离电视或显示器过近的磁铁或消磁工具也会造成退色。检查您的扬声器规格，确认其是否为磁屏蔽扬声器。

非磁屏蔽扬声器：

试着将扬声器从电视或显示器旁移除。如果发生退色，关闭电视或显示器，等待 15 到 30 分钟后再重新开启。这样通常会激活消磁功能，抵消磁场，从而排除任何退色效应。

操作注意事项

音箱用于再现普通音乐时，可以处理指定的输入功率。如果以下的任何信号被输入到音箱，即使输入功率在额定频率内，也会对音箱线圈造成过量电流，出现着火或线路损坏。

1. 来自未调频的 FM 电台的台间干扰。
2. 磁带快进时发出的声音。
3. 震荡器，电子乐器等发出的高音调乐音。
4. 放大器震荡。
5. 音频测试 CD 等发出的特殊测试音调。
6. 由于连接或断开音频连线造成的噪音和卡哒声（在连接或断开连线前，请关闭您的功率放大器。）
7. 麦克风的回响。



产品上标有左侧的标记时，表示含有有毒有害物质的含量超过 GB/T26572-2011 规定的限量要求的部件，根据 SJ/T11364-2014 的标识要求，环境保护使用期限为 10 年。但是，遥控器中使用的电池等消耗品除外。有关含有的部位请参阅下表。根据产品机体上贴有的序号能够了解制作年份。序号的开头的数字表示制造年份。
例如，"17 SERIAL *****" 表示 2017 年制造。

有毒有害物质或元素名称及含量标识格式

○：表示该有毒有害物质在该部件所有均质材料中的含量均在 GB/T26572-2011 规定的限量要求下。 ×：表示该有毒有害物质至少在该部件的某一均质材料中的含量超出 GB/T26572-2011 规定的限量要求。						
部品名称	有毒有害物质或元素					
	Pb	Hg	Cd	Cr (VI)	PBB	PBDE
	铅	汞	镉	六价铬	多溴联苯	多溴二苯醚
扬声器产品 （× 表示部分扬声器产品的外部装饰方面和附属品内的端子、销钉含量超出 1000ppm。）						
外部装饰方面	×	○	○	○	○	○
安装电路板	○	○	○	○	○	○
附属品	×	○	○	○	○	○
包装品	○	○	○	○	○	○

用前须知

注意事项

在产品目录中或包装上，产品名称结尾字母表示产品颜色。颜色不同不影响产品规格及操作。

该扬声器内含强磁铁，不要把金属物品（例如螺丝刀）放在扬声器附近，以免损伤高频扬声器振动膜。

开始认识扬声器

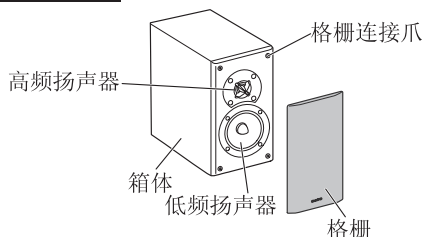

两个扬声器相同，因此，您在使用时左右两边放哪一个均可。

拆下格栅

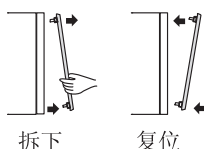

使用软木垫片

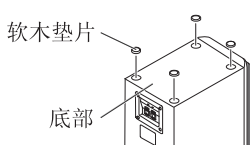

连接扬声器

- 在连接扬声器之前，切断扩音器电源线与壁装电源插座的连接，把扩音器音量调节器调至最小。
- 该扬声器的额定阻抗为 4Ω ，请确保所连接的扩音器与 4Ω 阻抗相容。
- 使用所提供的扬声器电缆连接扬声器与扩音器，如下图所示。
- 对于因连接其他公司生产的设备而造成的损害，我们将概不负责。

规格

型号:	双路低音反射式
阻抗:	4Ω
最大输入功率:	120 W
输出声压级别:	84 dB/W/m
响应频率:	50 Hz 到 50 kHz
分频频率:	2.5 kHz
尺寸(宽×高×长):	170 × 283 × 256 mm (包括格栅和突出部分)
重量:	4.3 kg
扬声器 低频扬声器:	13 厘米 N-OMF 圆锥形
高频扬声器:	3 厘米 环形
接线柱:	螺钉型扬声器端子 (支持香蕉插头)
格栅:	可拆卸
附件:	1. 1 米扬声器电缆×2 软木垫片×8
其他:	非磁屏蔽

* 规格与功能可能发生更改，恕不另行通知。

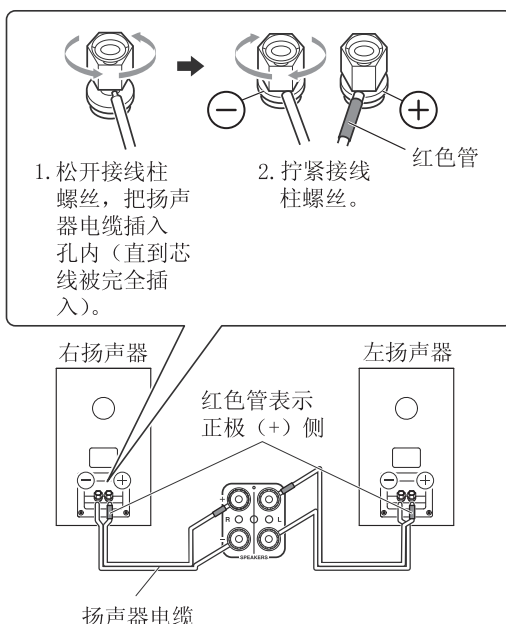

扩音器所使用的扬声器端子类型及其位置取决于机型。关于扬声器与扩音器连接的细节，请查阅扩音器的安装手册。

- 确保扬声器的正极(+)端子与扩音器的正极(+)端子相连接，扬声器的负极(-)端子与扩音器的负极(-)端子相连接。
- 请确保正极(+)与负极(-)导线不相互接触，否则可能发生短路，损坏扩音器。



ONKYO

安桥(上海)商贸有限公司

上海市徐汇区茶陵北路20号1号楼302室

电话:86-21-52131366 传真:86-21-52130396 客服热线:4000424228
<http://www.cn.onkyo.com/>

SN 29403255

(C) Copyright 2017 Onkyo & Pioneer Corporation Japan. All rights reserved.

F1709-0



* 2 9 4 0 3 2 5 5 *