

SENCOR®

SDC 4912



User's manual

Návod k obsluze

Návod na obsluhu

Használati útmutató

Instrukcja obsługi

**LED DUAL ALARM CLOCK
WITH USB CHARGING**

**LED BUDÍK SE DVĚMA ALARMY
A USB NABÍJENÍM**

**LED BUDÍK S DVOMA ALARMAMI
A USB NABÍJANÍM**

**USB-N TÖLTHETŐ ÉBRESZTŐÓRA KETTŐS
ÉBRESZTÉS FUNKCIÓVAL**

**LED BUDZIK Z DWOMA ALARMAMI
I ŁADOWANIEM USB**

EN CZ SK HU PL

FRONT VIEW

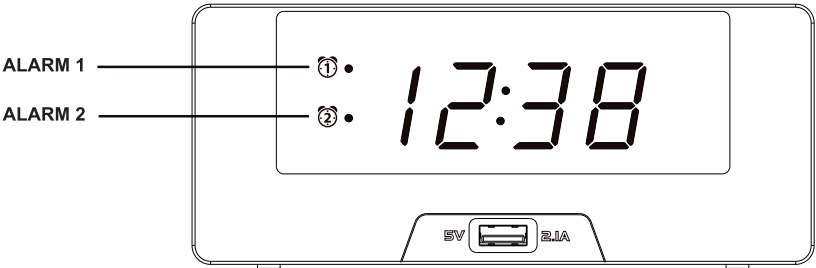

TOP VIEW

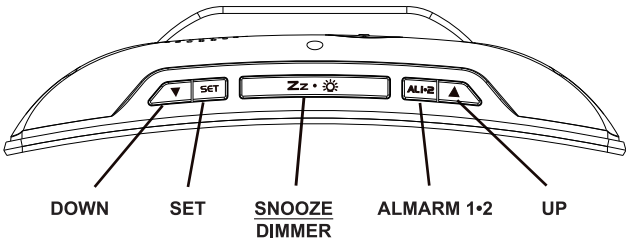

BACK VIEW

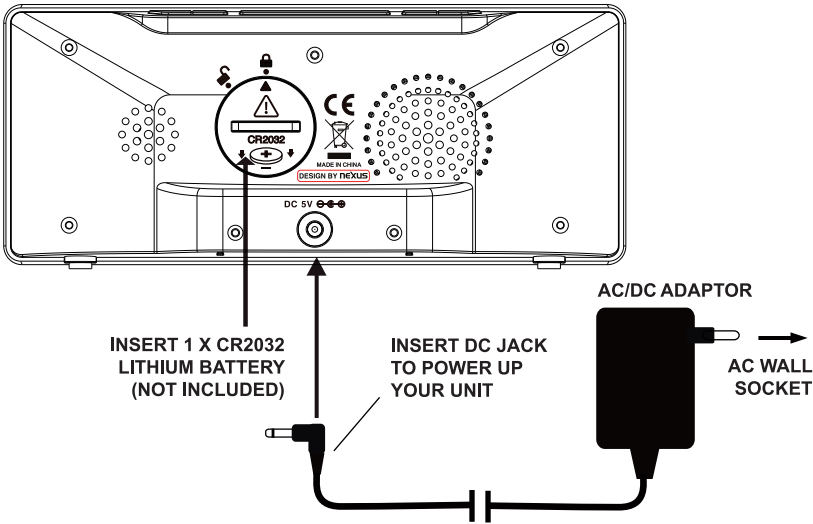

INSTALLATION

Plug the AC/DC adaptor to an AC household outlet, and then plug the DC jack to the back of the unit. Your alarm clock is ready to work for you.

BACKUP BATTERY INSTALLATION

Your alarm clock requires one CR2032 lithium battery (not included) to provide backup power to the clock in the event of a temporary power interruption.

1. Place your unit face down on a flat surface.
2. Use a coin and turn counterclockwise to open the battery cover located at the back of the unit.
3. Insert one new CR2032 lithium battery into the battery compartment with the "+" side facing up as indicated.
4. Use a coin and turn clockwise to lock the battery cover.

If AC power is interrupted, the LED display will go off and the alarm will not function. The backup battery will keep the time and alarm settings of your unit. Make sure a fresh CR2032 lithium battery is used. A fresh CR2032 battery could backup your clock continuously for around 3 days.

SETTING TIME, AND THE SNOOZE DURATION

1. Press **SET** once, the hour digit flash. Press **▲** or **▼** to set the current hour (hold to advance rapidly).
2. Press **SET** again, the minute digit flash. Press **▲** or **▼** to set minutes. (hold to advance rapidly).
3. Press **SET** again, the display shows "05" and flashes. Press **▲** or **▼** to select your snooze time from 5 to 60 minutes.
4. Press **SET** again or if no key is pressed in approx. 10 seconds to exit the setting mode.

SETTING THE ALARMS

1. Press and hold **AL 1.2**, ① LED and the hour digit flash. Press **▲** or **▼** to set the alarm 1 hour. (hold to advance rapidly).
2. Press **AL 1.2** again to adjust minutes. Press **▲** or **▼** to set the alarm 1 minutes. (hold to advance rapidly).
3. Press **AL 1.2** again, ② LED and the hour digit flash. Press **▲** or **▼** to set the alarm 2 hour.
4. Press **AL 1.2** again to adjust minutes. Press **▲** or **▼** to set the alarm 2 minutes. (hold to advance rapidly).
5. Press **AL 1.2** again or no button is pressed in around 10 seconds to exit alarm setting mode.

Note: Alarm function can only be operated at AC mode only.

TO TURN ON / OFF ALARM 1 AND 2

1. Press **AL 1.2** once to activate Alarm 1, ① LED appears.
2. Press **AL 1.2** once again to activate Alarm 2, ② LED appears.
3. Press **AL 1.2** once again to activate both Alarm 1 and 2. Both ① and ② LED's appear.
4. Press **AL 1.2** once again to deactivate both alarms, both ① and ② LED's disappear.

STOP AND RESET THE ALARM TO COME ON THE NEXT DAY

When alarm 1 or 2 is sounding, the related alarm icon flashes. Press the **AL 1.2** once to stop the alarm and reset it to come on the following day. After that, ① or ② LED stays on the display.

SNOOZE OPERATION (default snooze duration is 5 minutes)

When alarm is sounding, press **Zz • ⌘** once, the alarm will be silenced and come on again after the set snooze duration.

Note: If your second alarm activates while the first alarm is sounding or it is in the snooze mode, the second alarm overrides the first alarm (the first alarm is reset to come on the next day).

USING THE HI-LO DIMMER

Press **Zz • ⌘** to adjust the brightness (HI/ LO/ OFF) of the LED display.

TO CHARGE MOBILE PHONE WITH THE USB PORT

Connect the charging cable of your mobile phone to the A-type USB port in the front of the unit, then connect the other end to your mobile phone. The clock will charge the mobile phone automatically.

Remarks:

- 1. Make sure the original cable of your mobile phone's original charging cable for charging
- 2. Make sure the original adaptor enclosed with your clock is being used to power your clock. Using other adaptors may not charge your phone.

TROUBLE SHOOTING

If your clock displays irrelevant time or does not function properly, which maybe caused by electro-static discharge or other interference, unplug the DC jack to disconnect the AC power (and remove the backup battery). The clock will be reset to default settings and you need to set it again.

CARE OF YOUR PRODUCT

- 1. Place your clock on a stable surface, away from sources of direct sunlight or excessive heat or moisture.
- 2. Protect your furniture when placing your units on a natural wood and lacquered finish by using a cloth or protective material between it and the furniture.
- 3. Clean your unit with a soft cloth moistened only with mild soap and water. Stronger agents such as Benzene, thinner or similar materials can damage the surface of the unit. Make sure the unit is unplugged before cleaning.
- 4. If the unit is not to be used for a prolonged period, such as a month or longer, remove the batteries to prevent possible corrosion. Should the battery compartment become corroded or dirty, clean the compartment thoroughly and replace the batteries.

BATTERIES SAFETY WARNING

- 1. Danger of explosion if battery is incorrectly replaced.
- 2. Replace only with the same or equivalent type.
- 3. Battery shall not be exposed to excessive heat such as sunshine, fire or the like.
- 4. Do not ingest the battery, chemical burn hazard.
- 5. This product contains a coin/button cell battery. If the coin/button cell battery is swallowed, it can cause severe internal burns in just 2 hours and can lead to death.
- 6. Keep new and used batteries away from children.
- 7. If the battery compartment does not close securely, stop using the product and keep it away from children.
- 8. If you think batteries might have been swallowed or placed inside any part of the body, seek immediate medical attention.

SPECIFICATIONS

Alarm duration	1 hour
Snooze duration	5 to 60 minutes
Default settings	-
Time format	24 hour
Time	0:00
Alarm 1 and 2	6:00
Snooze duration	05 (5 minutes)

INSTRUCTIONS AND INFORMATION REGARDING THE DISPOSAL OF USED PACKAGING MATERIALS

Dispose of packaging material at a public waste disposal site.

DISPOSAL OF USED ELECTRICAL AND ELECTRONIC APPLIANCES



The meaning of the symbol on the product, its accessory or packaging indicates that this product shall not be treated as household waste. Please, dispose of this product at your applicable collection point for the recycling of electrical & electronic equipment waste. Alternatively in some states of the European Union or other European states you may return your products to your local retailer when buying an equivalent new product. The correct disposal of this product will help save valuable natural resources and help in preventing the potential negative impact on the environment and human health, which could be caused as a result of improper liquidation of waste. Please ask your local authorities or the nearest waste collection centre for further details. The improper disposal of this type of waste may fall subject to national regulations for fines.

For business entities in the European Union

If you wish to dispose of an electrical or electronic device, request the necessary information from your seller or supplier.

Disposal in other countries outside the European Union

If you wish to dispose of this product, request the necessary information about the correct disposal method from local government departments or from your seller.



The product meets EU requirements.

Changes to the text, design and technical specifications may occur without prior notice and we reserve the right to make these changes.

The original version is in the Czech language.

Address of the manufacturer: FAST ČR, a.s., Černokostelecká 1621, Říčany CZ-251 01

SENCOR®

EN Warranty conditions

Warranty card is not a part of the device packaging.

This product is warranted for the period of 24 months from the date of purchase to the end-user. Warranty is limited to the following conditions. Warranty is referred only to the customer goods using for common domestic use. The claim for service can be applied either at dealer's shop where the product was bought, or at below mentioned authorized service shops. The end-user is obligated to set up a claim immediately when the defects appeared but only till the end of warranty period. The end user is obligated to cooperate to certify the claiming defects. Only completed and clean (according to hygienic standards) product will be accepted. In case of eligible warranty claim the warranty period will be prolonged by the period from the date of claim application till the date of taking over the product by end-user, or the date the end-user is obligated to take it over. To obtain the service under this warranty, end-user is obligated to certify his claim with duly completed following documents: receipt, certificate of warranty, certificate of installation.

This warranty is void especially if apply as follows:

- Defects which were put on sale.
- Wear-out or damage caused by common use.
- The product was damaged by unprofessional or wrong installation, used in contrary to the applicable instruction manual, used in contrary to legal enactment and common process of use or used for another purpose which has been designed for.
- The product was damaged by uncared-for or insufficient maintenance.
- The product was damaged by dirt, accident of force majeure (natural disaster, fire, and flood).
- Defects on functionality caused by low duality of signal, electromagnetic field interference etc.
- The product was mechanically damaged (e.g. broken button, fall).
- Damage caused by use of unsuitable media, fillings, expendable supplies (batteries) or by unsuitable working conditions (e.g. high temperatures, high humidity, quakes).
- Repair, modification or other failure action to the product by unauthorized person.
- End-user did not prove enough his right to claim (time and place of purchase).
- Data on presented documents differs from data on products.
- Cases when the claiming product cannot be indentified according to the presented documents (e.g. the serial number or the warranty seal has been damaged).

Authorized service centers

Visit www.sencor.eu for detailed information about authorized service centers.