

# SENCOR®

## SWM 3500



**USER'S MANUAL**

**FM Modulator BT / MP3**

EN

CZ

SK

HU

PL

## DESCRIPTION OF EQUIPMENT

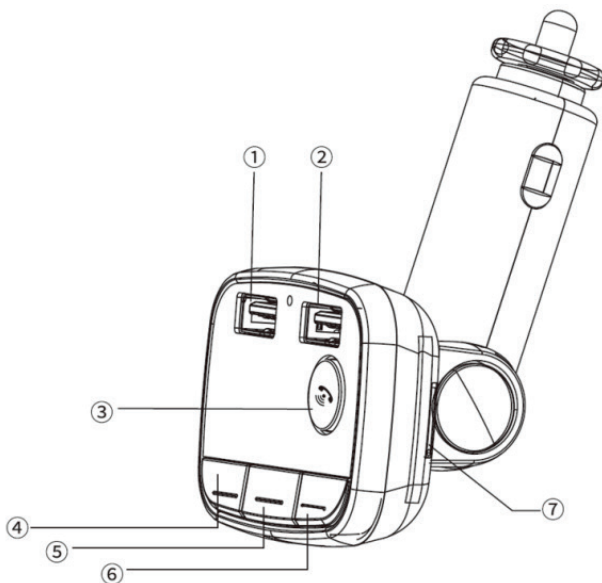

1	USB charging port (max. 2.4A)
2	USB port for portable devices (max. 1A)
3	Playback/pause/call answer/call back
4	Previous track
5	Frequency/mode change
6	Next track
7	TF memory card slot

## SETTING UP AND PAIRING WITH FM RADIO

Before first use, be sure to read the safety instructions contained in this user's manual carefully. Connect the modulator to the car socket power supply (12 - 24V). Tune any vacant frequency on your car stereo and then press the "Change frequency and mode" button to tune the same frequency on the modulator (No.5 on the figure). When this button is pressed, the frequency number on the modulator display will start flashing, then press the arrow buttons (No.4 and 6 on the figure) to set the desired frequency matching the one of your FM car stereo. Hold down the button (No.4 or 6) to increase the speed of searching for the desired frequency.

## PAIRING VIA BLUETOOTH

Find the Bluetooth modulator name "SWM 3500" on your Bluetooth portable device to be paired (such as a mobile phone) and start the pairing process. If you are requested to enter a pairing code while your device and the modulator are being paired, use the following code: "0000".

**Note:** To ensure a stable Bluetooth connection, make sure that the distance between the modulator and your connected device is kept within 5m.

**Note:** Some connected devices support common volume setting. If some of the connected devices do not support this feature, the volume setting will operate separately on each device.

## USB CHARGING INPUT

This input (No.1 on figure "Device description") is designed for connecting and charging portable devices. Maximum USB port load is 2.4 A.

**Note:** Power supply cables of lower quality may cause playback interference when connected.

## INSERTING THE TF MEMORY CARD

Insert the TF memory card in the relevant slot (No.7 on the figure) so that the contacts face the control buttons and the modulator display. Carefully push the TF memory card with your nail or a flat tool until it clicks gently in place. To release the TF memory card, press it gently into the modulator with your nail or a flat tool and the card will release. While removing the TF memory card, hold it gently so that you can catch it after being released from the modulator.

## USB INPUT FOR PORTABLE DEVICES AND TF MEMORY CARD PLAYBACK

Once the USB flash drive is connected to the USB playback input (No.2 on figure) or the memory card is connected to the relevant slot (No.7 on figure), the modulator will recognize the device connection and search it for playable MP3 tracks. If it finds them, it will select this

input and start playback of these tracks. To select from the tracks being played, press the "Previous track" or "Next track" button (No.4 and 6 on figure). To pause/start playback, press the "Playback/pause" button (No.5 on figure) shortly.

**Note:** Owing to the variety of devices on the market, the compatibility and playability of all media is not guaranteed. Memory devices that you wish to connect should be tested in advance or formatted to the FAT32 file format. It may not be possible to playback protected media, files or content contained on them. Playback tested and unprotected media and content.

**Note:** Media with a power consumption greater than flash memory should only be connected only if they have a separate power supply. If the USB flash drive is bigger than 32 GB, e.g. 64 GB, format it to FAT32 and verify its compatibility and recognition by this device before use. If the device does not read the memory even though it should contain playable content, use a different card or memory/media type.

## SELECTING THE PLAYBACK MEDIUM

When a USB flash drive is connected to and/or the TF memory card is inserted in the modulator while the BT connection is active, you can select the audio source by a long-press of the "Change frequency and mode" button (No.5 on figure). Repeat the long presses to switch among individual available sources.

## CALLING

If your mobile phone is paired to the modulator via Bluetooth connection, an incoming call will interrupt the music playback, then press the "Playback/pause" button (No.3 on figure) shortly to accept/end the call. To reject the incoming call, long-press the "Playback-pause" button. To start dialling the last call number, press the "Playback/pause" button twice shortly.

## VOLUME CONTROL

Hold down the "Previous track" or "Next track" button (No.4 and 6 on figure) to change the playback volume level.

**Note:** The resulting playback volume is influenced by the current volume setting on the modulator, car stereo and your portable device. To set optimal volume, it may be necessary to adjust the volume level on each of these devices.

## OTHER FUNCTIONS

By long-pressing the "Playback/pause" button (No.5 on figure), the display will show the electric system voltage in your car for several seconds (e.g. 11V).

## TECHNICAL PARAMETERS

Input voltage range:	DC 12V - 24V
Music format:	MP3
Working current:	< 60mA
Bit rate:	32 Kbps – 320 Kbps
FM transmitter frequency:	87.5 MHz – 108.0MHz
USB charging port:	DC 5V / 3.4A max. (2.4A + 1A)
External memory expansion:	TF Card / USB flash drive
Working temperature:	-10°C to +40°C
Transmitting distance:	Up to 5 m

## ATTENTION

- This device's operating voltage is 12V ~ 24V. If the voltage is too high or too low, damage or failure to the device may occur.
- For safety reasons, always connect the USB flash drive or the memory card to the unit before connecting the unit to the car's cigarette lighter socket.
- This unit may not support all types of USB flash discs or memory cards.
- If the unit fails to read data from the USB flash drive or the memory card, please try to reinsert the USB flash drive/memory card or reconnect the unit to the lighter socket. If the problem persists, please use other USB flash drive or card.
- The car FM tuner frequency should be the same as the unit's frequency.
- Do not pull out or insert the USB flash drive/memory card while the unit is powered from the lighter. If you want to do so, first disconnect the unit from the socket and insert or remove the drive/card before reconnecting the unit to the power supply.
- If there are too many audio files stored on the USB flash drive or the memory card, their processing may be slow.

## INSTRUCTIONS AND INFORMATION ABOUT THE DISPOSAL OF DISCARDED PACKAGE

Return the packaging to a collection centre for disposal.



### DISPOSAL OF DISCARDED ELECTRICAL AND ELECTRONIC EQUIPMENT

This symbol placed on the product, accessories or package notifies that the product must not be treated as household waste. Please dispose of this product in a collection centre designed for recycling electric and electronic equipment. In some EU or European countries, you can return your products to your local dealer when buying a new equivalent product. Correct disposal of this product helps save valuable natural resources and prevents possible adverse impacts on the environment and human health that might be caused by improper waste disposal. For further information, please contact your local authorities or the nearest waste disposal collection centre. Wrong disposal of this type of waste may be subject to a legal penalty.

### For EU companies

If you need to dispose of an electric or electronic device, ask your dealer or supplier for necessary information.

### Disposal in countries outside the European Union

To dispose of this product, please ask your local authorities or dealer for the necessary information on correct disposal.



This product complies with EU requirements.

FAST ČR, a.s. hereby declares that the SWM 3500 type device conforms to the 2014/53/EU Directive. For full version of the EU declaration of conformity, please refer to [www.sencor.eu](http://www.sencor.eu) website.

Changes in the text, design and technical specifications may be made without prior notice and we reserve the right to make such changes.

The original version is in Czech.

Address of the manufacturer:

FAST ČR, a. s., Černokostelecká 1621, Říčany CZ-251 01

# SENCOR<sup>®</sup>

## **EN** Warranty conditions

A warranty card is not included with this product.

The seller provides to the buyer a warranty on the product for a period of 24 months from the acceptance of the product by the buyer. The warranty is provided under the conditions contained below. The warranty applies only to new consumer goods sold to the consumer for standard domestic use. The rights and responsibilities for defects (complaints) can be claimed either at the vendor, where the product was purchased or at the authorised service centre listed below. The buyer is obliged to lodge the complaint without undue delay so that the defect is not worsened, but no later than by the end of the warranty period. The buyer is obliged to provide cooperation during the complaint procedure necessary for the verification of the claimed defect. Only a complete and due to hygiene regulations unsoiled product will be accepted into the complaint procedure. In the case of a justified complaint the warranty period is extended by the time from the moment the complaint was lodged to the moment the repaired product was received by the buyer, when the buyer is obliged to accept the product after it has been repaired. The buyer is obliged to prove the right to the complaint (proof of purchase of the product, warranty card, documentation about putting the product into operation).

The warranty does not cover, in particular:

- defects for which a discount was given;
- wear and damage arising from standard use of the product;
- damage to the product resulting from unprofessional or incorrect installation, the use of the product in contradiction to the user's manual, legal regulations in force and generally known and usual methods of use, resulting from the use of the product for a purpose other than for which it was designed;
- damage to the product arising from neglected or incorrect maintenance;
- damage to the product arising from it being soiled, by an accident or by the occurrence of force-majeure (natural event, fire, flooding);
- functional defects of the product caused by inappropriate signal quality, interfering electromagnetic field, etc., mechanical damage to the product (button is broken off, it was dropped);
- damage caused by the use of inappropriate media, refills, consumables (battery) or inappropriate operating conditions (e.g. high ambient temperatures, high humidity in the environment, shocks);
- damage, modification or other tampering with the product performed by an unqualified or unauthorised person (service centre);
- cases, where the buyer does not prove the grounds for his rights (when and where the claimed product was purchased);
- cases, where the information on the presented documentation differs from the information shown on the product;
- cases when the claimed product cannot be identified as the product in the documentation with which the buyer proves his right to complaint (e.g. damaged serial number or warranty seal of the appliance, overwritten details in documentation).

Service coordinator for the Czech Republic:

FAST ČR, a.s., Černokostelecká 1621, 251 01 Říčany; tel: 323,204,120

FAST ČR, a.s., Cejl 31, 602 00 Brno; tel: 531,010,295

You can find other authorised service centres for the Czech Republic at [www.sencor.cz](http://www.sencor.cz).