

⚠ WARNING:

This product contains a Button or Coin Cell Battery. A swallowed Button or Coin Cell Battery can cause internal chemical burns in as little as two hours and lead to death. Dispose of used batteries immediately. Keep new and used batteries away from children. If you think batteries might have been swallowed or placed inside any part of the body, seek immediate medical attention.

SAFE BATTERY USAGE

- Use alkaline batteries for best performance and longer life.
- Use only the battery type recommended for the unit.
- Batteries should be replaced only by an adult.
- Insert batteries with the correct polarity (+ and -).
- Do not mix old and new batteries.
- Do not mix alkaline, standard (carbon-zinc), or rechargeable batteries.
- Do not short-circuit batteries.
- When not used for an extended time, remove batteries to prevent possible leakage and damage to the unit.
- Do not mix rechargeable and non-rechargeable batteries.
- Rechargeable batteries are to be removed from the toy before charging.
- Rechargeable batteries are to be recharged only under adult supervision.
- Do not recharge non-rechargeable batteries.
- Exhausted batteries are to be removed from the toy.
- Do not dispose of batteries in fire as they may leak or explode.

FCC COMPLIANCE

NOTE: This equipment has been tested and found to comply with the limits for a Class B digital device, pursuant to Part 15 of the FCC Rules. These limits are designed to provide reasonable protection against harmful interference in a residential installation. This equipment generates, uses and can radiate radio frequency energy and, if not installed and used in accordance with the instructions, may cause harmful interference to radio communications. However, there is no guarantee that interference will not occur in a particular installation. If this equipment does cause harmful interference to radio or television reception, which can be determined by turning the equipment off and on, the user is encouraged to try to correct the interference by one or more of the following measures:

- Reorient or relocate the receiving antenna.
- Increase the separation between the equipment and receiver.
- Connect the equipment into an outlet on a circuit different from that to which the receiver is connected.
- Consult the dealer or an experienced radio/TV technician for help.

This device complies with Part 15 of the FCC Rules. Operation is subject to the following two conditions: (1) This device may not cause harmful interference, and (2) this device must accept any interference received, including interference that may cause undesired operation.

Caution: Modifications not authorized by the manufacturer may void users authority to operate this device.

CAN ICES-3 (B)/NMB-3(B).



'Let's care for the environment!'

The wheelie bin symbol indicates that the product must not be disposed of with other household waste. Please use designated collection points or recycling facilities when disposing of the item. Do not treat old batteries as household waste. Take them to a designated recycling facility.

Please keep this manual as it contains important information.



0718-0-E/INT

CrateCreatures.com
© 2018 MGA Entertainment, Inc.
CRATE CREATURES™ and CRATE CREATURES SURPRISE!™ are trademarks of MGA in the U.S. and other countries. All logos, names, characters, likenesses, images, slogans, and packaging appearance are the property of MGA.
16300 Roscoe Blvd.
Van Nuys, CA 91406 U.S.A.
(800) 222-4685
Printed in China

MGA Entertainment (Netherlands) B.V.
Klipperaak 201, 2411 ND Bodegraven, NL
Tel: +31 (0)172-758 038
E-mail: klantenservice@mgaee.com



The preferred method of contact for Customer Service is through our e-mail contact form at www.mgaee.com



SKUs: 557234, 557227, 557258, 557241

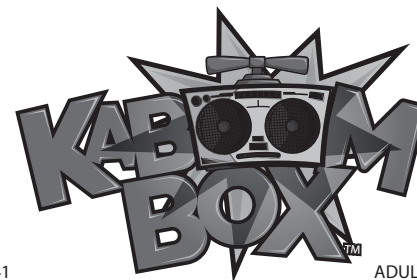

⚠ WARNING:
CHOKING HAZARD—Small parts.
Not for children under 3 years.

AGES 4+ YEARS
EACH SOLD SEPARATELY
ADULT BATTERY INSTALLATION REQUIRED

CONTENTS

A. 1 Croak™

OR 1 Nanners™

OR 1 Gobbie

OR 1 Stubbs™

B. 1 Pair of Arms

C. 1 Pair of Legs

D. 1 Headpiece

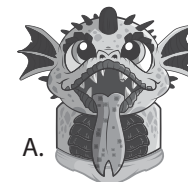

CROAK™
557234



NANNERS™
557227

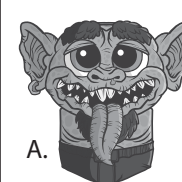

GOBBIE
557258



STUBBS™
557241

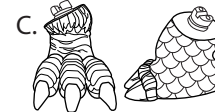

KABOOM BOX™ CREATURES WILL COME WITH RANDOM MONSTER ARMS, LEGS AND HEADPIECES. COLLECT THEM ALL TO MIX AND MATCH!

Illustrations are for reference only. Styles may vary from actual contents.

BATTERY INSTALLATION

The batteries included in your creature are for in-store demonstration. Before beginning, an adult must install fresh alkaline batteries. Here's how:

1. Using a Phillips screwdriver (not included), remove the screw and battery compartment cover from the back of the creature.
2. Install three (3) fresh 1.5V AG13 (LR44) alkaline batteries (not included) making sure the (+) and (-) ends face the proper direction as indicated inside the battery compartment.
3. Replace the compartment cover and tighten the screw.

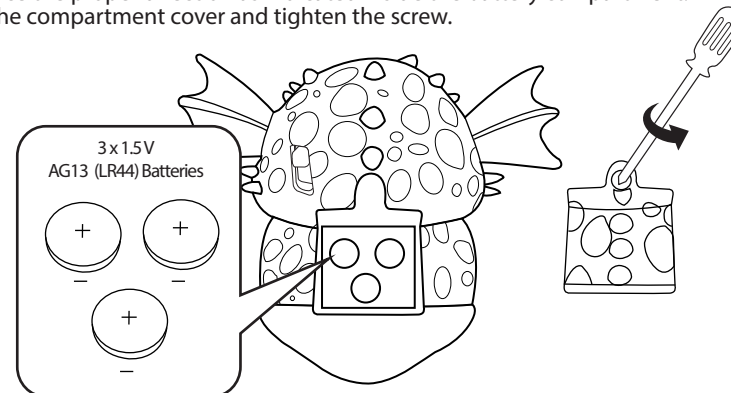

QUICK START

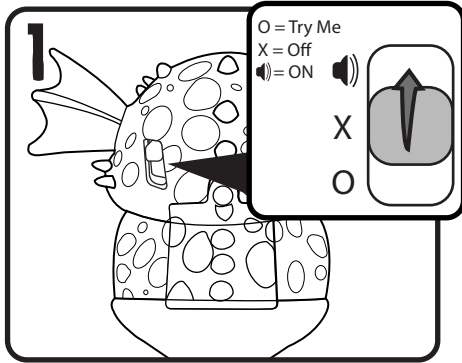

Move the switch on the back of your creature to the ON position.

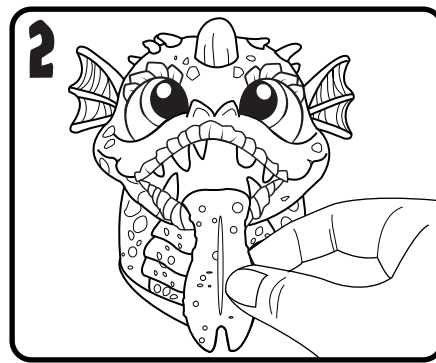

Pull the tongue to hear its monster sound.

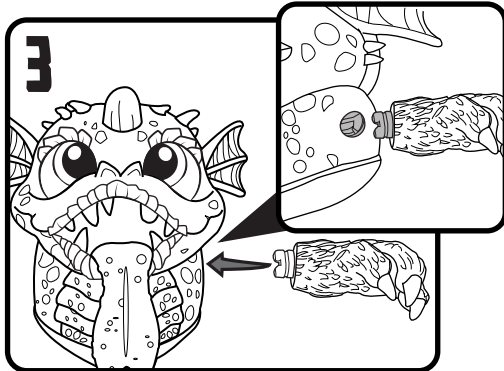

Insert the peg on the arms, legs or headpiece into any opening on the creature. The pegs are keyed and will need to be inserted correctly for a perfect fit. It will activate a monster sound once attached.

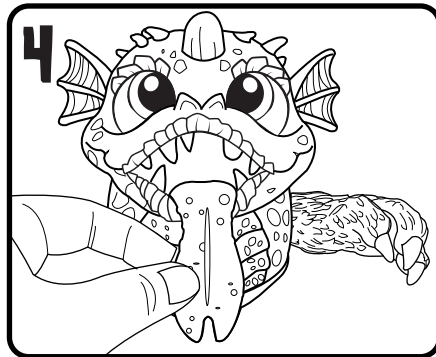

Pull the tongue to hear the monster sounds. Each time you attach a part and pull its tongue, new monster sounds will be added.

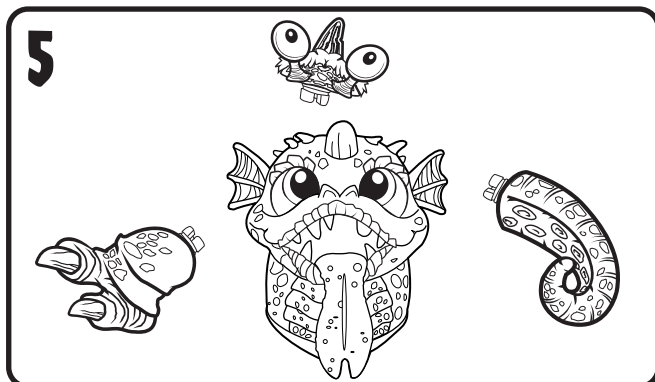

MIX AND MATCH PARTS FROM OTHER KABOOM BOX™ CREATURES (NOT INCLUDED) AND UNLOCK NEW SOUNDS!

UNBOX AGAIN AND AGAIN

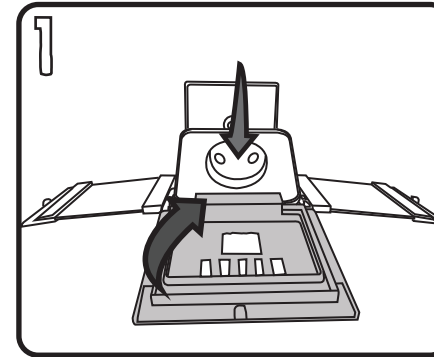

Lift the window panel to lower the platform.

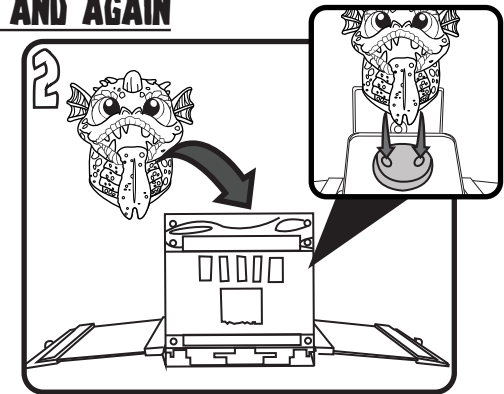

While holding the panel in place, insert your creature first. Align the openings on the bottom of your creature with the platform.

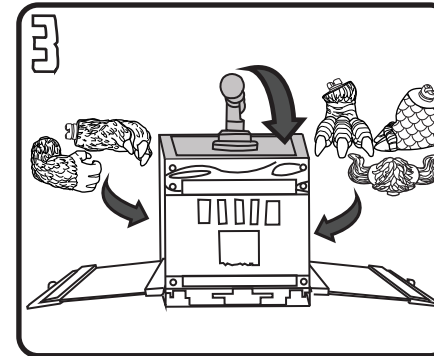

Lift the panel with the trigger handle. Lock the trigger panel with the front panel. Then, insert the creature's arms, legs and headpiece through the sides.

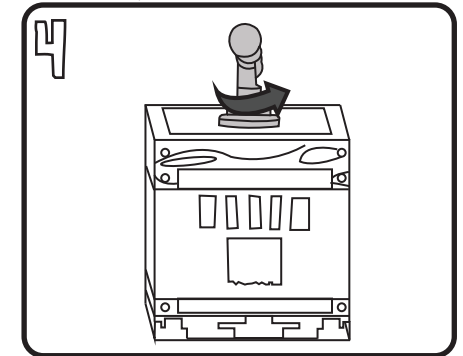

Close the side panels and turn the handle counterclockwise to lock.

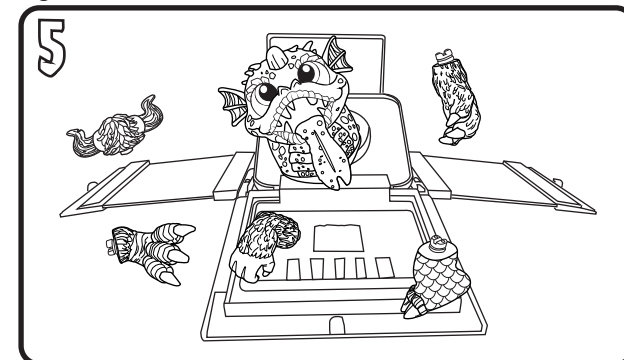

To unbox, turn the handle clockwise and push down. Watch your creature explode out!

IMPORTANT INFORMATION

- Function may be limited when the product is in TRY ME mode.
- Wipe clean with a damp cloth and keep moisture away from battery compartment.
- Turn the switch on your creature to the "OFF" position after use to conserve battery.