

LANAFORM

AIR QUALITY

Aroma Decor

ESSENTIAL OIL DIFFUSER



GLASS COVER



COLOUR CHANGING



AUTO SWITCH OFF



3HRS DIFFUSION

DIFFUSEUR D'HUILES
ESSENTIELLES

VERDAMPER VAN
ETHERISCHE OLIËN

DIFFUSOR FÜR
ÄTHERISCHE ÖLE

DIFUSOR DE ACEITES
ESENCIALES

DIFFUSORE DI
OLIO ESSENZIALE



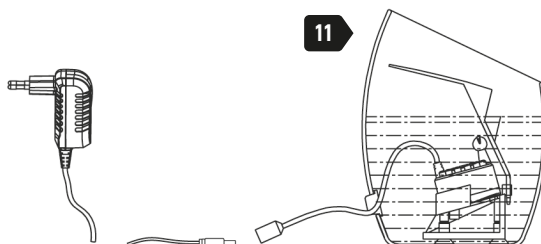
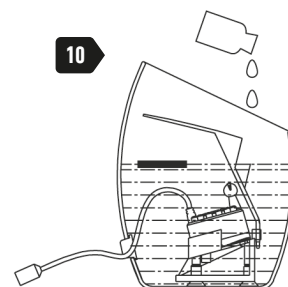
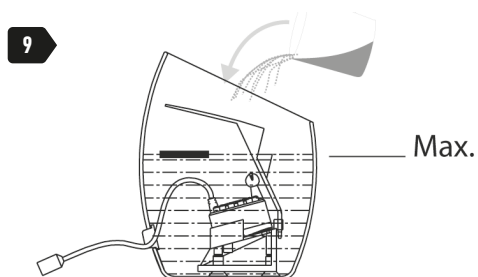
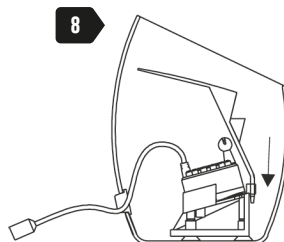
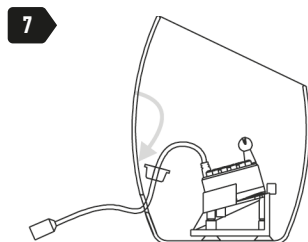
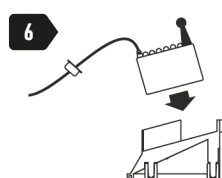
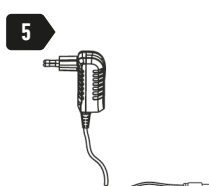
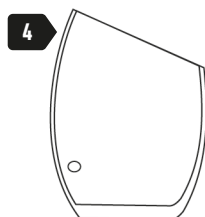
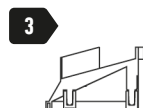
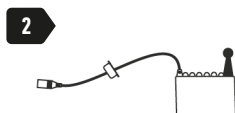
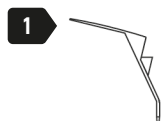

EN Instructions

 *The photographs and other images of the product in this manual and on the packaging are as accurate as possible, but do not claim to be a perfect reproduction of the product.*

Thank you for buying the Aroma Decor from LANAFORM. The essential oil diffuser Aroma Decor combines technology, wellbeing and design. Very silent, it allows at the same time the propagation of an aromatized cold vapour but also the diffusion of soft coloured lights variations in your house.

PLEASE READ ALL THE INSTRUCTION PRIOR TO USING YOUR DIFFUSER, IN PARTICULAR THESE FEW BASIC SAFETY INSTRUCTIONS:

- Always place the Aroma Decor on a hard, flat, horizontal surface. Keep slightly away from walls and heat sources such as cookers, radiators, etc. Caution: If not placed on a horizontal surface, the Aroma Decor may not work correctly.
- Check that your mains voltage is compatible with that of the appliance.
- Do not connect or disconnect the plug with wet hands.
- If the supply lead is damaged, it must be replaced by a similar lead available from the supplier or its after-sales department.
- Do not leave the diffuser in the sun for long periods of time.
- Do not completely dismantle the device.
- Do not switch the diffuser on when there is no water in the tank.
- Do not touch the transducer when the device is switched on.
- Do not use essential oils which are not recommended.
- Do not use artificial perfume, these may damage the device.
- Ensure the cable does not pass directly above the transducer.
- Do not tug at the water detector, this could damage the device.
- Unplug the device prior to cleaning.
- Do not wash the complete product in water and do not immerse it, see cleaning instructions in this manual.
- Never scrape the transducer with a hard object, see cleaning instructions in this manual.
- It is advisable to use the Aroma Decor for periods of 30 minutes, several times a day if you wish.
- This device was not designed for use by people with reduced physical, sensory or mental capabilities (including children), or people without experience or knowledge of the product, unless

it may be beneficial to them and the person responsible for their safety can supervise them and has received advice and instruction in using the device. Children should be supervised to ensure that they do not play with the appliance.

COMPONENTS

- 1 Plastic lid for adjusting the steam output (1)
- 2 Water sensor and LED light generator (2)
- 3 Holder for the water sensor and LED light generator (3)
- 4 Diffuser (4)
- 5 Transformer (5)

INSTRUCTIONS FOR USE

Characteristics:

- Changing colours.
- 700ml capacity.
- 3 hours continuous diffusion.
- Easy-fill water tank.
- The water sensor ensures that the device stops automatically when there is not enough water in the tank.
- Silent.

Functionalities:

- Essential oil diffuser.
- Eliminates electrostatic charges.
- Improves the quality of the surrounding air.

HOW TO USE IT:

- Place the Aroma Design in the room half an hour before lighting it so that it reaches ambient temperature.
- Make sure that the diffuser is clean.
- Insert the holder for the water sensor and LED light generator (2) onto its holder (3) as shown on the diagram (6).
- Place both of them inside the diffuser, making sure they are positioned as shown on the diagram (7).
- Next pull the wire out through the hole provided for this purpose. Make sure that the hole is blocked using the rubber bung found on the cable. (7)
- Insert the lid for adjusting the steam output (1) onto the holder for the water sensor and LED light generator (3) until you have a good fit. Make sure that the top part of the lid is facing the highest side of the diffuser to prevent splashing. Check its position on the diagram (8).
- Fill the tank with clean water up to a maximum of 700ml. (The water temperature must not be

higher than 40°C). (9)

- Pour a few drops of essential oil into the tank. (10)
- With dry hands, plug in the device. (11) The device lights up automatically. The steam and colours it releases then create a relaxing environment.

▲ Warning: DESPITE THE SAFETY MECHANISM WHICH STOPS THE TRANSDUCER WORKING, DO NOT LEAVE THE DEVICE PLUGGED IN WHEN NOT IN USE.

FURTHER INFORMATION REGARDING THE USE OF ESSENTIAL OILS

- Before using essential oils, check for the negative effects on health which may result from the use of such oils.
- Always choose essential oils of good quality: they should be pure, 100% natural and designed for use in diffusers. Use them in moderation and with care. Follow the recommendations and warnings indicated on the packaging of the essential oils and take care in particular to note that that:
 - The use of essential oils is not permitted for pregnant women or for persons suffering from epilepsy, asthma or allergies, or persons with heart problems or serious illness.
 - In the bedroom of a baby (less than 3 years old), essential oils should not be used more than once a day, not for more than 10 minutes and not when the baby is present in the room.
- Make sure that children and minors do not play with or use the appliance.
- A few drops (no more than 3 or 4) of essential oil suffice to ensure correct operation of the appliance and the diffusion of perfume. Using too much oil can damage the machine.
- Always put water in the tank before adding essential oils.
- LANAFORM cannot be held liable for accidental damage resulting from any use not in accordance with the present Instructions.

CARE AND STORAGE

If the water has too much calcium and magnesium, it can leave a "white powder" on the device. If this residue collects on the transducer (the metal disc which produces the ultrasounds) this will prevent the Aroma Decor from working correctly.

We recommend:

- 1 Using boiled and cooled water for each application,
- 2 Cleaning the tank every 2 days and cleaning the transducer once a week,

- 3 Changing the water in the tank every 2 days,
- 4 Cleaning the Aroma Decor (see instructions below) and making sure that all its components are completely dry when not in use.

To clean the transducer:

- 1 Pour 2 to 5 drops of vinegar on its surface and leave for 2 to 5 minutes.
- 2 Brush the scale off the surface with a soft brush.

- Do not use a hard tool to scratch at the surface.
- 3 Rinse the tank with fresh water.
- 4 Do not use soap, solvent or any other cleaning spray to clean the transducer.

To clean the tank unit:

- 1 Clean the water basin using a soft cloth and vinegar if there is any residue or calcium deposit inside.

- 2 Rinse the tank with clear water.

Storage:

Store the device in a dry cool place, out of reach of children after it has been cleaned and dried.

TROUBLESHOOTING

IF THE DEVICE IS NOT WORKING CORRECTLY, UNDER NORMAL CONDITIONS, CONSULT THE FOLLOWING TABLE:

Breakdown	Possible causes	Remedies
No vapour and no indicator light	If there is no light.	Check that the device is plugged in and that there is not a problem with the mains supply.
	The water level in the tank is too low.	Add water to the tank.
	The top for adjusting the power of the vapour is not in the correct position.	Reposition it correctly.
	The cable passes above the transducer.	Reposition it correctly.
	The water tank is leaking.	Check that the rubber stopper is positioned correctly.
	The temperature of the device is too low.	Place the device in the room at room temperature for half an hour prior to use.
The vapour has an unusual smell	The water has been in the tank too long.	Clean the tank and fill with fresh water.
Low intensity	Too much/little water in the tank.	Empty/fill the water tank.
	Sediment on the transducer.	Clean the transducer.
	The water is too cold.	Use water at room temperature.
	The water is unclean.	Clean the tank and fill with fresh water.



ADVICE REGARDING THE DISPOSAL OF WASTE

All the packaging is composed of materials that pose no hazard for the environment and which can be disposed of at your local sorting centre to be used as secondary raw materials. The cardboard may be disposed of in a paper recycling bin. The packaging film must be taken to your local sorting and recycling centre.

When you have finished using the device, please dispose of it in an environmentally friendly way and in accordance with the law.

LIMITED WARRANTY

LANAFORM guarantees this product against any

material or manufacturing defect for a period of two years from the date of purchase, except in the circumstances described below.

The LANAFORM guarantee does not cover damage caused as a result of normal wear to this product. In addition, the guarantee covering this LANAFORM product does not cover damage caused by abusive or inappropriate or incorrect use, accidents, the use of unauthorized accessories, changes made to the product or any other circumstance, of whatever sort, that is outside LANAFORM's control.

LANAFORM may not be held liable for any type of circumstantial, indirect or specific damage.

All implicit guarantees relating to the suitability of the product are limited to a period of two years from the initial date of purchase as long as a copy

of the proof of purchase can be supplied.

On receipt, LANAFORM will repair or replace your appliance at its discretion and will return it to you. The guarantee is only valid through LANAFORM's Service Centre. Any attempt to maintain this product by a person other than LANAFORM's Service Centre will render this guarantee void. ■

LANAFORM

AIR QUALITY

Aroma Decor

LA120306 / LOT014

Manufacturer & Importer

LANAFORM SA

Postal Address

Rue de la Légende, 55

4141 Louveigné, Belgium

Tel. +32 4 360 92 91

www.lanaform.com