

LANAFORM®

Java

Divine & Peaceful



Fragrance
diffuser

Diffuseur
d'arômes

Geurverspreider

Difusor
de aromas



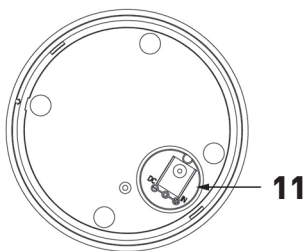
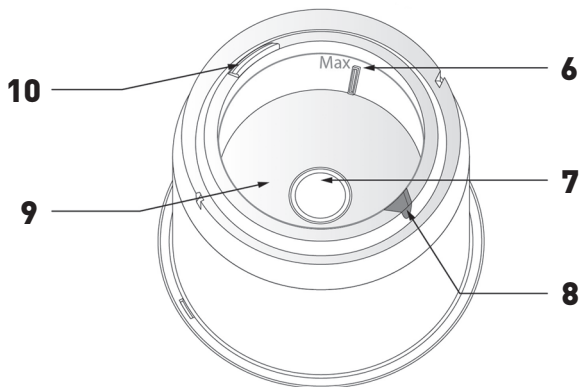
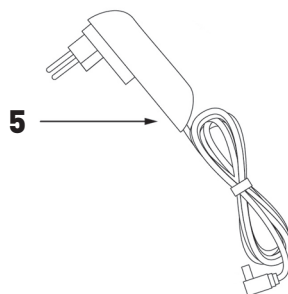
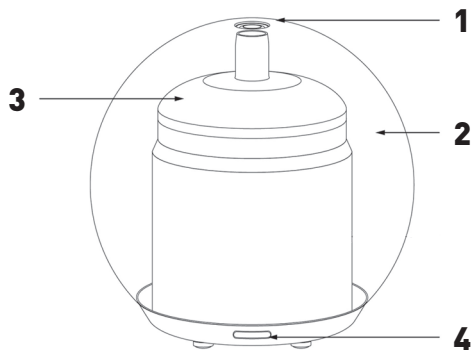

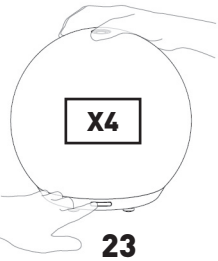
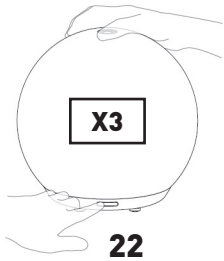
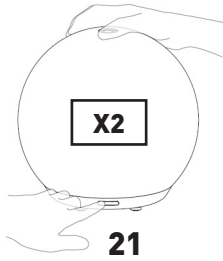
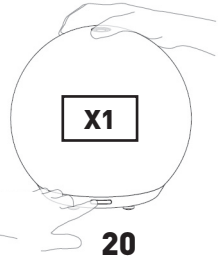
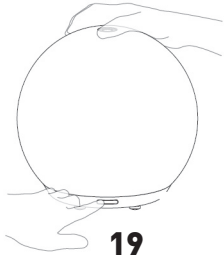
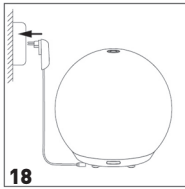
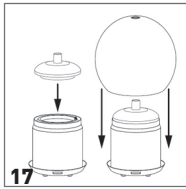
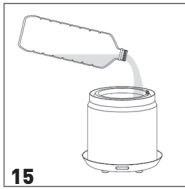
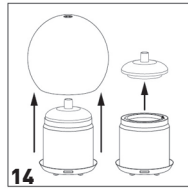
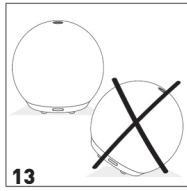
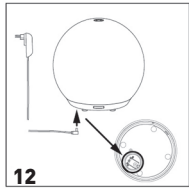

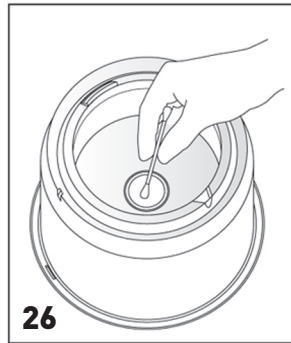
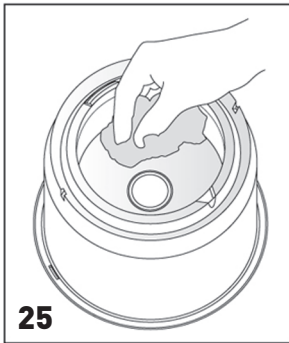
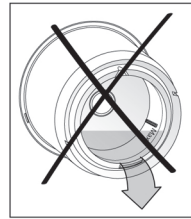
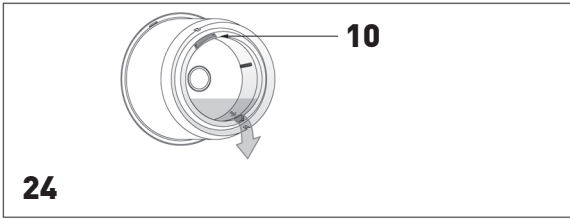

Thank you for choosing the Java by LANAFORM®.

With its perforated ceramic shell and changing colours, the Java essential oil diffuser combines well-being and quality. As well as generating a cool mist of fragrance, this virtually silent device also creates a pleasant relaxing atmosphere.

PLEASE READ ALL OF THE INSTRUCTIONS BEFORE USING YOUR DIFFUSER, ESPECIALLY THIS BASIC SAFETY INFORMATION:

Take care when handling the diffuser as the fragile upper ceramic part is not secured to the plastic base. You should therefore hold the plastic base in one hand while grasping the upper ceramic part with your other hand.

- Always place the device on a hard, flat, horizontal surface inside. Keep it away from walls and heat sources such as stoves, radiators, etc.
N.B.: If it is not placed on a horizontal surface, it may not work properly.
- Check that your mains voltage is the same as that of your device.
- Do not connect or disconnect the plug with wet hands.
- If the power cable is damaged, it must be replaced with the same type of cable which is available from the supplier or its after-sales department.
- Do not leave the device in the sun for a long period of time.
- Do not dismantle the device entirely.
- Do not switch the device on if there is no water in the reservoir.
- Do not lift the glass cover when the device is on. If you notice a suspicious odour or noise, switch the device off immediately and consult the «Troubleshooting» section of these instructions for use. If the problem persists, ask the supplier or its after-sales department to check the device.
- Do not use essential oils that are not recommended for diffusion. To find out which essential oils are recommended, consult the advice provided in these instructions for use.
- Do not use perfume or synthetic essences as these could damage the device.
- Unplug the device before cleaning it.
- Do not wash the entire unit with water and do not immerse it in water. Consult the cleaning instructions in these instructions for use. Do not use any chemical products (such as acids, alkalis, etc.) or corrosive detergents to clean the device.
- Never scrape the transducer with a hard tool. Consult the cleaning instructions in these instructions for use.
- The device should be used preferably for 30 minutes at a time, but can be used several times a day if you wish.
- Be sure to never empty the water from the reservoir through the exhaust vents. This would damage the diffuser. Tip the water out of the side opposite the exhaust vent.
- For optimal maintenance, use mineral water. Do not fill above the line indicating the maximum water level (100 ml). Always pour the water in before adding essential oils or room fragrances.
- Do not use pure essential oils or room fragrances without water.
- This device is not intended for use by people, including children, with reduced physical, sensory or mental capabilities, or people with lack of experience or knowledge, unless someone responsible for their safety can supervise or instruct them beforehand on how to use the device. Children should be supervised to make sure they do not play with the device.
- Use this device only for its intended purpose, as described in these instructions for use.

COMPONENTS

1. Mist outlet; (1)
2. Ceramic cover; (2)
3. Inner plastic cover; (3)
4. Button to turn the device on/off; (4)
5. Transformer; (4)
6. Maximum water level line; (6)
7. Ceramic disc/Transducer; (7)
8. Water spout; (8)
9. Plastic water reservoir; (9)
10. Exhaust vent; (10)
11. DC-jack/transformer socket. (11)

INSTRUCTIONS FOR USE

Features:

- Ceramic cover;
- Total capacity of 100 ml;
- Up to 7 hours of continuous diffusion;
- Input power: AC 100-240V, 50-60Hz;
- Output power: DC24V 500mA;
- Lifespan of the ceramic disc: +/- 3,000 hours.

Functionalities:

- Essential oil diffuser;
- Eliminates electrostatic charges;
- Improves ambient air quality.

Instructions for use:

- Place the Java diffuser in the room half an hour before turning it on to allow it to adjust to the room temperature.
- Check that the diffuser is clean.
- Insert the end of the adapter in the DC-jack socket located under the base of the diffuser. (12)
- Place the diffuser on a flat, stable surface, keeping it away from the edge. (13)
- Remove the outer ceramic cover from the base of the diffuser and then remove the inner plastic cover from the diffuser. (14)
Note: as the cover is made of ceramic it can break easily.
- Fill the reservoir with no more than 100 ml of mineral water and ensure the water level is no higher than the line shown on the inside of the base. (The temperature of the water should not exceed 40°C). (15)
- Pour a few (2-5) drops of essential oil into the reservoir. (16)
- Replace the ceramic cover on the filled water reservoir. Take care when handling. The ceramic cover is simply placed on the plastic base, it is not secured. Make sure there is no space between the base of the diffuser and the ceramic cover. (17)
- With dry hands, connect the power supply plug. (18)
- Press the ON/OFF button on the base of the diffuser to switch it on. The mist it diffuses creates an ambiance that encourages relaxation. (19)
- The diffuser has several functions:
 - Press once to start diffusion and atmospheric light effects. (20)
 - Press a second time to set your preferred atmospheric colour. (21)
 - Press a third time to stop the atmospheric light effect. The diffuser will continue to diffuse. (22)
 - Press a fourth time to switch the diffuser off. (23)

When the water level in the reservoir is too low or empty, the device will stop automatically. A light will then flash in the bottom of the water reservoir. If this happens, refill the water following the steps in the instructions for use to restore normal operation.

NOTE: Use the spout to empty the water from the reservoir out of the side opposite the exhaust vent. Never empty the water through the exhaust vent. This would damage the diffuser. (24)

N.B.: EVEN THOUGH THERE IS A SAFETY DEVICE THAT STOPS THE TRANSDUCER WORKING, DO NOT LEAVE THE DEVICE CONNECTED WHEN YOU ARE NOT USING IT.

ADDITIONAL INFORMATION RELATING TO THE USE OF ESSENTIAL OILS

- Before using essential oils, please check the harmful effects that use of these products may have on your health.
- Always choose quality essential oils that are pure, 100% natural and intended for diffusion. Use them in moderation and with care. Follow the instructions and warnings stated on the packaging of the essential oils, in particular noting that:
 - Pregnant women, people with epilepsy, asthmatics and people who suffer from allergies, and those with heart problems or serious illnesses should not use essential oils.
 - Essential oils should be used only for periods not exceeding 10 minutes in a baby's room (under 3 years old) and only when the baby is not actually in the room.
- Make sure that children and minors do not play with or use the device.
- Just a few drops (3 to 4 drops at most) of essential oils are sufficient to ensure that the device works properly and the scent is diffused. Excessive use of essential oils could damage the device.

- Make sure you pour water into the reservoir first before adding the drops of essential oils.
- Lanaform® cannot be held liable in the event of accidental damage resulting from any use contrary to the instructions given in these instructions for use.

MAINTENANCE AND STORAGE

If the water contains too much calcium and magnesium, it may deposit a "white powder" in the device. If this foam is deposited on the transducer (ceramic ring producing ultrasounds, diagram 1, point 5), this will prevent the device from working properly.

Maintenance:

We recommend:

1. Using cooled, boiled water for each use;
2. Cleaning the reservoir every 2 days and cleaning the transducer every week;
3. Changing the water in the reservoir every 2 days;
4. Cleaning the device and making sure that all its parts are completely dry when it is not in use.

To clean the transducer:

1. Switch the device off and unplug it;
2. Put 2 to 5 drops of vinegar on its surface and leave them there for 2 to 5 minutes;
3. Brush the foam off the surface with a soft brush (cotton bud) (25). Do not use a hard tool to scrape the surface;
4. Rinse the reservoir of the base in clean water;
5. Do not use soap, solvent or spray cleaner to clean the transducer.

To clean the reservoir:

1. Switch the device off and unplug it;
2. Clean the reservoir with water using a soft cloth and vinegar if there are any foam or limescale deposits on the inside. (26)
3. Rinse the reservoir in clean water.

Storage:

After cleaning and drying the device, store it in a dry, cool place out of the reach of children.

TROUBLESHOOTING

In the event of a malfunction, under normal conditions of use, please refer to the following chart:

Breakdowns	Possible causes	Solutions
No mist, no light	The power is not connected.	Connect the device to the power supply and press the button.
	The water level in the reservoir is too low.	Add water to the empty reservoir.
	Too much water in the reservoir.	Empty water out of the reservoir.
	The temperature of the unit is too low.	Place the unit in a room at ambient temperature for half an hour prior to use.
Mist has an unusual smell	The water has been standing in the reservoir too long.	Clean the reservoir and pour fresh water into it.
Low intensity	Too much/little water in one reservoir.	Empty water out of this reservoir or add water to it.
	Sediment on the transducer.	Clean the transducer.
	The water is too cold.	Use water that is at room temperature.
	The water is not clean.	Clean the reservoir(s) and pour fresh water in.

ADVICE REGARDING THE DISPOSAL OF WASTE

- All the packaging is composed of materials that pose no hazard for the environment and which can be disposed of at your local sorting centre to be used as secondary raw materials. The cardboard may be disposed of in a paper recycling bin. The packaging film must be taken to your local sorting and recycling centre.
- When you have finished using the device, please dispose of it in an environmentally friendly way and in accordance with the law.

LIMITED WARRANTY

LANAFORM® guarantees this product against any material or manufacturing defect for a period of two years from the date of purchase, except in the circumstances described below.

The LANAFORM® guarantee does not cover damage caused as a result of normal wear to this product. In addition, the guarantee covering this LANAFORM® product does not cover damage caused by abusive or inappropriate or incorrect use, accidents, the use of unauthorized accessories, changes made to the product or any other circumstance, of whatever sort, that is outside LANAFORM®'s control.

LANAFORM® may not be held liable for any type of circumstantial, indirect or specific damage. All implicit guarantees relating to the suitability of the product are limited to a period of two years from the initial date of purchase as long as a copy of the proof of purchase can be supplied.

On receipt, LANAFORM® will repair or replace your appliance at its discretion and will return it to you. The guarantee is only valid through LANAFORM®'s Service Centre®. Any attempt to maintain this product by a person other than LANAFORM®'s Service Centre will render this guarantee void.

LANAFORM®

SA LANAFORM NV

**Zoning de Cornémont
rue de la Légende, 55
B-4141 LOUVEIGNE
BELGIUM**

**Tél. +32 (0)4 360 92 91
Fax +32 (0)4 360 97 23**

**info@lanaform.com
www.lanaform.com**