



## **Quick Installation Guide**

RTL Auto Installation Version

M0304201 V2.0

The product user guide contains product features, how to use, and the operating procedure. Read the user manual carefully to get the best experience and avoid unnecessary damage. Keep this manual for future reference.

Strictly comply with applicable laws and regulations at the place of use. The device must not be used in violation of applicable legislation or for illegal purposes.

The company Alza.cz a.s. bears no responsibility if the device is used in violation of applicable legislation or for illegal purposes.

**Importer:** Alza.cz a.s., Jankovcova 1522/53, 170 00 Prague 7, [www.alza.cz](http://www.alza.cz)

## Note

1. This installation guide is only user for WiFi receiving mode. If you need to use AP mode, you have to download related driver on our website: [www.szcomfast.com](http://www.szcomfast.com).
2. The different configuration on different computer may cause the self-drive function to fail. Please open "Computer" and double-click "CD COMFAST" to start self-drive function.

**If the products use WPS function keys, you have to download related driver on our website: [www.szcomfast.com](http://www.szcomfast.com).**

## 1. Auto-Installation

Steps are very similar for installation on Windows 10/8.1/8/7/XP. Here we use Windows 7 as an example.

Insert the wireless adapter into the computer, open "Computer" and double-click "CD Driver(H:) WifiAutoInstall".

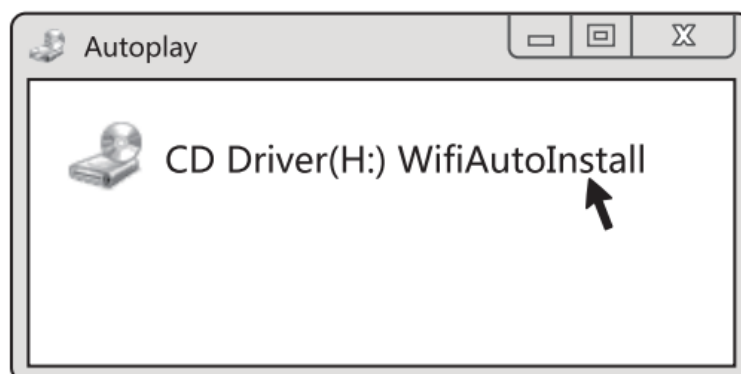

## 2. Installation Finished

Please click the "Install" button to complete the installation.

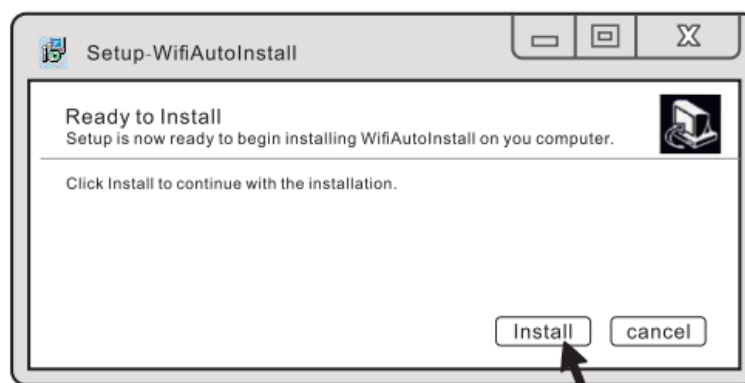

### 3. Network Connection

Click wireless connection icon and then choose the available WiFi signal.



## Warranty Conditions

A new product purchased in the Alza.cz sales network is guaranteed for 2 years. If you need repair or other services during the warranty period, contact the product seller directly, you must provide the original proof of purchase with the date of purchase..

**The following are considered to be a conflict with the warranty conditions, for which the claimed claim may not be recognized:**

- Using the product for any purpose other than that for which the product is intended or failing to follow the instructions for maintenance, operation and service of the product.
- Damage to the product by a natural disaster, the intervention of an unauthorized person or mechanically through the fault of the buyer (eg during transport, cleaning by inappropriate means, etc.).
- Natural wear and aging of consumables or components during use (such as batteries, etc.).
- Exposure to adverse external influences, such as sunlight and other radiation or electromagnetic fields, fluid intrusion, object intrusion, mains overvoltage, electrostatic discharge voltage (including lightning), faulty supply or input voltage and inappropriate polarity of this voltage, chemical processes such as used power supplies, etc.
- If anyone has made modifications, modifications, alterations to the design or adaptation to change or extend the functions of the product compared to the purchased design or use of non-original components.

## EU Declaration of Conformity

### Identification data of the manufacturer's / importer's authorized representative:

Importer: Alza.cz a.s.

Registered office: Jankovcova 1522/53, Holešovice, 170 00 Prague 7

IČO: 27082440

### Subject of the declaration:

Title: WiFi USB adapter

Model / Type: Comfast VU757F V2

**The above product has been tested in accordance with the standard (s) used to demonstrate compliance with the essential requirements laid down in the Directive (s):**

Directive No. 2014/53/EU

Directive No. 2011/65/EU as amended 2015/863/EU

Prague, 2020/08/27



## WEEE

This product must not be disposed of as normal household waste in accordance with the EU Directive on Waste Electrical and Electronic Equipment (WEEE - 2012/19 / EU). Instead it shall be returned to the place of purchase or handed over to a public collection point for the recyclable waste. By ensuring this product is disposed of correctly, you will help prevent potential negative consequences for the environment and human health, which could otherwise be caused by inappropriate waste handling of this product. Contact your local authority or the nearest collection point for further details. Improper disposal of this type of waste may result in fines in accordance with national regulations.

