



GameSir T4

Wireless Controller

User's guide

Importer

Alza.cz a.s.

Jankovcova 1522/53

Holešovice 170 00 Prague 7

www.alza.cz

Dear customer,

Thank you for purchasing our product. Please read the following instructions carefully before using for the first time and keep this user manual for future reference. Pay particular attention to the safety instructions. If you have any questions or comments about the device, please contact the customer line. Customer line, available 24 hours a day: +44 (0)203 514 4411, www.alza.co.uk.

Importer: Alza.cz a.s. Jankovcova 1522/53, Holešovice 170 00 Prague 7, www.alza.cz

NOTICE

- Please read this Precautions carefully before using the product.
- CONTAINS SMALL PARTS. Keep out of reach of children under the age of 3. Seek immediate medical attention if swallowed or inhaled.
- DO NOT use the product near fire.
- DO NOT expose to direct sunlight or high temperatures.
- DO NOT leave the product in a humid or dusty environment.
- DO NOT impact the product or cause it to fall due to strong impact.
- DO NOT touch USB port directly or it might cause malfunctions.
- DO NOT strongly bend or pull cable parts. Use a soft, dry cloth while cleaning.
- DO NOT use chemicals such as gasoline or thinner.
- DO NOT disassemble, repair or modify.
- DO NOT use for purposes other than its original purpose. We are NOT responsible for accidents or damage when used for non-original purposes.
- DO NOT look directly at the optical light. It might damage your eyes. If you have any quality concerns or suggestions, please contact GameSir or your local distributor.

PRODUCT DESCRIPTION

GameSir T4 wireless controller is designed for a strengthened gaming experience. It is compatible with Windows 7 or above through wired and 2.4 GHz low delay transmission wireless connection. GameSir T4 has LB & RB buttons, D-pad, silicone anti-skid 3D joystick and sensitive triggers. Key configurations of M1-M4 buttons at the backside are customizable and can be freely combined. Dual motors bring strong vibration feedback. Ergonomic handles are unevenly engraved and designed for anti-skid handhold. The product has translucent design with LED ABXY buttons on the right.

PACKAGE CONTENTS

GameSir T4 Wireless Controller

2.4 GHz Wireless Receiver

Type-C charging cable

Instruction Manual

SYSTEM REQUIREMENT

Windows 7/8/10

REGISTRATION

Register your GameSir ID at <https://gamesir.hk/> to get real-time information on your product's warranty status and series of GameSir exclusive benefits.

WHAT YOU'LL GET

- * 12 months limited manufacturer's warranty
- * Free online technical support at <https://gamesir.hk/> (Supports English and Japanese)

DEVICE LAYOUT

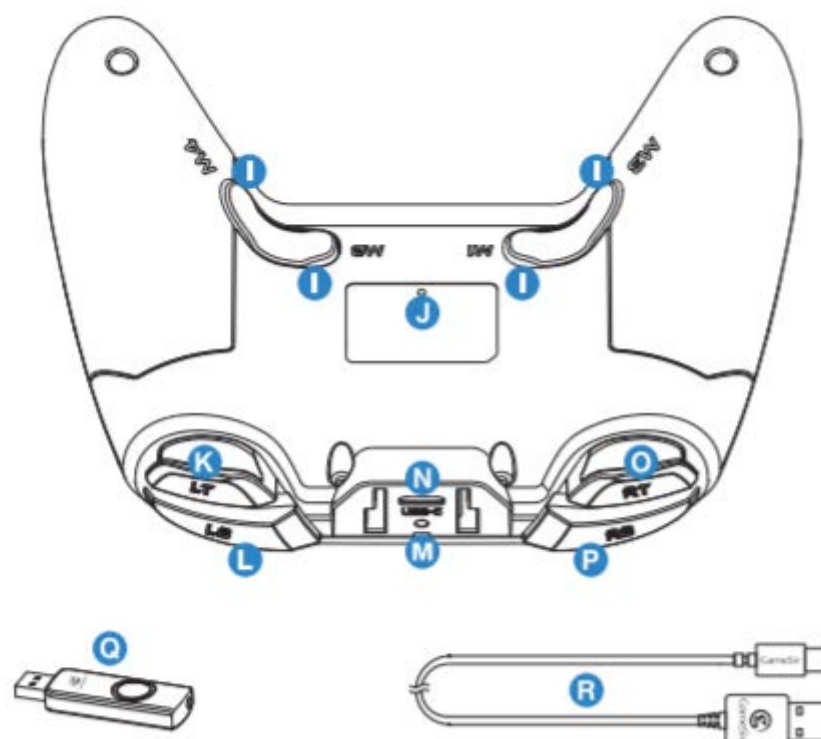

- A. Back button
- B. Start button
- C. Turbo button
- D. Home button
- E. A/B/X/Y buttons
- F. Backlight loop
- G. LED light indicators
- H. D-Pad
- I. Configurable buttons (M1/ M2/ M3/ M4)
- J. Reset
- K. LT Button
- L. LB Button
- M. Charging light indicator
- N. Type-C connector
- O. RT button
- P. RB button
- Q. 2.4 Ghz Dongle
- R. USB cable

CONNECTION

Connect to PC via 2.4 GHz receiver (Xinput Mode)

- Click Home button to turn on GameSir T4 Wireless Controller, LED indicator lights scroll up and down, the controller can be connected.
- Plug 2.4 GHz receiver into PC's USB port.
- When 2.4 GHz receiver indicator lights up and LED1+LED4 of GameSir T4 Wireless Controller stay on, Xinput Mode is connected successfully. GameSir T4 Wireless Controller can be used normally.

* Hold Home button for 5 seconds, GameSir T4 Wireless Controller can switch between Xinput Mode and Dinput Mode.

Xinput Mode: LED1+LED4 indicators stay on

Dinput Mode: LED1+LED3 indicators stay on.

Connect to PC via Type-C charging cable (Xinput Mode)

- Connect GameSir T4 Wireless Controller to PC's USB port via Type-C charging cable.
- When LED1+LED4 of GameSir T4 Wireless Controller stay on, Xinput Mode is connected successfully.
- The corresponding driver will be automatically installed on PC. GameSir T4 Wireless Controller can be used normally.

* Hold Home button for 5 seconds, GameSir T4 Wireless Controller can switch between Xinput Mode and Dinput Mode.

Xinput Mode: LED1+LED4 indicators stay on

Dinput Mode: LED1+LED3 indicators stay on.



Dinput mode



Xinput mode

CONFIGURABLE M BUTTONS

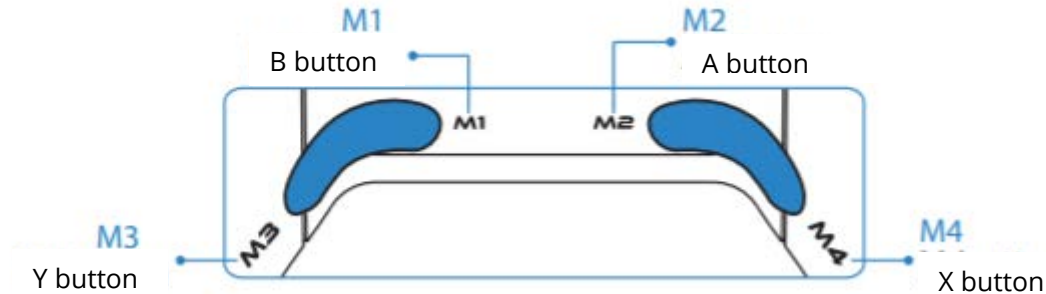

- Hold M1 then START or BACK, the backlight loop turns red and blue simultaneously to be set up.
- Hold the keys you want to combine.
- Press M1 again, the red backlight loop turns off. Combination is successfully set.
- These keys can be set up as combination buttons:
A, B, X, Y, L1, L2, L3, R1, R2, R3.
They can be freely combined, either combination keys or single button.
- M2, M3, M4 have the same settings as M1.
This function can be set up only when the controller is successfully connected.

TURBO FUNCTION

- Press the key where you want to set turbo function, press TURBO key simultaneously, then back light turns into red and Turbo function is successfully set.
- Press the key that is successfully set for Turbo function, press TURBO key simultaneously, then back light turns into red and Turbo function is successfully cancelled.

* The following buttons can be used to set for Turbo function: A, B, X, Y, LB, RB, LT, RT.

AUTOMATIC POWER OFF

When GameSir T4 Wireless Controller is connected, it will automatically power off within 180 seconds under no operation.

When GameSir T4 Wireless Controller is disconnected, it will automatically power off within 30 seconds under no operation.

CHARGING

It takes 1.5 to 2 hours to full charge GameSir T4 Wireless Controller. The charging indicator light keeps steady red during charging. When fully charged, the charging indicator light goes off. Please unplug the Type-C charging cable.

LIGHTING ADJUSTMENT AND MOTOR VIBRATION INTENSITY ADJUSTMENT

Lighting adjustment:

Hold LT, RT, R3 simultaneously then press up or down of D-pad to adjust lighting. The lowest level is light off among 5 levels of lighting.

ABXY backlight adjustment:

Hold LB+RB for 5 seconds to switch backlight on/off.

Motor vibration intensity adjustment:

Hold Turbo then press up or down of D-pad to adjust vibration. The lowest level is vibration off among 5 levels of vibration.

LOW BATTERY ALERT

GameSir T4 Wireless Controller shows low power condition (less than 10%) when:

1. Battery voltage is less than 3.5V;
2. LED indicator light flashes;
3. Vibration is off

RESET

Stick a slender pin into the Reset button on the back of GameSir T4 Wireless Controller to reset. The controller will turn off and reboot.

WARRANTY CONDITIONS

A new product purchased in the Alza.cz sales network is guaranteed for 2 years. If you need repair or other services during the warranty period, contact the product seller directly, you must provide the original proof of purchase with the date of purchase.

The following are considered to be a conflict with the warranty conditions, for which the claimed claim may not be recognized:

- Using the product for any purpose other than that for which the product is intended or failing to follow the instructions for maintenance, operation and service of the product.
- Damage to the product by a natural disaster, the intervention of an unauthorized person or mechanically through the fault of the buyer (e.g. during transport, cleaning by inappropriate means, etc.).
- Natural wear and aging of consumables or components during use (such as batteries, etc.).
- Exposure to adverse external influences, such as sunlight and other radiation or electromagnetic fields, fluid intrusion, object intrusion, mains overvoltage, electrostatic discharge voltage (including lightning), faulty supply or input voltage and inappropriate polarity of this voltage, chemical processes such as used power supplies, etc.
- If anyone has made modifications, modifications, alterations to the design or adaptation to change or extend the functions of the product compared to the purchased design or use of non-original components.

This product has been tested in accordance with the standards used to demonstrate compliance with the essential requirements set out in the relevant directives. You can find the declaration of conformity on the alza.cz website.



WEEE

This product must not be disposed of as normal household waste in accordance with the EU Directive on Waste Electrical and Electronic Equipment (WEEE - 2012/19 / EU). Instead it shall be returned to the place of purchase or handed over to a public collection point for the recyclable waste. By ensuring this product is disposed of correctly, you will help prevent potential negative consequences for the environment and human health, which could otherwise be caused by inappropriate waste handling of this product. Contact your local authority or the nearest collection point for further details. Improper disposal of this type of waste may result in fines in accordance with national regulations.

