

Support

To learn more about your Nest Mini, visit [**g.co/nest/help**](https://g.co/nest/help)

For online help and support, visit [**g.co/nest/help**](https://g.co/nest/help)

To get in touch with an expert, visit [**g.co/nest/contact**](https://g.co/nest/contact)

Let's get started

Google

1

Connect the power adaptor to your Google Nest Mini.

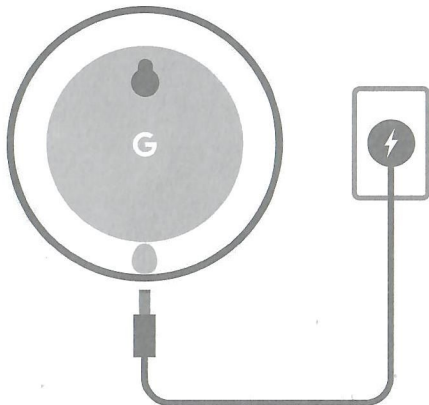

2

Download the Google Home app from the Google Play Store or Apple App Store. Then follow the on-screen steps to finish setup.



Google Nest Mini, Google Play and Google Home are trademarks of Google LLC.
App Store is a service mark of Apple Inc., registered in the US and other countries.

After setup is complete in the Google Home app,

just start with “Hey Google”

Listen to music

“Play some music”*
“Next song”
“Turn up the volume”
“Play relaxing sounds”
“Play my party playlist on all speakers”*

Command your day

“What’s the weather this weekend?”
“Will I need an umbrella today?”
“What time is it?”
“When is the sunset?”
“What’s the latest news?”

Get things done

“Wake me up at 6 AM tomorrow”
“Set a timer for 10 minutes”
“Remind me to call mum”
“Add eggs to my shopping list”
“Call Granddad”*

Control your home

“Turn on the TV”*
“Turn on the light”*
“Turn up the thermostat”*
“Broadcast ‘dinner is ready’”
“Play cooking videos on my TV”*

For more suggestions, say “Hey Google, what can you do?”

To discover more about Nest Mini, visit g.co/mini/explore

* Controlling certain devices and features in your home require compatible smart devices and/or a Google Chromecast or TV with Chromecast built-in. Subscriptions are required to access some content. To make calls, a Google Duo account is required for you and the call recipient.

Nest Mini touch controls

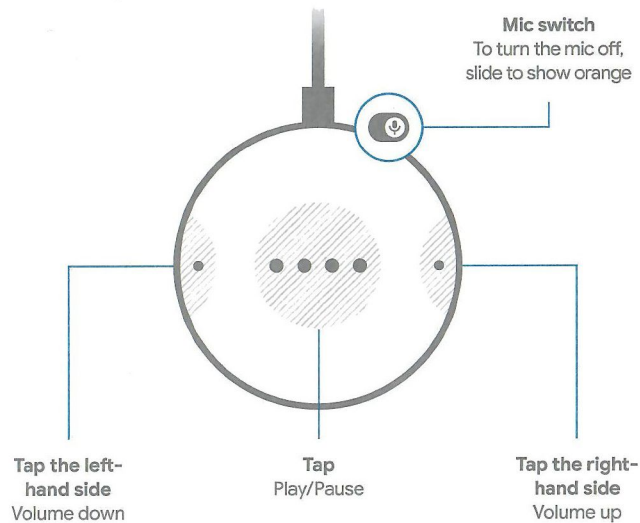

Wall mount (optional)

1. Hang your Nest Mini near a wall socket
2. To learn about volume control positions and how to mount your device, visit g.co/mini/wallmount

