

# **4G Video Call IP67 Waterproof GPS Kids Watch**

## **User Manual**



**Please read the instruction before using the watch. Picture  
only for reference**

### **1. Before using**

a. Check whether the watch is the purchased model and has complete accessories: 1 GPS Watch 1 Charger, 1 User manual, 1 screwdriver, 1 Toolkit bag with extra screws.

b. Buy a Micro SIM card which supports 4G network. SIM card

need enable GPRS data and caller ID function

c. Turn off the watch before installing the SIM card.

d. Battery charging by connecting with computer is recommended,  
the charging time is around 2 hours

Note: battery charging should be under adult supervision.

e. Scan the barcode in the last page to download the APP –  
Setracker2

## **2. Brief Watch Function**

- LBS+GPS+ WIFI real-time Positioning
- Two-way phone call and voice chat
- WIFI network available
- SOS Emergency phone call and alert
- 0.3 MP Camera and Video call
- Waterproof Level IP67
- Do not disturb mode when kids on class
- Math Game and schedule
- Make friends between watches
- Step counter, Flash light

**Note: swimming with watch is not recommended**

### 3. Set up watch with APP

#### 3.1 Registration and Binding watch

First, to enter Email address as the account name, then fill into the verification code as photo shows, the password set with 6-12 characters, numbers and letters all supported. And make sure you have **chosen the right server area which your country belongs to.**

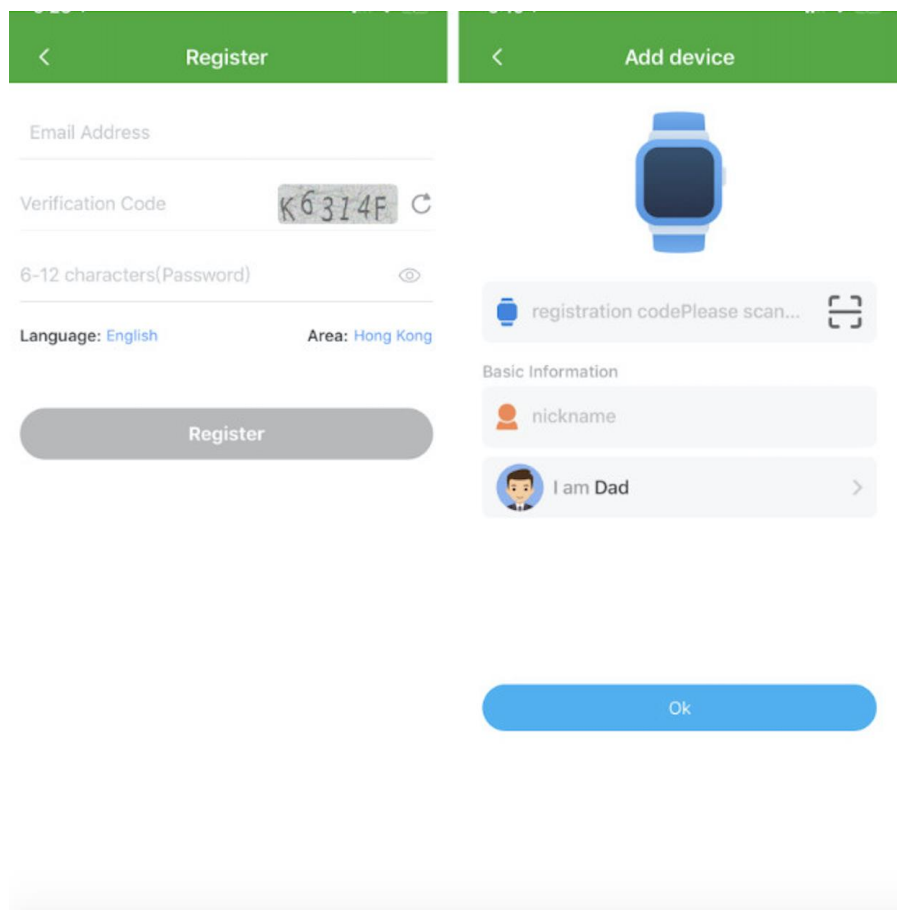

The screenshot displays two side-by-side panels from a mobile application. The left panel, titled 'Register', contains input fields for 'Email Address', 'Verification Code' (with a sample code 'K6314F' and a refresh icon), and '6-12 characters (Password)' (with an eye icon for toggling visibility). Below these fields are dropdown menus for 'Language: English' and 'Area: Hong Kong', followed by a grey 'Register' button. The right panel, titled 'Add device', features a blue smartwatch icon at the top. Below it is a QR code scanner area with the text 'registration codePlease scan...' and a QR icon. Underneath is a 'Basic Information' section with a 'nickname' field and a profile card showing a cartoon character and the text 'I am Dad' with a right-pointing arrow. At the bottom of the right panel is a blue 'Ok' button.

Important: The first family member who bind the watch will be the admin account. If the second family member also want to bind watch to check kids' status, then he/she can set up a new account but get

authorization from admin account.

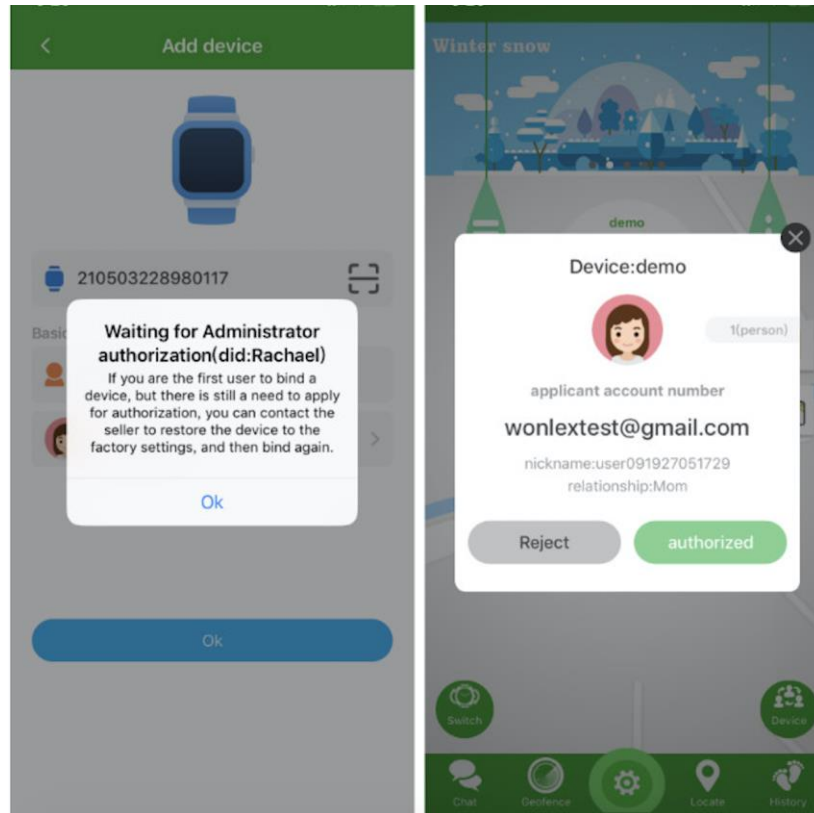

Notice: if you are the admin account but still get alerts of waiting for authorization then the reset will be required. Please contact the seller for support.

## 4.2 Quick review of APP main function

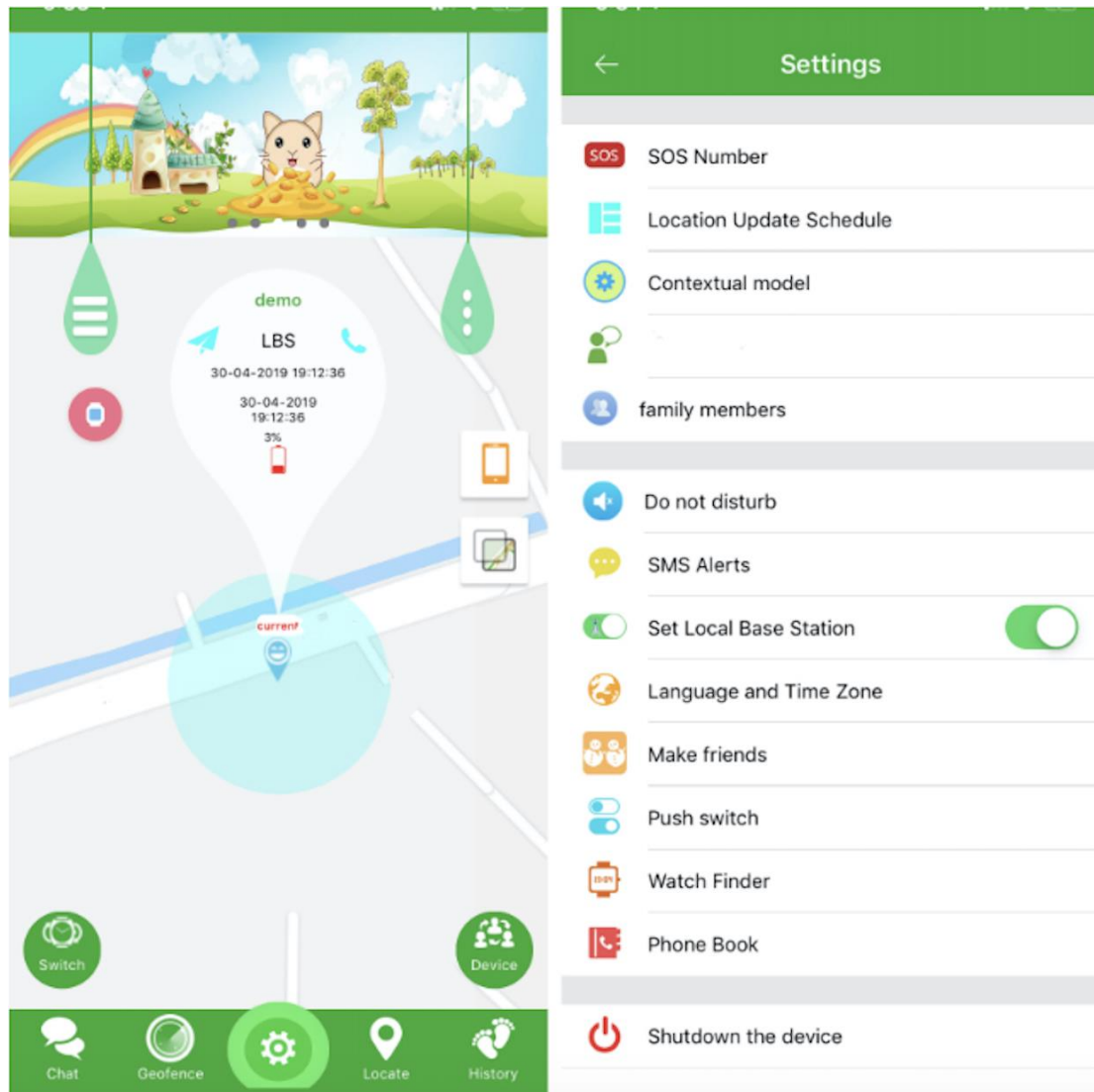

(1) **Chat:** Hold the “start recording” button to record voice message and Release to send. The longest voice message can be 15 seconds. Meanwhile, you can also send short message to the watch with limiting characters (< 30). Like “I am here”.

(2) **Locate:** Check the position of the watch in real time. Each round of positioning time is 3 minutes when locate function is triggered. After that, device will back to the default working mode. The GPS/LBS/WIFI location mode will be displayed in the map and each mode works depending on the real-time signal of watch. Normally,

When watches are inside building, LBS location will be shown but location accuracy is not good.

**(3)GEO fence:** The minimum circle need to over 200 meters, with maximum THREE safety zone can be set. When users go in and out of the fence, there will has alarm information send to the guardian numbers. Note: fence alarm information only when the watch GPS is triggered, base station (LBS)positioning fence has no alarm information.

**(3)History:** This function is used to check the history route of kids in different period. The location data can be saved up to 90 days.

#### **(4)Settings for watches**

a. SOS number: Maximum 3 phone numbers can be saved. Watch will call the SOS numbers automatically by pressing the physical SOS button on watch for 3 seconds, once the emergency call is triggered, alert message will send to APP and the three SOS phone numbers will be called one after another untill the call is answered.

b. Sound guardian: Enter your phone numbers and confirmed, then phone call from watch will come, after you pick up, then you can hear the surroundings without kids notice.

c. Data Upload intervals: three working modes to choose, the default working mode is every 10 minutes; power saving mode to update location is every 1 hour, and the real-time positioning mode is 1

minute, which is most battery consumption.

d. Night mode: to turn on this function watch will disconnect with network between 22:00 – 06:00

e. Do Not Disturb: Three time periods can be set. All incoming calls will be blocked under DND mode, and the home screen will be locked. This function also known as Class mode only works from Monday to Friday.

f. SMS alerts: You can enable low power and SOS alerts by SMS notification. When the battery is less than 20% and SOS Call made, alarm messages will send to the your phone, meanwhile, there will have also APP notification.

g. Phone book: Maximum 15 contacts can be added. Including SOS numbers, all these number can call into watch and kids can find and call these contacts from the watch phonebook.

h. Make friends: to have 2 working watches, Start “make friend” in both watches, then “Knock” gently together the watches screen, If the pairing is successful you will hear a sound, and the watches will show “paired”.

i. Watch finder: Useful function when you can not find watch., once the function is enabled, watch will ring.

j. Remote shutdown: When watch connects with APP and using internet, watch cannot be turned off by pressing button, you can

remote shutdown watch from APP.

**(5) More function.** On the left button on home page

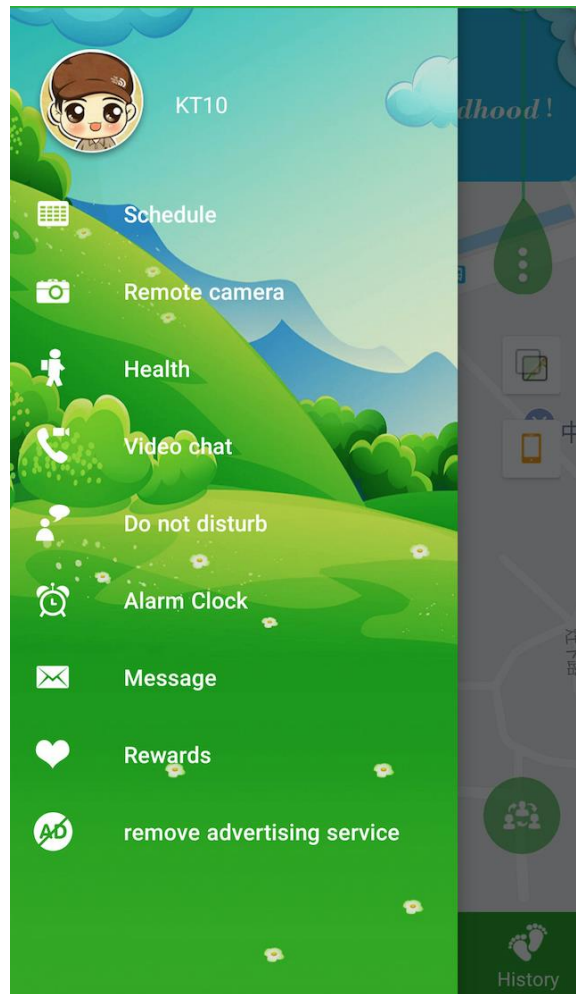

- a. **Schedule:** Setting course details for class schedule.
- b. **Remote Camera:** To remotely take photo from watch
- c. **Health:** To start “Step” in the watch, you have to open the switch in “walk”. Also you can check, amount of exercise, distance and sleep monitor.
- d. **Video call.** To start video call with watch
- e. **Alarm Clock & Rewards :** Maximum 3 alarms can can be set up. And rewards can be send by adding up the numbers.



f. **Remove add:** if you want to disable ads in Setracker2, please check more information here.

g. **Message:** to show the earlier notifications.

(6)**Account info:** On the right bubble of home page,

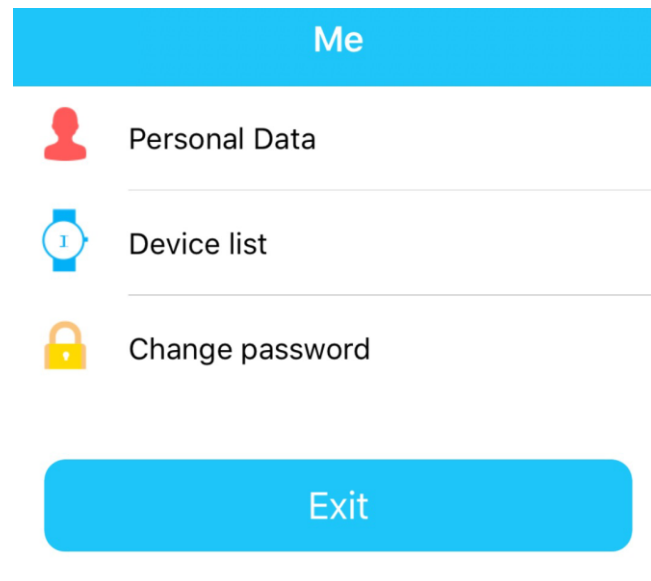

a. Personal info: It contains account name, avatar, kids' name, gender, **phone numbers**.

b. Device list: If you have more than one device to monitor, then you can add them in one account.

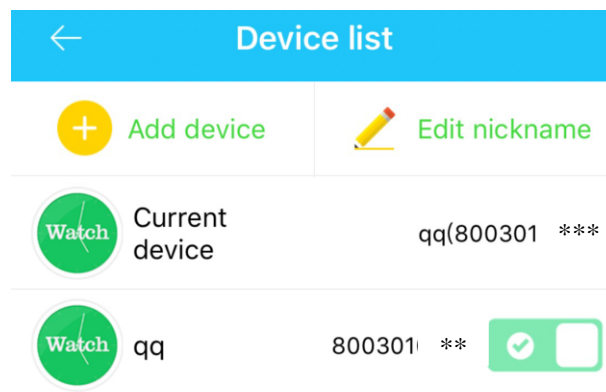

c. “Change password” to update password.

- d. “Exit” to log out the account

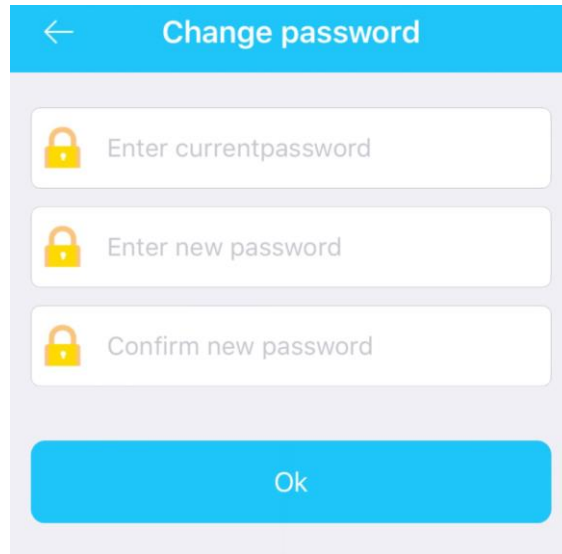

## 7. Troubleshooting

### 1. Can not register an account/Forget Password

When you are facing problems of adding device with error of ID does not exist or is already registered or forget the account password. Please contact us directly to reset the device then you can create new account from the very beginning.

### 2. The device is offline/Not connecting with Internet.

- Make sure your SIM card is credits, supports 2G network, and data and caller ID enabled
- Send SMS command: **pw,123456,ts#** from your phone to the phone number in watch; in following minutes, there will have

message replied with watch parameter. When you contact for support, those information is required and

## **8. Download the APP**



Support Android and iOS. APP: Setracker2

Please kindly notice the company reserves the right to modify the instruction contents without any further notice and small part of the contents might be different in particular software and model version.