



User Manual

MiVueTM C320/C330 Series

Table of Contents

Getting to know your dash cam	2
Power button	3
Function keys	3
System icons	4
System indicator	4
Using your recorder in a vehicle	5
Inserting a memory card	7
Formating a card	7
Operating basics	8
Turning the recorder on	8
Setting the date and time	8
Recording in driving mode	9
Recording in Parking mode	9
Camera mode	10
Playback mode	10
Safety camera alerts	12
Adding a safety camera	13
Updating safety camera data	13
System settings	14
MiVue Manager	17
Installing MiVue Manager	17
Playing the recording files	17
For more information	20
Caring for your device	20
Precautions and notices	21
Safety precautions	21
About GPS	22
Regulatory information	23
WEEE	24

Getting to know your dash cam

Note: The screenshots and other presentations shown in this manual may differ from the ones generated by the actual product.

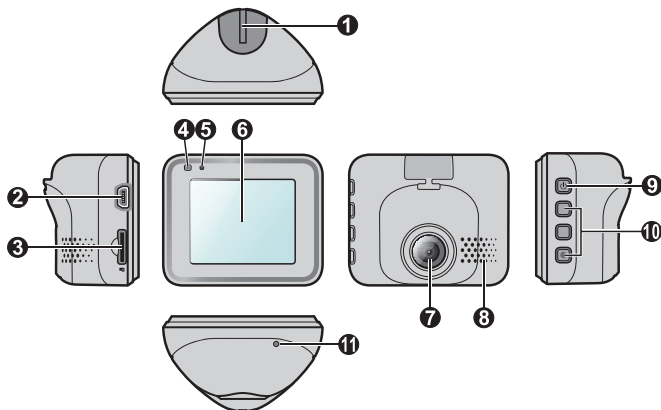

- | | |
|-----------------------|-----------------------------|
| ① Device mount socket | ⑦ Camera lens |
| ② Mini-USB connector | ⑧ Speaker |
| ③ Memory card slot | ⑨ Power button/Function key |
| ④ System indicator | ⑩ Function keys |
| ⑤ Microphone | ⑪ Shutdown button |
| ⑥ LCD screen | |

Power button

Press and hold for 2 seconds to manually turn the recorder on and off.





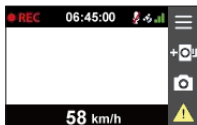

Note: If the system does not turn off by keeping the Power button pressed, you can force it to shut down by inserting a small rod (such as a straightened paperclip) into the Shutdown button.

Function keys

The device provides 4 function keys to control the corresponding icons displayed on the LCD screen. The keys' functions may vary on different screens.







Recording screen

-  Opens the Menu screen
-  Adds a custom safety (speed) camera
-  Takes a photo
-  Manually starts an event recording



Menu screen

-  Acts as the BACK button
-  Acts as the ENTER button
-  Moves to the previous option
-  Moves to the next option

System icons

Various system icons on the title bar at the top of the screen provide the status information of your device. The icons displayed will vary depending on your device model and state.

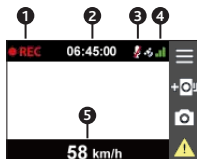

- ❶ Recording indicator
- ❷ Time display
- ❸ Recording with sound is disabled
- ❹ GPS signal*
- ❺ Your current speed*

* For selected models only.

System indicator

The System indicator glows in **green** when the recorder is charging. During charging, it flashes in **green** and **amber** alternately while the recording is in progress.

Using your recorder in a vehicle

Make sure that your car is parked on level ground.

1. Follow the instructions below to securely mount your recorder in a vehicle.

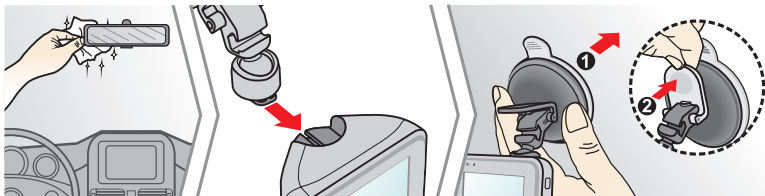

2. Connect the car charger to the cigarette lighter. Route the cables through the top ceiling and the A-pillar so that it does not interfere with driving. Make sure that the cable installation does not interfere with the vehicles airbags or other safety features.

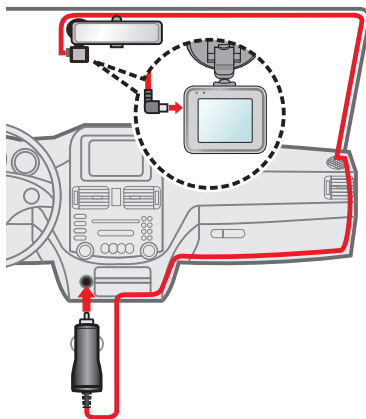

3. When adjusting the angle of mounting, make sure that the camera's view is parallel with the level ground and the ground/sky ratio is close to 6/4.



Note:

- To ensure the highest quality recordings, you are advised to place the recorder near the rear-view mirror.
- Select an appropriate location for mounting the device in a vehicle. Never place the device where the driver's field of vision is blocked.
- (For selected models only) If the car's windscreen is tinted with a reflective coating, it may be athermic and impact the GPS reception. In this instance, please mount your device where there is a "clear area."
- The system will automatically calibrate the G sensor of the device during start-up. To avoid G sensor malfunction, always turn the device on AFTER you mount it in the vehicle properly.

Inserting a memory card

You must insert a memory card (not supplied) before you can start recording. The recorder supports Class 10 memory cards with 8 GB - 128 GB capacity.

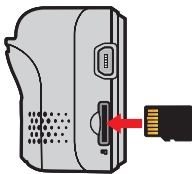

- Hold the card (MicroSD) by the edges and gently insert it into the slot as shown in the illustration.
- To remove a card, gently push the top edge of the card inwards to release it and pull it out of the slot.

Note:

- DO NOT apply pressure to the centre of the memory card.
- MiTAC does not guarantee the product's compatibility with memory cards from all manufacturers.
- Before you start recording, please format the memory card to avoid malfunction caused by files not created by the recorder.
- You are recommended to turn the device off before removing the memory card.

Formatting a card

If you need to format a memory card (all data will be erased), press  and select **Format**.







Operating basics

Turning the recorder on

Complete the installation according to the instructions in the “Using your recorder in a vehicle” section. Once the vehicle engine is started, the recorder automatically turns on.

Setting the date and time

To make sure that the date and time of your recordings are correct, check the settings before you begin recording.



1. Press  to access the Settings Menu.
2. Select **System > Date / Time** and press .
3. Select **Use GPS time*** or **Manual**:
 - When you select **Use GPS time**, the system will set date and time according to the GPS location.
 - When you select **Manual**, the system will display the date and time setting screen.
Use  /  to adjust the value of the selected field; press  and repeat the step until all fields have been changed. When completed, press .

* For selected models only.

Recording in driving mode

Continuous recording

By default, the system will automatically begin with continuous recording within seconds after start up. The recording may be divided into several video clips; recording will not stop between video clips.

- When continuous recording is in progress, you can manually stop recording by pressing .
- Press  to return to the recording screen; the system will start continuous recording automatically.
- The continuous recordings can be found in the “Video” category for file playback.

Event recording

By default, if an event happens such as a sudden impact, high speed driving, an aggressive turn or an accidental crash, the G sensor* will prompt the recorder to start recording the event.

* You can change the sensitivity level (6 levels, from Low to High) of the G sensor by selecting  > Video Recording > G-Sensor Sensitivity.

- If you want to manually start an event recording while continuous recording is in progress, press the Event button ().
- The event recordings can be found in the “Event” category for file playback.

Recording in Parking mode

Note: This feature is not available on all models.

Your dash cam supports the parking recording function. You must use an additional power source to record the video during Parking mode, such as Mio Smart Box uninterrupted power cable which is sold separately. For more information on using Mio Smart Box, see the provided documentation in its package.

The Parking mode function is disabled by default. You can enable the function by selecting  > **Parking Mode** > **Detection** > **On**.

Before enabling Parking mode, please check the memory storage allocation of your device. Select  > **System** > **Storage Allocation** to set a proper allocation for parking recording. Changing the allocation will erase the memory card, so save any videos or photos to your computer first.

When the Parking mode detection is enabled, the system will enter Parking mode when you:

- Disconnect the device's power (for example, when the vehicle engine is stopped or the power cable is disconnected) or when the car stops moving for about 5 minutes.

Note: The feature is triggered by the G sensor of the device. You can change the configuration by selecting  > **Parking Mode** > **Auto Entry**.

- Press  to manually start Parking mode while continuous recording is in progress.

The Parking indicator flashes in red when Parking recording is in progress. To stop Parking mode and resume continuous recording, press . If movements are detected and recorded during Parking mode, you will be asked to playback the video when you stop Parking mode. The parking recordings can be found in the "Parking" category for file playback.

Camera mode









The recorder allows you to take a photo. If the recording is in progress, press  to take a photo.

- The photos can be found in the "Photo" category for file playback.

Playback mode

To select a video or photo for playback:

1. Press  > **File Playback**.
2. Select the desired type: **Video**, **Event** and **Photo**.

-
3. Press  /  to select the desired file from the list, and then press  to start playback.
4. During playback, you can:
- While playing videos, press  /  to play the previous/next video.
 - While viewing photos, press  /  to display the previous/next photo.
 - Press  to return to the list.
 - Press  to display the pop-up menu to select:
 - **Play/Pause:** Starts or pauses the playback.
 - **Move to Event:** Moves the file to the "Event" category.
 - **Delete:** Deletes the file.

Safety camera alerts

Caution: For legal reasons the safety camera function is not available in all countries.

You can receive alerts to warn you about the locations of safety (speed) cameras*, which will enable you to monitor your speed through these areas.

* For selected models only.

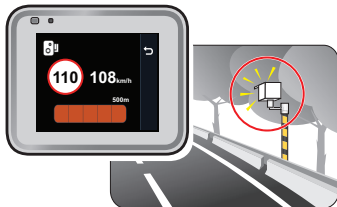



- When a safety camera appears and is positioned in the detectable direction, you will receive alerts. The screen will display the visual alert and you will also receive audio warnings (**Beep**, **Voice**, or **Mute**).
- When the alert sound setting is set to **Beep**:
 - When your car approaches a safety camera, you will receive a normal beep alert.
 - When your car approaches a safety camera at a speed over the set threshold, you will receive a persistent beep alert until your car speed drops lower than the appropriate speed limit.
 - When your car passes through a safety camera, you will be notified by a different beep alert.
- You can change the settings about how you want to receive the safety camera alerts. See the "System settings" section for information.

Adding a safety camera

Note: You can add a custom safety camera only when a GPS fix is established.

Your recorder allows you to customise the safety camera database. You can add up to 100 custom safety cameras in your recorder.

Follow the steps to configure a custom safety camera:

1. To add a custom safety camera in the current location, press  on the recording screen.
2. The next time when you pass by the location, you will receive alerts by the recorder.
3. To view the information of the user-added safety camera, select  > **SafetyCam** > **Custom SafetyCam** and then select the safety camera that you want to check.
4. Press  to remove the custom safety camera from the recorder.

Updating safety camera data

MiTAC does not warrant that all types and locations of safety camera data are available as cameras may be removed, relocated or new cameras installed.

Occasionally MiTAC may offer you updates of safety camera data. Visit Mio website (www.mio.com) for available downloads and follow the instructions to complete update.

System settings

To customise the system settings, press .

Note: Depending on your MiVue model, certain setting options may not be available.

- **File Playback**

Plays the recorded videos and photos.

- **Sound Recording**

Sets if you want to include sounds in the recordings. The default setting is **On**.

- **SafetyCam**

Sets how you want to be notified of safety cameras. The available settings include:

- **Alert Sound:** The options are **Beep**, **Voice** and **Mute**.
- **Alert Distance:** The options are **Short**, **Medium** and **Long**.
- **Alert Method:** The options are **Smart Alert** and **Standard Alert**.
- **Threshold:** Sets the speed value for the recorder to start offering alerts.
- **Cruise Speed Alert:** Sets the limit for cruise speed. When you drive at a cruise speed over the set value, you will receive alerts by the recorder.
- **Custom SafetyCam:** Lists all user-added safety cameras which are sorted by created time.

- **Parking Mode**

Allows you to change the settings of Parking mode. The available settings include:

- **Detection:** When enabled, the dash cam will automatically start recording when it detects movements or if an event happens in Parking mode.
- **Detection Method:** Sets the parking detection method to **Only G-sensor**, **Only Motion** or **Both Motion & G-sensor**.
- **Auto Entry:** Sets the mode (**Low**, **Medium**, **High** or **Manual**) for the system to enter

Parking mode automatically.

- **Motion Detection:** Sets the sensitivity level of motion detection to **Low**, **Medium** or **High**.
- **G-Sensor Sensitivity:** Sets the sensitivity level of the G sensor that allows automatic triggering of the parking recording when the dash cam is in Parking mode.

▪ Video Recording

Changes the settings of recording, including:

- **Video Clip Length:** Sets the length of each video clip for a continuous recording (**1 min**, **3 min** or **5 min**).
- **WDR:** Enables or disables WDR (Wide Dynamic Range) function of the device.
- **EV:** Sets the proper exposure level (**-1** - **+1**) to adjust the brightness of the image. The default setting is **0**.
- **Frequency:** The options are **50 Hz** and **60 Hz**.
- **G-Sensor Sensitivity:** Sets the sensitivity level (6 levels, from **Low** to **High**) of the G sensor that allows automatic triggering of the event recording while continuous recording is in progress.
- **Stamps:** Sets the information (**Coordinates** or **G-Sensor**) that will be displayed on the recorded video.
- **Speed Stamp:** Displays the driving speed on the recorded video.
- **Text Stamp:** Displays customisable text input information.

▪ System

Allows you to change the system settings of the device.

- **Satellites:** Displays the status of GPS/GLONASS signal reception. You can press  and then select **GPS** or **GLONASS** for better signal reception if the need arises.
- **Date/Time:** Sets the system date and time. For more information, see the "Setting the date and time" section.
- **System Sound:** Enables or disables system notification sounds.

-
- **Welcome Sound:** Enables or disables the notification sounds during start-up.
 - **Volume:** Adjusts the volume level.
 - **LCD Standby:** Selects **Always On** to keep the LCD on; or sets the timer for the LCD to turn off automatically (**10 sec, 1 min or 3 min**) after recording starts. Selecting **HUD** will turn off the LCD (in specified time) but still display the time and speed information.
 - **Language:** Sets the language.
 - **Distance Unit:** Sets the preferred distance unit.
 - **Storage Allocation:** The system provides 3 default memory configurations to store the videos and photos. Select the proper configuration based on your usage.
 - **Restore to Defaults:** Restores system settings to factory defaults.
 - **Version:** Displays the software information.
- **Format**
- Formats a memory card. (All data will be erased.)

MiVue Manager

MiVue Manager™ is a tool for you to view the videos recorded on a recorder.

Note: Not all features are available for every model.

Installing MiVue Manager

Download MiVue Manager from the Support page of Mio website (www.mio.com/support) and follow the on-screen prompts to install it. Make sure to download the correct software version (Windows or Mac) according to your computer's operating system.

Playing the recording files

1. Remove the memory card from the recorder and access the card on the computer via a card reader. You are advised to copy the recording files to your computer for backup and playback.
2. Start MiVue Manager on the computer.
 - By default, MiVue Manager shows the calendar and the file list on the right.
 - When a recording file exists, you will see the date marked with "●." Click that date to display the files that were recorded on that date.
 - You can choose the file type to display: **Event / Normal / Parking**.
 - To display all files in the current folder, click **All**. To return to the calendar view click **Calendar**.
3. Double-click the desired file on the file list to start playback.
4. The playback controls are described as follows:

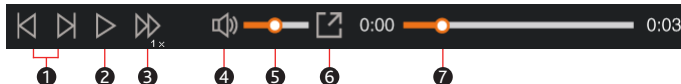

- ❶ Skips to the previous / next file on the list.
 - ❷ Starts or pauses the playback.
 - ❸ Changes the playback speed to 1/4x, 1/2x, 1x (default), 1.5x, or 2x.
 - ❹ Mutes or unmutes the volume.
 - ❺ Adjusts the volume level.
 - ❻ Plays the video in full screen.
 - ❼ Displays the playback progress. You can click on a point along the track bar to move directly to a different location for the playback.
5. During playback, you can check more driving information from the dashboard panel and the G sensor chart that are displayed below the video playback screen.
- On the dashboard panel, click  to display the map screen*.
 - G sensor chart displays data in 3-axis waveform about the car's shift forward/backward (X), to the right/left (Y) and upward/downward (Z).
- * The map screen may not display when the computer is not connected to the Internet or when your MiVue model does not support the GPS function.
6. The tool bar allows you to do the following:

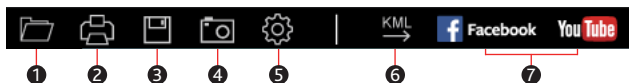

- ❶ Selects the folder that stores the recording files.
- ❷ Previews and prints the current video image.
- ❸ Saves the selected files to the specified location on your computer.
- ❹ Captures and saves the current video image to the specified location on your computer.

-
- 5 Opens the Settings Menu. The Settings items are described as follows:
 - **Change Language:** Sets the display language of MiVue Manager.
 - **Change Skin:** Sets the colour scheme of MiVue Manager.
 - **Check for Update:** Checks if there is any new version of MiVue Manager. Internet access is required for this feature.
 - **About:** Displays the version and copyright information of MiVue Manager.
 - 6 Exports the GPS information of the selected file in the KML format to the specified location on your computer.
 - 7 Uploads the selected file to Facebook / YouTube™.

For more information

Caring for your device

Taking good care of your device will ensure trouble-free operation and reduce the risk of damage.

- Keep your device away from excessive moisture and extreme temperatures.
- Avoid exposing your device to direct sunlight or strong ultraviolet light for extended periods of time.
- Do not place anything on top of your device or drop objects on your device.
- Do not drop your device or subject it to severe shock.
- Do not subject your device to sudden and severe temperature changes. This could cause moisture condensation inside the unit, which could damage your device. In the event of moisture condensation, allow the device to dry out completely before use.
- The screen surface can easily be scratched. Avoid touching it with sharp objects. Non-adhesive generic screen protectors designed specifically for use on portable devices with LCD panels may be used to help protect the screen from minor scratches.
- Never clean your device with it powered on. Use a soft, lint-free cloth to wipe the screen and the exterior of your device.
- Do not use paper towels to clean the screen.
- Never attempt to disassemble, repair or make any modifications to your device. Disassembling, modifying or any attempt to repair could cause damage to your device, may inflict bodily harm or damage to property and will void any warranty.
- Do not store or carry flammable liquids, gases or explosive materials in the same compartment as your device, its parts or accessories.
- To discourage theft, do not leave the device and accessories in plain view in an unattended vehicle.
- Overheating may damage the device.

Precautions and notices

- Do not operate the device while driving. Using this product does not change the requirement for a driver to take full responsibility for his or her behavior. This responsibility includes observing all traffic rules and regulations in order to avoid accidents, personal injury or property damage.
- A window mount is needed when using the recorder in a car. Make sure that you place the recorder in an appropriate place, so as not to obstruct the driver's view or deployment of airbags.
- Make sure that no object is blocking the camera lens and no reflective material is placed near the lens. Please keep the lens clean.
- If the car's windscreen is tinted with a coating, it may impact the recording quality.

Safety precautions

About charging

- Use only the charger supplied with your device. Use of another type of charger may result in malfunction and/or danger.
- This product is intended to be supplied by a LISTED Power Unit marked with "LPS", "Limited Power Source" and output rated + 5 V dc / 1.0 A.

About the charger

- Do not use the charger in a high moisture environment. Never touch the charger when your hands or feet are wet.
- Allow adequate ventilation around the charger when using it to operate the device or charge the battery. Do not cover the charger with paper or other objects that will reduce cooling. Do not use the charger while it is inside a carrying case.
- Connect the charger to a proper power source. The voltage requirements are found on the product case and/or packaging.
- Do not use the charger if the cord becomes damaged.

-
- Do not attempt to service the unit. There are no serviceable parts inside. Replace the unit if it is damaged or exposed to excess moisture.

About the battery

CAUTION! This unit contains a non-replaceable internal Lithium Ion battery. The battery can burst or explode, releasing hazardous chemicals. To reduce the risk of fire or burns, do not disassemble, crush, puncture or dispose of in fire or water.

- Use a specified battery in the equipment.
- Important instructions (for service personnel only)
 - Caution! Risk of explosion if battery is replaced by an incorrect type. Dispose of used batteries according to the instructions.
 - Replace only with the same or equivalent type recommended by the manufacturer.
 - The battery must be recycled or disposed of properly.
 - Use the battery only in the specified equipment.

About GPS

- GPS (Global Positioning System) is operated by the United States government. GLONASS (Global Navigation Satellite System) was started and developed by Soviet Union. Both GPS and GLONASS are satellite-based navigation systems.
- Any change to the satellite positioning system can affect the accuracy of all satellite positioning equipments.
- GPS satellite signals cannot pass through solid materials (except glass). When you are inside a tunnel or building, GPS positioning is not available. Signal reception can be affected by situations such as bad weather or dense overhead obstacles (e.g. trees, tunnels, viaducts and tall buildings).
- The GPS positioning data is for reference only.

Regulatory information

For regulatory identification purposes, MiVue C320/C330 Series is assigned a model number of N530.



Products with the CE marking comply with the Radio Equipment Directive (RED) (2014/53/EU) - issued by the Commission of the European Community.

Compliance with these directives implies conformity to the following European Standards:

EN 55032: 2012 + AC 2013 (Class B)

EN 55024: 2010

EN 61000-3-2: 2014

EN 61000-3-3: 2013

IEC 61000-4-2: 2008

IEC 61000-4-3: 2006 + A1: 2007 + A2: 2010

IEC 61000-4-4: 2012

IEC 61000-4-5: 2014

IEC 61000-4-6: 2013

IEC 61000-4-8: 2009

IEC 61000-4-11: 2004

ETSI EN 301 489-1 V2.1.1 (2017-02)

Draft ETSI EN 301 489-19 V2.1.0 (2017-03)

EN 60950-1:2005 (Second Edition) + Am 1:2009 + Am 2:2013

ETSI EN 303 413 V1.1.1 (2017-06)

EN 50498: 2010 (ISO7637-2)

EN 62479

The manufacturer cannot be held responsible for modifications made by the User and the consequences thereof, which may alter the conformity of the product with the CE Marking.

Declaration of conformity

Hereby, MiTAC declares that this N530 is in compliance with the essential requirements and other relevant provisions of Directive 2014/53/EU.

WEEE



This product must not be disposed of as normal household waste, in accordance with the EU directive for waste electrical and electronic equipment (WEEE – 2012/19/EU). Instead, it should be disposed of by returning it to the point of sale, or to a municipal recycling collection point.

Revision: R01
(9/2017)

Disclaimer

The screenshots in this manual may differ between different operating systems and software versions. You can download the latest User Manual of your product from Mio™ website (www.mio.com).

Specifications and documents are subject to change without notice. MiTAC does not warrant this document is error-free. MiTAC assumes no liability for damage incurred directly or indirectly from errors, omissions or discrepancies between the device and the documents.

Note

Not all models are available in all regions.

Depending on the specific model purchased, the colour and look of your device and accessories may not exactly match the graphics shown in this document.

MiTAC Europe Ltd.
Spectrum House, Beehive Ring Road,
London Gatwick Airport, RH6 0LG,
UNITED KINGDOM