

aune

T1s

双模电子管解码耳放

Dual-Mode Tube DAC with Headphone Amplifier

使用手册 / User Manual

Preface

Dear Customers:

Thanks for purchasing the aune T1s and congratulations on choosing this high quality dual-mode tube DAC with headphone amplifier.

We sincerely hope the T1s will bring you excellent Hi-Fi experience.

Please read this user manual carefully before using the device.

T1s at a Glance

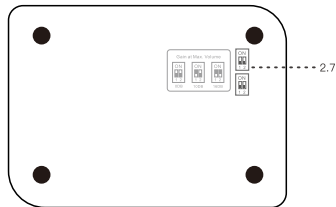
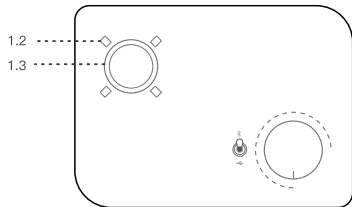
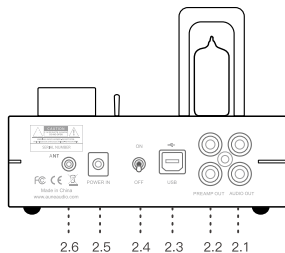
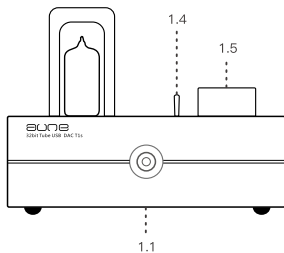

Name and Functions of Each Part

1.1 Headphone port

1.2 Tube cover socket

1.3 Tube socket

1.4 Bluetooth/USB switch

1.5 Volume knob

2.1 Line output

2.2 Preamp output

2.3 USB input

2.4 Power switch

2.5 Power input

2.6 Bluetooth antenna interface

2.7 Gain switch

❗ Tube and tube covers need to be installed as below:

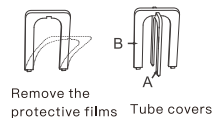
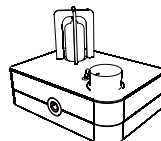
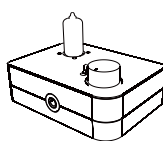

1. How to install the tube:

- Insert the tube into the socket vertically.
- After power-on, the tube will automatically warm up. There will be no sound until the indicator light is on.

2. How to install the tube covers:

- First insert tube cover A into the socket.
- Insert tube cover B. The notches must match.

Introduction

The T1s is the fourth generation of the classic aune T1 series. USB supports 32bit/768k and DSD512; supports aptX HD Bluetooth decoding; adopts the ES9038Q2M DAC chip, the third generation OP+BUF amp module and a 6922EH tube, leading to a very rich sound.

Specifications

USB input:

Maximum bit depth: 32bit

Maximum sampling rate: 768k

Maximum DSD rate: DSD512

Line output:

Output level@0dB: 2Vrms

Frequency response (20Hz~20kHz): $\pm 0.5\text{dB}$

THD+N @1kHz: 0.01%

Noise: 7.9uV

Headphone output:

Output power: 30mW@120 Ω

Bluetooth input: 24bit/48k (max)

Input interfaces: USB/Bluetooth

Output interfaces: 6.35mm headphone out/Preamp out/Line out

Dimensions: 132mm x 95mm x 105mm

Weight: 1kg

Accessories: power adapter, USB cable, Bluetooth antenna, tube, tube cover,

6.35mm (F) to 3.5mm (M) adapter, quick guide, disk

Operation Instructions

As a USB DAC

1. Connect the T1s and a computer/smartphone/portable music player with a corresponding cable
 2. Flip the switch on the top panel to “USB”
 3. Install a custom XMOS driver on your computer (smartphones and portable music players don't need any driver)
 4. Play music on the computer/smartphone/portable music player
 5. Plug in a pair of headphones
 6. “AUDIO OUT” and “PREAMP OUT” output analog signals, via which The T1s can be connected to active speakers or an amplifier.
- (Do not use the headphone port and “PREAMP OUT” at the same time; the headphone port and “AUDIO OUT” can be used at the same time.)

⚠ The T1s has a specially designed delayed startup circuit, which makes output work only after the tube fully warms up. Steps: flip the power switch on – tube light is on – after 20 seconds, the light on tube socket is on – the T1s enters normal working state.

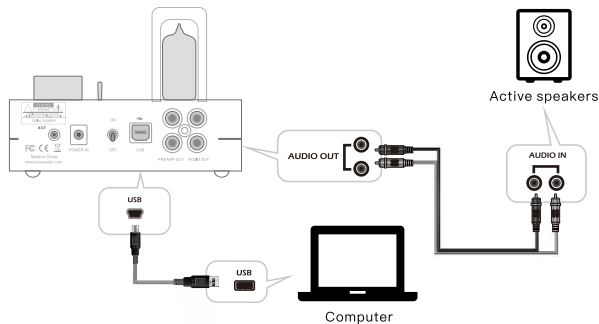

Operation Instructions

As a Bluetooth DAC

1. Flip the switch on the top panel to the Bluetooth icon
 2. Turn on Bluetooth on a smartphone/computer/portable music player, and connect to the device “aune audio”
 3. Plug in a pair of headphones
 4. “AUDIO OUT” and “PREAMP OUT” output analog signals, via which The T1s can be connected to active speakers or an amplifier.
- (Do not use the headphone port and “PREAMP OUT” at the same time; the headphone port and “AUDIO OUT” can be used at the same time.)

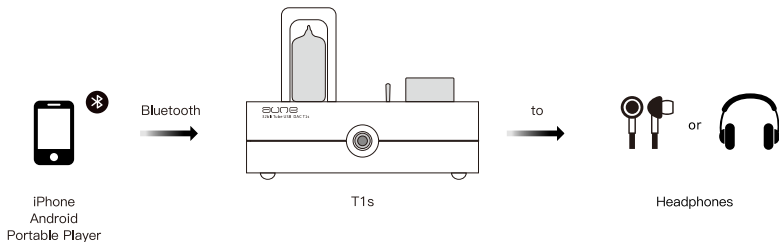

Operation Instructions

Gain Adjustment

Adjust gain to match different headphones:

0dB: 1 OFF, 2 OFF

10dB: 1 ON, 2 OFF

16dB: 1 ON, 2 ON

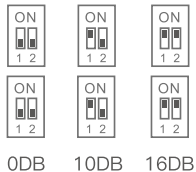

aune

aune | 430034 WUHAN | CHINA

Email: sales@auneaudio.com | Fax: +86 027 85840435 | www.auneaudio.com